

| ROUTE | SECTION | COUNTY | TOTAL SHEETS | SHEET NO. |
|-------------------------------|----------------|---------|--------------------|-----------|
| FAS 938 | 05-00064-00-RS | PULASKI | 32 | 11 |
| PROJECT NO. RS-HPP-3300 (002) | | | CONTRACT NO. 99250 | |



190

195

200

205

210

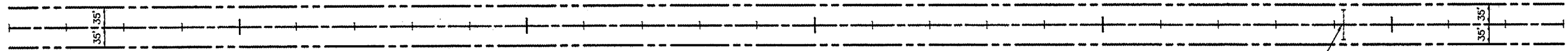

Sta. 209+16
Exist. 18" x 52' CMP w/Hdws
To remain.

SCALES:
1" = 200' HOR
1" = 20' VER

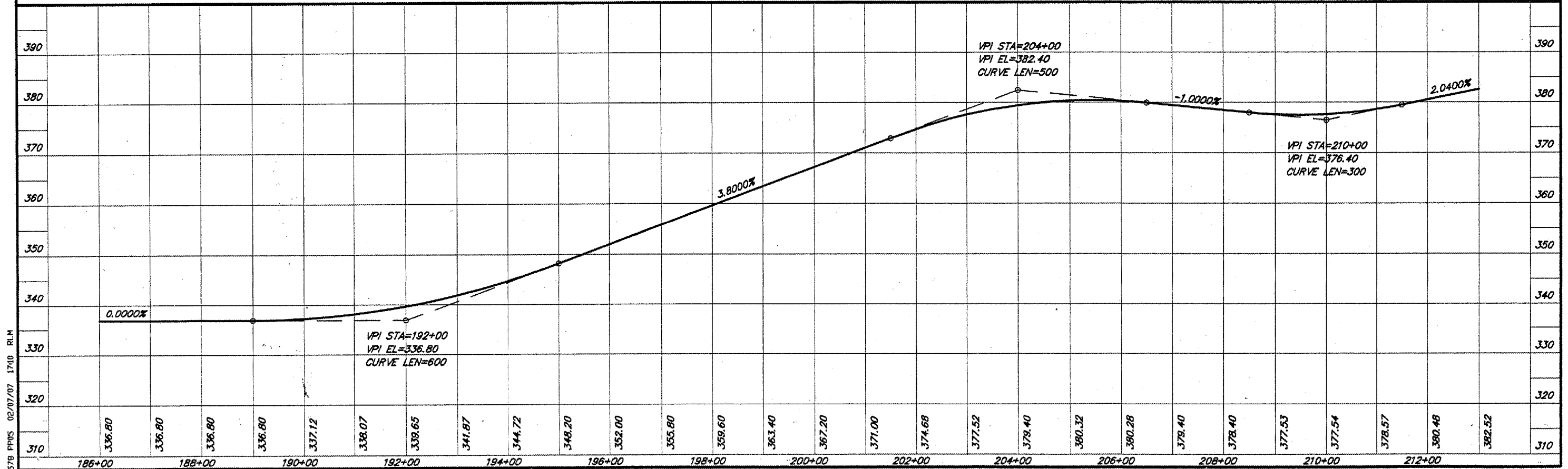

578 PPS 02/07/07 1710 RLM