

ROUTE	SECTION	COUNTY	TOTAL SHEETS	SHEET NO.
FAS 938	05-00064-00-RS	PULASKI	32	19
PROJECT NO. RS-HPP-3300 (002)			CONTRACT NO. 99260	

CURVE DATA
 $\Delta = 9^{\circ}19'00''$ $T = 233.44'$
 $D = 2^{\circ}00'00''$ $L = 465.86'$
 $R = 2864.93'$ $E = 9.50'$
 $S.E. = 0.039'/ft.$
 Attain Sta. 413+24 to Sta. 414+43
 Remove Sta. 418+52 to Sta. 419+71

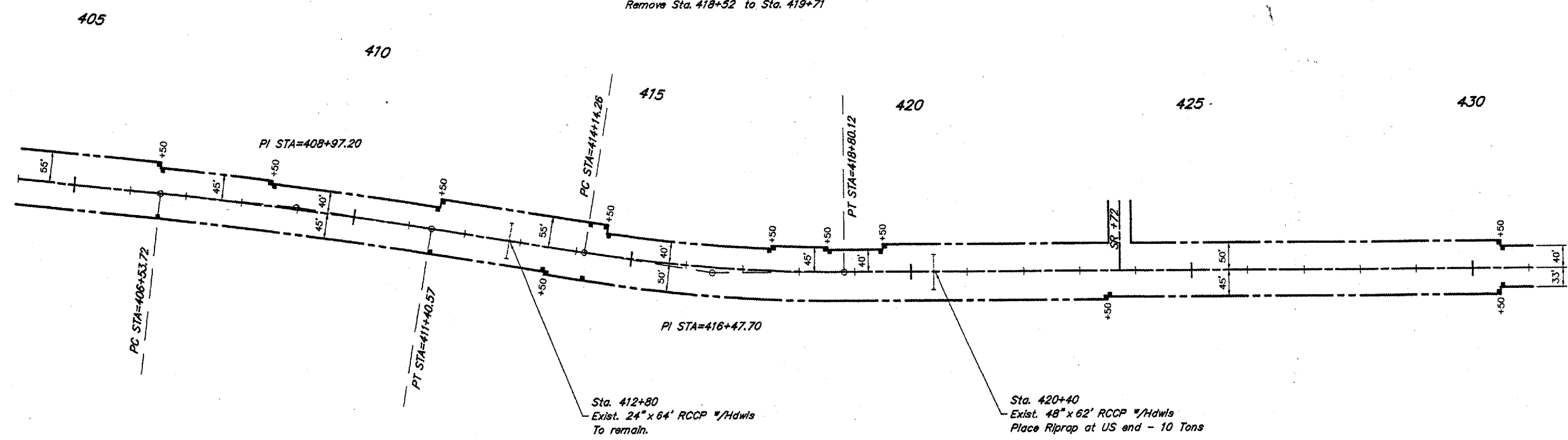

CURVE DATA
 $\Delta = 3^{\circ}05'00''$ $T = 243.48'$
 $D = 0^{\circ}38'00''$ $L = 486.84'$
 $R = 9046.75'$ $E = 3.28'$
 Normal Crown

SCALES:
 1" = 200' HOR
 1" = 20' VER

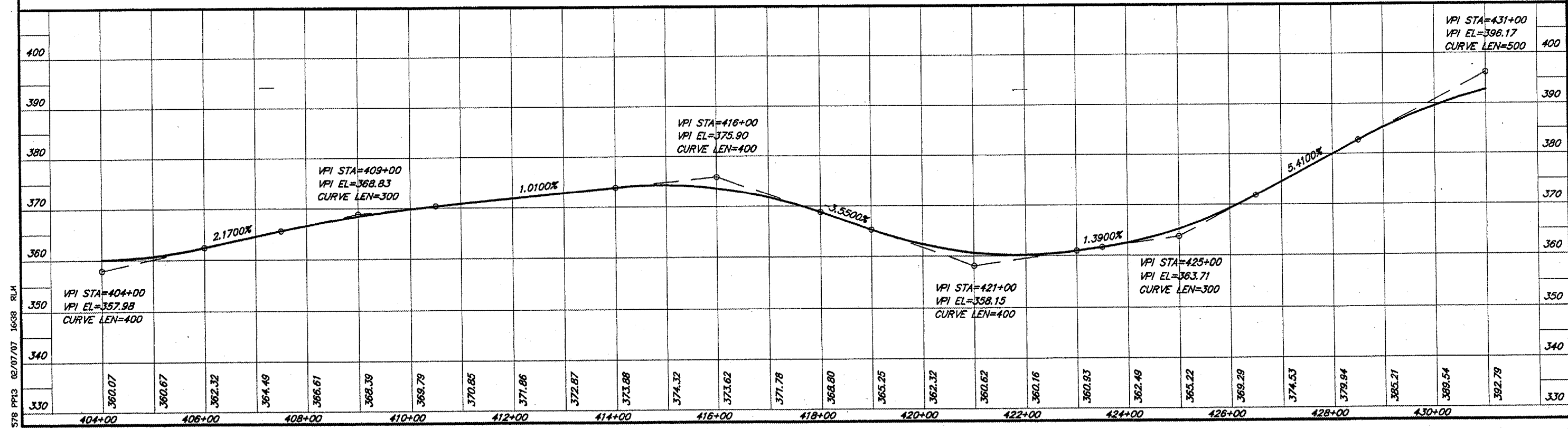

578 PPI3 02/07/07 1638 RLM