

CLOSED RUNWAY MARKER DETAIL

N.T.S.

NOTES

1. MARKERS SHALL BE SOLID YELLOW.
2. MARKERS SHALL BE PAINTED BURLAP, PLYWOOD OR OTHER APPROVED SOLID MATERIALS.
3. CONTRACTOR SHALL MAINTAIN MARKERS.
4. COST OF FURNISHING, INSTALLING, MAINTAINING, RELOCATING AND REMOVING MARKERS SHALL BE INCIDENTAL TO THE CONTRACT.
5. MARKERS SHALL BE PLACED OVER EXISTING RUNWAY NUMERALS. HOWEVER, WHEN WORK IS NECESSARY FOR THAT AREA OR PAVEMENT IS OPEN TO TAXIING AIRCRAFT, THE MARKERS SHALL BE RELOCATED OFF THE PAVEMENT AS SHOWN ON THE DETAIL.
6. PORTABLE CLOSED RUNWAY MARKERS SHALL BE PROVIDED, INSTALLED, OPERATED AND MAINTAINED AS SPECIFIED.
7. THE PORTABLE CLOSED RUNWAY MARKERS SHALL BE INSTALLED ON RUNWAY 13/31. TEMPORARY CLOSED RUNWAY MARKERS AS DISCUSSED IN ITEM 2. ABOVE SHALL BE INSTALLED ON RUNWAY 18/36 AND RUNWAY 4/22.

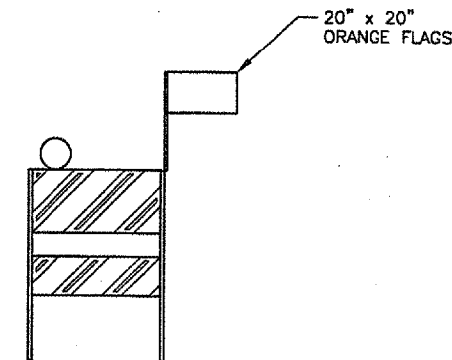

FLASHER BARRICADE DETAIL

N.T.S.

FLASHER BARRICADE NOTES

1. FLASHERS TO BE BATTERY OPERATED. LENS TO BE RED AND BE ABLE TO ROTATE 90 DEGREES.
2. SANDBAGS TO BE PLACED ON EACH SUPPORT BRACE AS REQUIRED TO PREVENT DISPLACEMENT BY WIND, JET OR PROP BLAST.
3. NO SEPARATE PAYMENT WILL BE MADE FOR THIS ITEM. COSTS SHALL BE CONSIDERED INCIDENTAL TO THE PROJECT.
4. PLACE AT 20' INTERVALS.

REVISIONS

NUMBER	BY	DATE

0 1 2
 THIS BAR IS EQUAL TO 2'
 AT FULL SCALE (34X22).



SPRINGFIELD AIRPORT AUTHORITY
ABRAHAM LINCOLN CAPITAL AIRPORT
SPRINGFIELD, ILLINOIS

CONSTRUCT RUNWAY 13/31 RSA IMPROVEMENTS
CONSTRUCTION ACTIVITY PLAN DETAILS

© Copyright CMT, Inc.

CMT
 CRAWFORD, MURPHY & TILLY, INC.
 CONSULTING ENGINEERS
 License No. 184-000613

DESIGN BY: RLV

DRAWN BY: DPA

CHECKED BY: RLV

APPROVED BY: RLV

DATE: 04/24/07

JOB No: 05035-03

IL PROJ. NO. SPI-3488
 AIP PROJ. NO. 3-17-0096-42