

KEYMAP

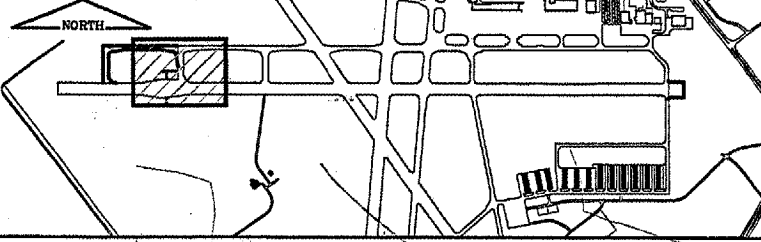

NOTES:

- 1. REPLACE EXISTING IN-PAVEMENT RUNWAY EDGE LIGHT FIXTURES - 6 EACH. LIGHT BASES TO BE RE-USED.

CA003

K:\Springfield\0503503\Draw\Sheets
 FILE: EXCON02.dwg
 UPDATE BY: Dave Allen
 PLOT DATE: 5/7/2007 11:43 AM
 Capital_Base
 tbinfo
 BASE_PROPGE0
 KEY
 Base_ExistTopo_TxyB
 ContourBase

REVISIONS

NUMBER	BY	DATE

0 1 2
 THIS BAR IS EQUAL TO 2" AT FULL SCALE (34X22).

MATCHLINE STA. 117+00

MATCHLINE STA. 217+00

MATCHLINE STA. 230+00

PARALLEL TXY B

CONN. TXY K

RUNWAY 13/31

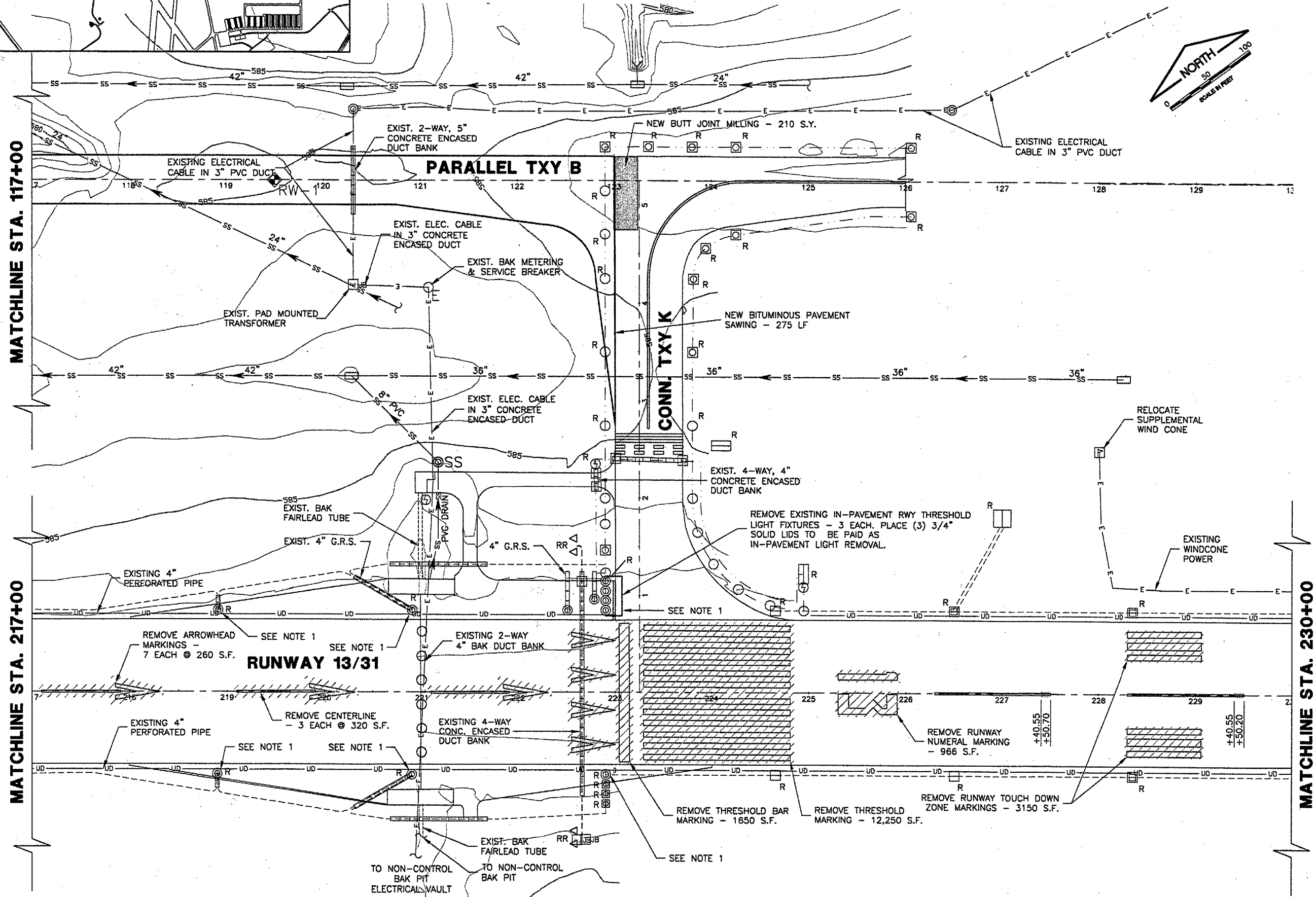

SPRINGFIELD AIRPORT AUTHORITY
ABRAHAM LINCOLN CAPITAL AIRPORT
SPRINGFIELD, ILLINOIS

CONSTRUCT RUNWAY 13/31 RSA IMPROVEMENTS
EXISTING CONDITIONS & REMOVALS 2

CMT
 CRAWFORD, MURPHY & TILLY, INC.
 CONSULTING ENGINEERS
 License No. 854-000813

DESIGN BY:	RLV
DRAWN BY:	DPA
CHECKED BY:	RLV
APPROVED BY:	RLV
DATE:	04/24/07
JOB No:	05035-03
IL PROJ. NO. SPI-3488	
AIP PROJ. NO. 3-17-0096-42	
SHEET 10 OF 70 SHEETS	