

KEYMAP

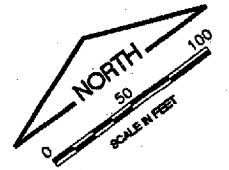
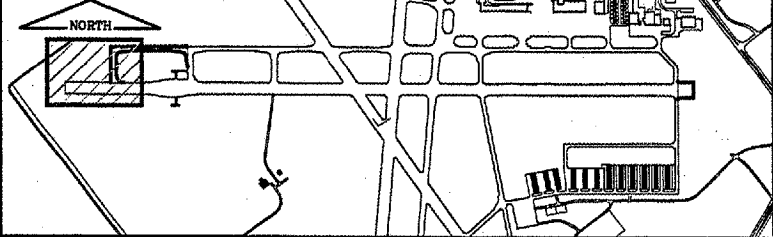

CA003
 K:\Springfield\0503503\Draw\Sheets
 FILE: PROPIMP01.dwg
 UPDATE BY: Allan Draughon
 PLOT DATE: 4/30/2007 12:52 PM
 Capital_Base
 Base_ExistTopo_TxyB
 tbinfo
 BASE_PROPGEO
 KEY

REVISIONS

NUMBER	BY	DATE

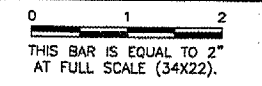

- LEGEND**
- FUTURE PAVEMENT
 - NEW PAVEMENT
 - EXISTING PAVEMENT
 - NEW 4" BITUMINOUS SURFACE COURSE (401), 14" BITUMINOUS BASE COURSE (201), 4" CRUSHED AGGREGATE BASE COURSE (209), 8" LIME TREATED SUBGRADE (155) - CONTRACTOR'S OPTION
 - NEW 1 1/2" BITUMINOUS SURFACE COURSE (401), 2 1/2" BITUMINOUS BASE COURSE (201), 4" CRUSHED AGGREGATE BASE COURSE (209)
 - NEW BITUMINOUS BUTT JOINT - SEE STAKING PLANS

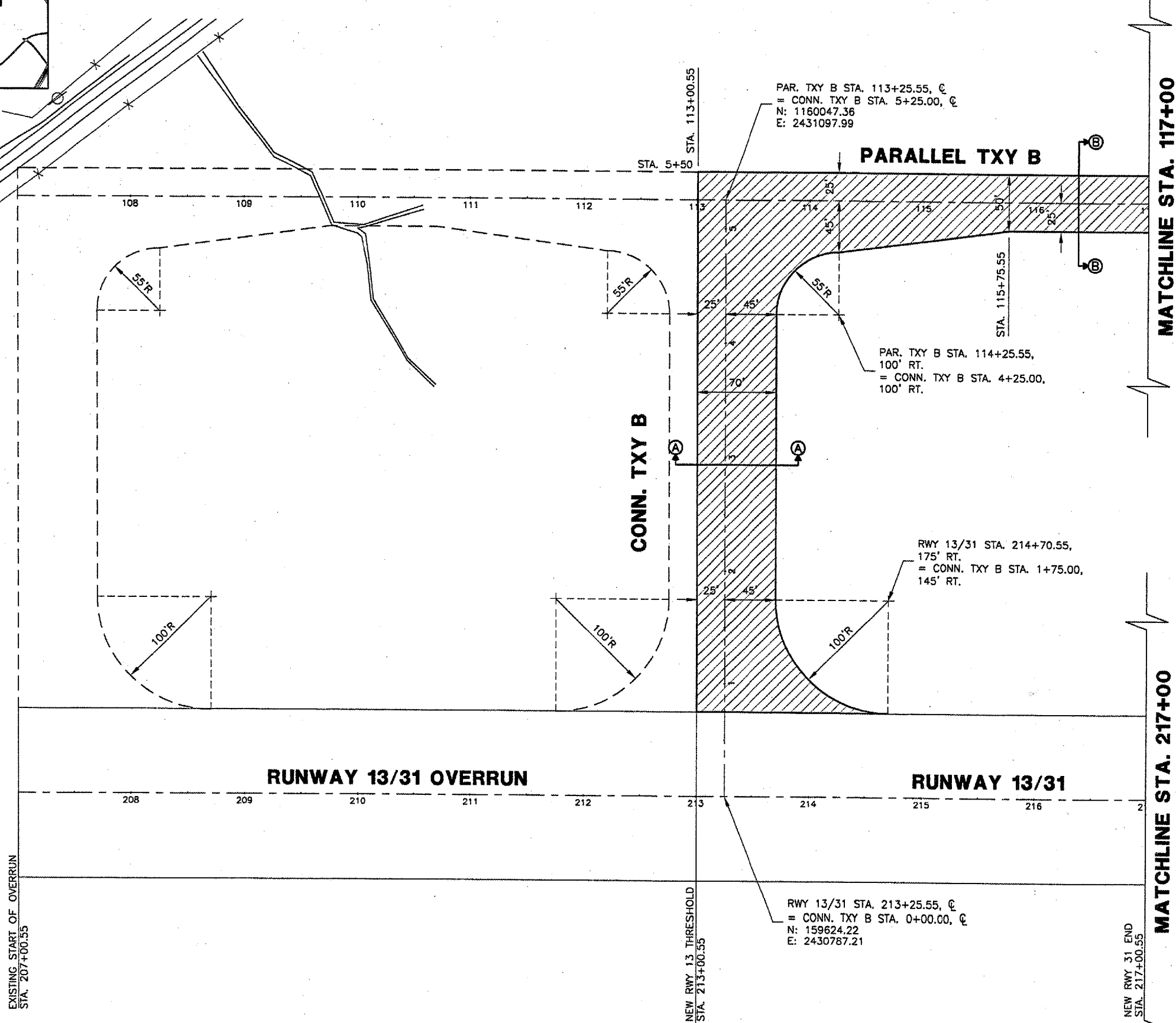

SPRINGFIELD AIRPORT AUTHORITY
ABRAHAM LINCOLN CAPITAL AIRPORT
SPRINGFIELD, ILLINOIS

CONSTRUCT RUNWAY 13/31 RSA IMPROVEMENTS

PROPOSED IMPROVEMENTS 1

© Copyright CMT, Inc.
CMT
 CRAWFORD, MURPHY & TILLY, INC.
 CONSULTING ENGINEERS
 License No. 184-000819

DESIGN BY: RLV
 DRAWN BY: DPA
 CHECKED BY: RLV
 APPROVED BY: RLV
 DATE: 04/24/07
 JOB No: 05035-03
 IL PROJ. NO. SPI-3488
 AIP PROJ. NO. 3-17-0096-42