

KEYMAP

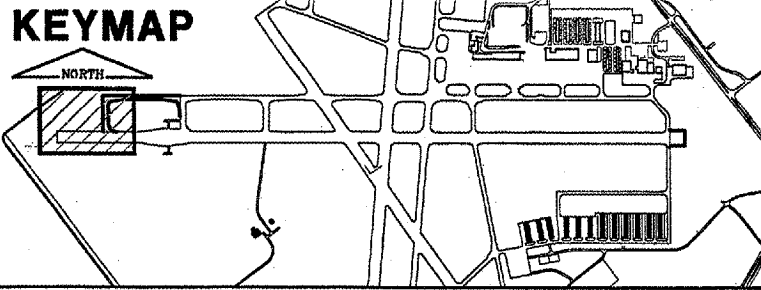

CA003
 K:\Springfield\0503503\Draw\Sheets
 FILE: ELECO1.dwg
 UPDATE BY: Dave Allen
 PLOT DATE: 5/4/2007 10:40 AM
 Capital_Base
 Base_ExistTopo_TxyB
 tbinfo
 BASE_PROPGEO
 KEY
 BASE_PROPELEC

REVISIONS

NUMBER	BY	DATE

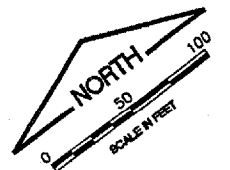
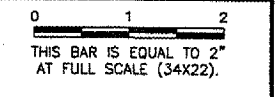

SIGNAGE TABLE

SIGN	STATION	OFFSET
1	2+56.00	80' RT.
2	214+70.50	110' LT.

LEGEND

- EXISTING STAKE MOUNTED TAXIWAY LIGHT
- EXISTING BASE MOUNTED RWY LIGHT
- NEW HIGH INTENSITY RWY EDGE LIGHT
- ▣ FUTURE HIGH INTENSITY RWY EDGE LIGHT
- EXISTING BASE MOUNTED TXY LIGHT
- NEW BASE MOUNTED TXY LIGHT
- ⊙ EXISTING IN-PAVEMENT RWY EDGE LIGHT
- ⊙ NEW IN-PAVEMENT RWY EDGE LIGHT
- ⊙ NEW THRESHOLD LIGHT
- ④ NEW DISTANCE REMAINING SIGN & NO.
- ③ EXISTING AIRFIELD SIGN (SIGN PANELS TO BE REPLACED) & NO.
- ② NEW AIRFIELD SIGN & NO.
- ⊕ EXIST. SPLICE CAN
- NEW SPLICE CAN
- G- GREEN LENS
- R- RED LENS
- W- WHITE LENS
- Y- YELLOW LENS
- ▲ RELOCATED REIL
- R REMOVE
- EXIST. DUCT BANK
- NEW DUCT BANK & #-WAY
- EXIST. TXY CIRCUIT
- NEW TXY B CIRCUIT
- NEW RWY 13/31 CIRCUIT
- NEW REIL CIRCUIT
- NEW DIRECTIONAL BORE - 4"

NOTES:

- NEW CABLING IS SHOWN DISTORTED TO IMPROVE CLARITY.
- EDGE LIGHTS SHALL BE LOCATED AT 10' OFF THE EDGE OF PAVEMENT.
- EDGE LIGHT CABLE SHALL BE LOCATED AT 12' OFF THE EDGE OF PAVEMENT.

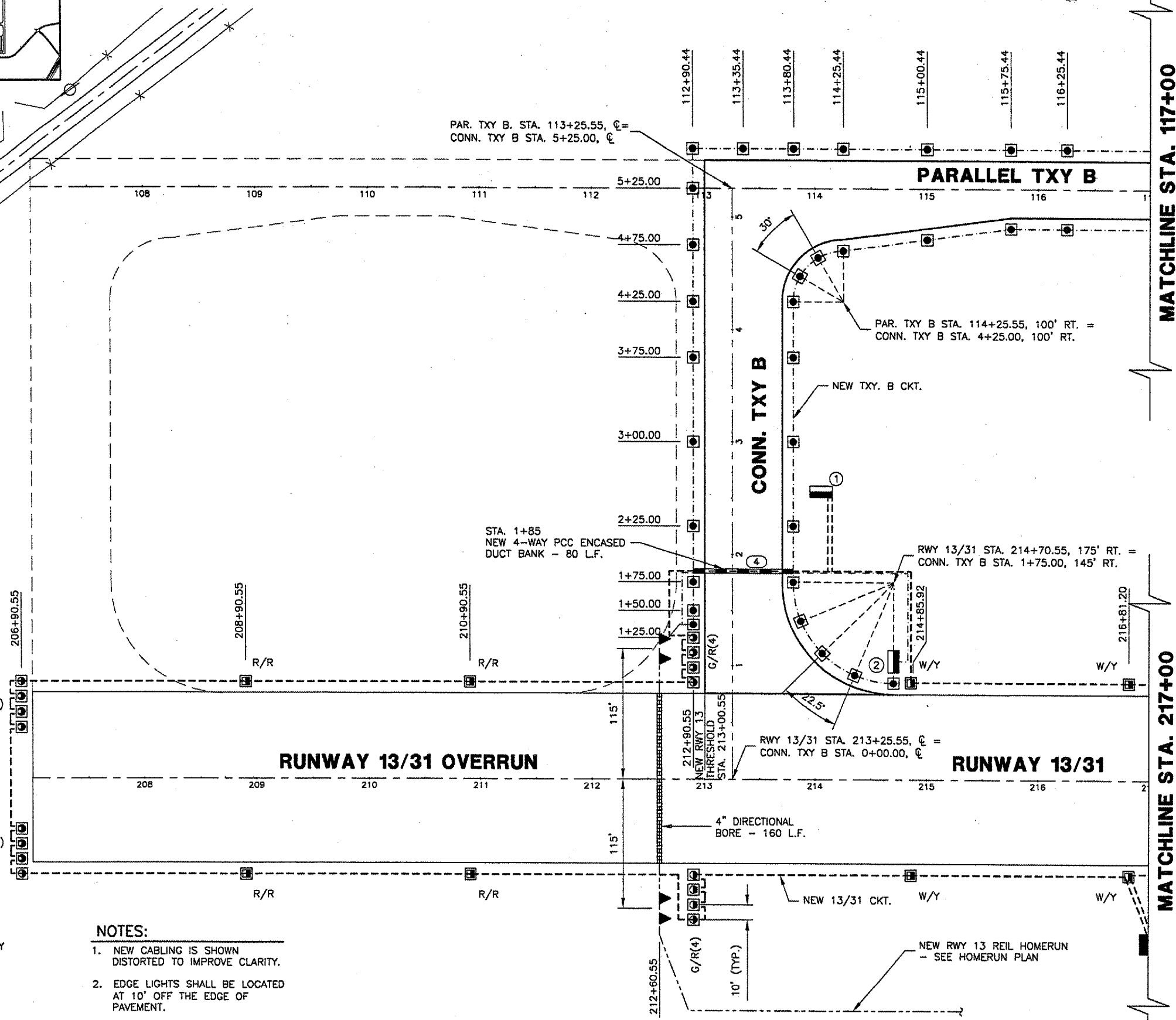

MATCHLINE STA. 117+00

MATCHLINE STA. 217+00

SPRINGFIELD AIRPORT AUTHORITY
ABRAHAM LINCOLN CAPITAL AIRPORT
SPRINGFIELD, ILLINOIS
CONSTRUCT RUNWAY 13/31 RSA IMPROVEMENTS
ELECTRICAL & LIGHTING PLAN 1

CMT
 CRAWFORD, MURPHY & TILLY, INC.
 CONSULTING ENGINEERS
 License No. 184-000618

DESIGN BY: RLV
 DRAWN BY: DPA
 CHECKED BY: RLV
 APPROVED BY: RLV
 DATE: 04/24/07
 JOB No: 05035-03
 I.L. PROJ. NO. SPI-3488
 AIP PROJ. NO. 3-17-0096-42
 SHEET 36 OF 70 SHEETS