

SIGNAGE TABLE		
SIGN	STATION	OFFSET
26	275+18.11	150' LT.
27	277+00.55	150' RT.
28	285+18.11	150' LT.
29	NO CHANGE	

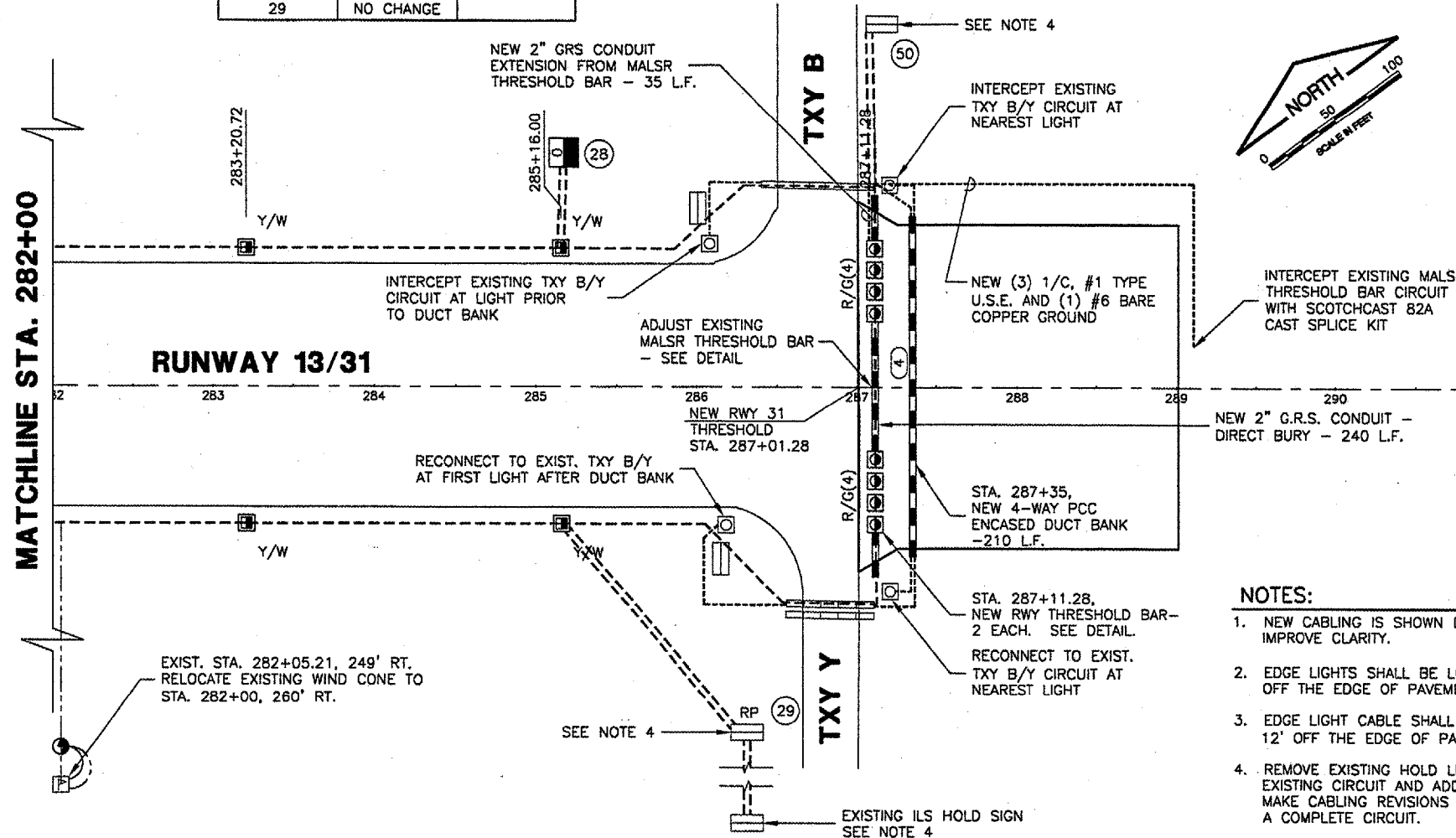

**LEGEND**

- EXISTING STAKE MOUNTED TAXIWAY LIGHT
- EXISTING BASE MOUNTED RWY LIGHT
- NEW HIGH INTENSITY RWY EDGE LIGHT
- FUTURE HIGH INTENSITY RWY EDGE LIGHT
- EXISTING BASE MOUNTED TXY LIGHT
- NEW BASE MOUNTED TXY LIGHT
- ⊙ EXISTING IN-PAVEMENT RWY EDGE LIGHT
- ⊙ NEW IN-PAVEMENT RWY EDGE LIGHT
- ⊙ NEW THRESHOLD LIGHT
- ④ NEW DISTANCE REMAINING SIGN & NO.
- ③ EXISTING AIRFIELD SIGN (SIGN PANELS TO BE REPLACED) & NO.
- ② NEW AIRFIELD SIGN & NO.
- ⊙ EXIST. SPLICE CAN
- ⊙ NEW SPLICE CAN
- EXIST. DUCT BANK
- NEW DUCT BANK & #-WAY
- G- GREEN LENS
- R- RED LENS
- W- WHITE LENS
- Y- YELLOW LENS
- ▲ RELOCATED REIL
- R REMOVE
- EXIST. TXY CIRCUIT
- NEW TXY B CIRCUIT
- NEW RWY 13/31 CIRCUIT
- NEW REIL CIRCUIT
- NEW DIRECTIONAL BORE - 4"

- NOTES:**
- NEW CABLING IS SHOWN DISTORTED TO IMPROVE CLARITY.
  - EDGE LIGHTS SHALL BE LOCATED AT 10' OFF THE EDGE OF PAVEMENT.
  - EDGE LIGHT CABLE SHALL BE LOCATED AT 12' OFF THE EDGE OF PAVEMENT.
  - REMOVE EXISTING HOLD LINE SIGN FROM EXISTING CIRCUIT AND ADD TO NEW CIRCUIT. MAKE CABLING REVISIONS TO PROVIDE FOR A COMPLETE CIRCUIT.

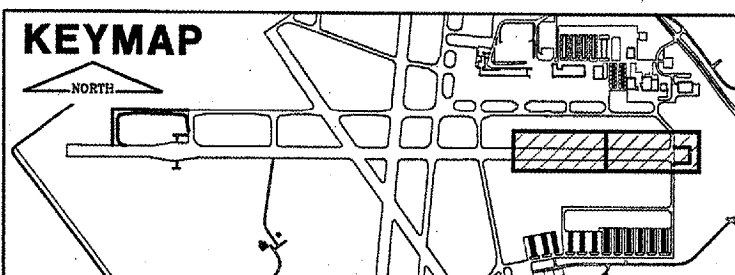

**REVISIONS**

NUMBER	BY	DATE

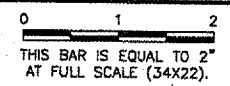

  
**SPRINGFIELD AIRPORT AUTHORITY**  
**ABRAHAM LINCOLN CAPITAL AIRPORT**  
**SPRINGFIELD, ILLINOIS**

**CONSTRUCT RUNWAY 13/31 RSA IMPROVEMENTS**  
**ELECTRICAL & LIGHTING PLAN 5**

© Copyright CMT, Inc.  
**CMT**  
 CRAWFORD, MURPHY & TILLY, INC.  
 CONSULTING ENGINEERS  
 License No. 984-000613

DESIGN BY:	RLV
DRAWN BY:	DPA
CHECKED BY:	RLV
APPROVED BY:	RLV
DATE:	04/24/07
JOB No:	05035-03
IL PROJ. NO.	SPI-3488
AIP PROJ. NO.	3-17-0096-42