

DATE	REVISION	BY

CARMI MUNICIPAL AIRPORT
CARMI, ILLINOIS

IL PROJ.: CUL-3663 A.I.P. PROJ.: 3-17-0109-B7

ILL. Project No. 801-0733YD_0800 Elevator: R-131DRN.DWG Scale: 1" = 30' Date: 11/15/06	LAYOUT: SEP 11/15/06 DRAWN: CCC 11/15/06 REVIEWED: CAH 03/27/07
---	---



EXTEND PARTIAL PARALLEL TAXIWAY

PROPOSED DRAINAGE PLAN STA. 21+50 TO STA. 37+50

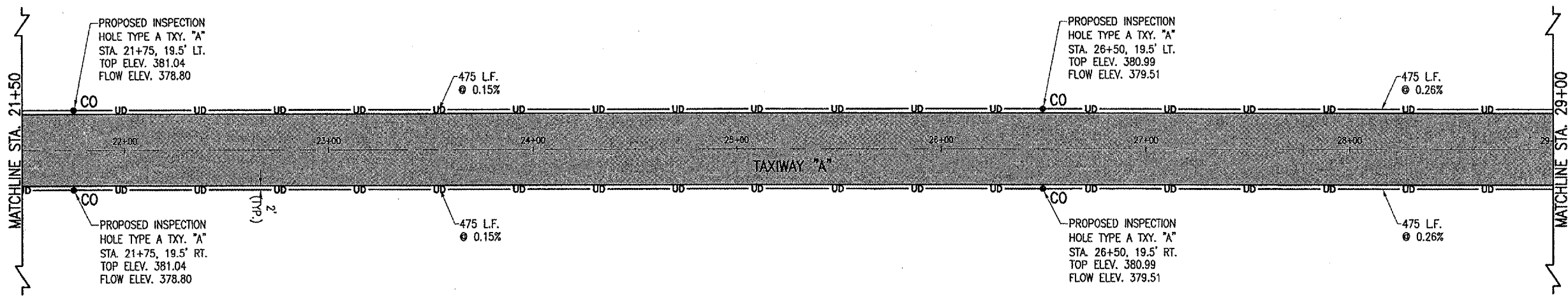

LEGEND

- EXISTING PAVEMENT
- PROPOSED PAVEMENT
- PROPOSED 4" PERFORATED UNDERDRAIN W/SOCK
- PROPOSED UNDERDRAIN INSPECTION HOLE

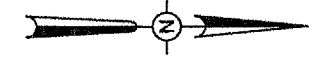
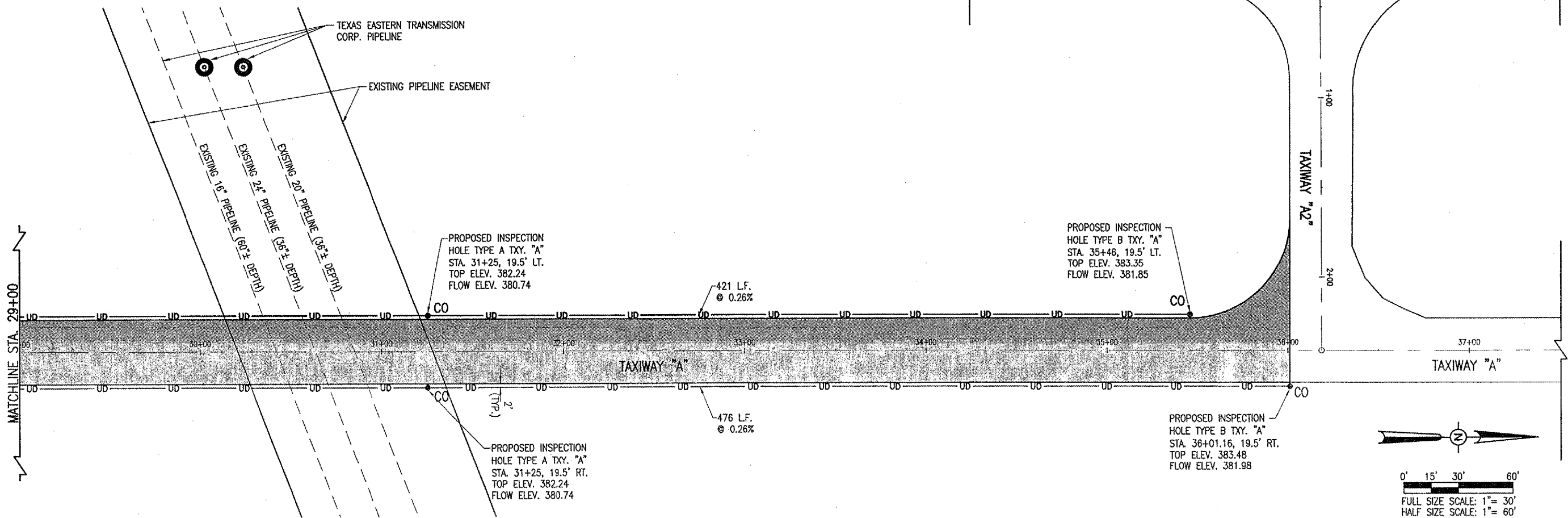

0' 15' 30' 60'
 FULL SIZE SCALE: 1" = 30'
 HALF SIZE SCALE: 1" = 60'