

QUAD CITY INTERNATIONAL AIRPORT
 RUNWAY 5 EXTENSION - PAVING
 ILL. MLI-3623, QU003
 SHEET 11 OF 74

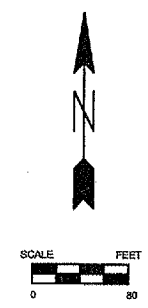
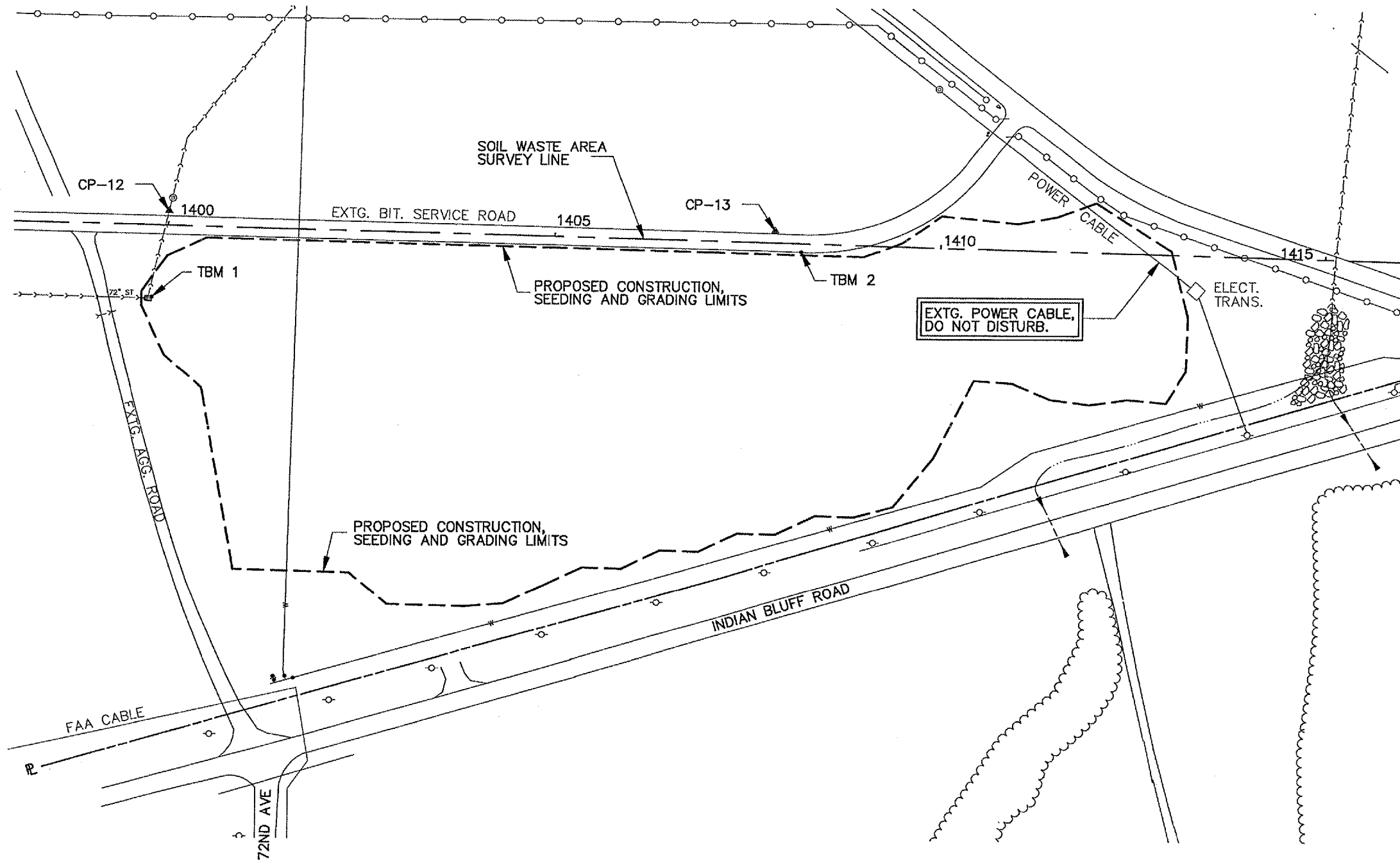

PROJECT CONTROL POINTS			
NUMBER	LOCATION	ELEV.	REMARK
CP-11	STA. 1386+36.96, RT. 200.74' N1738837.5207, E2203759.6063	577.65	
CP-12	STA. 1400+00, LT. 18.49' N1739021.9767, E2205127.7852	573.90	SPK
CP-13	STA. 1407+85.66, LT. 15.92' N1738999.4073, E2205913.1239	576.70	SPK

TEMPORARY BENCH MARKS		
T.B.M.	ELEV.	DESCRIPTION
TBM-A	578.57	CHIS. □ ON CONC TRANSFORMER PAD, TXWY K, STA. 377+71.67, RT. 369.06'
TBM-C	580.78	ALUMINUM DISC IN CONC ○ RNWY 31 END, RNWY 31, STA. 83+49.85, LT. 0.00'
TBM-1	575.01	CHIS. *x* ON NW COR OF CONC INLET, STA. 1399+84.22, RT. 91.77'
TBM-2	580.40	PK NAIL SET AT S EDGE OF SERVICE ROAD, STA. 1408+20.01, RT. 10.73'

- LEGEND:**
- ⊙ EDGE LIGHT
 - GUIDANCE SIGN
 - ELECTRICAL CABLE
 - - - STORM SEWER OR UNDERDRAIN
 - ▣ INLET
 - ▽ OUTLET
 - STORM MANHOLE
 - ⊙ SANITARY MANHOLE
 - - - DRAINAGE DITCH
 - - - CONDUIT OR DUCT BANK
 - - - FUTURE PAVEMENT
 - - - PROPOSED CONSTRUCTION, SEEDING, AND GRADING LIMITS

3:\A\airport\A06T025 R5 EXTN, P\MTWASTE_AREA.dwg, 5/11/2007 9:37:43 AM, e:\fm