

QUAD CITY INTERNATIONAL AIRPORT
 RUNWAY 5 EXTENSION - PAVING
 ILL. MLI-3623, QU003
 SHEET 28 OF 74

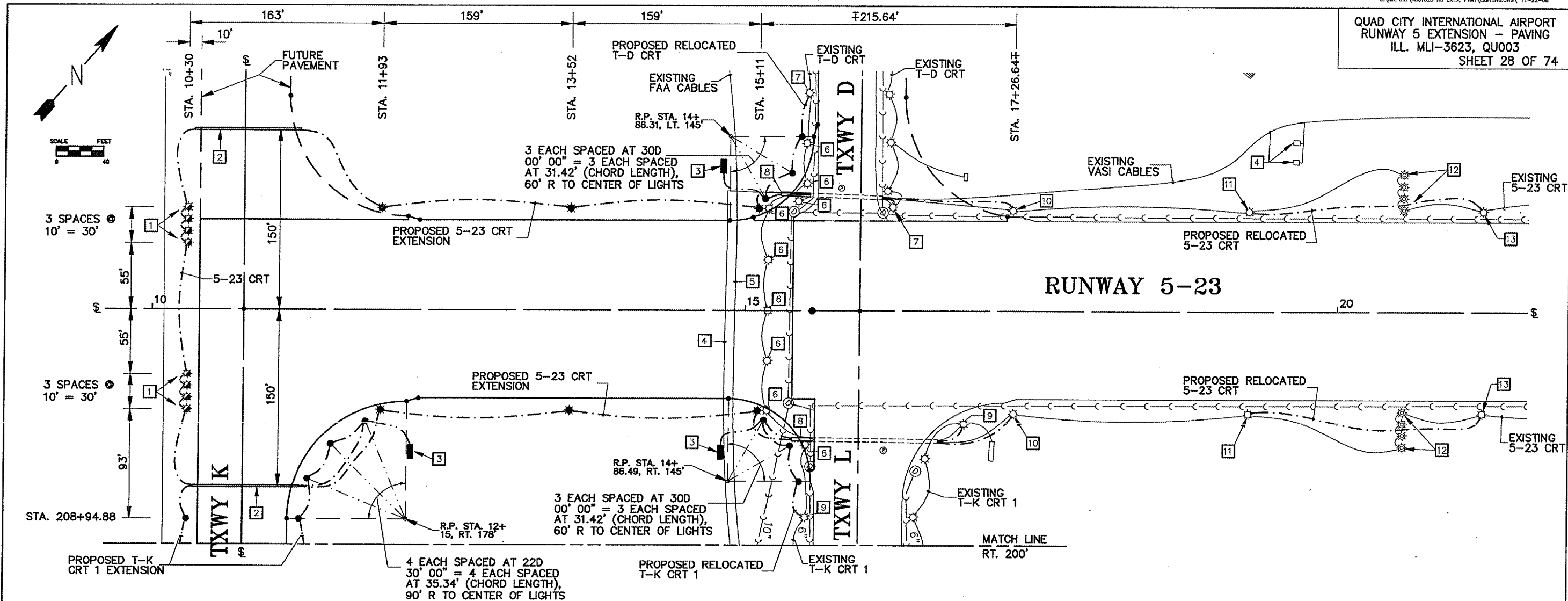

SYMBOL LEGEND

- ☼ EXISTING L-861T MITL OR L-861 MIRL
- ☼ EXISTING L-861E MEDIUM INTENSITY THRESHOLD LIGHT
- ⊙ EXISTING L-852 IN-PAVEMENT TAXIWAY CENTERLINE LIGHT
- EXISTING L-867 SPLICE OR TRANSFORMER CAN
- EXISTING GUIDANCE SIGN
- Ⓧ Ⓨ EXISTING STORM OR SANITARY MANHOLE
- EXISTING UNDERDRAINS/STORM OR SANITARY SEWERS
- EXISTING CONDUIT OR DUCT BANK
- EXISTING ELECTRICAL CIRCUIT, CABLE IN UNIT DUCT
- PROPOSED LOCATION FOR RELOCATED OR NEW GUIDANCE SIGN
- PROPOSED LOCATION FOR RELOCATED OR NEW L-861T MITL (BLUE)
- ☼ PROPOSED LOCATION FOR RELOCATED OR NEW L-861 MIRL (WHITE / YELLOW)
- ☼ PROPOSED LOCATION FOR RELOCATED OR NEW L-861E THRESHOLD MIRL (RED / GREEN)
- ⊙ PROPOSED L-867 SPLICE OR TRANSFORMER CAN
- PROPOSED CONDUIT OR DUCT BANK
- PROPOSED ELECTRICAL CIRCUIT, 1/C, #8, EPR CABLE IN 1" HDPE UNIT DUCT
- PROPOSED ELECTRICAL CIRCUIT, 2/C, #8, EPR CABLES IN 1-1/2" HDPE UNIT DUCT

NUMBERED LEGEND

- 1 RELOCATE EXISTING L-861E THRESHOLD MIRL UNITS (8 EACH) FROM LOCATIONS 12 TO NEW LOCATIONS 1. SW FACE = GREEN FILTER, NE FACE = RED FILTER. SUPPLY & INSTALL NEW GROUNDING ROD WITH EACH RELOCATION PER DETAIL. INCLUDE GROUNDING ROD & WIRE COSTS IN RELOCATION UNIT PRICE.
- 2 PROPOSED DUCT BANKS: T-D = 3-WAY BANK (N OF RWY), T-K = 2-WAY BANK (S OF RWY).
- 3 PROPOSED LOCATION FOR RELOCATED OR NEW GUIDANCE SIGN. SEE SHEET 30 FOR MORE INFORMATION.
- 4 EXISTING VASI SYSTEM TO BE REPLACED. SEE SHEET 36 FOR MORE INFORMATION.
- 5 EXISTING FAA CONTROL CABLE TO BE RELOCATED. DO NOT DISTURB EXISTING CABLE UNTIL REPLACEMENT CABLE IS IN SERVICE. SEE SHEET 41 FOR MORE INFORMATION.
- 6 RELOCATE OR REMOVE EXISTING L-861T MITL UNITS OR SPLICE CANS. SUPPLY & INSTALL NEW GROUNDING ROD WITH EACH RELOCATION PER DETAIL. INCLUDE GROUNDING ROD & WIRE COSTS IN RELOCATION UNIT PRICE.
- 7 DISCONNECT EXTG. T-D CRT CABLES & UNIT DUCTS AT THESE LOCATIONS. START / END PROPOSED T-D CRT RELOCATION AT THESE LOCATIONS.

- 8 EXTEND EXISTING DUCT BANK TO A POINT THAT IS 5' BEYOND THE EDGE OF THE PROPOSED / FUTURE PAVEMENT. USE 4" SPLIT DUCT TO EXTEND DUCT BANK IF EXISTING CABLES ARE PRESENT.
- 9 DISCONNECT EXTG. T-K CRT 1 CABLES & UNIT DUCTS AT THESE LOCATIONS. START / END PROPOSED T-K CRT 1 RELOCATION AT THESE LOCATIONS.
- 10 DISCONNECT EXTG. 5-23 CRT CABLES & UNIT DUCTS AT THESE LOCATIONS. START / END PROPOSED 5-23 CRT EXTENSION AT THESE LOCATIONS. SUPPLY AND INSTALL NEW WHITE / YELLOW LIGHT LENSES AT THESE LOCATIONS.
- 11 DISCONNECT EXTG. 5-23 CRT CABLES & UNIT DUCTS AT THESE LOCATIONS. START PROPOSED 5-23 CRT RELOCATIONS AT THESE LOCATIONS. SUPPLY AND INSTALL NEW WHITE / YELLOW LIGHT LENSES AT THESE LOCATIONS.
- 12 EXISTING L-861E THRESHOLD MIRL UNITS (8 EACH) TO BE RELOCATED TO LOCATION 1. THESE THRESHOLD LIGHTS ARE TO REMAIN IN PLACE AND BE OPERATIONAL UNTIL THE NEW PAVEMENT EXTENSION AND EARTHWORK IS COMPLETE.
- 13 DISCONNECT EXTG. 5-23 CRT CABLES & UNIT DUCTS AT THESE LOCATIONS. END PROPOSED 5-23 CRT RELOCATIONS AT THESE LOCATIONS.

GENERAL NOTES:

1. SEE SHEET 33 FOR ELECTRICAL GENERAL NOTES.
2. SEE SHEETS 33-35 FOR ELECTRICAL DETAILS
3. SEE SHEET 30 FOR SIGN DETAILS.
4. ALL EXISTING ELECTRICAL CIRCUITS TO REMAIN ACTIVE AT ALL TIMES. CONTRACTOR TO PROVIDE, INSTALL, AND MAINTAIN TEMPORARY ABOVE GROUND JUMPER CABLES AS REQUIRED TO PROVIDE CIRCUIT CONTINUITY IN ALL CIRCUITS AT ALL TIMES DURING CONSTRUCTION. COSTS TO BE INCLUDED IN THE LIGHTING CONTRACT UNIT PRICES. LENGTH OF JUMPER CABLES SHALL NOT BE MEASURED FOR PAYMENT AND / OR PAYED FOR.
5. RUNWAY EDGE LIGHTS ARE TO BE WHITE / YELLOW BETWEEN:
 - STA. 10+40 TO STA. 30+40 (YELLOW ON NORTHEAST SIDE) AND
 - STA. 40+55.91 TO STA. 60+55.91 (YELLOW ON SOUTHWEST SIDE).
 RUNWAY EDGE LIGHTS ARE TO BE WHITE / WHITE BETWEEN STA. 30+40 TO STA. 40+55.91. CONTRACTOR SHALL SUPPLY AND INSTALL 8 EACH NEW CLEAR LIGHT LENSES ON THE RUNWAY EDGE LIGHTS AT THE FOLLOWING LOCATIONS: STA. 31+02, RT.; 31+08, LT.; 35+04, LT. & RT.; 37+02, LT. & RT.; AND 39+00, LT. & RT.

J:\airport\A06T025 R5 EXTN, P\M\LIGHTING.DWG, 5/8/2007 1:46:52 PM, ffr