

PROPOSED TAXIWAY EDGE LIGHT LOCATIONS		
LIGHT REFERENCE LETTER	STATION & OUT	SHORTEST DISTANCE TO EDGE OF PAVEMENT
A	210+20.64, RT. 51.15'	10'
B	210+48.51, RT. 55.70'	9.96'
C	210+74.34, RT. 66.92'	10'
D	210+97.68, RT. 90.46'	10'
E	211+23.77, RT. 71.20'	8.98'
F	211+53.73, RT. 59.74'	10'
G	211+88.27, RT. 41.52'	10'

SYMBOL LEGEND

- EXISTING L-861T MITL OR L-861 MIRL
- EXISTING L-861E MEDIUM INTENSITY THRESHOLD LIGHT
- EXISTING L-852 IN-PAVEMENT TAXIWAY CENTERLINE LIGHT
- EXISTING L-867 SPLICE OR TRANSFORMER CAN
- EXISTING GUIDANCE SIGN
- EXISTING STORM OR SANITARY MANHOLE
- EXISTING UNDERDRAINS/STORM OR SANITARY SEWERS
- EXISTING CONDUIT OR DUCT BANK
- EXISTING ELECTRICAL CIRCUIT, CABLE IN UNIT DUCT
- PROPOSED LOCATION FOR RELOCATED OR NEW GUIDANCE SIGN
- PROPOSED LOCATION FOR RELOCATED OR NEW L-861T MITL (BLUE)
- PROPOSED LOCATION FOR RELOCATED OR NEW L-861 MIRL (WHITE / YELLOW)
- PROPOSED LOCATION FOR RELOCATED OR NEW L-861E THRESHOLD MIRL (RED / GREEN)
- PROPOSED L-867 SPLICE OR TRANSFORMER CAN
- PROPOSED CONDUIT OR DUCT BANK
- PROPOSED ELECTRICAL CIRCUIT, 1/C, #8, EPR CABLE IN 1" HDPE UNIT DUCT
- PROPOSED ELECTRICAL CIRCUIT, 2/C, #8, EPR CABLES IN 1-1/2" HDPE UNIT DUCT

NUMBERED LEGEND

- 1 PROPOSED LOCATION FOR RELOCATED OR NEW GUIDANCE SIGN. SEE SHEET 30 FOR MORE INFORMATION.
- 2 EXISTING VASI SYSTEM TO BE REPLACED. SEE SHEET 36 FOR MORE INFORMATION.
- 3 EXISTING GUIDANCE SIGN TO BE REMOVED. SEE SHEET 30 FOR MORE INFORMATION.
- 4 EXISTING FAA CONTROL CABLE TO BE RELOCATED. DO NOT DISTURB EXISTING CABLE UNTIL REPLACEMENT CABLE IS IN SERVICE. SEE SHEET 41 FOR MORE INFORMATION.
- 5 RELOCATE OR REMOVE EXISTING L-861T MITL UNITS OR SPLICE CANS. SUPPLY & INSTALL NEW GROUNDING ROD WITH EACH RELOCATION PER DETAIL. INCLUDE GROUNDING ROD & WIRE COSTS IN RELOCATION UNIT PRICE.
- 6 DISCONNECT EXTG. T-K CRT 1 CABLES & UNIT DUCTS AT THESE LOCATIONS. START / END PROPOSED T-K CRT 1 EXTENSION AT THESE LOCATIONS.
- 7 EXISTING FAA CABLES AND 6" RIGID STEEL CONDUIT UNDER T-L. INSTALL 6" RIGID STEEL TO PVC FITTING ON EXISTING CONDUIT. USE 6" SPLIT DUCT IN PROPOSED ONE WAY DUCT BANK TO EXTEND THE EXISTING CONDUIT TO A POINT THAT IS 5' BEYOND THE EDGE OF THE PROPOSED PAVEMENT. CONTROL CABLES TO REMAIN ACTIVE AND CONTINUOUS UNTIL REPLACED.
- 8 DISCONNECT EXTG. T-K CRT 1 CABLES & UNIT DUCTS AT THESE LOCATIONS. START / END PROPOSED T-K CRT 1 RELOCATION AT THESE LOCATIONS.

GENERAL NOTES:

- 1. SEE SHEET 33 FOR ELECTRICAL GENERAL NOTES.
- 2. SEE SHEETS 33-35 FOR ELECTRICAL DETAILS
- 3. SEE SHEET 30 FOR SIGN DETAILS.
- 4. ALL EXISTING ELECTRICAL CIRCUITS TO REMAIN ACTIVE AT ALL TIMES. CONTRACTOR TO PROVIDE, INSTALL, AND MAINTAIN TEMPORARY ABOVE GROUND JUMPER CABLES AS REQUIRED TO PROVIDE CIRCUIT CONTINUITY IN ALL CIRCUITS AT ALL TIMES DURING CONSTRUCTION. COSTS TO BE INCLUDED IN THE LIGHTING CONTRACT UNIT PRICES. LENGTH OF JUMPER CABLES SHALL NOT BE MEASURED FOR PAYMENT AND / OR PAYED FOR.

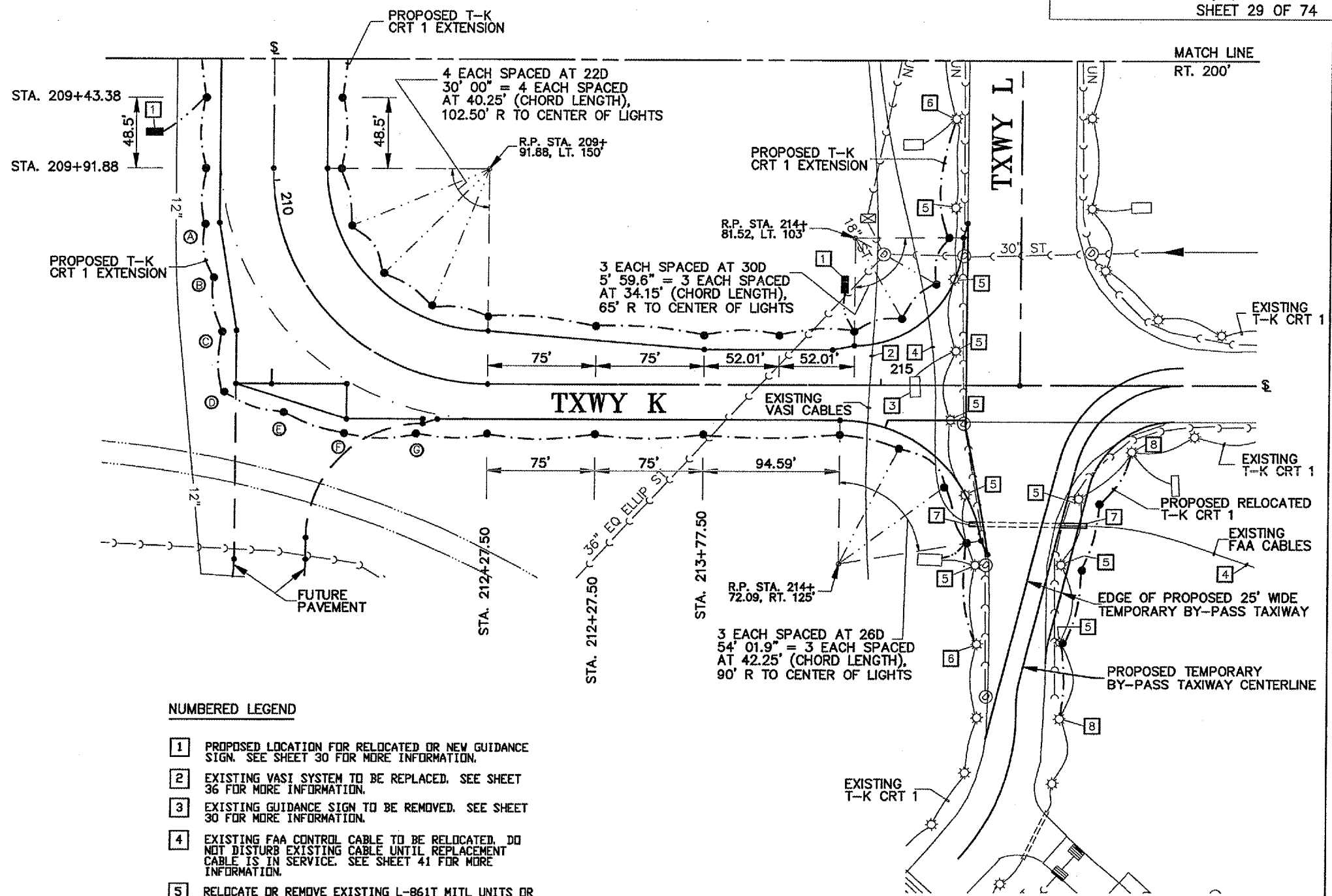

I:\Airport\A06T025 R5 EXTN, PVMT\LIGHTING.dwg, 5/8/2007 1:48:40 PM, zffm