

**GENERAL NOTES:**

- 1) "LEGEND" COLUMN IN TABLE (FOUND ON PAGE 32) INDICATES NUMBER OF PANELS (MODULES), SPECIFIC CHARACTERS PER PANEL AND BLANK PANELS. SIGNS ARE TO BE MANUFACTURED AND SUPPLIED AS SHOWN IN THE LEGEND COLUMN UNLESS OTHERWISE APPROVED BY THE MAA.
- 2) ALL SIGNS SHALL COMPLY WITH FAA ADVISORY CIRCULAR 150/5345-44E.
- 3) CONTRACTOR SHALL VERIFY ALL BASE DIMENSIONS WITH MANUFACTURER PRIOR TO INSTALLATION OF ANCHOR BOLTS.
- 4) THE CONTRACTOR SHALL DISASSEMBLE EXISTING GUIDANCE SIGNS AS REQUIRED TO INSTALL PROPOSED NEW SIGN PANELS AND REUSE EXISTING PANELS AS INDICATED IN TABLE. EXISTING PANELS REMOVED MAY ONLY BE REUSED, IF THE CONDITION OF THE PANEL IS ACCEPTABLE TO THE MAA AND THE RESIDENT ENGINEER. THE CONTRACTOR SHALL REPLACE ALL DAMAGED EXISTING PANELS AND EQUIPMENT AS REQUIRED BY THE RESIDENT ENGINEER. ONCE THE SIGNS HAVE BEEN REBUILT, THE CONTRACTOR SHALL SEAL SIGNS AND RETURN THE EXISTING SIGNS TO THEIR ORIGINAL CONDITION. EXISTING PANELS REMOVED AND NOT REUSED SHALL BE DELIVERED BY THE CONTRACTOR TO THE OWNER (MAA).
- 5) SIGNS SHALL BE DOUBLE FACED AS INDICATED IN TABLE (TYPE L-858Y, L-858R, OR L-969L). SIGNS AND REPLACEMENT PANELS SHALL BE COMPATIBLE IN ALL RESPECTS WITH EACH OTHER AND WITH THE EXISTING SIGNS CURRENTLY IN PLACE AT THE QUAD CITY INTERNATIONAL AIRPORT. SIGNS AND REPLACEMENT PANELS SHALL BE LUMACURVE, OR APPROVED EQUAL.
- 6) "FACE" COLUMN INDICATES DIRECTION OF SIGN FACE.
- 7) SEE SHEET 33 - 35 FOR ELECTRICAL GENERAL NOTES AND ELECTRICAL DETAILS.
- 8) SEE SHEET 34 FOR SIGN DETAILS.
- 9) WHERE PROPOSED SIGNS ARE INSTALLED BESIDE EXISTING SIGNS PROVIDE 1' SPACE BETWEEN SIGNS.

**LEGEND:**

- ⊛ EXISTING EDGE LIGHT
- ▭ EXISTING GUIDANCE SIGN
- (23-9) EXISTING SIGN NUMBER AT EXISTING SIGN LOCATION
- (23-10) EXISTING SIGN NUMBER AT RELOCATED SIGN LOCATION
- ▬ PROPOSED LOCATION FOR RELOCATED OR NEW GUIDANCE SIGN
- [K1] PROPOSED SIGN NUMBER

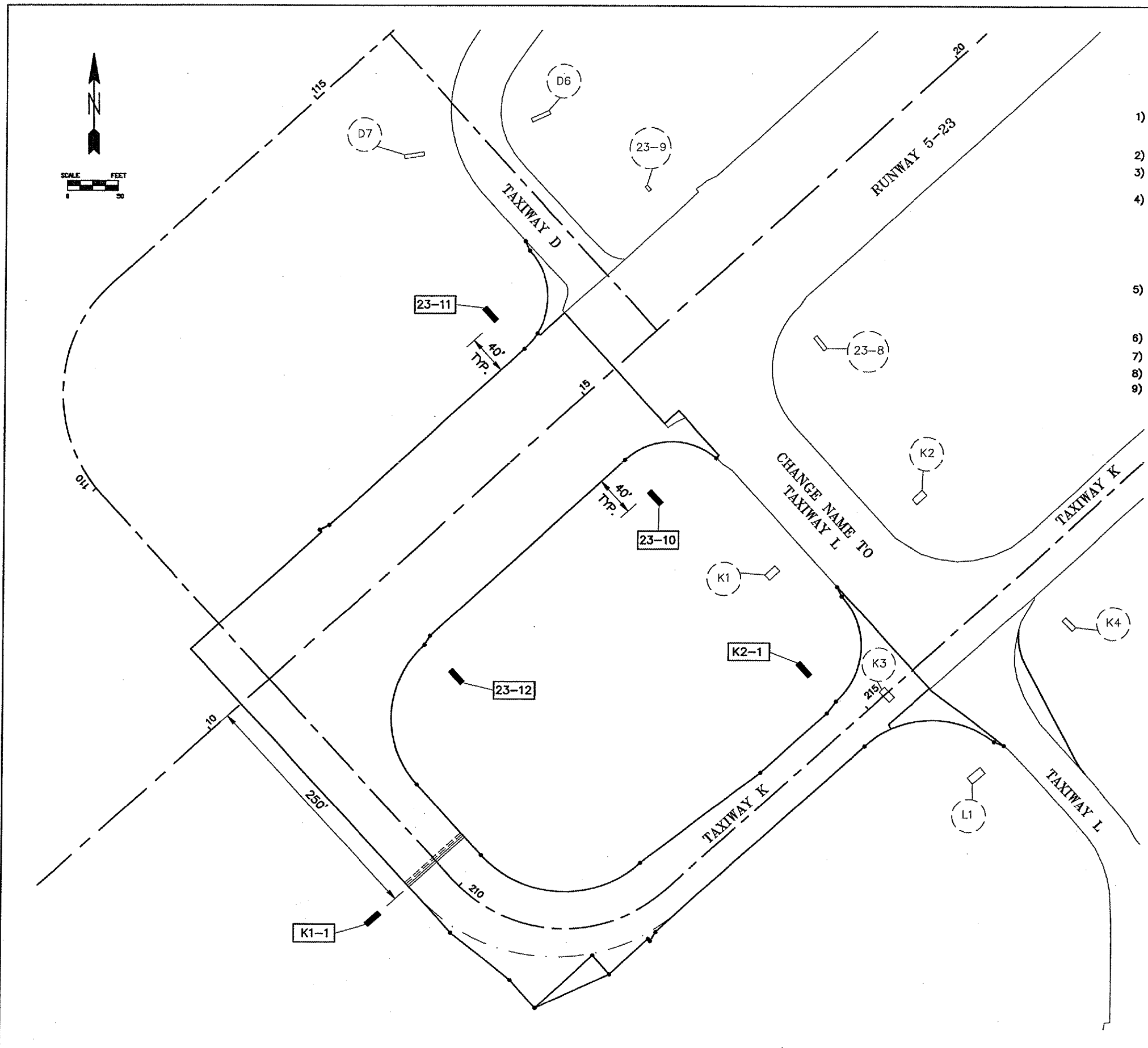

G:\AIRPORT\A06T025 RS EXTN, PAVT\SIGNS1.DWG, 5/8/2007 1:40:47 PM, ifm