

**CURVE INFORMATION CURVE #3**  
 PI = 13+54.32  
 Δ = 22°35'13" (RT.)  
 D = 20'50'05"  
 R = 275.00'  
 T = 54.92'  
 L = 108.41'  
 E = 5.43'  
 e = NC  
 PC = 12+99.41  
 PT = 14+07.82

# ENTRANCE ROAD

IL. PROJ: MLI-3673 AIP PROJ: 3-17-0068-XX

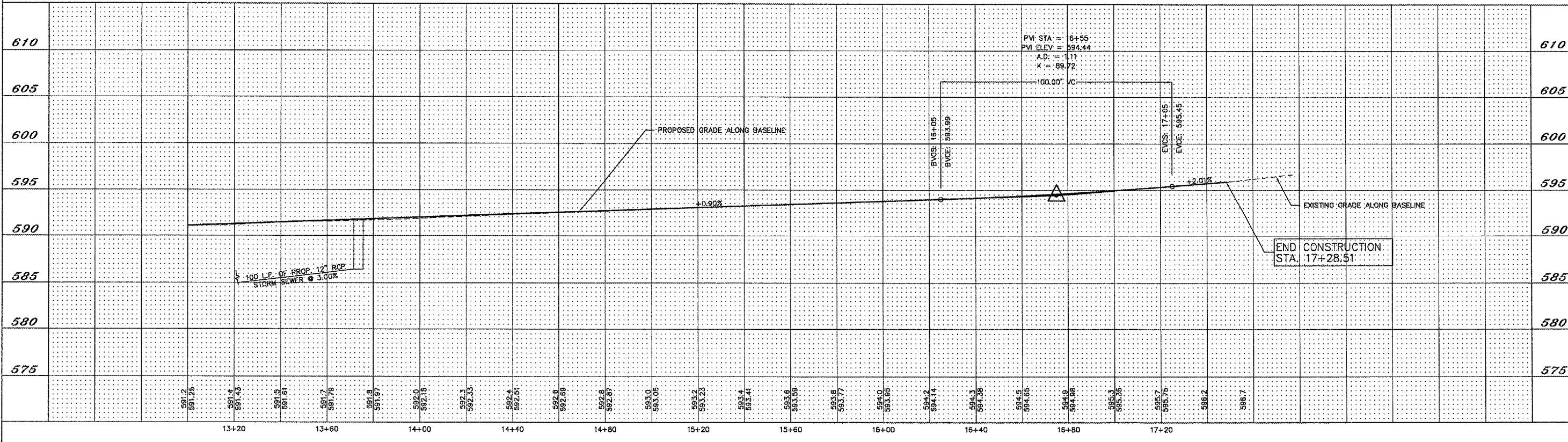

**QUAD CITY INTERNATIONAL AIRPORT**  
 Moline, IL

REVISIONS		
NO.	ITEM	DATE

PLOTTING SCALE: 1" = 20'  
 DRAWN BY: BH/DU  
 CHECKED BY: SAS  
 DATE: APRIL 2007

4700 Kennedy Drive  
 (309) 752-3350  
 Design Firm License: Illinois 184-000815  
 Copyright 2007 By McClure Engineering Associates, Inc.

**PLAN & PROFILE-STA. 13+00-STA. 17+40**  
 ENTRANCE ROAD RELOCATION  
 AND PARKING LOT EXPANSION  
 Moline, Illinois  
 FILE NAME: T:\M0107.001\DWG\07001.mcd.dwg  
 JOB NUMBER: 01-29-07-001

SHEET NO.  
**13**  
 OF 41