

| TREE REMOVAL |        |      |
|--------------|--------|------|
| STA.         | OFFSET | SIZE |
| 37+35 RT     | 15'    | 24"  |
| 37+76 LT     | 33'    | 36"  |
| 37+80 LT     | 32'    | 12"  |
| 37+94 LT     | 55'    | 12"  |
| 38+08 LT     | 33'    | 24"  |
| 38+23 LT     | 37'    | 12"  |
| 38+75 RT     | 15'    | 60"  |

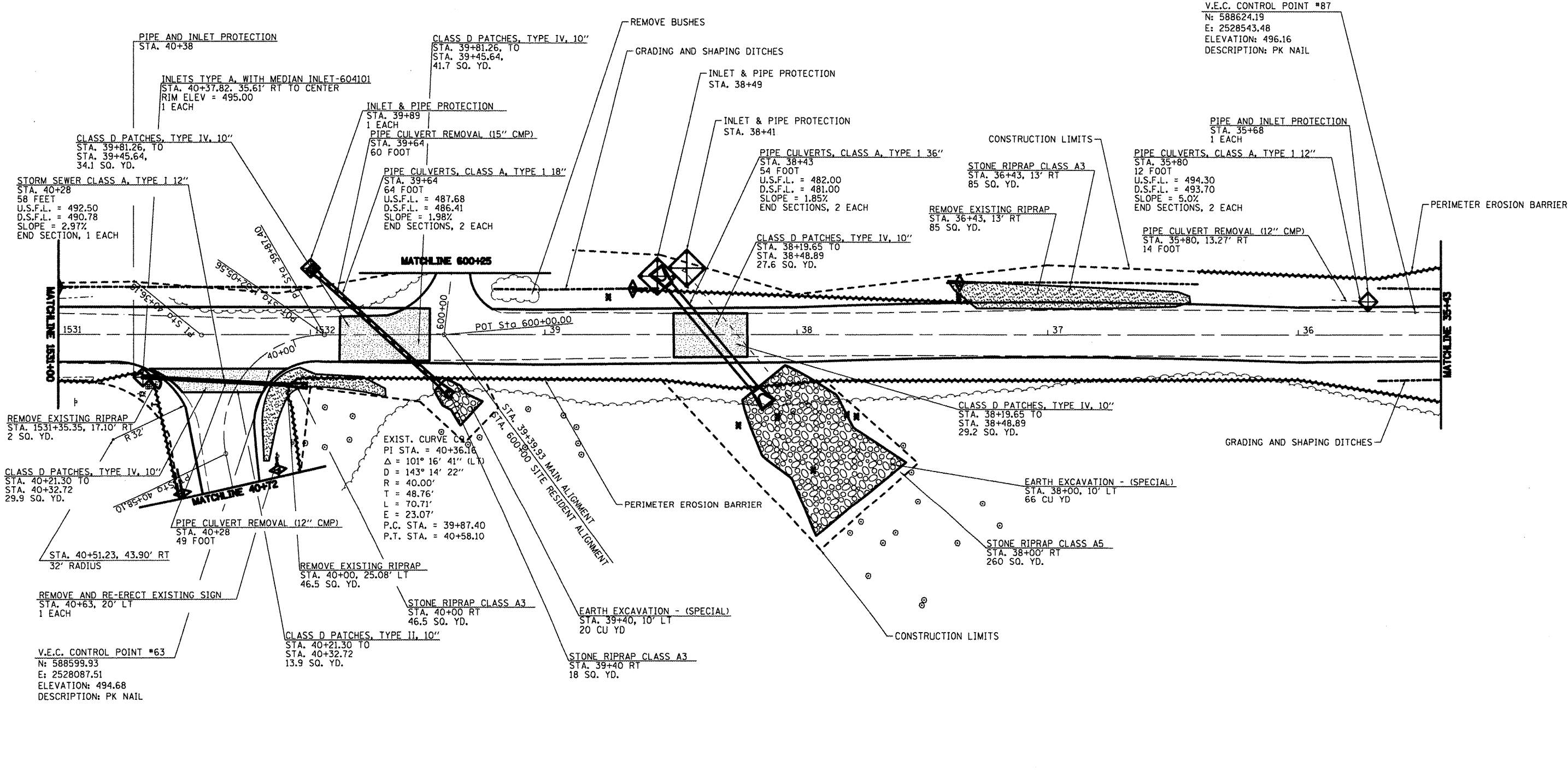

| TEMPORARY DITCH CHECKS |      |  |
|------------------------|------|--|
| STA.                   | L.F. |  |
| RT 37+35               | 6    |  |
| RT 38+65               | 6    |  |
| LT 40+70               | 6    |  |
| RT 40+70               | 6    |  |

| GRADING AND SHAPING DITCHES |      |  |
|-----------------------------|------|--|
| STA.                        | L.F. |  |
| RT 35+43 - RT 35+68         | 25   |  |
| RT 36+40 - RT 37+40         | 100  |  |
| RT 38+55 - RT 39+20         | 65   |  |
| LT 40+60 - LT 40+72         | 12   |  |
| RT 40+60 - RT 40+72         | 12   |  |
| LT 1531+00 - LT 1532+00     | 100  |  |

| PERIMETER EROSION BARRIER |      |  |
|---------------------------|------|--|
| STA.                      | L.F. |  |
| LT 35+43 - LT 40+72       | 529  |  |
| RT 35+92 - RT 36+50       | 58   |  |
| RT 37+30 - RT 38+65       | 135  |  |
| RT 40+72 - RT 1531+00     | 90   |  |

- TEMPORARY DITCH CHECK
- INLET AND PIPE PROTECTION
- PROPOSED RIPRAP
- PERIMETER EROSION CONTROL
- PAVEMENT PATCHING

|             |                      |                   |           |
|-------------|----------------------|-------------------|-----------|
| FILE NAME = | USER NAME = *USER*   | DESIGNED - R.H.D. | REVISED - |
| #FILE#      |                      | DRAWN - J.T.T.    | REVISED - |
|             | PLOT SCALE = *SCALE* | CHECKED - R.H.D.  | REVISED - |
|             | PLOT DATE = *DATE*   | DATE - 4/4/12     | REVISED - |

**STATE OF ILLINOIS  
DEPARTMENT OF TRANSPORTATION**

**WASHINGTON COUNTY CONSERVATION AREA  
MAIN ALIGNMENT**

SCALE: 1" = 20'    SHEET NO. 22 OF 112 SHEETS    STA. 35+43 TO STA. 40+72

|                            |            |                    |           |
|----------------------------|------------|--------------------|-----------|
| SECTION                    | COUNTY     | TOTAL SHEETS       | SHEET NO. |
|                            | WASHINGTON | 112                | 22        |
|                            |            | CONTRACT NO. 46223 |           |
| ILLINOIS PROJ. AND PROJECT |            |                    |           |

JOB NO. 200-061-4 VASCONCELES ENGINEERING CORP. DESIGN FIRM REGISTRATION NUMBER 184-00207