

TREE REMOVAL		
STA.	OFFSET	SIZE
122+07 LT	33'	24"
123+60 RT	13'	12"

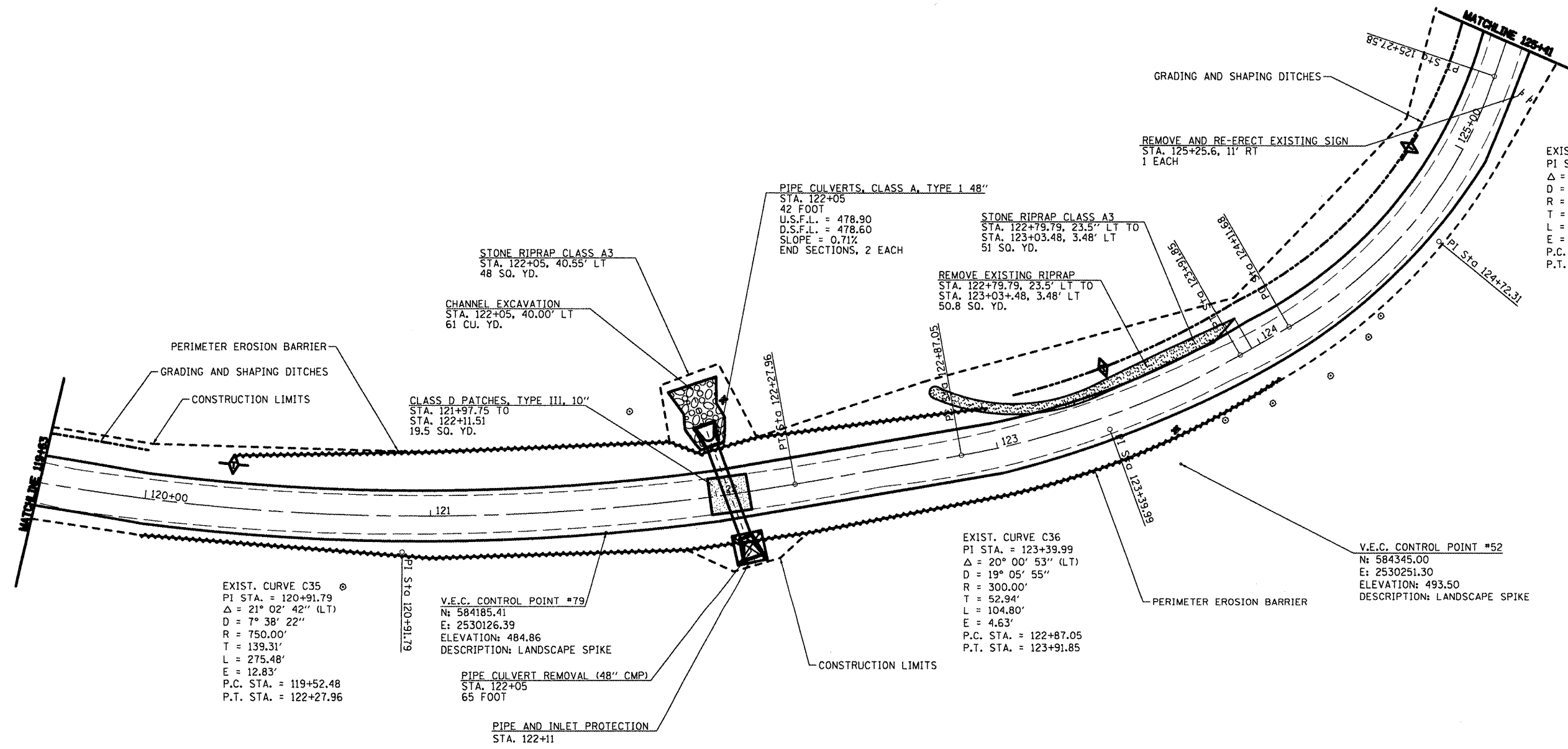

EXIST. CURVE C37
 PI STA. = 124+72.31
 $\Delta = 41^\circ 30' 11''$ (LT)
 $D = 35^\circ 48' 36''$
 $R = 160.00'$
 $T = 60.62'$
 $L = 115.90'$
 $E = 11.10'$
 P.C. STA. = 124+11.68
 P.T. STA. = 125+27.58

EXIST. CURVE C36
 PI STA. = 123+39.99
 $\Delta = 20^\circ 00' 53''$ (LT)
 $D = 19^\circ 05' 55''$
 $R = 300.00'$
 $T = 52.94'$
 $L = 104.80'$
 $E = 4.63'$
 P.C. STA. = 122+87.05
 P.T. STA. = 123+91.85

EXIST. CURVE C35
 PI STA. = 120+91.79
 $\Delta = 21^\circ 02' 42''$ (LT)
 $D = 7^\circ 38' 22''$
 $R = 750.00'$
 $T = 139.31'$
 $L = 275.48'$
 $E = 12.83'$
 P.C. STA. = 119+52.48
 P.T. STA. = 122+27.96

- TEMPORARY DITCH CHECK
- INLET AND PIPE PROTECTION
- PERIMETER EROSION CONTROL
- PROPOSED RIPRAP
- PAVEMENT PATCHING

TEMPORARY DITCH CHECKS		GRADING AND SHAPING DITCHES		PERIMETER EROSION BARRIER	
STA.	L.F.	STA.	L.F.	STA.	L.F.
LT 120+30	6	LT 119+63 - LT 120+00	37	RT 120+00 - RT 124+00	40
LT 123+95	6	LT 123+10 - LT 125+41	231	LT 120+50 - LT 123+00	270
LT 124+90	6				

FILE NAME =	USER NAME = #USER#	DESIGNED - R.H.D.	REVISED -
#FILE#		DRAWN - J.T.T.	REVISED -
		CHECKED - R.H.D.	REVISED -
		DATE - 4/4/12	REVISED -

STATE OF ILLINOIS
DEPARTMENT OF TRANSPORTATION

WASHINGTON COUNTY CONSERVATION AREA
MAIN ALIGNMENT

SCALE: 1" = 20' SHEET NO. 37 OF 112 SHEETS STA. 119+63 TO STA. 125+41

SECTION	COUNTY	TOTAL SHEETS	SHEET NO.
	WASHINGTON	112	37
		CONTRACT NO. 46223	

JOB NO. 200-064-W VASCONEVELLES ENGINEERING CORP. DESIGN FIRM REGISTRATION NUMBER 104-002007