

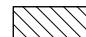

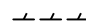

REMOVAL LEGEND

-  HMA SURFACE REMOVAL, 2 3/4"
-  REMOVAL LIMITS
-  STRUCTURE TO BE ADJUSTED
-  PIPE TO BE REMOVED
-  TREE REMOVAL
-  SOIL BORING/
PAVEMENT CORE

SHEET LOCATION MAP

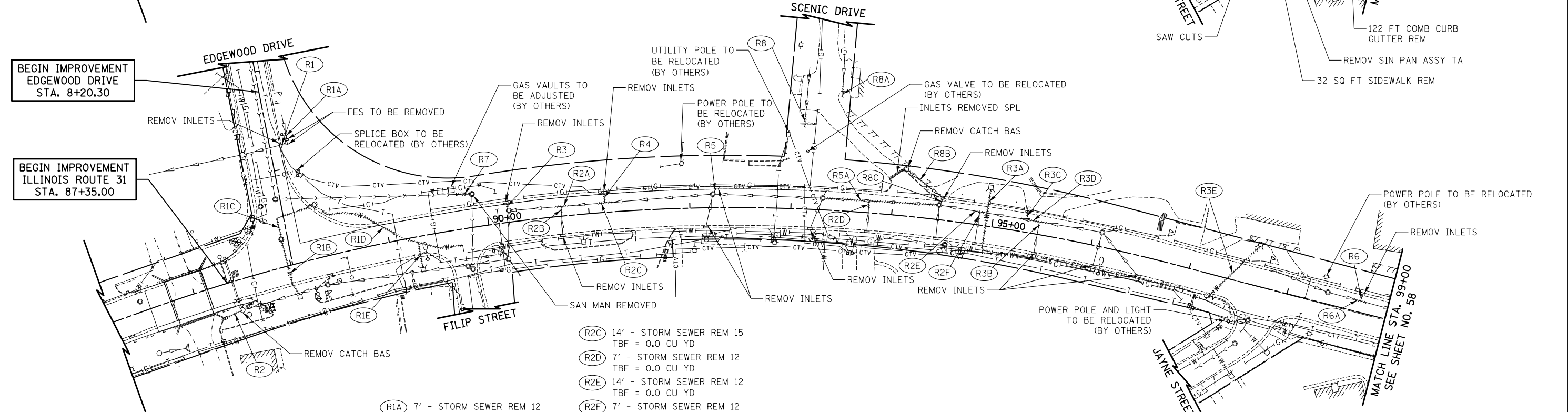
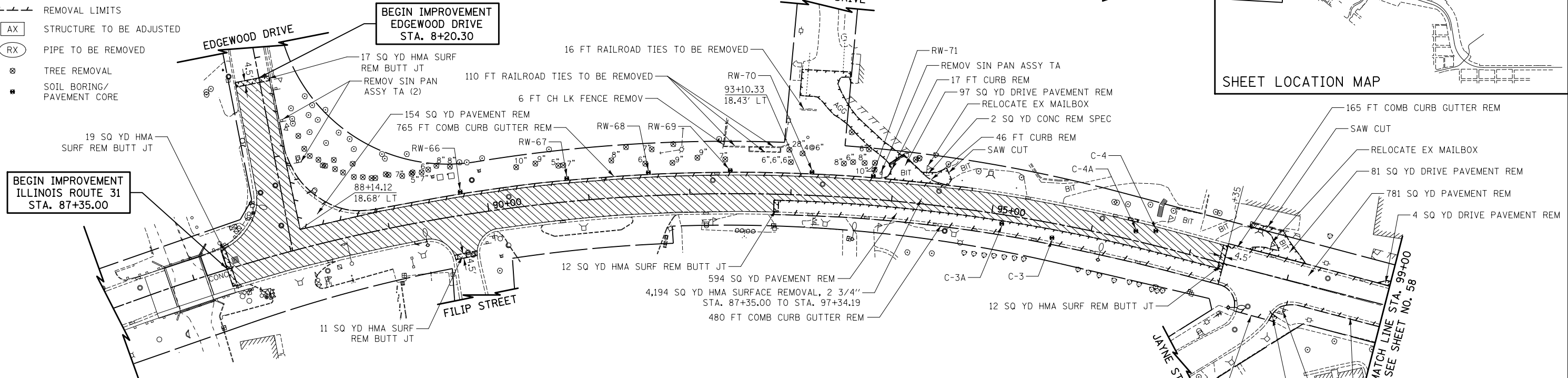
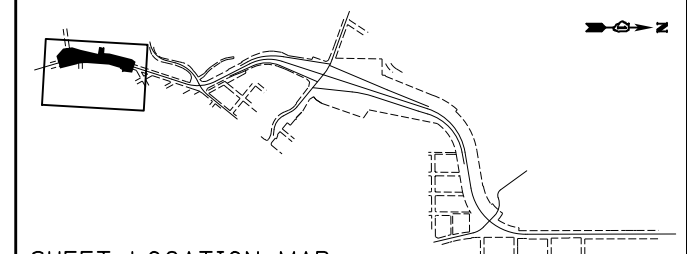

- (R1) 5' - STORM SEWER REM 12
TBF = 0.0 CU YD
- (R2) 19' - STORM SEWER REM 12
TBF = 0.0 CU YD
- (R3) 6' - STORM SEWER REM 12
TBF = 0.0 CU YD
- (R4) 10' - STORM SEWER REM 12
TBF = 0.0 CU YD
- (R5) 5' - STORM SEWER REM 12
TBF = 0.0 CU YD
- (R5A) 112' - STORM SEWER REM 12
TBF = 0.0 CU YD
- (R6) 7' - STORM SEWER REM 12
TBF = 0.0 CU YD
- (R7) 13' SAN SEW REMOV 21
TBF = 0.0 CU YD
- (R8) 13' - PIPE CULVERT REMOV
TBF = 0.0 CU YD
- (R8A) 11' - PIPE CULVERT REMOV
TBF = 0.0 CU YD
- (R8B) 44' - STORM SEWER REM 12
TBF = 0.0 CU YD
- (R8C) 4' - STORM SEWER REM 12
TBF = 0.0 CU YD
- (R1A) 7' - STORM SEWER REM 12
TBF = 0.0 CU YD
- (R1B) 56' - WATER MAIN REMOV 8
TBF = 0.0 CU YD
- (R1C) 56' - WATER MAIN REMOV 8
TBF = 0.0 CU YD
- (R1D) 156' - WATER MAIN REMOV 8
TBF = 0.0 CU YD
- (R1E) 25' - WATER MAIN REMOV 8
TBF = 0.0 CU YD
- (R2A) 14' - STORM SEWER REM 15
TBF = 0.0 CU YD
- (R2B) 7' - STORM SEWER REM 12
TBF = 0.0 CU YD
- (R2C) 14' - STORM SEWER REM 15
TBF = 0.0 CU YD
- (R2D) 7' - STORM SEWER REM 12
TBF = 0.0 CU YD
- (R2E) 14' - STORM SEWER REM 12
TBF = 0.0 CU YD
- (R2F) 7' - STORM SEWER REM 12
TBF = 0.0 CU YD
- (R3A) 61' - WATER SERVICE REMOVAL
TBF = 0.0 CU YD
- (R3B) 7' - STORM SEWER REM 12
TBF = 0.0 CU YD
- (R3C) 7' - STORM SEWER REM 12
TBF = 0.0 CU YD
- (R3D) 27' - STORM SEWER REM 12
TBF = 0.0 CU YD
- (R3E) 76' - WATER SERVICE REMOVAL
TBF = 0.0 CU YD
- (R6A) 14' - STORM SEWER REM 12
TBF = 0.0 CU YD

NOTES

- THE REMOVAL OF END SECTIONS SHALL BE PAID FOR AS "STORM SEWER REMOVAL".
- TRAFFIC SIGNALS TO BE REMOVED ARE CALLED OFF IN THE TRAFFIC SIGNAL PLANS.
- LIGHTING STRUCTURES TO BE REMOVED ARE CALLED OFF IN THE LIGHTING PLANS.

ILLINOIS ROUTE 31
EDGEWOOD DRIVE

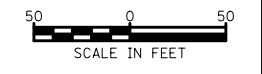

FILE NAME = ...\\D160F72-sht-rem-01.dgn	USER NAME = ctb	DESIGNED - CTB	REVISED -	STATE OF ILLINOIS DEPARTMENT OF TRANSPORTATION	REMOVAL PLAN			O.R. RTE.	SECTION	COUNTY	TOTAL SHEETS	SHEET NO.	
		DRAWN - ARA	REVISED -		SCALE: 1" = 50'	SHEET NO. 1 OF 13 SHEETS	STA. 87+35	TO STA. 99+00	0003	18A-2	MCHENRY	825	57
		CHECKED - GAB	REVISED -		CONTRACT NO. 60F72								
		DATE - 5/3/2012	REVISED -		FED. ROAD DIST. NO. 1 ILLINOIS FED. AID PROJECT								