

SHEET LOCATION MAP

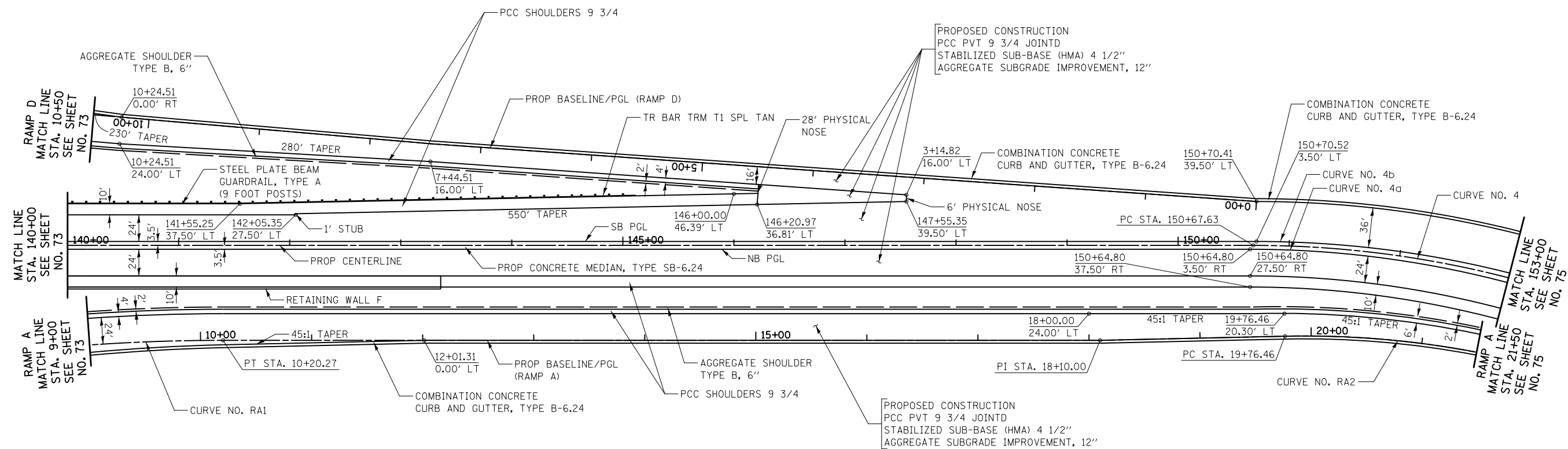

RAMP A
E/P OFFSETS IN 45:1 TAPER

STA	OFFSET	STA	OFFSET
9+00	6.70' RT	10+75	2.81' RT
9+25	6.14' RT	11+00	2.25' RT
9+50	5.58' RT	11+25	1.70' RT
9+75	5.03' RT	11+50	1.14' RT
10+00	4.47' RT	11+75	0.58' RT
10+25	3.92' RT	12+00	0.03' RT
10+50	3.36' RT		

RAMP A E/P OFFSETS
IN 45:1 TAPER

STA	OFFSET
20+00	19.78' LT
20+25	19.22' LT
20+50	18.67' LT
20+75	18.11' LT
21+00	17.56' LT
21+25	17.00' LT
21+50	16.44' LT

PROP CURVE NO. 4a
 $\Delta = 62^\circ 30' 28''$
 $R = 911.00'$
 $T = 552.89'$
 $L = 993.87'$
 $E = 154.65'$
 P.C. STA. = 150+64.80, 3.50' RT
 P.T. STA. = 160+65.08, 8.98' RT

PROP CURVE NO. 4b
 $\Delta = 62^\circ 30' 28''$
 $R = 929.00'$
 $T = 563.82'$
 $L = 1,013.51'$
 $E = 157.71'$
 P.C. STA. = 150+70.52, 3.50' LT
 P.T. STA. = 160+77.55, 9.00' LT

PROP. CURVE NO. 4
 PI STA. = 156+26.02
 $\Delta = 62^\circ 30' 28''$ (RT)
 $D = 6^\circ 13' 39''$
 $R = 920.06'$
 $T = 558.39'$
 $L = 1,003.75'$
 $E = 156.19'$
 $e = 4.00\%$
 P.C. STA. = 150+67.63
 P.T. STA. = 160+71.38

ILLINOIS ROUTE 31
 RAMP A
 RAMP D



FILE NAME = ... \D160F72-shr-pln-05.dgn	USER NAME = ctb	DESIGNED - CTB	REVISED -
		DRAWN - ARA	REVISED -
		CHECKED - GAB	REVISED -
		DATE - 5/3/2012	REVISED -

STATE OF ILLINOIS
 DEPARTMENT OF TRANSPORTATION

SCALE: 1" = 50'		SHEET NO. 5 OF 15 SHEETS		STA. 140+00 TO STA. 153+00	
-----------------	--	--------------------------	--	----------------------------	--

O.R. RTE.	SECTION	COUNTY	TOTAL SHEETS	SHEET NO.
0003	18A-2	MCHENRY	825	74
CONTRACT NO. 60F72				
FED. ROAD DIST. NO. 1 ILLINOIS FED. AID PROJECT				