

PROPOSED RECONSTRUCTION  
HOT-MIX ASPHALT PAVEMENT (FULL-DEPTH), 8 1/4"  
AGGREGATE SUBGRADE IMPROVEMENT, 12"

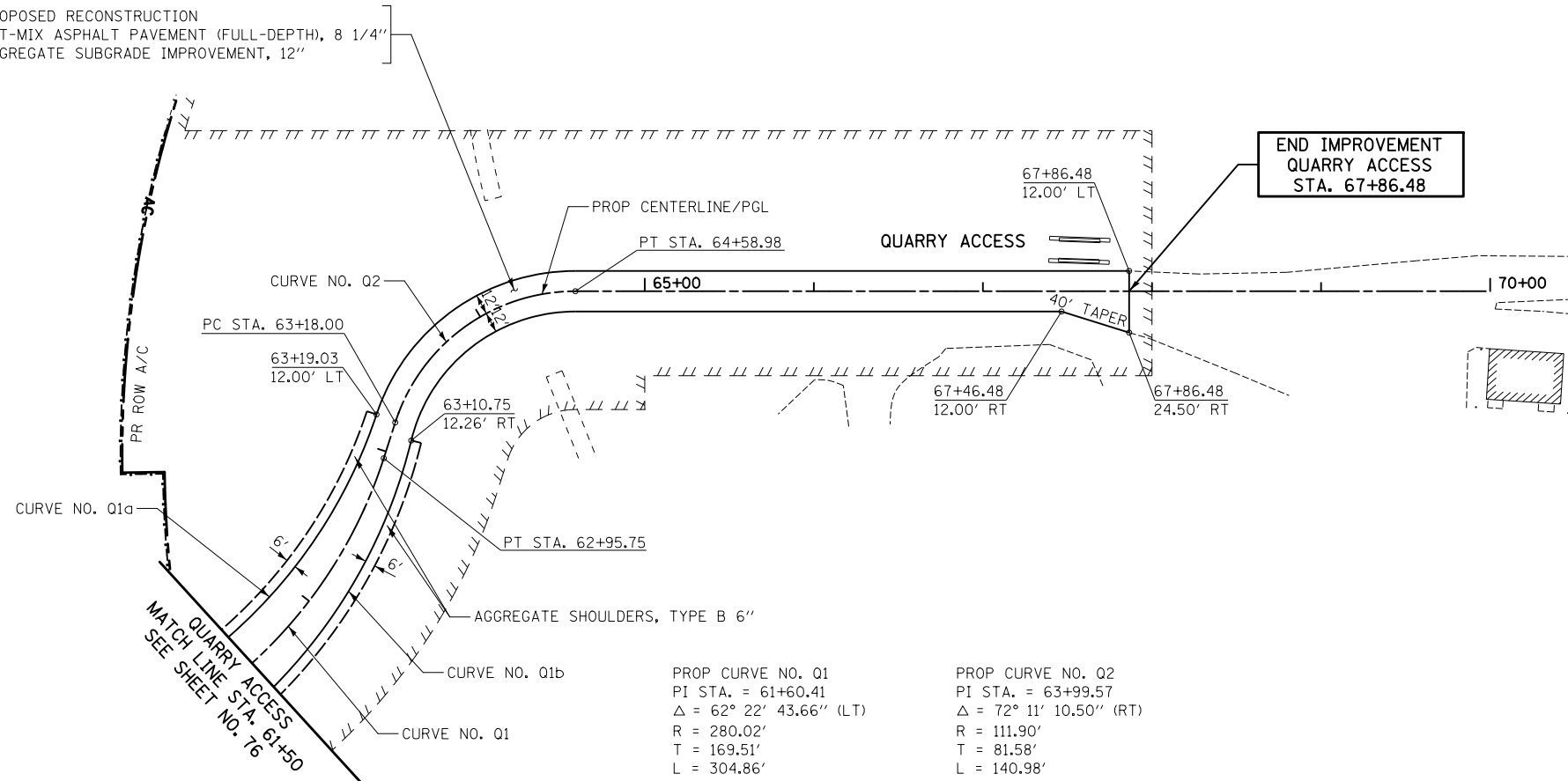

PROP CURVE NO. Q1  
PI STA. = 61+60.41  
 $\Delta = 62^\circ 22' 43.66''$  (LT)  
R = 280.02'  
T = 169.51'  
L = 304.86'  
E = 47.31'  
e = N.C.  
P.C. STA. = 59+90.89  
P.T. STA. = 62+95.75

PROP CURVE NO. Q2  
PI STA. = 63+99.57  
 $\Delta = 72^\circ 11' 10.50''$  (RT)  
R = 111.90'  
T = 81.58'  
L = 140.98'  
E = 26.58'  
e = N.C.  
P.C. STA. = 63+18.00  
P.T. STA. = 64.58.98

PROP CURVE NO. Q1a  
 $\Delta = 61^\circ 51' 07''$   
R = 300.00'  
T = 179.73'  
L = 323.86'  
E = 49.72'  
P.C. STA. = 59+74.69, 18.00' LT  
P.T. STA. = 63+19.03, 12.00' LT

PROP CURVE NO. Q1b  
 $\Delta = 58^\circ 47' 50''$   
R = 312.00'  
T = 175.79'  
L = 320.18'  
E = 46.12'  
P.C. STA. = 60+10.69, 27.92' RT  
P.T. STA. = 63+10.75, 12.26' RT



QUARRY ACCESS

FILE NAME = ... \D160F72-sht-pln-13.dgn	USER NAME = ctb	DESIGNED - CTB	REVISED -	<b>STATE OF ILLINOIS DEPARTMENT OF TRANSPORTATION</b>	<b>PLAN</b>	O.R. RTE. 0003	SECTION 18A-2	COUNTY MCHENRY	TOTAL SHEETS 825	SHEET NO. 82
	PLOT SCALE = 100.0000' / in.	CHECKED - GAB	REVISED -			SCALE: 1" = 50'	SHEET NO. 14 OF 15 SHEETS	STA. 61+50 TO STA. 67+86.48	<b>CONTRACT NO. 60F72</b>	
PLOT DATE = 5/2/2012	DATE = 5/3/2012	DATE = 5/3/2012	REVISED -	FED. ROAD DIST. NO. 1   ILLINOIS FED. AID PROJECT						