

<b>IL RTE. 31 MAINLINE</b>	<b>IL RTE. 31 MAINLINE</b>	<b>IL RTE. 31 MAINLINE</b>	<b>IL RTE. 31 MAINLINE</b>
209 STA. 113+87.50, 30.0' RT CB TA 4 DIA T24F&G RIM = 750.66 INV = 746.66 (NW) INV = 746.66 (SW)	217 STA. 112+50.00, 42.0' LT CB TA 4 DIA T24F&G RIM = 748.21 INV = 743.60 (NW) INV = 743.60 (SW) INV = 743.60 (S)	301 STA. 121+49.54, 31.3' LT CB TC T1F OL RIM = 763.00 INV = 759.00 (E)	304 STA. 118+30.00, 61.3' LT CB TC T8G RIM = 755.13 INV = 752.11 (NE)
210 STA. 114+75.00, 30.0' RT CB TC T24F&G RIM = 751.48 INV = 747.48 (SE)	219 STA. 113+87.50, 53.5' LT CB TA 4 DIA T8G RIM = 749.03 INV = 745.25 (NE)	302 STA. 116+00.00, 32.6' RT CB TA 4 DIA T24F&G RIM = 753.24 INV = 749.50 (NW) INV = 749.50 (SW) INV = 749.74 (4" S)	305 STA. 118+30.00, 45.2' RT CB TA 5 DIA T24F&G RIM = 756.34 INV = 748.65 (N) INV = 748.65 (SE) INV = 749.34 (SW) INV = 752.84 (4" S)
216 STA. 113+87.50, 42.0' LT CB TA 4 DIA T24F&G RIM = 749.79 INV = 745.20 (NE) INV = 745.20 (SE) INV = 745.20 (SW) INV = 746.29 (4" E)	220 STA. 112+50.00, 53.6' LT CB TA 4 DIA T8G RIM = 747.56 INV = 743.64 (E)	303 STA. 119+06.00, 94.6' RT PRC FLAR END SEC 24 W/GRATING INV = 748.50 (S)	

<b>RAMP C</b>	
322 STA. 7+32.50, 39.0' LT CB TC T8G RIM = 764.90 INV = 759.90 (W)	554 STA. 7+06.00, 27.0' RT MH TA 5 DIA T1F CL RIM = 760.00 INV = 748.00 (N) INV = 750.00 (NE) INV = 748.00 (W) INV = 748.00 (SW)
359 STA. 7+06.00, 3.0' RT MH TA 4 DIA T1F CL RIM = 766.19 INV = 756.19 (E) INV = 756.19 (N) INV = 754.19 (W)	322 47'-STORM SEW CL A 2, 12" @ 7.89% TBF=22.3 CU YD
552 STA. 7+10.00, 56.0' RT CB TC T8G RIM = 752.00 INV = 748.13 (W)	359 20'-STORM SEW CL A 3, 12" @ 20.95% TBF=7.8 CU YD
553 STA. 8+86.00, 65.0' RT CB TA 4 DIA T8G RIM = 752.90 INV = 748.90 (NE)	552 26'-STORM SEW CL A 2, 12" @ 0.50% TBF=0.0 CU YD
	553 184'-STORM SEW CL A 2, 12" @ 0.49% TBF=0.0 CU YD

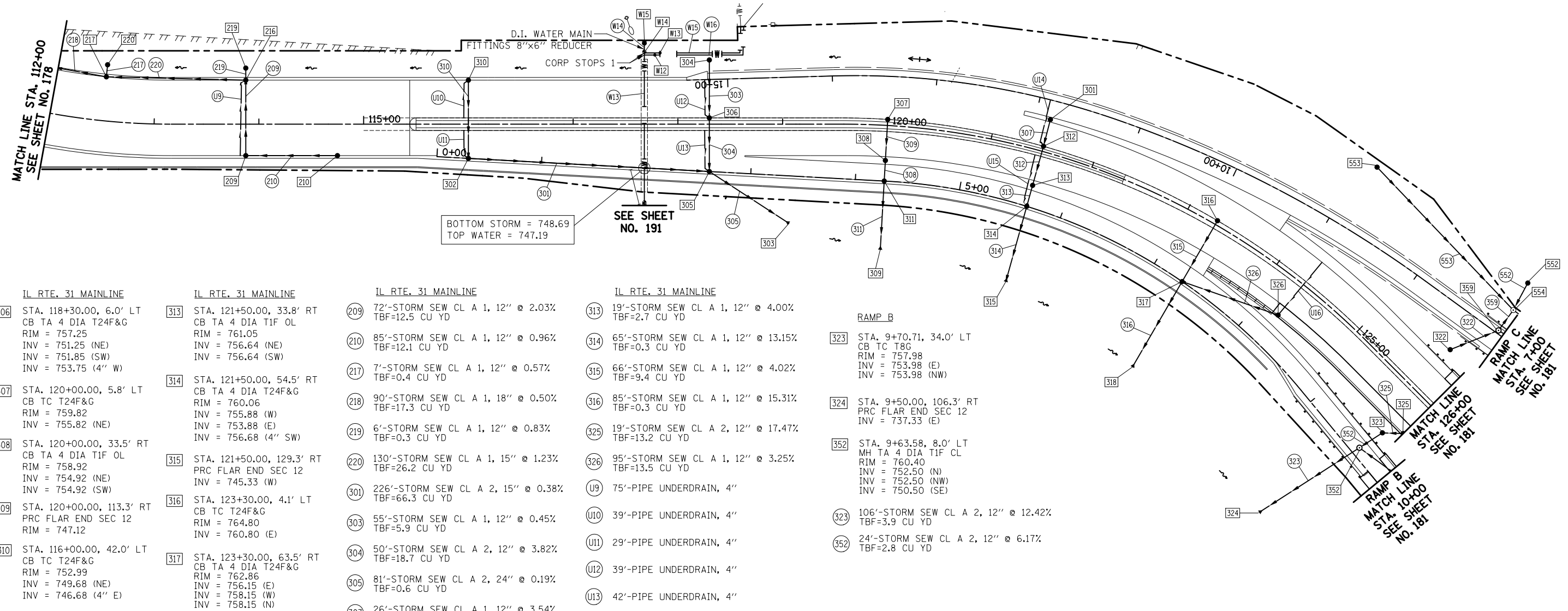

<b>IL RTE. 31 MAINLINE</b>	<b>IL RTE. 31 MAINLINE</b>	<b>IL RTE. 31 MAINLINE</b>	<b>IL RTE. 31 MAINLINE</b>
306 STA. 118+30.00, 6.0' LT CB TA 4 DIA T24F&G RIM = 757.25 INV = 751.25 (NE) INV = 751.85 (SW) INV = 753.75 (4" W)	313 STA. 121+50.00, 33.8' RT CB TA 4 DIA T1F OL RIM = 761.05 INV = 756.64 (NE) INV = 756.64 (SW)	209 72'-STORM SEW CL A 1, 12" @ 2.03% TBF=12.5 CU YD	313 19'-STORM SEW CL A 1, 12" @ 4.00% TBF=2.7 CU YD
307 STA. 120+00.00, 5.8' LT CB TC T24F&G RIM = 759.82 INV = 755.82 (NE)	314 STA. 121+50.00, 54.5' RT CB TA 4 DIA T24F&G RIM = 760.06 INV = 755.88 (W) INV = 753.88 (E) INV = 756.68 (4" SW)	210 85'-STORM SEW CL A 1, 12" @ 0.96% TBF=12.1 CU YD	314 65'-STORM SEW CL A 1, 12" @ 13.15% TBF=0.3 CU YD
308 STA. 120+00.00, 33.5' RT CB TA 4 DIA T1F OL RIM = 758.92 INV = 754.92 (NE) INV = 754.92 (SW)	315 STA. 121+50.00, 129.3' RT PRC FLAR END SEC 12 INV = 745.33 (W)	217 7'-STORM SEW CL A 1, 12" @ 0.57% TBF=0.4 CU YD	315 66'-STORM SEW CL A 1, 12" @ 4.02% TBF=9.4 CU YD
309 STA. 120+00.00, 113.3' RT PRC FLAR END SEC 12 RIM = 747.12	316 STA. 123+30.00, 4.1' LT CB TC T24F&G RIM = 764.80 INV = 760.80 (E)	218 90'-STORM SEW CL A 1, 18" @ 0.50% TBF=17.3 CU YD	316 85'-STORM SEW CL A 1, 12" @ 15.31% TBF=0.3 CU YD
310 STA. 116+00.00, 42.0' LT CB TC T24F&G RIM = 752.99 INV = 749.68 (NE) INV = 746.68 (4" E)	317 STA. 123+30.00, 63.5' RT CB TA 4 DIA T24F&G RIM = 762.86 INV = 756.15 (E) INV = 758.15 (W) INV = 758.15 (N)	219 6'-STORM SEW CL A 1, 12" @ 0.83% TBF=0.3 CU YD	325 19'-STORM SEW CL A 2, 12" @ 17.47% TBF=13.2 CU YD
311 STA. 120+00.00, 53.1' RT CB TA 4 DIA T24F&G RIM = 758.35 INV = 754.55 (SW) INV = 752.55 (NE)	318 STA. 123+30.00, 157.4' RT PRC FLAR END SEC 12 INV = 743.14 (W)	220 130'-STORM SEW CL A 1, 15" @ 1.23% TBF=26.2 CU YD	326 95'-STORM SEW CL A 1, 12" @ 3.25% TBF=13.5 CU YD
312 STA. 121+50.00, 5.0' LT CB TA 4 DIA T24F&G RIM = 761.96 INV = 758.08 (NE) INV = 758.08 (SW) INV = 758.58 (4" S)	325 STA. 126+00.00, 37.5' RT CB TA 4 DIA T20F&G RIM = 767.73 INV = 757.30 (SE)	301 226'-STORM SEW CL A 2, 15" @ 0.38% TBF=66.3 CU YD	U9 75'-PIPE UNDERDRAIN, 4"
	326 STA. 124+31.00, 37.8' RT CB TA 4 DIA T20F&G RIM = 765.18 INV = 761.24 (SE) INV = 761.68 (4" W)	303 55'-STORM SEW CL A 1, 12" @ 0.45% TBF=5.9 CU YD	U10 39'-PIPE UNDERDRAIN, 4"
		304 50'-STORM SEW CL A 2, 12" @ 3.82% TBF=18.7 CU YD	U11 29'-PIPE UNDERDRAIN, 4"
		305 81'-STORM SEW CL A 2, 24" @ 0.19% TBF=0.6 CU YD	U12 39'-PIPE UNDERDRAIN, 4"
		307 26'-STORM SEW CL A 1, 12" @ 3.54% TBF=3.4 CU YD	U13 42'-PIPE UNDERDRAIN, 4"
		308 18'-STORM SEW CL A 1, 12" @ 2.06% TBF=2.4 CU YD	U14 47'-PIPE UNDERDRAIN, 4"
		309 36'-STORM SEW CL A 1, 12" @ 2.50% TBF=4.8 CU YD	U15 52'-PIPE UNDERDRAIN, 4"
		310 75'-STORM SEW CL A 1, 12" @ 0.24% TBF=9.9 CU YD	U16 66'-PIPE UNDERDRAIN, 4"
		311 56'-STORM SEW CL A 1, 12" @ 9.70% TBF=0.3 CU YD	
		312 33'-STORM SEW CL A 1, 12" @ 4.36% TBF=4.4 CU YD	

<b>RAMP B</b>
323 STA. 9+70.71, 34.0' LT CB TC T8G RIM = 757.98 INV = 753.98 (E) INV = 753.98 (NW)
324 STA. 9+50.00, 106.3' RT PRC FLAR END SEC 12 INV = 737.33 (E)
352 STA. 9+63.58, 8.0' LT MH TA 4 DIA T1F CL RIM = 760.40 INV = 752.50 (N) INV = 752.50 (NW) INV = 750.50 (SE)
323 106'-STORM SEW CL A 2, 12" @ 12.42% TBF=3.9 CU YD
352 24'-STORM SEW CL A 2, 12" @ 6.17% TBF=2.8 CU YD

<b>IL RTE. 31 MAINLINE SEWER &amp; WATER</b>	
W15 STA. 117+68.00, 77.3' LT FIRE HYD W/AUX V & VB	W13 144'-RESTRAINED JOINT WATER MAIN 8 122'-STEEL CASINGS 16 TBF=59.7 CU YD
W12 STA. 117+78.00, 66.0' LT DOM WAT SER BOX	W14 8'-WATER MAIN 6 TBF=0.0 CU YD
W13 STA. 117+83.00, 68.0' LT DOM WAT SER BOX	W15 117'-WATER SERV LINE 1 TBF=0.0 CU YD
W14 STA. 117+68.00, 69.0' LT VV TA 4 DIA T1F CL RIM = 758.01 TOP PIPE = 751.09 WATER VALVES 8"	W16 122'-WATER SERV LINE 1 TBF=0.0 CU YD

- NOTES:**
- CURB STRUCTURE RIM ELEVATIONS ARE LOCATED AT THE EDGE OF PAVEMENT
  - LOCATION CALL-OFFS AND INVERT ELEVATIONS FOR END SECTIONS ARE AT THE FLARED END OF THE STRUCTURE
  - CONTRACTOR SHALL COORDINATE ALL WATER MAIN WORK WITH THE VILLAGE OF ALGONQUIN

**ILLINOIS ROUTE 31  
RAMP B  
RAMP C**

