

IL RTE. 31 MAINLINE	IL RTE. 31 MAINLINE	IL RTE. 31 MAINLINE	IL RTE. 31 MAINLINE	IL RTE. 31 MAINLINE	IL RTE. 31 MAINLINE	IL RTE. 31 MAINLINE
17 STA. 178+23.00, 11.0' RT CB TC T24F&G RIM = 883.30 INV = 877.30 (W)	20 STA. 175+23.00, 47.0' LT CB TC T24F&G RIM = 874.69 INV = 870.69 (E)	23 STA. 172+25.25, 88.0' LT MAN TA 5 DIA TIF CL RIM = 868.50 INV = 864.50 (NE) INV = 863.50 (SE) INV = 862.50 (W)	26 STA. 170+08.00, 189.4' LT PRC FLAR END SEC 36 W/ GRATING INV = 829.00 (S)	30 STA. 174+00.00, 75.0' RT CB TC TIF OL RIM = 872.63 INV = 869.92 (SW)	47 STA. 177+00.00, 86.4' RT CB TA 4 DIA T8G RIM = 879.60 INV = 877.00 (N) INV = 876.00 (S) INV = 876.00 (E)	65 STA. 168+10.00, 11.0' RT CB TC T24F&G RIM = 862.20 INV = 858.22 (N) INV = 858.70 (4" S)
18 STA. 178+65.00, 29.0' LT MAN TA 5 DIA TIF CL RIM = 882.25 INV = 876.00 (N) INV = 876.00 (S) INV = 876.00 (E) INV = 876.00 (W)	21 STA. 175+23.00, 41.0' LT MAN TA 5 DIA TIF CL RIM = 874.93 INV = 869.00 (N) INV = 869.00 (S) INV = 870.65 (E) INV = 870.65 (W)	24 STA. 171+01.62, 132.7' LT MAN TA 5 DIA TIF CL RIM = 856.50 INV = 850.50 (E) INV = 849.66 (W) INV = 850.50 (S)	27 STA. 174+00.00, 11.0' RT CB TA 4 DIA T24F&G RIM = 873.86 INV = 869.35 (NW) INV = 869.35 (S)	32 STA. 172+50.00, 48.2' RT CB TC T24F&G RIM = 872.49 INV = 867.50 (NW)	59 STA. 167+00.00, 35.0' LT CB TA 4 DIA T24F&G RIM = 858.94 INV = 855.13 (N) INV = 855.13 (S) INV = 855.13 (E)	66 STA. 168+10.00, 35.0' LT CB TA 4 DIA T24F&G RIM = 860.91 INV = 856.93 (S) INV = 856.93 (W) INV = 857.41 (4" SE)
19 STA. 178+65.00, 35.0' LT CB TC T24F&G RIM = 882.01 INV = 876.02 (E) INV = 878.51 (4" S)	22 STA. 175+23.00, 11.1' RT CB TC T24F&G RIM = 876.46 INV = 871.30 (W)	25 STA. 170+05.37, 155.1' LT MAN TA 6 DIA TIF CL EX RIM = 834.28 INV = 829.15 (N) INV = 829.15 (E)	28 STA. 173+93.00, 60.1' LT CB TA 5 DIA T24F&G RIM = 871.57 INV = 865.50 (N) INV = 865.50 (NE) INV = 865.50 (SE) INV = 865.50 (SW) INV = 868.07 (4" E)	44 STA. 180+00.00, 70.68' RT CB TA 4 DIA T8G RIM = 886.10 INV = 879.55 (N) INV = 879.55 (S)	60 STA. 172+25.00, 5.0' LT CB TA 4 DIA T24F&G RIM = 870.26 INV = 865.76 (NW) INV = 866.76 (SE)	69 STA. 167+00.00, 11.0' RT CB TC T24F&G RIM = 859.78 INV = 855.97 (N)
			29 STA. 174+11.00, 76.0' LT CB TC T8G RIM = 869.65 INV = 865.69 (S)	45 STA. 179+72.15, 60.6' RT MAN TA 4 DIA TIF CL RIM = 886.97 INV = 879.43 (N) INV = 879.43 (S)	61 STA. 172+25.00, 37.2' LT CB TA 4 DIA T24F&G RIM = 869.21 INV = 863.73 (NW) INV = 865.21 (SE) INV = 865.71 (4" E)	152 STA. 177+00.00, 41.0' LT MAN TA 5 DIA TIF CL RIM = 878.50 INV = 872.73 (N) INV = 873.70 (E) INV = 873.65 (W) INV = 871.70 (S)
				46 STA. 177+86.68, 60.6' RT MAN TA 4 DIA TIF CL RIM = 884.09 INV = 878.54 (N) INV = 878.54 (S)	63 STA. 170+50.00, 5.0' LT CB TC T24F&G RIM = 866.70 INV = 861.80 (NW)	153 STA. 177+00.00, 11.0' RT CB TC T24F&G RIM = 879.87 INV = 874.34 (W)
					64 STA. 170+50.00, 35.0' LT CB TA 4 DIA T24F&G RIM = 865.59 INV = 861.65 (NE) INV = 861.65 (SE)	154 STA. 177+00.00, 46.9' LT CB TC T24F&G RIM = 878.12 INV = 873.70 (E)
					159 STA. 167+00.00, 139.0' LT PRC FLAR END SEC 12 INV = 832.0 (S)	

NORTH MAIN STREET	NORTH MAIN STREET
31 STA. 58+00.00, 42.9' RT CB TA 4 DIA T24F&G RIM = 875.22 INV = 869.70 (N) INV = 869.70 (NE) INV = 869.70 (SE)	33 51'-STORM SEW CL A 1, 12" @ 0.51% TBF=9.4 CU YD
33 STA. 57+40.00, 20.9' LT CB TC T24F&G RIM = 875.62 INV = 871.62 (NE)	34 58'-STORM SEW CL A 2, 12" @ 2.86% TBF=5.1 CU YD
34 STA. 57+40.00, 30.0' RT CB TA 4 DIA T24F&G RIM = 876.05 INV = 871.36 (NW) INV = 871.36 (SW) INV = 872.55 (4" W)	U53 54'-PIPE UNDERDRAIN, 4"

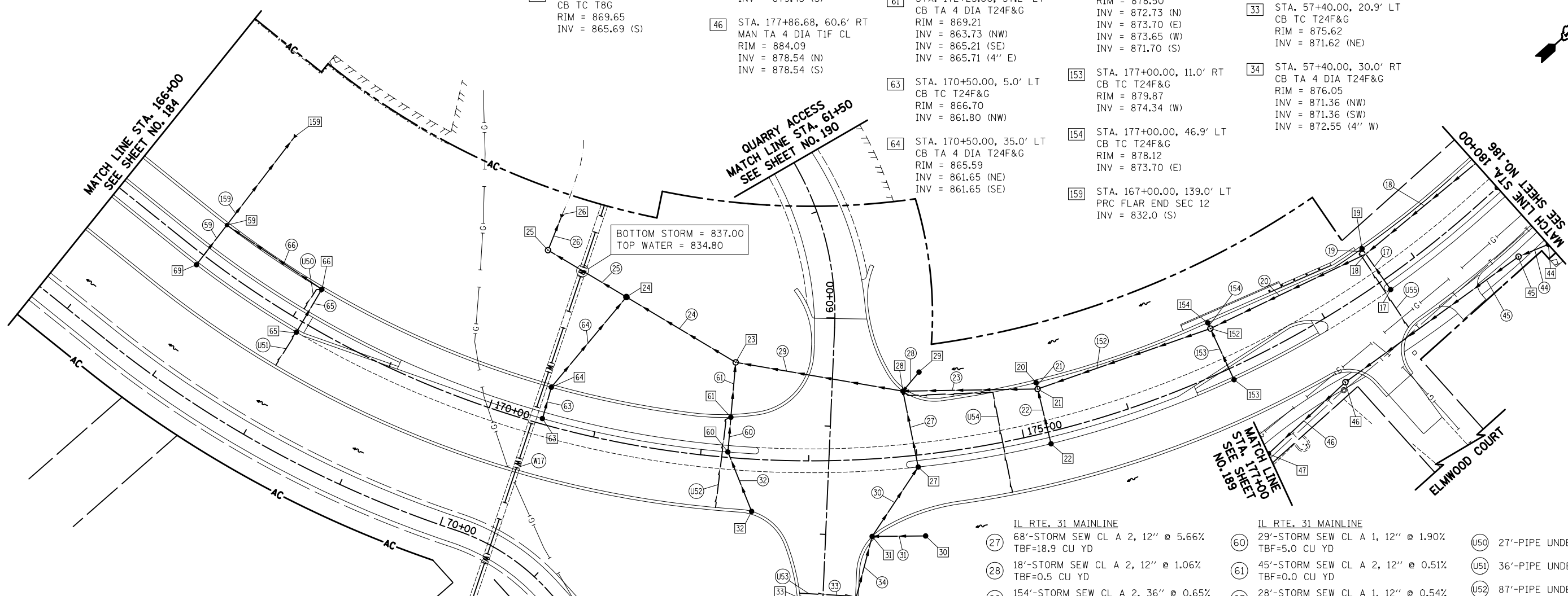

IL RTE. 31 MAINLINE
17 36'-STORM SEW CL A 2, 12" @ 3.16% TBF=13.4 CU YD
18 150'-STORM SEW CL A 2, 18" @ 2.00% TBF=97.1 CU YD
19 4'-STORM SEW CL A 2, 12" @ 0.50% TBF=1.5 CU YD
20 154'-STORM SEW CL A 2, 36" @ 2.12% TBF=43.4 CU YD
21 4'-STORM SEW CL A 1, 12" @ 1.00% TBF=0.7 CU YD
22 48'-STORM SEW CL A 1, 12" @ 1.35% TBF=10.9 CU YD
23 119'-STORM SEW CL A 2, 36" @ 2.94% TBF=13.0 CU YD

IL RTE. 31 MAINLINE
24 113'-STORM SEW CL A 2, 36" @ 11.50% TBF=0.0 CU YD
25 66'-STORM SEW CL A 2, 36" @ 17.35% 2-R C PIPE ELBOW 36 3-CONCRETE ANCHORS SEE SHEET 359 FOR SLOPE DRAIN DETAIL TBF=0.0 CU YD
26 25'-STORM SEW CL A 2, 36" @ 0.60% TBF=0.0 CU YD

NOTES:
 1. CURB STRUCTURE RIM ELEVATIONS ARE LOCATED AT THE EDGE OF PAVEMENT
 2. LOCATION CALL-OFFS AND INVERT ELEVATIONS FOR END SECTIONS ARE AT THE FLARED END OF THE STRUCTURE

IL RTE. 31 MAINLINE
27 68'-STORM SEW CL A 2, 12" @ 5.66% TBF=18.9 CU YD
28 18'-STORM SEW CL A 2, 12" @ 1.06% TBF=0.5 CU YD
29 154'-STORM SEW CL A 2, 36" @ 0.65% TBF=15.6 CU YD
30 75'-STORM SEW CL A 2, 12" @ 0.47% TBF=19.3 CU YD
31 46'-STORM SEW CL A 1, 12" @ 0.48% TBF=0.0 CU YD
32 59'-STORM SEW CL A 1, 12" @ 1.25% TBF=10.2 CU YD
44 26'-STORM SEW CL A 2, 12" @ 0.46% TBF=13.6 CU YD
45 194'-STORM SEW CL A 2, 12" @ 0.46% TBF=159.9 CU YD
46 93'-STORM SEW CL A 2, 12" @ 1.66% TBF=6.7 CU YD
59 44'-STORM SEW CL A 1, 12" @ 1.91% TBF=5.8 CU YD

IL RTE. 31 MAINLINE
60 29'-STORM SEW CL A 1, 12" @ 1.90% TBF=5.0 CU YD
61 45'-STORM SEW CL A 2, 12" @ 0.51% TBF=0.0 CU YD
63 28'-STORM SEW CL A 1, 12" @ 0.54% TBF=5.4 CU YD
64 103'-STORM SEW CL A 2, 12" @ 10.83% TBF=0.0 CU YD
65 44'-STORM SEW CL A 1, 12" @ 2.93% TBF=3.3 CU YD
66 103'-STORM SEW CL A 1, 12" @ 1.75% TBF=13.6 CU YD
152 164'-STORM SEW CL A 2, 36" @ 1.65% TBF=85.3 CU YD
153 49'-STORM SEW CL A 2, 12" @ 1.31% TBF=13.1 CU YD
154 5'-STORM SEW CL A 2, 12" @ 1.00% TBF=1.1 CU YD
159 94'-STORM SEW CL A 2, 12" @ 22.68% TBF=0.0 CU YD

U50 27'-PIPE UNDERDRAIN, 4"
U51 36'-PIPE UNDERDRAIN, 4"
U52 87'-PIPE UNDERDRAIN, 4"
U54 176'-PIPE UNDERDRAIN, 4"
U55 87'-PIPE UNDERDRAIN, 4"
W17 390'-STEEL CASING 16 TBF=221.9 CU YD (WATERMAIN TO BE INSTALLED BY OTHERS)

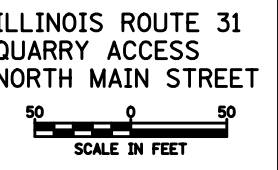

FILE NAME = ...\\D160F72-sht-dp1n-09.dgn	USER NAME = ctb	DESIGNED - DTE	REVISED -
		DRAWN - DTE	REVISED -
		CHECKED - GAB	REVISED -
		DATE - 5/3/2012	REVISED -

**STATE OF ILLINOIS
DEPARTMENT OF TRANSPORTATION**

DRAINAGE AND UTILITIES PLAN

SCALE: 1" = 50' SHEET NO. 9 OF 15 SHEETS STA. 166+00 TO STA. 180+00

O.R. RTE.	SECTION	COUNTY	TOTAL SHEETS	SHEET NO.
0003	18A-2	MCHENRY	825	185
CONTRACT NO. 60F72				
FED. ROAD DIST. NO. 1 ILLINOIS FED. AID PROJECT				