

TRAFFIC SIGNAL NOTES

(A) LEFT ON GREEN ARROW ONLY
 R 10-5
 24"x30"
 (TYP.)
 SIGN PANEL
 TYPE 1
 (4 REQUIRED)

1. PORTABLE CHANGEABLE MESSAGE SIGNS SHALL BE PRESENT ON THE WEST, NORTH AND EAST APPROACHES ONE WEEK IN ADVANCE UNTIL ONE WEEK FOLLOWING THE SIGNAL TURN-ON. THE MESSAGE ON THE SIGNS SHALL INCLUDE THE DATE ON WHICH THE SIGNALS WILL BE TURNED ON.

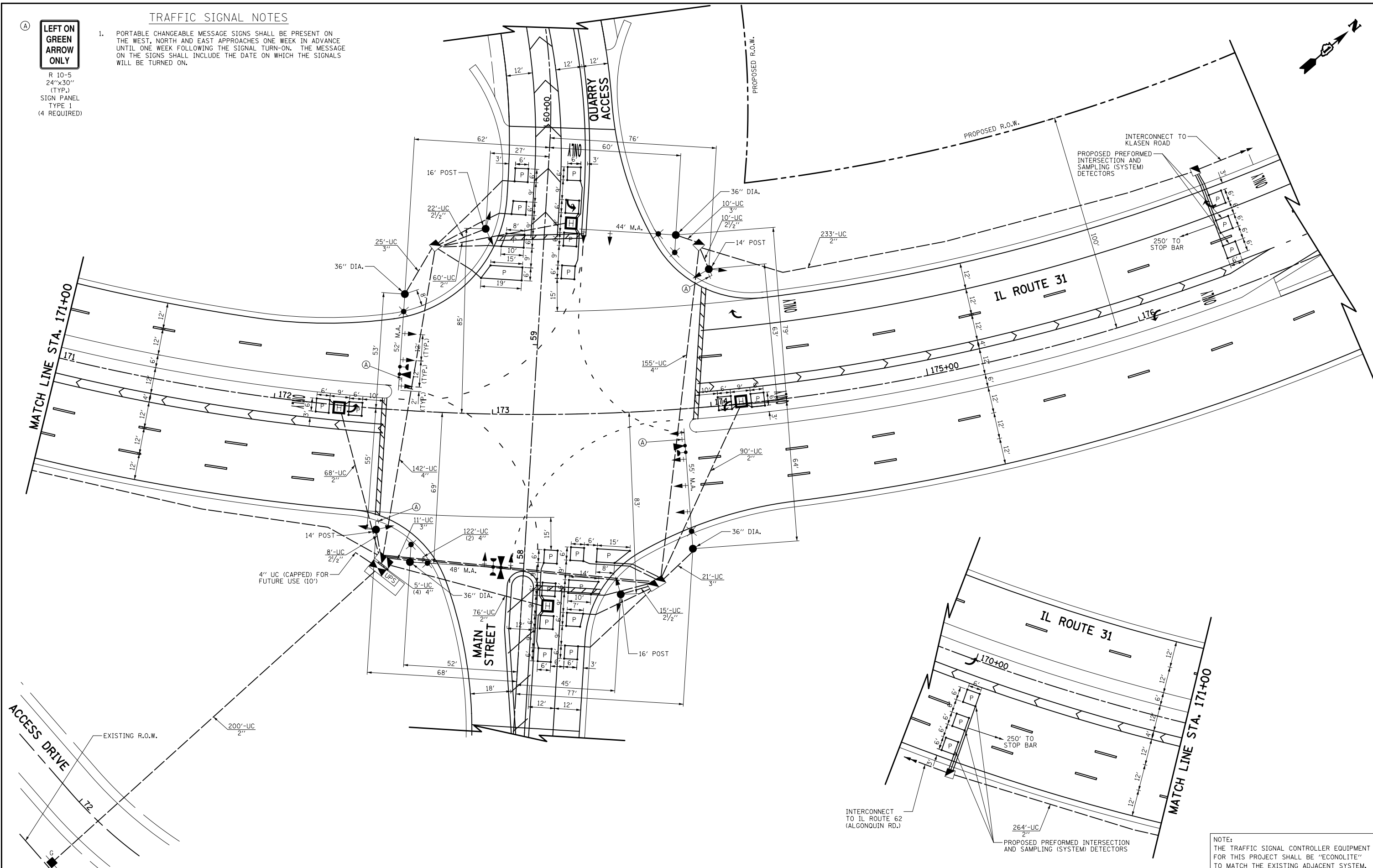

NOTE:
 THE TRAFFIC SIGNAL CONTROLLER EQUIPMENT FOR THIS PROJECT SHALL BE "ECONOLITE" TO MATCH THE EXISTING ADJACENT SYSTEM.

FILE NAME =
 ...\\D160F72-sht-ts-14.dgn

USER NAME = akw
 DESIGNED - BRD
 DRAWN - OJT
 PLOT SCALE = 40.0000' / in.
 CHECKED - JJE
 PLOT DATE = 5/2/2012
 DATE - 5/3/2012

REVISED -
 REVISED -
 REVISED -
 REVISED -

STATE OF ILLINOIS
 DEPARTMENT OF TRANSPORTATION

TRAFFIC SIGNAL INSTALLATION PLAN
 IL ROUTE 31 AT MAIN STREET/QUARRY ACCESS

SCALE: 1"=20' SHEET NO. 1 OF 1 SHEETS STA. TO STA.

O.R. RTE.	SECTION	COUNTY	TOTAL SHEETS	SHEET NO.
0003	18A-2	MCHENRY	825	276
CONTRACT NO. 60F72				
FED. ROAD DIST. NO. 1 ILLINOIS FED. AID PROJECT				