

PLAN

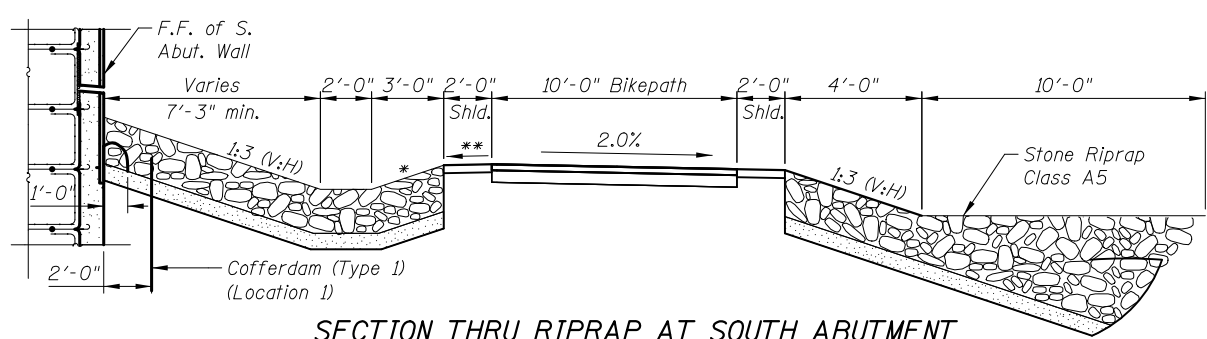

SECTION THRU RIPRAP AT SOUTH ABUTMENT

Dimensions and slopes measured at Rt. L's to the Bikepath
See Section A-A for balance of information

* 1:3 (V:H)
** 2.0%

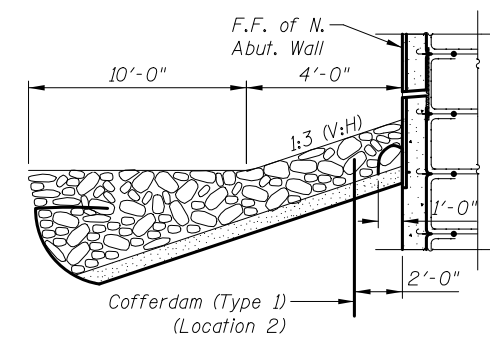

SECTION THRU RIPRAP AT NORTH ABUTMENT

Dimensions and slopes measured at Rt. L's to Abutment
See Section A-A for balance of information

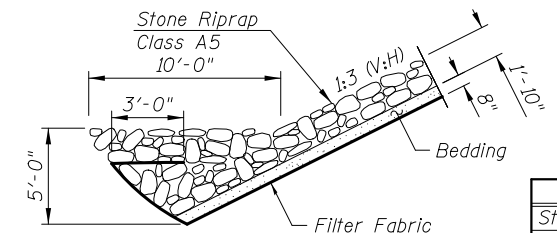

SECTION A-A

Bedding to be included in the cost of Stone Riprap

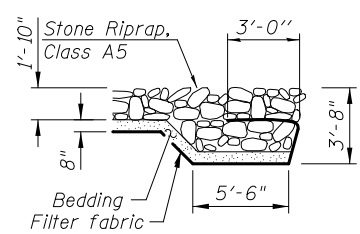

SECTION B-B

BILL OF MATERIAL

Item	Unit	Total
Stone Riprap, Class A5	Sq. Yd.	362
Filter Fabric	Sq. Yd.	362
Cofferdam Excavation	Cu. Yd.	297
Cofferdam (Type 1) (Location 3)	Each	1
Cofferdam (Type 1) (Location 4)	Each	1

5/2/2012 4:20:16 PM I:\2154\cad\sheet\Roadway\20-Structures & Walls\04-SN 056-0079\0560079-60F72-03-RRD.dgn

DRAWN - M. LANGE	REVISED -
DESIGNED - D. ATKINS	REVISED -
CHECKED - G. HATLESTAD	REVISED -
DATE - 5/3/2012	REVISED -

O.R. RTE.	SECTION	COUNTY	TOTAL SHEETS	SHEET NO.
0003	18A-2	MCHENRY	825	528
CONTRACT NO. 60F72				
ILLINOIS FED. AID PROJECT				