

Bench Mark: Control Point CP21, Mag Nail located in bituminous shoulder behind the back of curb, Station 66+81.96, offset 21.99 feet Rt., Elev. 762.75.

Existing Structure: None
 IDOT Std. Light Pole (See Lighting Plans)

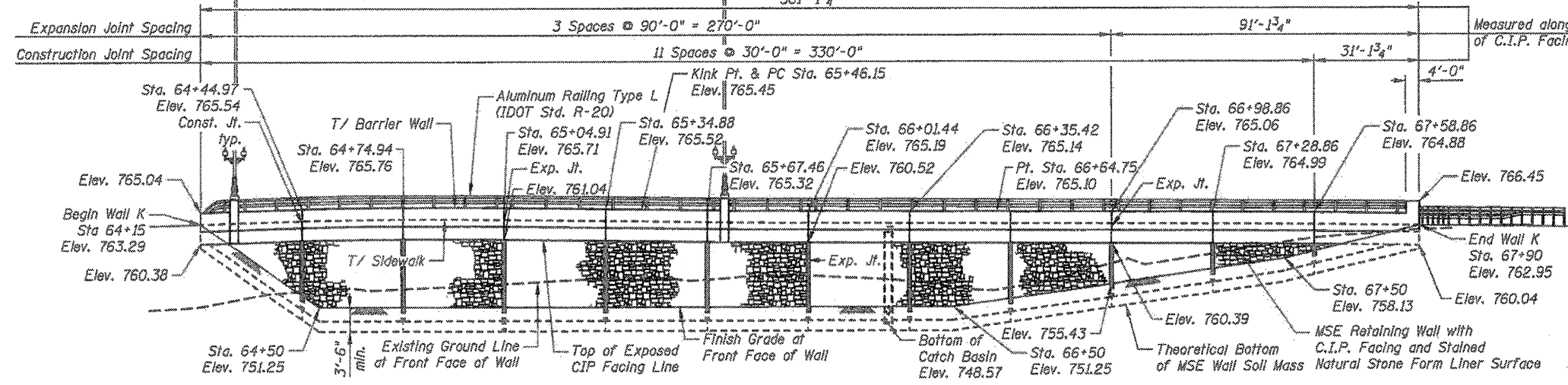

ELEVATION
 (Looking North @ F.F. of Wall)

CURVE No. A2
 $\Delta = 22^\circ 25' 15.23''$ (RT)
 $D = 18^\circ 47' 07.8''$
 $T = 60.45'$
 $L = 119.35'$
 $E = 5.93'$
 $R = 305.0'$
 P.C. = Sta. 65+45.40
 P.T. = Sta. 66+64.75
 P.I. = Sta. 66+05.85
 S.E. = 2.00%

CURVE No. A3
 $\Delta = 55^\circ 11' 27.92''$ (LT)
 $D = 19^\circ 24' 32.9''$
 $T = 154.30'$
 $L = 284.36'$
 $E = 37.89'$
 $R = 295.20'$
 P.C. = Sta. 68+16.41
 P.T. = Sta. 71+00.77
 P.I. = Sta. 69+70.71
 S.E. = 2.00%
 T.R. = 149.5' (EB)
 S.E. Runoff = 74.7' (EB)

DESIGN SPECIFICATIONS
 2002 AASHTO Standard Specification for Highway Bridges, 17th Ed.

DESIGN STRESSES
FIELD UNITS
 $f'_c = 3,500$ psi
 $f_y = 60,000$ psi (Reinforcement)

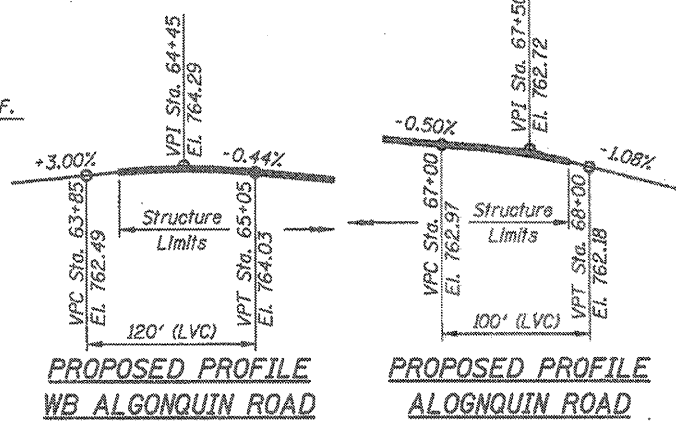

PROPOSED PROFILE
WB ALGONQUIN ROAD

PROPOSED PROFILE
ALOGNQUIN ROAD

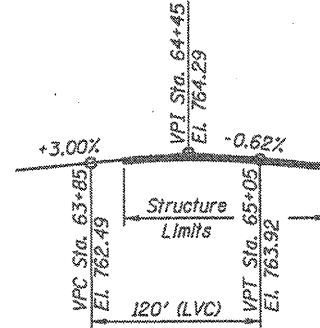

PROPOSED PROFILE
EB ALGONQUIN ROAD

CIVILTECH ENGINEERING, INC.
 GREGORY J. HATLESTAD, S.E.



GREGORY J. HATLESTAD, S.E.
 # 081-005562

EXP 11/30/12
 DATE 3/15/12

APPROVED
 For Structural Adequacy Only
Gregory J. Hatlestad
 Engineer of Bridges & Structures

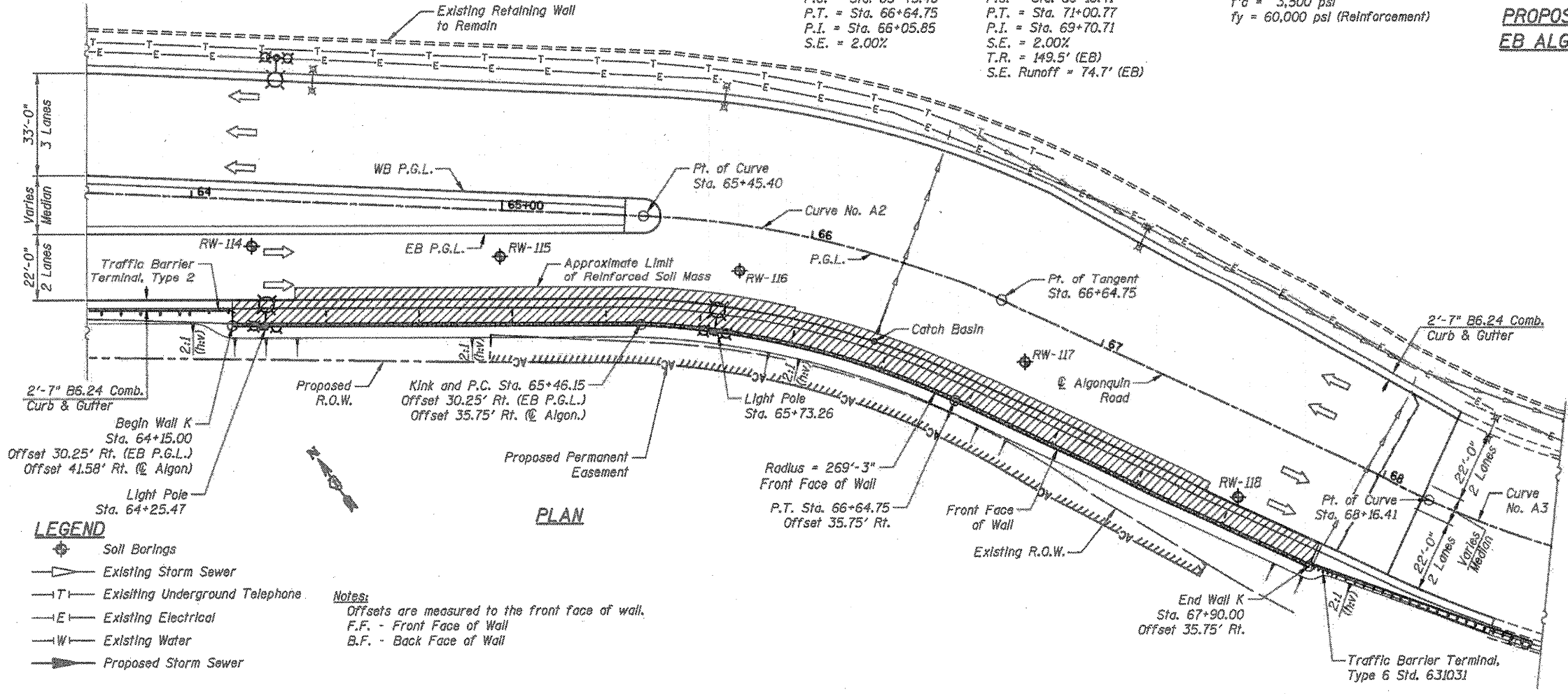

PLAN

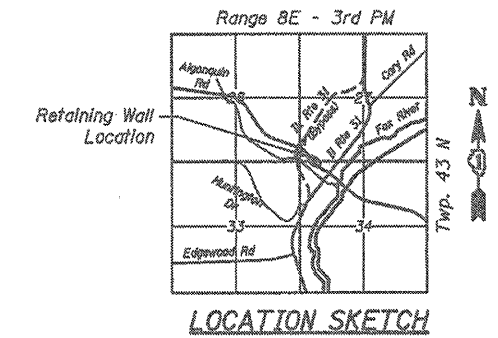

LOCATION SKETCH

GENERAL PLAN & ELEVATION
WALL K, ALGONQUIN ROAD - F.A.P. 339
SECTION 18A-2, McHENRY COUNTY
STA. 64+15 TO STA. 67+90
STRUCTURE NO. 056-2504

CIVILTECH
 450 E Devon Ave, Suite 300
 Itasca, Illinois 60143
 Tel: 630.773.3900 Fax: 630.773.3975
 www.civiltechinc.com

DRAWN	- K. HODGEN
DESIGNED	- D. ATKINS
CHECKED	- G. HATLESTAD
DATE	- 3/23/2012

STATE OF ILLINOIS
 DEPARTMENT OF TRANSPORTATION

GENERAL PLAN & ELEVATION
WALL K, ALGONQUIN ROAD
STRUCTURE NO. 056-2504
 SHEET NO. WK1 OF WK9 SHEETS

O.R. RTE.	SECTION	COUNTY	TOTAL SHEETS	SHEET NO.
0003	18A-2	MCHEMRY	825	656
			CONTRACT NO. 60FT2	
ILLINOIS FED. AID PROJECT				

J:\2012\Road\Sheet\Roadway\3D-Structures & Walls\K-Wall\056-2504-0072-04-01.dwg
 2/15/2012 2:35:42 PM