

| | | | |
|-----------|---------------|----|------|
| FINL | SURVEYED | BY | DATE |
| SURVEY | PLOTTED | | |
| NOTE BOOK | TEMPLATE | | |
| NO. | AREAS CHECKED | | |

| | | | |
|-----------|---------------|----|------|
| ORIGINAL | SURVEYED | BY | DATE |
| SURVEY | PLOTTED | | |
| NOTE BOOK | TEMPLATE | | |
| NO. | AREAS CHECKED | | |

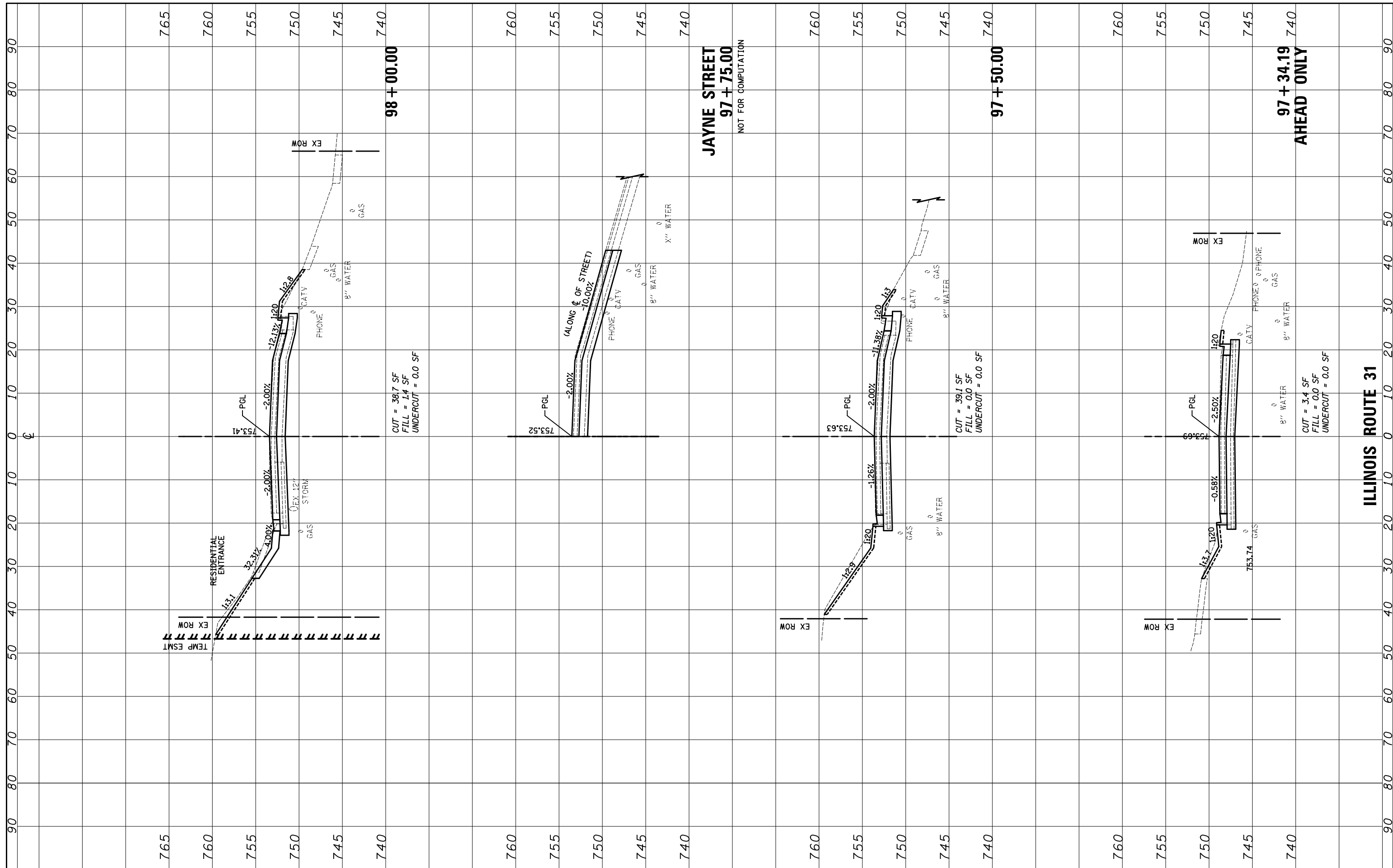

FILE NAME = ...\\D160F72-sht-xssht-01.Bypass_South.dgn

| | | |
|-----------------------------|-----------------|-----------|
| USER NAME = okw | DESIGNED - PML | REVISED - |
| PLOT SCALE = 20.0000' / in. | DRAWN - PML | REVISED - |
| PLOT DATE = 5/2/2012 | CHECKED - GAB | REVISED - |
| | DATE - 5/3/2012 | REVISED - |

**STATE OF ILLINOIS
 DEPARTMENT OF TRANSPORTATION**

CROSS SECTIONS

SCALE: 10'H: 5'V SHEET NO. 7 OF 64 SHEETS STA. 97+34.19(AH) TO STA. 98+00.00

| | | | | |
|---|---------|---------|--------------|-----------|
| O.R. RTE. | SECTION | COUNTY | TOTAL SHEETS | SHEET NO. |
| 0003 | 18A-2 | MCHENRY | 825 | 686 |
| CONTRACT NO. 60F72 | | | | |
| FED. ROAD DIST. NO. 1 ILLINOIS FED. AID PROJECT | | | | |