

Bench Mark: Brass disk in concrete wall (M.S.L. Elev. 544.082)  
Sta. 105+09.54 BR Right Bank (N.G.V.D. Elev. = 543.644)

Existing Structure: S.N. 099-0166 was originally constructed in 1933 under Section 128-BR-I to carry Jefferson Street over the Des Plaines River. The structure is a Scherzer Rolling Lift Bascule Bridge with a main moveable span of 168'-0" and four fixed approach spans.

An assigned detour route will be utilized to maintain vehicular traffic, but the channel will remain open to river traffic.

NE Pinion Gear shall be salvaged, delivered, and unloaded at the Joliet Moveable Bridge Office: 105 Bridge Street, Joliet, IL 60435. 24 hour notice shall be given by calling 815-726-5495. Cost included in the pay item Operating Machinery.

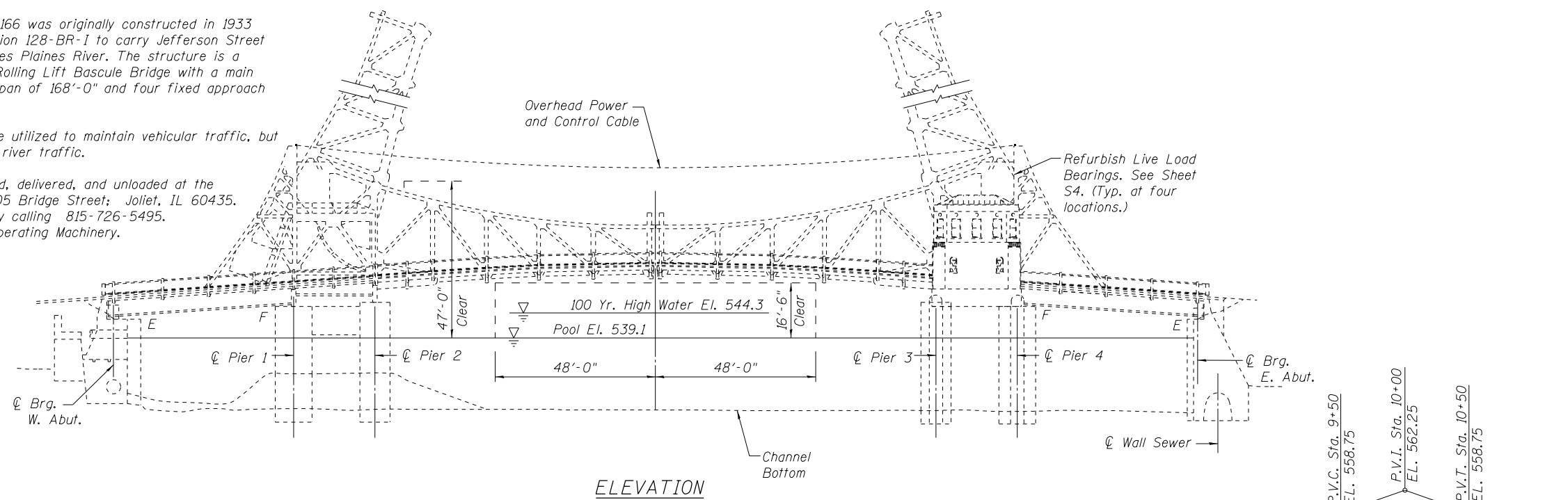

ELEVATION

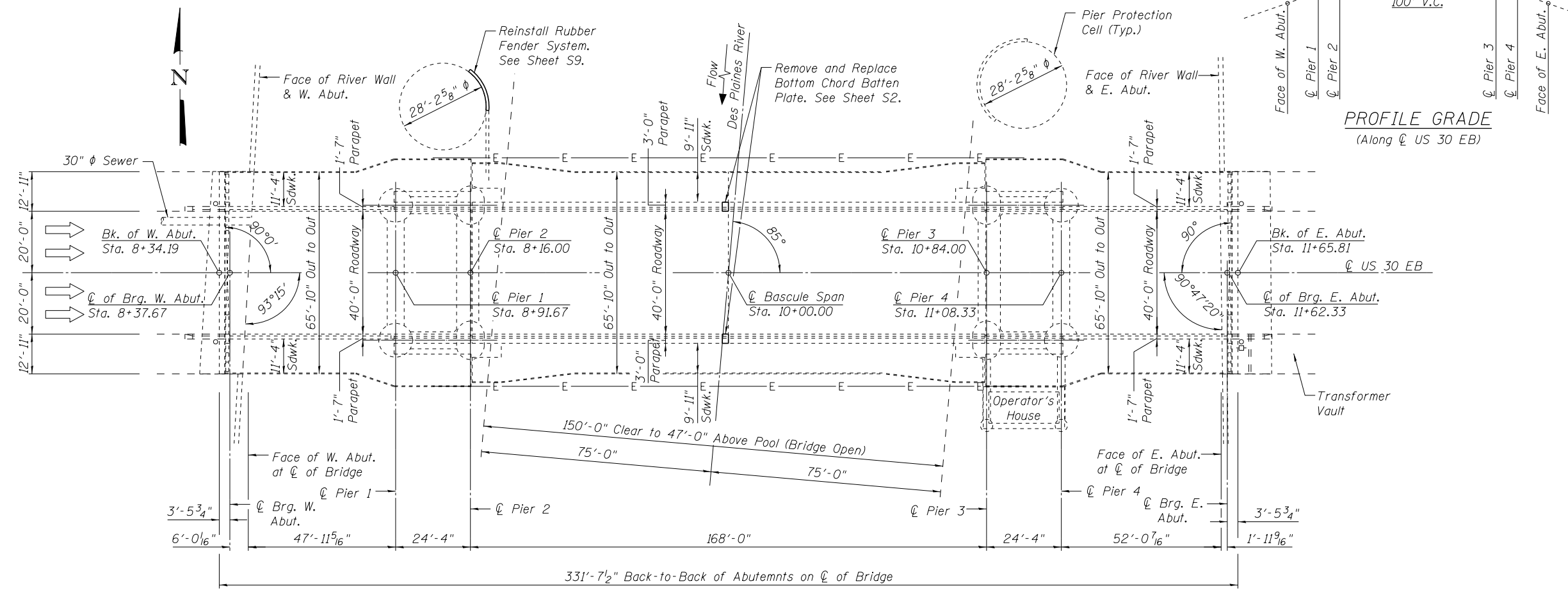

PLAN

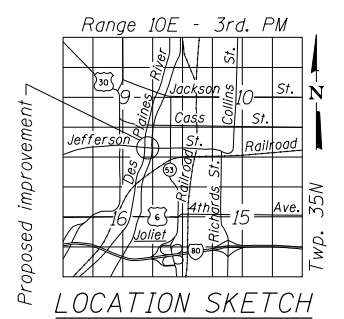

SCOPE OF WORK

1. Repair Floor Beam A. See Sheet S3.
2. Refurbish live load bearings.
3. Refurbish/replace operating machinery components. See Sheet S5.
4. Reinstall rubber fender system at west pier protection cell.
5. Sidewalk post repairs. See Sheet S8.
6. Remove and replace batten plates.

DESIGN SPECIFICATIONS

2002 AASHTO Standard Specifications for Highway Bridges (17th Edition)  
1988 AASHTO Standard Specifications for Movable Bridges (5th Edition)

LOADING HS20-44

DESIGN STRESSES

FIELD UNITS  
 $f_y = 36,000$  psi (structural steel)



COLLINS ENGINEERS, INC.  
JAMES M. HAMELKA  
NO. 81-6116  
EXPIRES 11-30-2012

FILE NAME =	USER NAME =	DESIGNED - JMS	REVISOR -	<p align="center"><b>STATE OF ILLINOIS</b> <b>DEPARTMENT OF TRANSPORTATION</b></p> <p align="center"><b>GENERAL PLAN AND ELEVATION</b> <b>US 30 EB (JEFFERSON STREET) OVER DES PLAINES RIVER</b> <b>STRUCTURE NO. 099-0166</b></p> <p align="center">SHEET NO. 51 OF 59 SHEETS</p>	F.A.P. RTE. =	SECTION =	COUNTY =	TOTAL SHEETS =	SHEET NO. =
		CHECKED - JMH	REVISOR -		607	2011-065-BR	WILL	33	14
		DRAWN - PRH	REVISOR -		CONTRACT NO. 60P84				
		CHECKED - JMH	REVISOR -		ILLINOIS FED. AID PROJECT				