

DATE	
BY	
NO.	
ORIGINAL SURVEY	
PIOTTED	
NOTE BOOK	
AREAS CHECKED	

DATE	
BY	
NO.	
ORIGINAL SURVEY	
PIOTTED	
NOTE BOOK	
AREAS CHECKED	

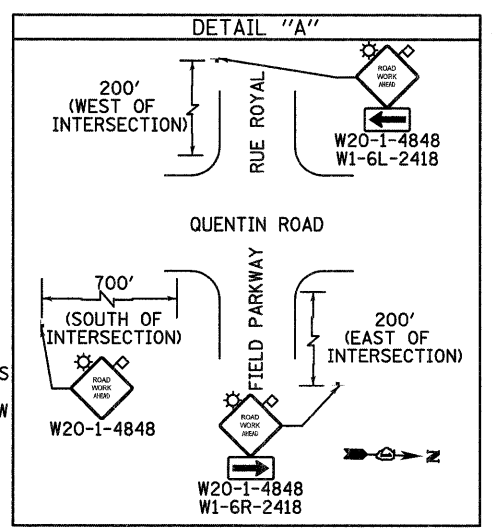
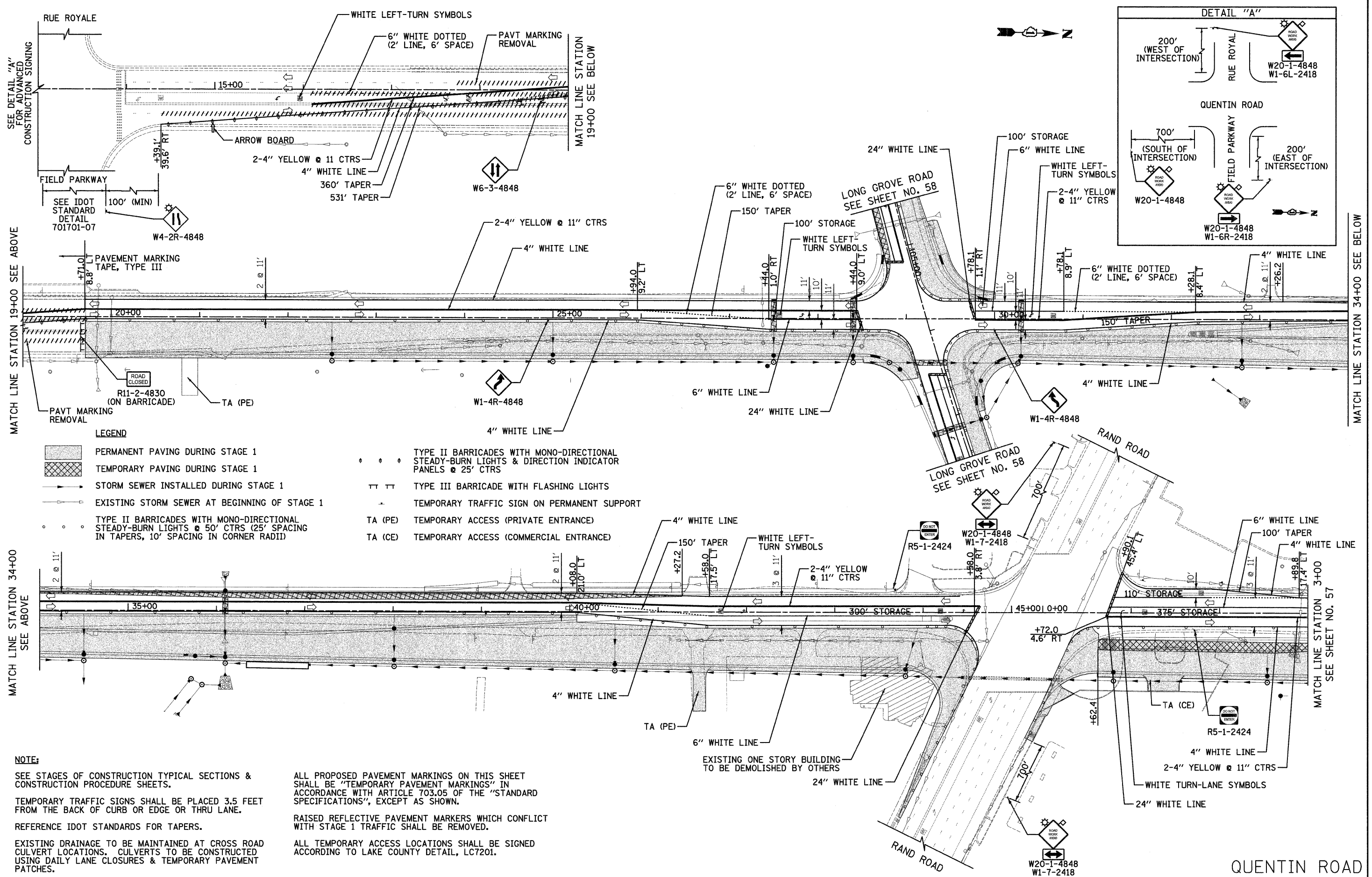

- LEGEND**
- PERMANENT PAVING DURING STAGE 1
 - TEMPORARY PAVING DURING STAGE 1
 - STORM SEWER INSTALLED DURING STAGE 1
 - EXISTING STORM SEWER AT BEGINNING OF STAGE 1
 - TYPE II BARRICADES WITH MONO-DIRECTIONAL STEADY-BURN LIGHTS @ 50' CTRS (25' SPACING IN TAPERS, 10' SPACING IN CORNER RADII)
 - TYPE II BARRICADES WITH MONO-DIRECTIONAL STEADY-BURN LIGHTS & DIRECTION INDICATOR PANELS @ 25' CTRS
 - TYPE III BARRICADE WITH FLASHING LIGHTS
 - TEMPORARY TRAFFIC SIGN ON PERMANENT SUPPORT
 - TA (PE) TEMPORARY ACCESS (PRIVATE ENTRANCE)
 - TA (CE) TEMPORARY ACCESS (COMMERCIAL ENTRANCE)

NOTE:

SEE STAGES OF CONSTRUCTION TYPICAL SECTIONS & CONSTRUCTION PROCEDURE SHEETS.

TEMPORARY TRAFFIC SIGNS SHALL BE PLACED 3.5 FEET FROM THE BACK OF CURB OR EDGE OR THRU LANE.

REFERENCE IDOT STANDARDS FOR TAPERS.

EXISTING DRAINAGE TO BE MAINTAINED AT CROSS ROAD CULVERT LOCATIONS. CULVERTS TO BE CONSTRUCTED USING DAILY LANE CLOSURES & TEMPORARY PAVEMENT PATCHES.

ALL PROPOSED PAVEMENT MARKINGS ON THIS SHEET SHALL BE "TEMPORARY PAVEMENT MARKINGS" IN ACCORDANCE WITH ARTICLE 703.05 OF THE "STANDARD SPECIFICATIONS", EXCEPT AS SHOWN.

RAISED REFLECTIVE PAVEMENT MARKERS WHICH CONFLICT WITH STAGE 1 TRAFFIC SHALL BE REMOVED.

ALL TEMPORARY ACCESS LOCATIONS SHALL BE SIGNED ACCORDING TO LAKE COUNTY DETAIL, LC7201.

CIVILTECH
 450 E Devon Ave, Suite 300
 Itasca, Illinois 60143
 Tel: 630.773.3900 Fax: 630.773.3975
 www.civiltechinc.com

DESIGNED - JRR	REVISED -
DRAWN - JRR	REVISED -
CHECKED - RTM	REVISED -
DATE - 10/24/2011	REVISED -

STATE OF ILLINOIS
DEPARTMENT OF TRANSPORTATION

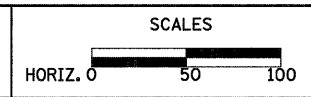

STAGES OF CONSTRUCTION STAGE I

SHEET NO. 1 OF 3 SHEETS

F.A.U. R.T.E.	SECTION	COUNTY	TOTAL SHEETS	SHEET NO.
364	02-00051-08-WR	LAKE	188	56
CONTRACT NO. 63649				
FED. ROAD DIST. NO. 1 ILLINOIS FED. AID PROJECT				

QUENTIN ROAD