

DATE	
BY	
SURVEYED	
PLOTTED	
NOTE BOOK	
AREAS CHECKED	
NO.	

DATE	
BY	
SURVEYED	
PLOTTED	
NOTE BOOK	
AREAS CHECKED	
NO.	

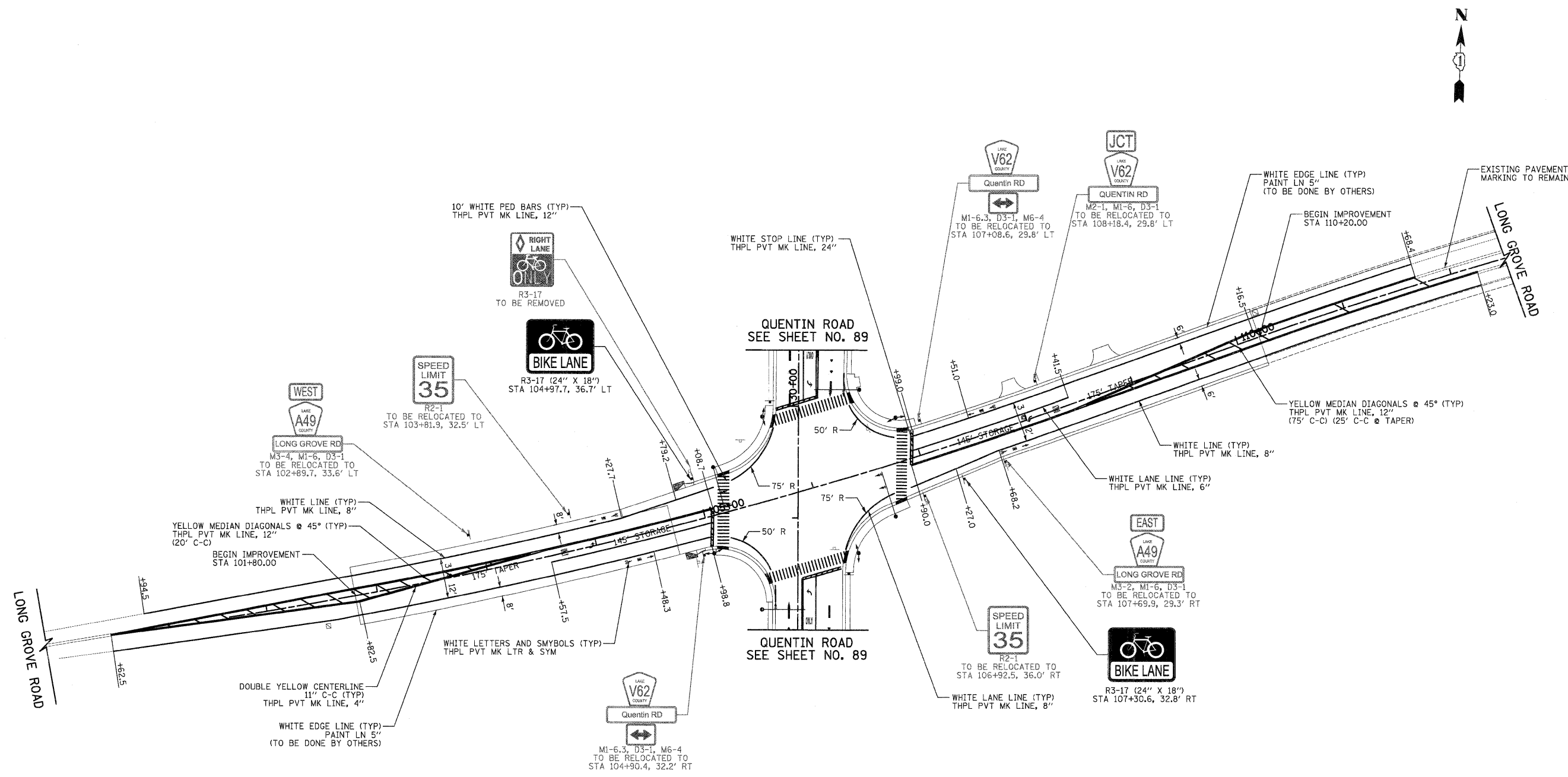

NOTE:
 ALL SIGNS WILL BE INSTALLED BY LCDOT FORCES.
 EXISTING SIGNS SHALL BE TAKEN DOWN BY THE
 CONTRACTOR AND SET ASIDE FOR LCDOT TO PICKUP,
 EXCEPT AS NOTED.

BASE FOR TELESCOPING STEEL SIGN SUPPORT, SPECIAL
 SHALL BE REQUIRED WHEN SIGNS ARE TO BE INSTALLED
 ON SIDEWALKS, MEDIAN ISLANDS, OR OTHER CONCRETE
 LOCATIONS.

LONG GROVE ROAD

CIVILTECH
 450 E Devon Ave, Suite 300
 Itasca, Illinois 60143
 Tel: 630.773.3900 Fax: 630.773.3975
 www.civiltechinc.com

DESIGNED - JRR	REVISED -
DRAWN - JRR	REVISED -
CHECKED - RTM	REVISED -
DATE - 10/24/2011	REVISED -

**STATE OF ILLINOIS
 DEPARTMENT OF TRANSPORTATION**

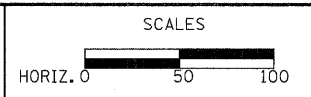

PAVEMENT MARKING AND SIGNING

SHEET NO. 3 OF 3 SHEETS STA. 101+80 TO STA. 110+20

F.A.U. RTE.	SECTION	COUNTY	TOTAL SHEETS	SHEET NO.
364	02-00051-08-WR	LAKE	188	91
CONTRACT NO. 63649				
FED. ROAD DIST. NO. 1 ILLINOIS FED. AID PROJECT				