

DATE \_\_\_\_\_  
 BY \_\_\_\_\_  
 SURVEYED \_\_\_\_\_  
 SURVEY \_\_\_\_\_  
 TEMPLATE \_\_\_\_\_  
 AREAS \_\_\_\_\_  
 AREAS CHECKED \_\_\_\_\_

DATE \_\_\_\_\_  
 BY \_\_\_\_\_  
 SURVEYED \_\_\_\_\_  
 SURVEY \_\_\_\_\_  
 TEMPLATE \_\_\_\_\_  
 AREAS \_\_\_\_\_  
 AREAS CHECKED \_\_\_\_\_

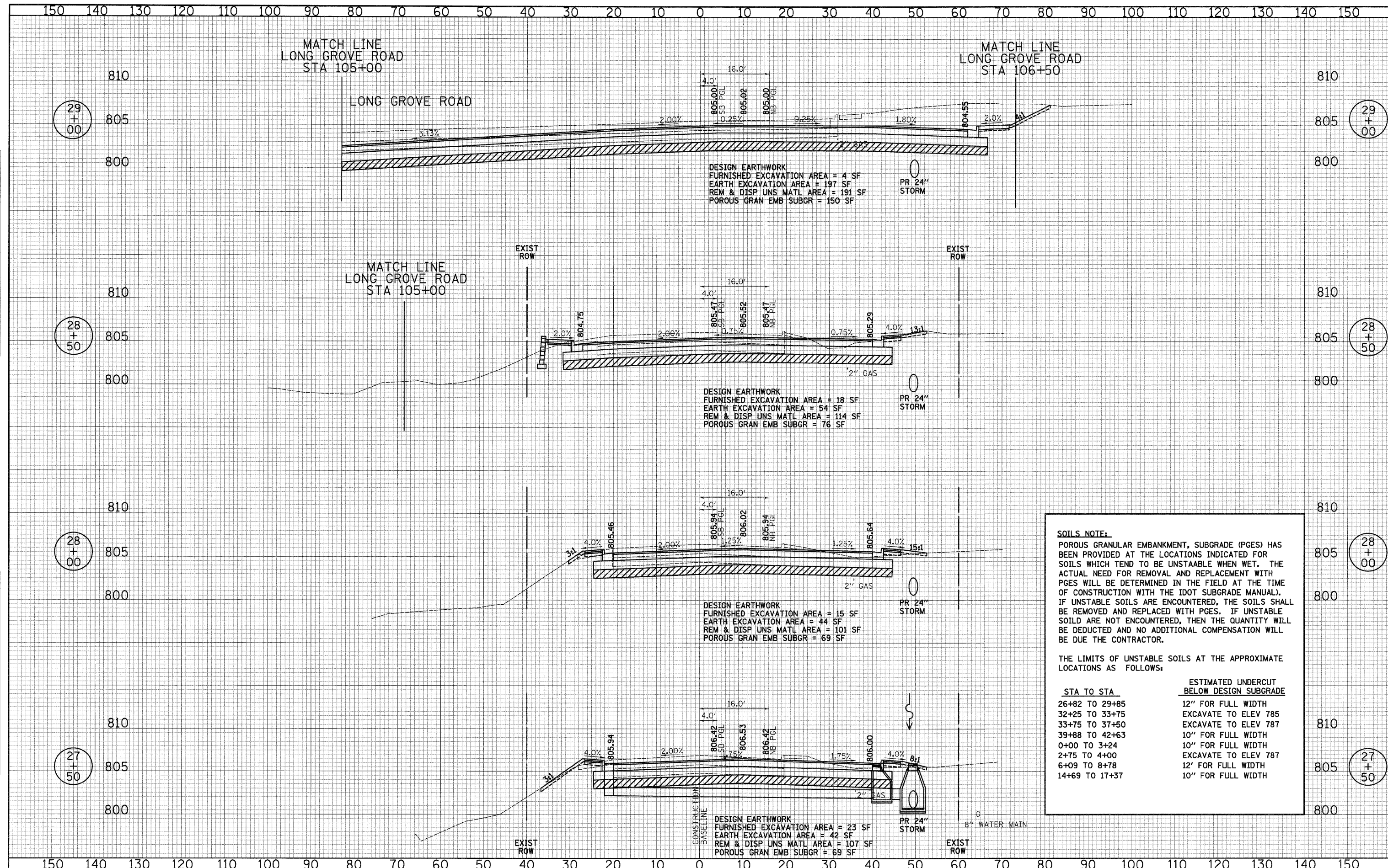

DESIGN EARTHWORK  
 FURNISHED EXCAVATION AREA = 4 SF  
 EARTH EXCAVATION AREA = 197 SF  
 REM & DISP UNS MATL AREA = 191 SF  
 POROUS GRAN EMB SUBGR = 150 SF

DESIGN EARTHWORK  
 FURNISHED EXCAVATION AREA = 18 SF  
 EARTH EXCAVATION AREA = 54 SF  
 REM & DISP UNS MATL AREA = 114 SF  
 POROUS GRAN EMB SUBGR = 76 SF

DESIGN EARTHWORK  
 FURNISHED EXCAVATION AREA = 15 SF  
 EARTH EXCAVATION AREA = 44 SF  
 REM & DISP UNS MATL AREA = 101 SF  
 POROUS GRAN EMB SUBGR = 69 SF

DESIGN EARTHWORK  
 FURNISHED EXCAVATION AREA = 23 SF  
 EARTH EXCAVATION AREA = 42 SF  
 REM & DISP UNS MATL AREA = 107 SF  
 POROUS GRAN EMB SUBGR = 69 SF

**SOILS NOTE:**  
 POROUS GRANULAR EMBANKMENT, SUBGRADE (PGES) HAS BEEN PROVIDED AT THE LOCATIONS INDICATED FOR SOILS WHICH TEND TO BE UNSTABLE WHEN WET. THE ACTUAL NEED FOR REMOVAL AND REPLACEMENT WITH PGES WILL BE DETERMINED IN THE FIELD AT THE TIME OF CONSTRUCTION WITH THE IDOT SUBGRADE MANUAL. IF UNSTABLE SOILS ARE ENCOUNTERED, THE SOILS SHALL BE REMOVED AND REPLACED WITH PGES. IF UNSTABLE SOILS ARE NOT ENCOUNTERED, THEN THE QUANTITY WILL BE DEDUCTED AND NO ADDITIONAL COMPENSATION WILL BE DUE THE CONTRACTOR.

THE LIMITS OF UNSTABLE SOILS AT THE APPROXIMATE LOCATIONS AS FOLLOWS:

STA TO STA	ESTIMATED UNDERCUT BELOW DESIGN SUBGRADE
26+82 TO 29+85	12" FOR FULL WIDTH
32+25 TO 33+75	EXCAVATE TO ELEV 785
33+75 TO 37+50	EXCAVATE TO ELEV 787
39+88 TO 42+63	10" FOR FULL WIDTH
0+00 TO 3+24	10" FOR FULL WIDTH
2+75 TO 4+00	EXCAVATE TO ELEV 787
6+09 TO 8+78	12' FOR FULL WIDTH
14+69 TO 17+37	10" FOR FULL WIDTH

29  
+  
00

29  
+  
00

28  
+  
50

28  
+  
50

28  
+  
00

28  
+  
00

27  
+  
50

27  
+  
50