

**CONSTRUCTION STAGING LEGEND**

- TRAFFIC CONTROL DEVICE (BARRICADE, DRUM, VERTICAL PANEL) WITH STEADY BURN LIGHT AT 50' C/C (TYP.); 25' C/C ON TAPERS; 10' C/C AT INTERSECTION RETURNS AND DRIVEWAYS
- ▨ WORK ZONE
- ➔ DIRECTION OF TRAFFIC MOVEMENT
- ⚡ TYPE III BARRICADE WITH 2 2-WAY FLASHING LIGHTS WITH ROAD CLOSED SIGN
- ⚡ TEMPORARY INFORMATION SIGN/TRAFFIC CONTROL SIGN

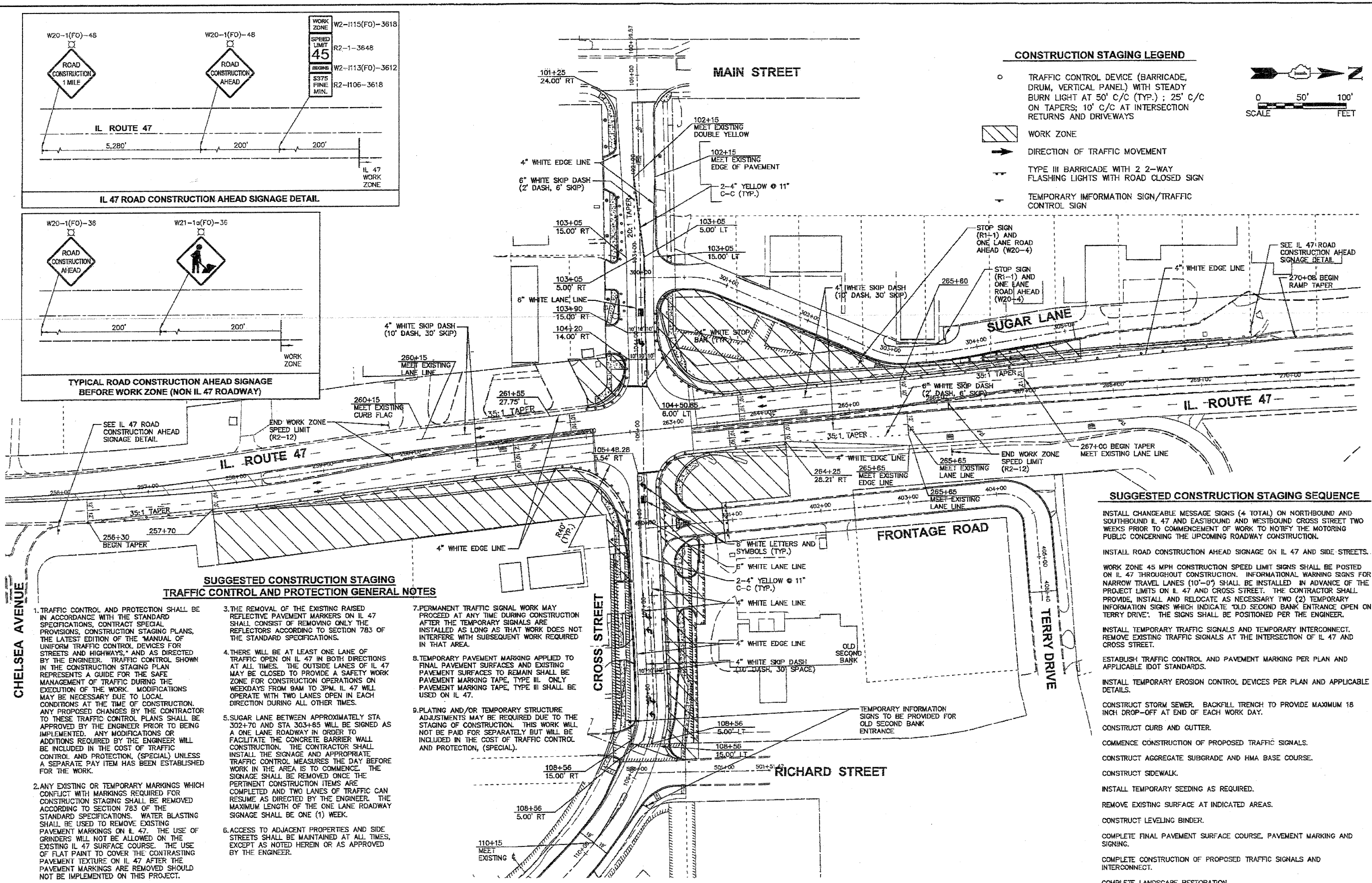
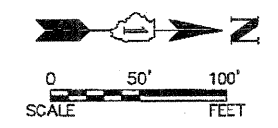

**SUGGESTED CONSTRUCTION STAGING TRAFFIC CONTROL AND PROTECTION GENERAL NOTES**

1. TRAFFIC CONTROL AND PROTECTION SHALL BE IN ACCORDANCE WITH THE STANDARD SPECIFICATIONS, CONTRACT SPECIAL PROVISIONS, CONSTRUCTION STAGING PLANS, THE LATEST EDITION OF THE 'MANUAL OF UNIFORM TRAFFIC CONTROL DEVICES FOR STREETS AND HIGHWAYS,' AND AS DIRECTED BY THE ENGINEER. TRAFFIC CONTROL SHOWN IN THE CONSTRUCTION STAGING PLAN REPRESENTS A GUIDE FOR THE SAFE MANAGEMENT OF TRAFFIC DURING THE EXECUTION OF THE WORK. MODIFICATIONS MAY BE NECESSARY DUE TO LOCAL CONDITIONS AT THE TIME OF CONSTRUCTION. ANY PROPOSED CHANGES BY THE CONTRACTOR TO THESE TRAFFIC CONTROL PLANS SHALL BE APPROVED BY THE ENGINEER PRIOR TO BEING IMPLEMENTED. ANY MODIFICATIONS OR ADDITIONS REQUIRED BY THE ENGINEER WILL BE INCLUDED IN THE COST OF TRAFFIC CONTROL AND PROTECTION, (SPECIAL) UNLESS A SEPARATE PAY ITEM HAS BEEN ESTABLISHED FOR THE WORK.
2. ANY EXISTING OR TEMPORARY MARKINGS WHICH CONFLICT WITH MARKINGS REQUIRED FOR CONSTRUCTION STAGING SHALL BE REMOVED ACCORDING TO SECTION 783 OF THE STANDARD SPECIFICATIONS. WATER BLASTING SHALL BE USED TO REMOVE EXISTING PAVEMENT MARKINGS ON IL 47. THE USE OF GRINDERS WILL NOT BE ALLOWED ON THE EXISTING IL 47 SURFACE COURSE. THE USE OF FLAT PAINT TO COVER THE CONTRASTING PAVEMENT TEXTURE ON IL 47 AFTER THE PAVEMENT MARKINGS ARE REMOVED SHOULD NOT BE IMPLEMENTED ON THIS PROJECT.
3. THE REMOVAL OF THE EXISTING RAISED REFLECTIVE PAVEMENT MARKERS ON IL 47 SHALL CONSIST OF REMOVING ONLY THE REFLECTORS ACCORDING TO SECTION 783 OF THE STANDARD SPECIFICATIONS.
4. THERE WILL BE AT LEAST ONE LANE OF TRAFFIC OPEN ON IL 47 IN BOTH DIRECTIONS AT ALL TIMES. THE OUTSIDE LANES OF IL 47 MAY BE CLOSED TO PROVIDE A SAFETY WORK ZONE FOR CONSTRUCTION OPERATIONS ON WEEKDAYS FROM 9AM TO 3PM. IL 47 WILL OPERATE WITH TWO LANES OPEN IN EACH DIRECTION DURING ALL OTHER TIMES.
5. SUGAR LANE BETWEEN APPROXIMATELY STA 302+70 AND STA 303+65 WILL BE SIGNED AS A ONE LANE ROADWAY IN ORDER TO FACILITATE THE CONCRETE BARRIER WALL CONSTRUCTION. THE CONTRACTOR SHALL INSTALL THE SIGNAGE AND APPROPRIATE TRAFFIC CONTROL MEASURES THE DAY BEFORE WORK IN THE AREA IS TO COMMENCE. THE SIGNAGE SHALL BE REMOVED ONCE THE PERTINENT CONSTRUCTION ITEMS ARE COMPLETED AND TWO LANES OF TRAFFIC CAN RESUME AS DIRECTED BY THE ENGINEER. THE MAXIMUM LENGTH OF THE ONE LANE ROADWAY SIGNAGE SHALL BE ONE (1) WEEK.
6. ACCESS TO ADJACENT PROPERTIES AND SIDE STREETS SHALL BE MAINTAINED AT ALL TIMES, EXCEPT AS NOTED HEREIN OR AS APPROVED BY THE ENGINEER.
7. PERMANENT TRAFFIC SIGNAL WORK MAY PROCEED AT ANY TIME DURING CONSTRUCTION AFTER THE TEMPORARY SIGNALS ARE INSTALLED AS LONG AS THAT WORK DOES NOT INTERFERE WITH SUBSEQUENT WORK REQUIRED IN THAT AREA.
8. TEMPORARY PAVEMENT MARKING APPLIED TO FINAL PAVEMENT SURFACES AND EXISTING PAVEMENT SURFACES TO REMAIN SHALL BE PAVEMENT MARKING TAPE. TYPE III ONLY PAVEMENT MARKING TAPE, TYPE III SHALL BE USED ON IL 47.
9. PLATING AND/OR TEMPORARY STRUCTURE ADJUSTMENTS MAY BE REQUIRED DUE TO THE STAGING OF CONSTRUCTION. THIS WORK WILL NOT BE PAID FOR SEPARATELY BUT WILL BE INCLUDED IN THE COST OF TRAFFIC CONTROL AND PROTECTION, (SPECIAL).

**SUGGESTED CONSTRUCTION STAGING SEQUENCE**

- INSTALL CHANGEABLE MESSAGE SIGNS (4 TOTAL) ON NORTHBOUND AND SOUTHBOUND IL 47 AND EASTBOUND AND WESTBOUND CROSS STREET TWO WEEKS PRIOR TO COMMENCEMENT OF WORK TO NOTIFY THE MOTORING PUBLIC CONCERNING THE UPCOMING ROADWAY CONSTRUCTION.
- INSTALL ROAD CONSTRUCTION AHEAD SIGNAGE ON IL 47 AND SIDE STREETS.
- WORK ZONE 45 MPH CONSTRUCTION SPEED LIMIT SIGNS SHALL BE POSTED ON IL 47 THROUGHOUT CONSTRUCTION. INFORMATIONAL WARNING SIGNS FOR NARROW TRAVEL LANES (10'-0") SHALL BE INSTALLED IN ADVANCE OF THE PROJECT LIMITS ON IL 47 AND CROSS STREET. THE CONTRACTOR SHALL PROVIDE, INSTALL AND RELOCATE AS NECESSARY TWO (2) TEMPORARY INFORMATION SIGNS WHICH INDICATE 'OLD SECOND BANK ENTRANCE OPEN ON TERRY DRIVE'. THE SIGNS SHALL BE POSITIONED PER THE ENGINEER.
- INSTALL TEMPORARY TRAFFIC SIGNALS AND TEMPORARY INTERCONNECT. REMOVE EXISTING TRAFFIC SIGNALS AT THE INTERSECTION OF IL 47 AND CROSS STREET.
- ESTABLISH TRAFFIC CONTROL AND PAVEMENT MARKING PER PLAN AND APPLICABLE IDOT STANDARDS.
- INSTALL TEMPORARY EROSION CONTROL DEVICES PER PLAN AND APPLICABLE DETAILS.
- CONSTRUCT STORM SEWER. BACKFILL TRENCH TO PROVIDE MAXIMUM 18 INCH DROP-OFF AT END OF EACH WORK DAY.
- CONSTRUCT CURB AND GUTTER.
- COMMENCE CONSTRUCTION OF PROPOSED TRAFFIC SIGNALS.
- CONSTRUCT AGGREGATE SUBGRADE AND HMA BASE COURSE.
- CONSTRUCT SIDEWALK.
- INSTALL TEMPORARY SEEDING AS REQUIRED.
- REMOVE EXISTING SURFACE AT INDICATED AREAS.
- CONSTRUCT LEVELING BINDER.
- COMPLETE FINAL PAVEMENT SURFACE COURSE, PAVEMENT MARKING AND SIGNING.
- COMPLETE CONSTRUCTION OF PROPOSED TRAFFIC SIGNALS AND INTERCONNECT.
- COMPLETE LANDSCAPE RESTORATION.

2012 Engineering Enterprises, Inc. 22323  
 2012 © 3:03 PM By: Kihl Pung - Tab: 23 - Const Staging - 22323  
 2012 © 3:03 PM By: Kihl Pung - Tab: 23 - Const Staging - 22323

Engineering Enterprises, Inc. CONSULTING ENGINEERS 52 Wheeler Road Sugar Grove, Illinois 60554 630.466.6700 / www.eeiweb.com	USER NAME =	DESIGNED -	REVISED -
	PLTJ SCALE =	CHECKED -	REVISED -
	PLTJ DATE =	DATE -	REVISED -

STATE OF ILLINOIS  
DEPARTMENT OF TRANSPORTATION

SUGGESTED CONSTRUCTION STAGING PLAN			
SCALE: 1"=50'	SHEET NO. 2 OF 2 SHEETS	STA. N/A	TO STA. N/A

F.A.P. RTE.	SECTION	COUNTY	TOTAL SHEETS	SHEET NO.
326	10-00023-00-ES	KANE	70	23
CONTRACT NO. 63700				
FED. ROAD DIST. NO. 1 (ILLINOIS) FED. AID PROJECT NO. M-8003(11)				