

Plotted: February 20, 2012 @ 11:00 AM By: Kris Pung - Tab: 61 - 47 Section - 22x34
 COPYRIGHT © 2012 ENGINEERING ENTERPRISES, INC.

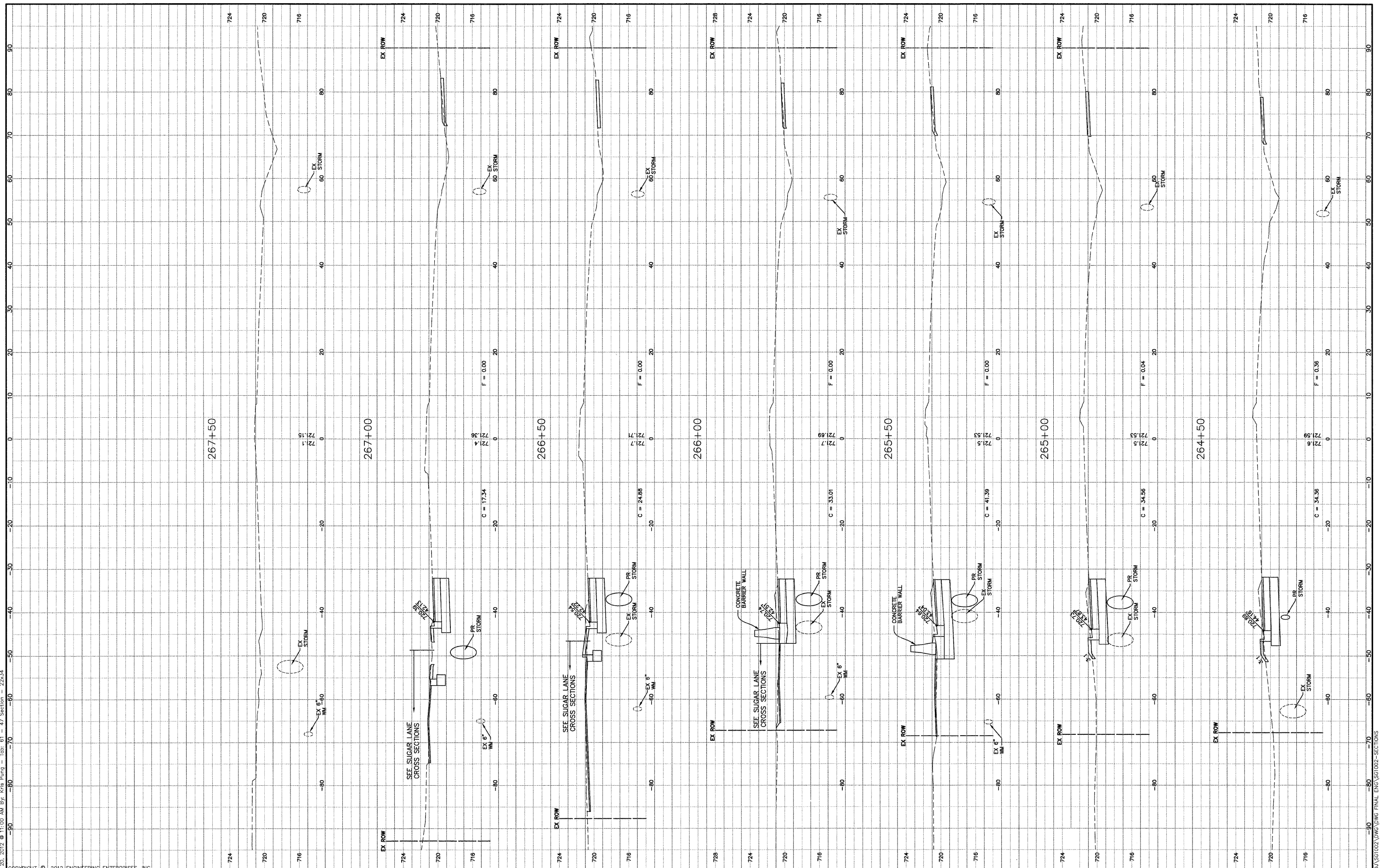

Engineering Enterprises, Inc.
 CONSULTING ENGINEERS
 52 Wheeler Road
 Sugar Grove, Illinois 60554
 630.466.6700 / www.eeiweb.com

| | |
|--------------|------------|
| USER NAME = | DESIGNED - |
| PLOT SCALE = | DRAWN - |
| PLOT DATE = | CHECKED - |
| | DATE - |

| |
|----------|
| REVISD - |
| REVISD - |
| REVISD - |
| REVISD - |

**STATE OF ILLINOIS
 DEPARTMENT OF TRANSPORTATION**

IL ROUTE 47 - CROSS SECTIONS

SCALE: H¹/₄"=10' - V¹/₄"=5' SHEET NO. 3 OF 12 SHEETS STA. 264+50 TO STA. 267+50

| | | | | |
|---|---------------------------|----------------|--------------------|-----------------|
| F.A.P. RTE. 326 | SECTION 10-00023-00-ES | COUNTY KANE | TOTAL SHEETS 70 | SHEET NO. 61 |
| FED. ROAD DIST. NO. 1 ILLINOIS FED. AID PROJECT NO. M-9003(717) | | | CONTRACT NO. 63700 | |

Path: H:\SG1002\DWG\046 FINAL ENG\SG1002-SECTIONS