

Plotted: February 20, 2012 @ 11:00 AM By: Kris Pung - Tab. 62 - Cross Section - 22x34
 COPYRIGHT © 2012 ENGINEERING ENTERPRISES, INC.

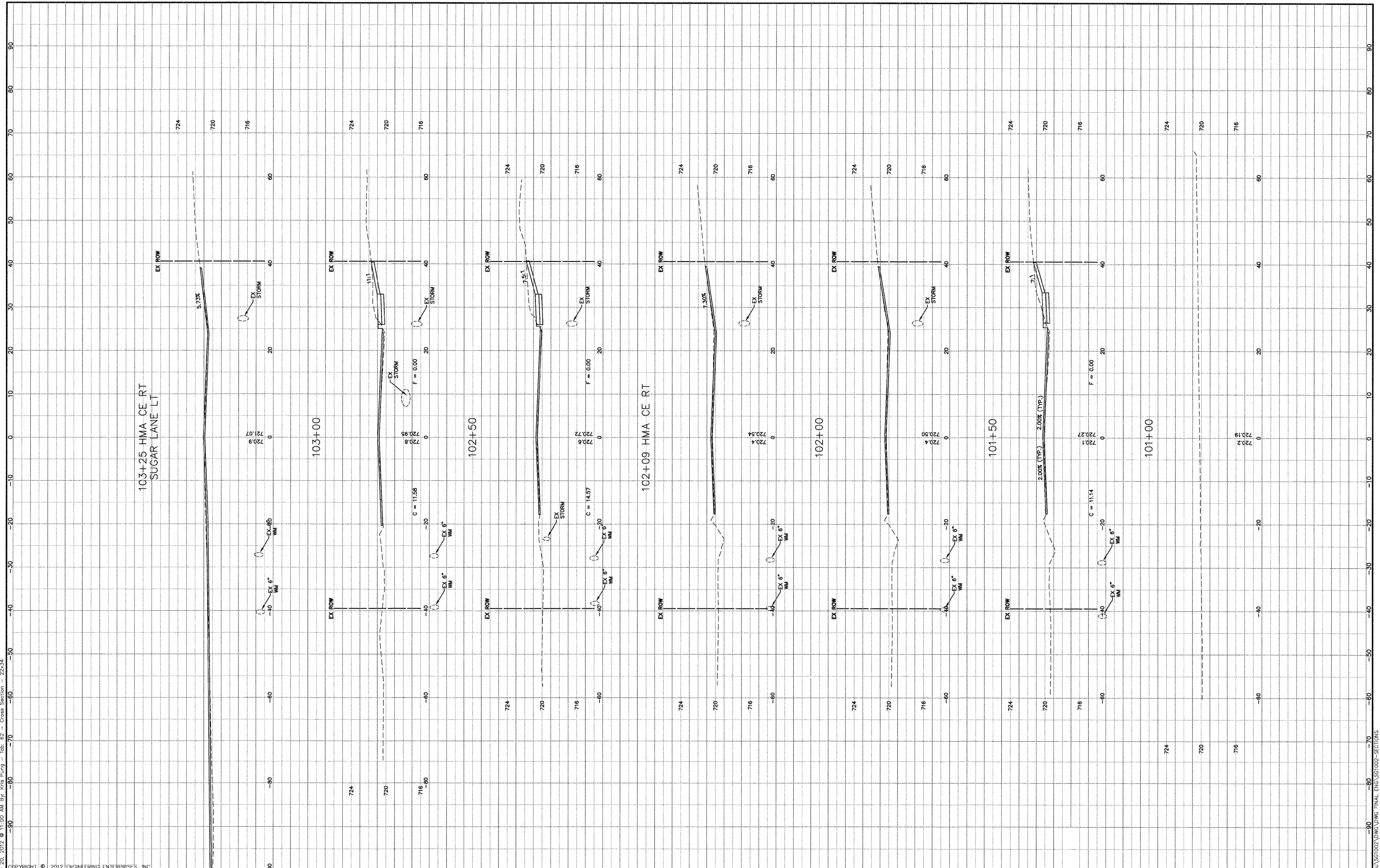

Engineering Enterprises, Inc.
 CONSULTING ENGINEERS
 52 Wheeler Road
 Sugar Grove, Illinois 60554
 630.466.8700 / www.eeiweb.com

USER NAME =
 PLOT SCALE =
 PLOT DATE =

DESIGNED -	REVISED -
DRAWN -	REVISED -
CHECKED -	REVISED -
DATE -	REVISED -

**STATE OF ILLINOIS
 DEPARTMENT OF TRANSPORTATION**

CROSS STREET - CROSS SECTIONS

SCALE: H¹/₄"=10' - V¹/₄"=5' SHEET NO. 4 OF 12 SHEETS STA. 101+00 TO STA. 103+25

F.A.P. RTE. 326	SECTION 10-00023-00-ES	COUNTY KANE	TOTAL SHEETS 70	SHEET NO. 62
FED. ROAD DIST. NO. 1 ILLINOIS FED. AID PROJECT NO. M-9003(717)			CONTRACT NO. 63700	