

PROGRAM AND OFFICE ENGINEER: CHARLES F. RIDDLE, P.E. (847) 705-4406, SCHALMURG, IL

INDEX OF SHEETS	
1	TITLE SHEET
2	SUMMARY OF QUANTITIES
3	TYPICAL SECTIONS & GENERAL NOTES
4-12	REMINGTON BLVD. RESURFACING PLANS
13-20	DISTRICT 1 STANDARD DETAILS

INDEX OF DISTRICT 1 STANDARD DETAILS	
STANDARD	TITLE
BD-08	DETAILS FOR FRAMES AND LIDS ADJUSTMENT WITH MILLING
BD-32	BUTT JOINT AND HMA TAPER DETAILS
TC-10	TRAFFIC CONTROL AND PROTECTION FOR SIDEROADS, INTERSECTIONS AND DRIVEWAYS
TC-13	DISTRICT 1 TYPICAL PAVEMENT MARKINGS
TC-14	TRAFFIC CONTROL AND PROTECTION AT TURN BAYS (TO REMAIN OPEN TO TRAFFIC)
TC-16	PAVEMENT MARKING LETTERS AND SYMBOLS FOR TRAFFIC STAGING
TC-22	ARTERIAL ROAD INFORMATION SIGNS
TC-26	DRIVEWAY ENTRANCE SIGNS

INDEX OF APPLICABLE HIGHWAY STANDARDS	
STANDARD	TITLE
000001-06	STANDARD SYMBOLS, ABBREVIATIONS AND PATTERNS
424001-06	PERPENDICULAR CURB RAMPS
424006	DIAGONAL CURB RAMPS FOR SIDEWALK
606001-04	CONCRETE CURB TYPE B AND COMBINATION CONCRETE CURB AND GUTTER
701426-04	LANE CLOSURE, MULTILANE, INTERMITTENT OR MOVING OPER., FOR SPEED $\geq$ 45 MPH
701427	LANE CLOSURE, MULTILANE, INTERMITTENT OR MOVING OPER., FOR SPEED $\leq$ 40 MPH
701601-07	URBAN LANE CLOSURE, MULTILANE, 1W OR 2W WITH NON TRANSFERABLE MEDIAN
701701-08	URBAN LANE CLOSURE, MULTILANE INTERSECTION
701801-05	SIDEWALK, CORNER OR CROSSWALK CLOSURE
701901-02	TRAFFIC CONTROL DEVICES
780001-03	TYPICAL PAVEMENT MARKINGS

**SCALES**

FULL SIZE PLANS (22 x 34) HAVE BEEN PREPARED USING STANDARD ENGINEERING SCALES. REDUCED SIZED PLANS (11 x 17) WILL CONFORM TO REDUCED SCALES. IN MAKING MEASUREMENTS ON REDUCED PLANS, THE ABOVE SCALES MAY BE USED.

DESIGN SPEED: 45 MPH  
 POSTED SPEED: 45 MPH  
 COLLECTOR ADT: 22,451

STATE OF ILLINOIS  
 DEPARTMENT OF TRANSPORTATION  
 DIVISION OF HIGHWAYS

PLANS FOR PROPOSED  
 FEDERAL AID HIGHWAY  
 REMINGTON BOULEVARD  
 SCHMIDT ROAD TO QUADRANGLE DRIVE  
 RESURFACING

SECTION: 11-00057-00-RS  
 PROJECT HPP-2961(100)  
 VILLAGE OF BOLINGBROOK  
 WILL COUNTY  
 C-91-254-12

SECTION	COUNTY	TOTAL SHEETS	SHEET NO.
11-00057-00-RS	WILL	20	1
ILLINOIS	CONTRACT NO.	63706	

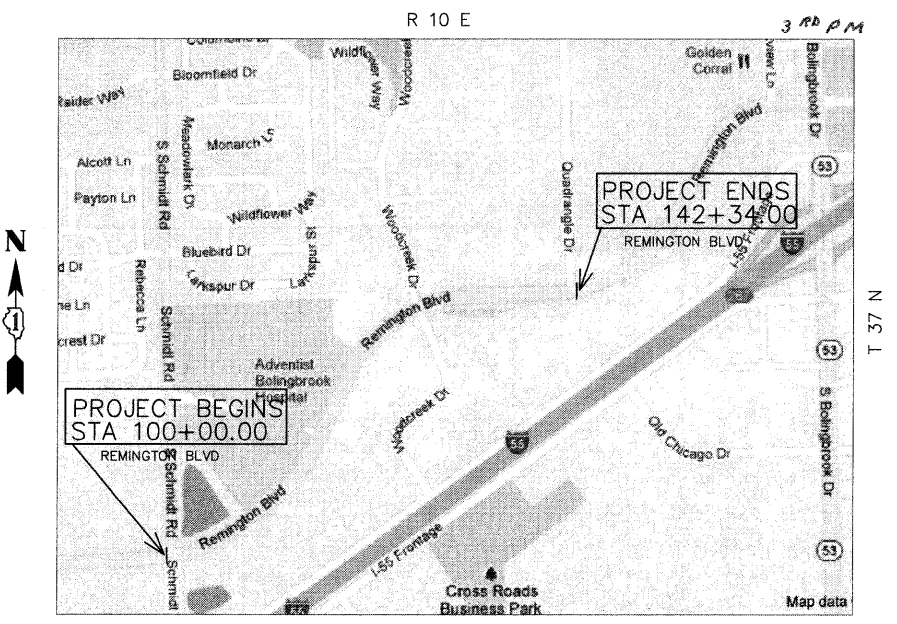
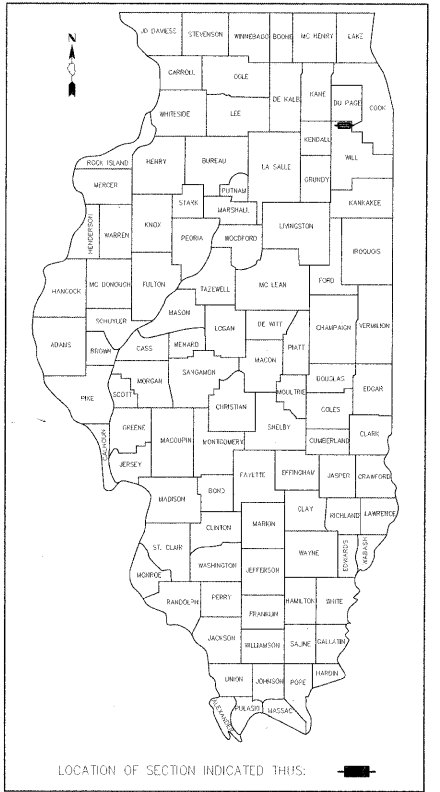

DU PAGE TOWNSHIP  
**LOCATION MAP**  
 (NOT TO SCALE)

GROSS LENGTH OF PROJECT : 4,234 FT = 0.8018 MILE  
 NET LENGTH OF PROJECT: 4,234 FT = 0.8018 MILE

ILLINOIS DEPARTMENT OF TRANSPORTATION

APPROVED March 21, 2012  
*Michael Drey*  
 VILLAGE OF BOLINGBROOK, DIRECTOR OF PUBLIC WORKS

PASSED APRIL 5, 2012  
*C. Holt*  
 DISTRICT 1 ENGINEER OF LOCAL ROADS & STREETS

Releasing For Bid Based on Limited Review APRIL 6, 2012  
*Diane M. O'Keefe*  
 DEPUTY DIRECTOR OF HIGHWAYS, REGION 1 ENGINEER

CALL **J.U.L.I.E.** (JOINT UTILITY LOCATING INFORMATION FOR EXCAVATORS)  
 48 Hours (2 working days) Before You Dig.  
 TOLL FREE: 1 (800) 892-0123

CONTRACT NO. 63706

*Pratik Patel*  
  
 PRATIK PATEL ILLINOIS P.E. 062-051388  
 VILLAGE OF BOLINGBROOK  
 EXPIRES 11/30/2013

PRINTED BY THE AUTHORITY  
 OF THE STATE OF ILLINOIS

DATE  
 3-20-2012