

F.A.P. RTE.	SECTION	COUNTY	TOTAL SHEETS	SHEET NO.
653	7RS-3 & 8RS-4	LASALLE	23	1
		ILLINOIS	CONTRACT NO. 66B82	

STATE OF ILLINOIS  
DEPARTMENT OF TRANSPORTATION  
DIVISION OF HIGHWAYS  
**PROPOSED  
HIGHWAY PLANS**

**INDEX OF SHEETS**

1	COVER SHEET & HIGHWAY STANDARDS
2	GENERAL NOTES
3-6	SUMMARY OF QUANTITIES
7-10	TYPICAL SECTIONS
11-13	SCHEDULE OF QUANTITIES
14-17	PLAN VIEWS
18-23	DETAILS

**LIST OF ILLINOIS DOT HIGHWAY STANDARDS**

000001-06	STANDARD SYMBOLS, ABBREVIATIONS AND PATTERNS
424001-06	PERPENDICULAR CURB RAMPS FOR SIDEWALKS
424006	DIAGONAL CURB RAMPS FOR SIDEWALKS
424011	CORNER PARALLEL CURB RAMPS FOR SIDEWALKS
424016	MID-BLOCK CURB RAMPS FOR SIDEWALKS
424021	DEPRESSED CORNER FOR SIDEWALKS
424026	ENTRANCE / ALLEY PEDESTRIAN CROSSINGS
424031	MEDIAN PEDESTRIAN CROSSINGS
442201-03	CLASS C AND D PATCHES
604001-03	FRAME AND LIDS, TYPE 1
604051-03	FRAME AND GRATE, TYPE 11
606001-04	CONCRETE CURB TYPE B AND COMBINATION CONCRETE CURB AND GUTTER
701427	LANE CLOSURE, MULTILANE INTERMITTENT OR MOVING OPERATION, FOR SPEEDS ≤ 40 MPH
701601-07	URBAN LANE CLOSURE, MULTILANE, 1W OR 2W WITH NONTRAVERSABLE MEDIAN
701701-08	URBAN LANE CLOSURE, MULTILANE INTERSECTION
701801-05	LANE CLOSURE, MULTILANE 1W OR 2W CROSSWALK OR SIDEWALK CLOSURE
701901-02	TRAFFIC CONTROL DEVICES
781001-03	TYPICAL APPLICATIONS RAISED REFLECTIVE PAVEMENT MARKERS
886001-01	DETECTOR LOOP INSTALLATIONS
886006-01	TYPICAL LAYOUT FOR DETECTION LOOPS

**FAP ROUTE 653 (IL 18 EB)  
SECTION 7RS-3 & 8RS-4  
PROJECT: F-0653(029)  
3P MILLING AND RESURFACING  
LASALLE COUNTY**

C-93-041-12

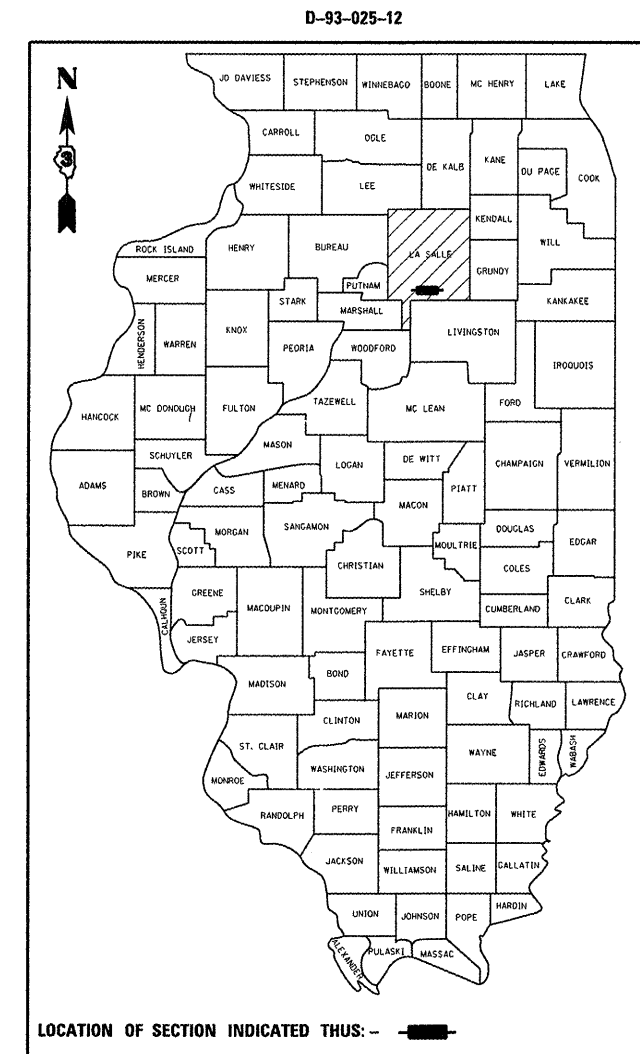

**OTHER PRINCIPAL ARTERIAL**

**WEST OF PARK ST (IL 23 NB)**  
ADT = 4850  
PV = 94.17% SU = 0.74% MU = 5.09%

**EAST OF PARK ST (IL 23 NB)**  
ADT = 3950  
PV = 93.03% SU = 1.27% MU = 5.7%

MICROFILMED \_\_\_\_\_  
REEL NUMBER \_\_\_\_\_  
AWARDED \_\_\_\_\_  
RESIDENT ENGINEER \_\_\_\_\_  
AS BUILT CHANGES WERE MADE  
ON THE FOLLOWING SHEETS \_\_\_\_\_



FULL SIZE PLANS HAVE BEEN PREPARED USING STANDARD ENGINEERING SCALES. REDUCED SIZED PLANS WILL NOT CONFORM TO STANDARD SCALES. IN MAKING MEASUREMENTS ON REDUCED PLANS, THE ABOVE SCALES MAY BE USED.

J.U.L.I.E.  
JOINT UTILITY LOCATION INFORMATION FOR EXCAVATION  
1-800-892-0123  
OR 811

**PROJECT ENGINEER: JOE KANNEL P.E.**  
**UNIT CHIEF: BRAD DUNCAN P.E.**  
**CONTRACT NO. 66B82**

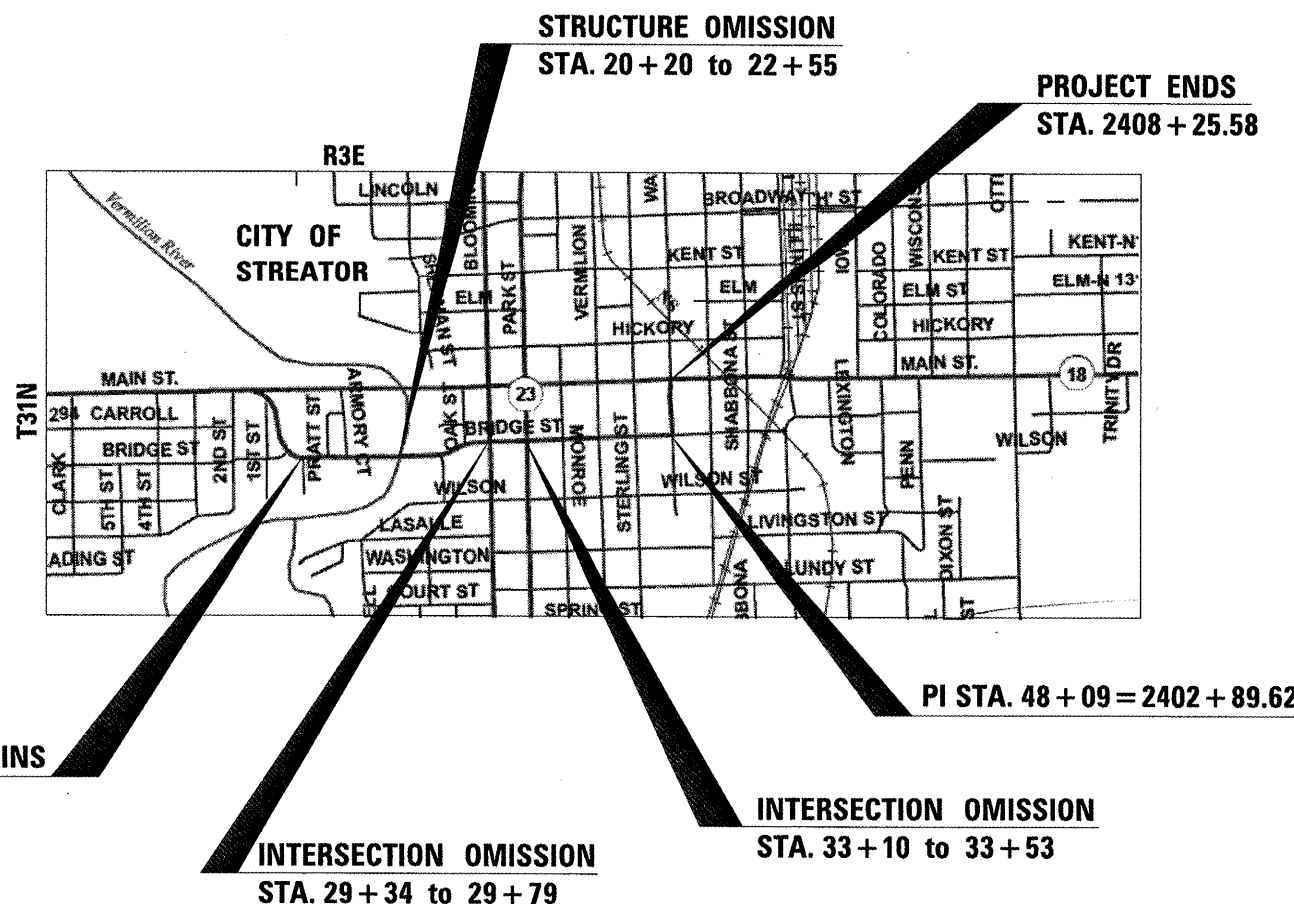

GROSS LENGTH = 4027 FT. = 0.76 MILES  
NET LENGTH = 3704 FT. = 0.70 MILES

STATE OF ILLINOIS  
DEPARTMENT OF TRANSPORTATION  
DIVISION OF HIGHWAYS

SUBMITTED March 23 2012  
Eric S. Therkildsen  
DEPUTY DIRECTOR OF HIGHWAYS, REGION ENGINEER

May 11 2012  
John D. Baranzelli P.E. Jr.  
acting ENGINEER OF DESIGN AND ENVIRONMENT

May 11 2012  
William R. Franke  
acting DIRECTOR OF HIGHWAYS, CHIEF ENGINEER

**PRINTED BY THE AUTHORITY  
OF THE STATE OF ILLINOIS**

GENERAL NOTES

THE THICKNESS OF HMA SHOWN ON THE PLANS IS THE NOMINAL THICKNESS. DEVIATIONS FROM THE NOMINAL THICKNESS WILL BE PERMITTED WHEN SUCH DEVIATIONS OCCUR DUE TO IRREGULARITIES IN THE EXISTING SURFACE OR BASE ON WHICH THE HMA IS PLACED.

THE HMA SURFACE OF ALL MAILBOX TURNOUTS, PRIVATE ENTRANCES, COMMERCIAL ENTRANCES, AND SIDE ROADS SHALL BE MADE NEATLY, IN A WORKMANLIKE MANNER, AND SHALL ACCURATELY CONFORM TO THE SHAPES AND DIMENSIONS SHOWN ON THE PLAN DETAILS. IF REQUIRED BY THE ENGINEER, THE CONTRACTOR SHALL BE REQUIRED TO SAW CUT THE HMA SURFACE TO CONFORM TO THE SHAPES AND DIMENSIONS SHOWN ON THE PLAN DETAILS. THIS WORK SHALL BE INCLUDED IN THE COST OF THE HMA SURFACE.

THE ENGINEER WILL BE THE SOLE JUDGE CONCERNING CURING TIME FOR THE VARIOUS HMA LIFTS.

SEEDING SHALL NOT BE PERMITTED AT ANY TIME WHEN THE GROUND IS FROZEN, WET, OR IN AN UNTILLABLE CONDITION. LOCATIONS TO BE SEEDED WILL BE DETERMINED BY THE ENGINEER.

FOR NEW CONSTRUCTION, PLACE CURB RAMPS FOR SIDEWALKS AT ALL LOCATIONS WHERE PROPOSED SIDEWALK ABUTS CURB AT STREET ENTRANCES

ADA CURB RAMP CONSTRUCTION SHALL BE COMPLETED PRIOR TO THE MILLING OF THE ROADWAY.

ON EXISTING PAVEMENT WHICH MAY BE SUPERELEVATED, THE NEW HMA PAVEMENT SHALL BE BUILT WITH THE SAME SUPERELEVATION UNLESS NEW SUPERELEVATION RATES ARE GIVEN ON THE PLANS.

ANY REFERENCE TO A STANDARD IN THESE PLANS SHALL BE INTERPRETED TO MEAN THE EDITION AS INDICATED BY THE SUBNUMBER SHOWN IN THE LIST OF STANDARDS OR THE COPY INCLUDED IN THESE PLANS.

THE FOLLOWING RATES OF APPLICATION HAVE BEEN USED IN CALCULATING PLAN QUANTITIES:

GRANULAR MATERIALS	2.05	TONS / CU YD
AGGREGATE (PRIME COAT)	0.002	TONS / SQ YD
HMA RESURFACING	112	LBS / SQ YD / IN
SHORT TERM PAVEMENT MARKING	10	FT / 100 FT OF APPLICATION
MIX FOR CRACKS, JTS & FLGWYS	0.0003	TONS / SQ YD
LEVEL BINDER (HAND METHOD)	0.0005	TONS / SQ YD
SUPPLEMENTAL WATERING	3	GAL / SQ YD / APPLICATION
CALCIUM CHLORIDE	2	LB / SQ YD / APPLICATION
AGGREGATE DITCH CHECKS	5	TONS AGGREGATE

BITUMINOUS MATERIALS (PRIME COAT) RATES		
SURFACE TYPE	ESTIMATED TRUCK APPLICATION RATE	RESIDUAL RATE
AGGREGATE BASES	0.375 GAL / SQ YD	N/A
MILLED HMA OR PCC PAVEMENT	0.08 GAL / SQ YD	0.04 GAL / SQ YD
EXISTING PAVEMENT	0.05 GAL / SQ YD	0.025 GAL / SQ YD
FOG COAT (BETWEEN ADDITIONAL HMA LIFTS)	0.05 GAL / SQ YD	0.025 GAL / SQ YD

ESTIMATED TRUCK APPLICATION RATE USED FOR CALCULATING PLAN QUANTITIES

THE CONTRACTOR SHALL CONTACT JULIE AT LEAST 48 HOURS PRIOR TO EXCAVATION TO DETERMINE WHICH UTILITIES ARE IN THE AREA.

COMMITMENTS

1. ANY SURPLUS EXCAVATED EARTH MATERIAL REMAINING AFTER THE COMPLETION OF WORK SHALL REMAIN WITHIN THE PROJECT LIMITS.
2. THE CONTRACTOR SHALL PROVIDE FOR AN ALTERNATE ACCESSIBLE AND DETECTABLE SIDEWALK ROUTE WHENEVER AN EXISTING SIDEWALK IS DISRUPTED BY THE CONTRACTORS OPERATIONS. PRIORITY SHALL BE GIVEN TO SCHOOL CROSSWALKS AND DOWNTOWN/ COMMERCIAL AREAS. SIDEWALK RAMPS NOT COMPLETED AND OPENED TO PEDESTRIAN TRAFFIC IN A TIMELY MANNER AFTER REMOVAL OPERATIONS SHALL BE ACCESSIBLE USING A 3" COMPACTED AGGREGATE SURFACE. ALL COSTS ASSOCIATED WITH PROVIDING TEMPORARY SIDEWALK ACCOMMODATIONS WILL BE INCLUDED IN THE COST OF HIGHWAY STANDARD 701801.

STATE OF ILLINOIS  
DEPARTMENT OF TRANSPORTATION  
DISTRICT THREE

PREPARED BY: Dan Pyszczalski  
DISTRICT STUDIES & PLANS ENGINEER

DATE: March 23, 2012

EXAMINED BY: [Signature]  
DISTRICT CONSTRUCTION ENGINEER

Wann L. Phillips  
DISTRICT MATERIALS ENGINEER

[Signature]  
DISTRICT OPERATIONS ENGINEER

FILE NAME =	USER NAME = duncanbd	DESIGNED -	REVISED -	<b>STATE OF ILLINOIS DEPARTMENT OF TRANSPORTATION</b>	<b>GENERAL NOTES</b>	F.A.P. RTE.	SECTION	COUNTY	TOTAL SHEETS	SHEET NO.
c:\pw_work\pwork\duncanbd\d0285100\0365882-sht-cover.dgn	DRAWN -	REVISED -	653			7RS-3 & 8RS-4	LASALLE	23	2	
PLOT SCALE = 100.0000' / 1in.	CHECKED -	REVISED -	CONTRACT NO. 66882							
PLOT DATE = 3/23/2012	DATE -	REVISED -	ILLINOIS FED. AID PROJECT							
					SCALE:	SHEET NO.	OF SHEETS	STA.	TO STA.	

CODE NO.	ITEM	UNIT	TOTAL QUANTITY	CONSTR. CODE	
				80% FEDERAL	20% STATE
				ROADWAY	
				0005	
				URBAN	
40600100	BITUMINOUS MATERIALS (PRIME COAT)	GALLON	2030		2030
40600300	AGGREGATE (PRIME COAT)	TON	62		62
40600400	MIXTURE FOR CRACKS, JOINTS, AND FLANGEWAYS	TON	9		9
40600527	LEVELING BINDER (HAND METHOD), 1L-9.5FG, N50	TON	9		9
40600627	LEVELING BINDER (MACHINE METHOD), 1L-9.5FG, N50	TON	384		384
40600895	CONSTRUCTING TEST STRIP	EACH	1		1
40600990	TEMPORARY RAMP	SQ YD	700		700
40603080	HOT-MIX ASPHALT BINDER COURSE, 1L-19.0, N50	TON	687		687
40603510	POLYMERIZED HOT-MIX ASPHALT SURFACE COURSE, MIX "C", N50	TON	1227		1227
40800050	INCIDENTAL HOT-MIX ASPHALT SURFACING	TON	143		143
42400100	PORTLAND CEMENT CONCRETE SIDEWALK 4 INCH	SQ FT	3646		3646
42400800	DETECTABLE WARNINGS	SQ FT	432		432
44000155	HOT-MIX ASPHALT SURFACE REMOVAL, 1 1/2"	SQ YD	1693		1693
44000158	HOT-MIX ASPHALT SURFACE REMOVAL, 2 1/4"	SQ YD	9118		9118

FILE NAME =	USER NAME = duncanbd	DESIGNED -	REVISED -
et\pwwork\pwwork\duncanbd\0285100\036882-sht-500.dgn		DRAWN -	REVISED -
		CHECKED -	REVISED -
		DATE -	REVISED -

**STATE OF ILLINOIS  
DEPARTMENT OF TRANSPORTATION**

SUMMARY OF QUANTITIES			
SCALE:	SHEET NO. 1 OF 4 SHEETS	STA.	TO STA.

F.A.P. RTE.	SECTION	COUNTY	TOTAL SHEETS	SHEET NO.
653	7RS-3 & 8RS-4	LASALLE	23	3
CONTRACT NO. 66B82				
ILLINOIS FED. AID PROJECT				

CODE NO.	ITEM	UNIT	TOTAL QUANTITY	CONSTR. CODE
				80% FEDERAL 20% STATE ROADWAY 0005 URBAN
44000164	HOT-MIX ASPHALT SURFACE REMOVAL, 3 3/4"	SO YD	5452	5452
44000500	COMBINATION CURB AND GUTTER REMOVAL	FOOT	516	516
44000600	SIDEWALK REMOVAL	SO FT	3474	3474
44300200	STRIP REFLECTIVE CRACK CONTROL TREATMENT	FOOT	3704	3704
56109210	WATER VALVES TO BE ADJUSTED	EACH	2	2
60255800	MANHOLES TO BE ADJUSTED WITH NEW TYPE 1 FRAME, CLOSED LID	EACH	13	13
60261300	INLETS TO BE ADJUSTED WITH NEW TYPE 11 FRAME AND GRATE	EACH	10	10
60600605	CONCRETE CURB, TYPE B	FOOT	20	20
60603800	COMBINATION CONCRETE CURB AND GUTTER, TYPE B-6.12	FOOT	480	480
60605000	COMBINATION CONCRETE CURB AND GUTTER, TYPE B-6.24	FOOT	32	32
67100100	MOBILIZATION	L SUM	1	1
70102630	TRAFFIC CONTROL AND PROTECTION, STANDARD 701601	L SUM	1	1
70102635	TRAFFIC CONTROL AND PROTECTION, STANDARD 701701	L SUM	1	1
70102640	TRAFFIC CONTROL AND PROTECTION, STANDARD 701801	L SUM	1	1

FILE NAME =	USER NAME = duncanbd	DESIGNED -	REVISED -
c:\pwwork\pwwork\duncanbd\0285100\0366882-sh-t-500.dgn		DRAWN -	REVISED -
		CHECKED -	REVISED -
		DATE -	REVISED -

**STATE OF ILLINOIS  
DEPARTMENT OF TRANSPORTATION**

SUMMARY OF QUANTITIES			
SCALE:	SHEET NO. 2 OF 4 SHEETS	STA.	TO STA.

F.A.P. RTE.	SECTION	COUNTY	TOTAL SHEETS	SHEET NO.
653	7RS-3 & 8RS-4	LASALLE	23	4
			CONTRACT NO. 66B82	
ILLINOIS FED. AID PROJECT				

CODE NO.	ITEM	UNIT	TOTAL QUANTITY	CONSTR. CODE	
				80% FEDERAL	20% STATE
				ROADWAY	
				0005	
				URBAN	
70103815	TRAFFIC CONTROL SURVEILLANCE	CAL DA	10	10	
70300100	SHORT TERM PAVEMENT MARKING	FOOT	8798	8798	
70300210	TEMPORARY PAVEMENT MARKING LETTERS AND SYMBOLS	SQ FT	854	854	
70300220	TEMPORARY PAVEMENT MARKING - LINE 4"	FOOT	4028	4028	
70300240	TEMPORARY PAVEMENT MARKING - LINE 6"	FOOT	2801	2801	
70300250	TEMPORARY PAVEMENT MARKING - LINE 8"	FOOT	1494	1494	
70300260	TEMPORARY PAVEMENT MARKING - LINE 12"	FOOT	2258	2258	
70300280	TEMPORARY PAVEMENT MARKING - LINE 24"	FOOT	433	433	
70301000	WORK ZONE PAVEMENT MARKING REMOVAL	SQ FT	1946	1946	
△ 78000100	THERMOPLASTIC PAVEMENT MARKING - LETTERS AND SYMBOLS	SQ FT	426.6	426.6	
△ 78000200	THERMOPLASTIC PAVEMENT MARKING - LINE 4"	FOOT	2014	2014	
△ 78000400	THERMOPLASTIC PAVEMENT MARKING - LINE 6"	FOOT	1401	1401	
△ 78000500	THERMOPLASTIC PAVEMENT MARKING - LINE 8"	FOOT	747	747	
△ 78000600	THERMOPLASTIC PAVEMENT MARKING - LINE 12"	FOOT	1129	1129	

△ SPECIALTY ITEMS

FILE NAME =	USER NAME = duncanbd	DESIGNED -	REVISED -
ca:\pwwork\pwwork\duncanbd\0285100\0365882-sh1-500.dgn		DRAWN -	REVISED -
PLOT SCALE = 100.0000' / 1"		CHECKED -	REVISED -
PLOT DATE = 3/23/2012		DATE -	REVISED -

STATE OF ILLINOIS  
DEPARTMENT OF TRANSPORTATION

SUMMARY OF QUANTITIES

F.A.P. RTE.	SECTION	COUNTY	TOTAL SHEETS	SHEET NO.
653	7RS-3 & 8RS-4	LASALLE	23	5
CONTRACT NO. 66B82			ILLINOIS FED. AID PROJECT	
SCALE:	SHEET NO. 3 OF 4 SHEETS	STA.	TO STA.	

CODE NO.	ITEM	UNIT	TOTAL QUANTITY	CONSTR. CODE	
				80% FEDERAL ROADWAY	20% STATE ROADWAY
				0005	URBAN
△ 78000650	THERMOPLASTIC PAVEMENT MARKING - LINE 24"	FOOT	217		217
△ 78004230	PREFORMED PLASTIC PAVEMENT MARKING, TYPE B - INLAID - LINE 6"	FOOT	1009		1009
△ 78100100	RAISED REFLECTIVE PAVEMENT MARKER	EACH	69		69
△ 78200300	PRISMATIC CURB REFLECTOR	EACH	16		16
	78300200	RAISED REFLECTIVE PAVEMENT MARKER REMOVAL	EACH	53	53
△ 87301305	ELECTRIC CABLE IN CONDUIT, LEAD-IN, NO. 14 1 PAIR	FOOT	318		318
△ 88600100	DETECTOR LOOP, TYPE I	FOOT	565		565
△ X8860100	LOOP DETECTOR TESTING	EACH	1		1
	<b>X4420831</b>	CLASS D PATCHES, TYPE III, 15 INCH (SPECIAL)	SQ YD	32	32

△ SPECIALTY ITEMS

FILE NAME =	USER NAME = duncanbd	DESIGNED -	REVISED -
c:\pwwork\pwwork\duncanbd\0285100\0366882-sht-S00.dgn		DRAWN -	REVISED -
	PLOT SCALE = 100.0000' / 1"	CHECKED -	REVISED -
	PLOT DATE = 3/23/2012	DATE -	REVISED -

**STATE OF ILLINOIS  
DEPARTMENT OF TRANSPORTATION**

SUMMARY OF QUANTITIES			
SCALE:	SHEET NO.	4 OF 4 SHEETS	STA. TO STA.

F.A.P. RTE.	SECTION	COUNTY	TOTAL SHEETS	SHEET NO.
653	7RS-3 & 8RS-4	LASALLE	23	6
CONTRACT NO. 66B82				
[ILLINOIS] FED. AID PROJECT				

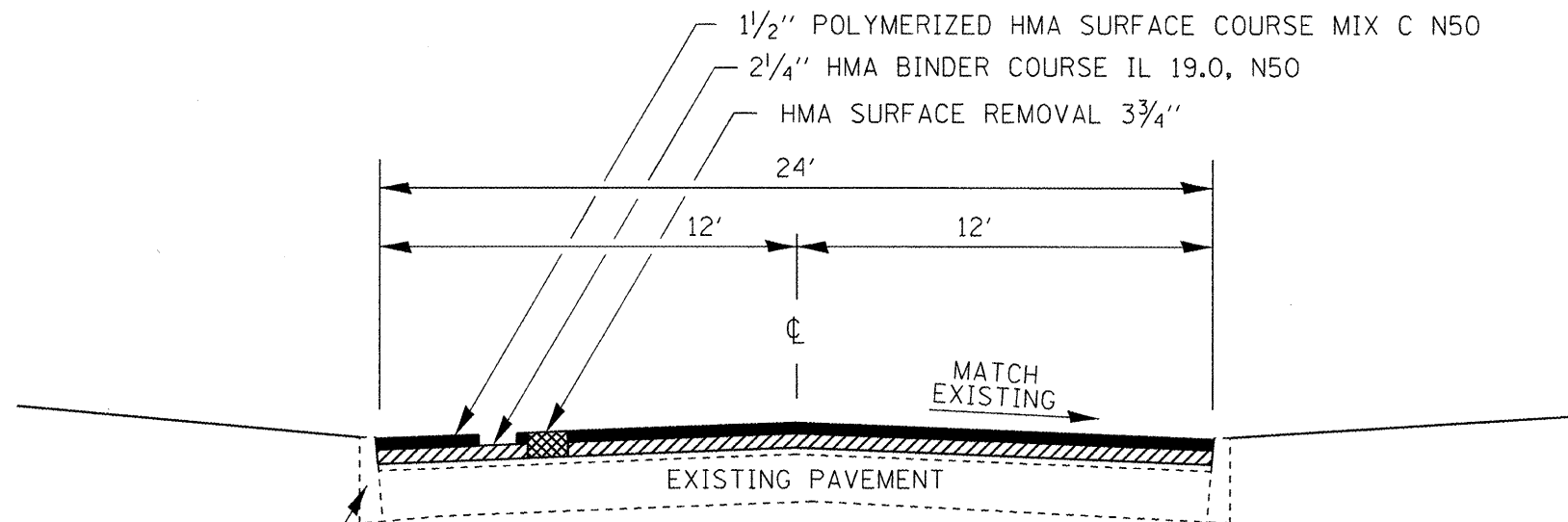

**BRIDGE ST. PROPOSED TYPICAL SECTION  
STA. 13+18 TO STA. 20+20**

EXISTING CURB

**MIXTURES TABLE**

	HMA SURFACE (POLY)	HMA BINDER	HMA LEVEL BINDER
PG GRADE	SBS PG70-22	PG 64-22	PG 64-22
DESIGN AIR VOIDS	4.0% @ N50	4.0% @ N50	4.0% @ N50
MIXTURE COMPOSITION	IL 9.5	IL 19.0	IL 9.5 FG
FRICTION AGGREGATE	MIXTURE C		
DENSITY CONTROL	CORES	CORES	CORES

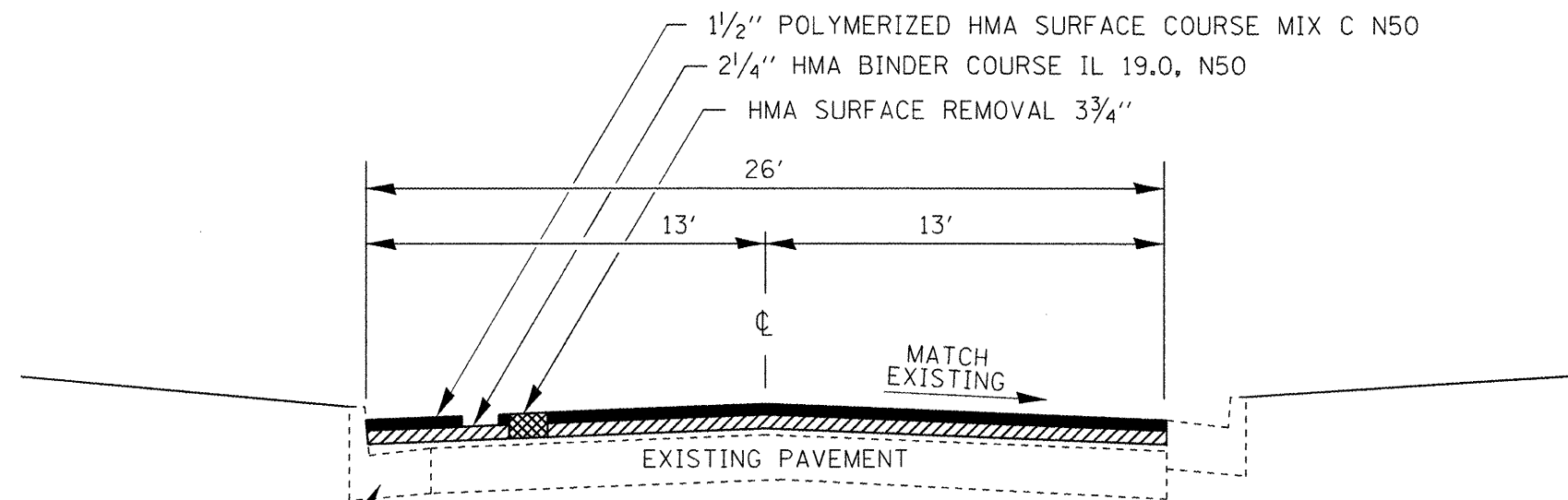

**BRIDGE ST. PROPOSED TYPICAL SECTION  
STA. 22+55 TO STA. 29+34**

EXISTING C & G

NOTE:  
STRIP REFLECTIVE CRACK CONTROL SHALL BE PLACED ALONG THE CENTERLINE THROUGH THE LENGTH OF THE PROJECT.

NOTE:  
DEPTH OF EXISTING HMA ABOVE THE PCC CURB AND GUTTER MAY BE LESS THAN PROPOSED SURFACE REMOVAL DEPTH.

FILE NAME =	USER NAME = duncanbd	DESIGNED -	REVISED -
c:\pwwork\p1dot\duncanbd\0285100\0366882-sh-typical.dgn		DRAWN -	REVISED -
PLOT SCALE = 100,0000' / in.		CHECKED -	REVISED -
PLOT DATE = 3/23/2012		DATE -	REVISED -

STATE OF ILLINOIS  
DEPARTMENT OF TRANSPORTATION

TYPICAL SECTIONS

SCALE: SHEET 1 OF 4 SHEETS STA. TO STA.

F.A.P. RTE.	SECTION	COUNTY	TOTAL SHEETS	SHEET NO.
653	7RS-3 & BRS-4	LASALLE	23	7
CONTRACT NO. 66882				
ILLINOIS FED. AID PROJECT				

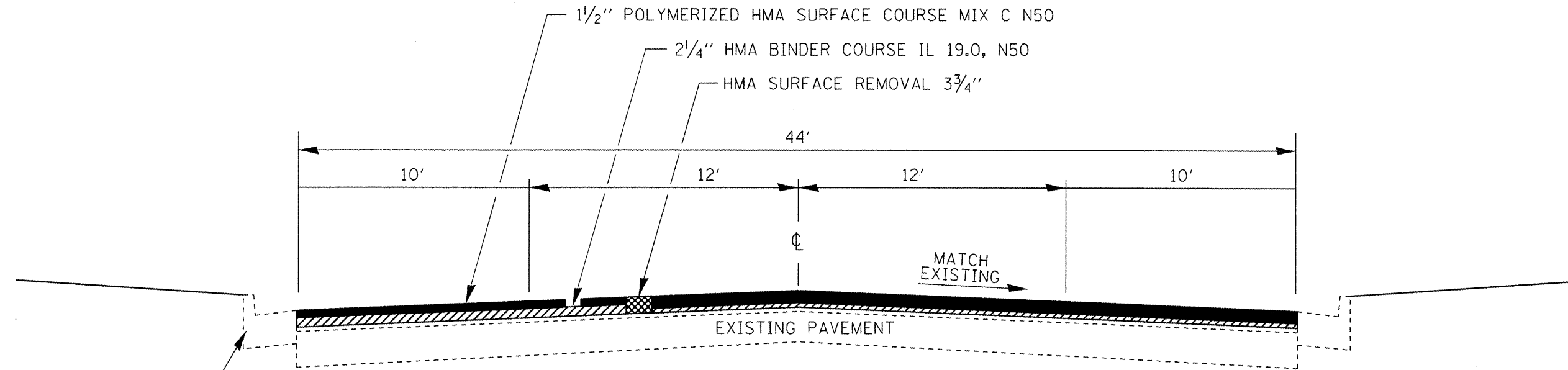

EXISTING C & G

**BRIDGE ST. PROPOSED TYPICAL SECTION  
STA. 29+79 TO STA. 33+10**

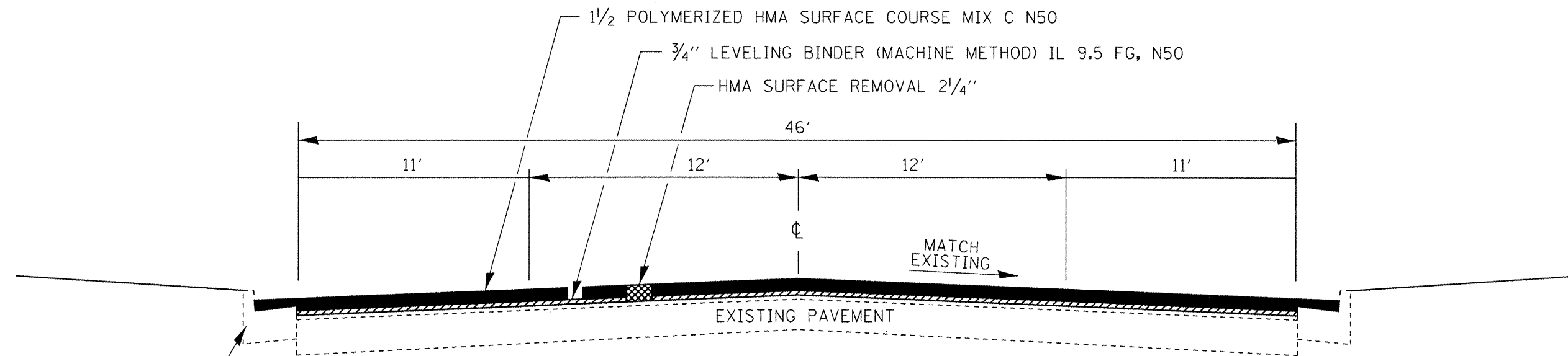

EXISTING C & G

**BRIDGE ST. PROPOSED TYPICAL SECTION  
STA. 33+53 TO STA. 44+70**

NOTE:  
DEPTH OF EXISTING HMA ABOVE THE PCC  
CURB AND GUTTER MAY BE LESS THAN  
PROPOSED SURFACE REMOVAL DEPTH.

FILE NAME =	USER NAME = duncenbd	DESIGNED -	REVISED -
c:\pwwork\p1dot\duncenbd\0205100\0366882-sh-typical.dgn		DRAWN -	REVISED -
	PLOT SCALE = 100.0000' / 1" =	CHECKED -	REVISED -
	PLOT DATE = 3/23/2012	DATE -	REVISED -

**STATE OF ILLINOIS  
DEPARTMENT OF TRANSPORTATION**

**TYPICAL SECTIONS**

SCALE: SHEET 2 OF 4 SHEETS STA. TO STA.

F.A.P. RTE.	SECTION	COUNTY	TOTAL SHEETS	SHEET NO.
653	7RS-3 & 8RS-4	LASALLE	23	8
CONTRACT NO. 66B82				
ILLINOIS FED. AID PROJECT				



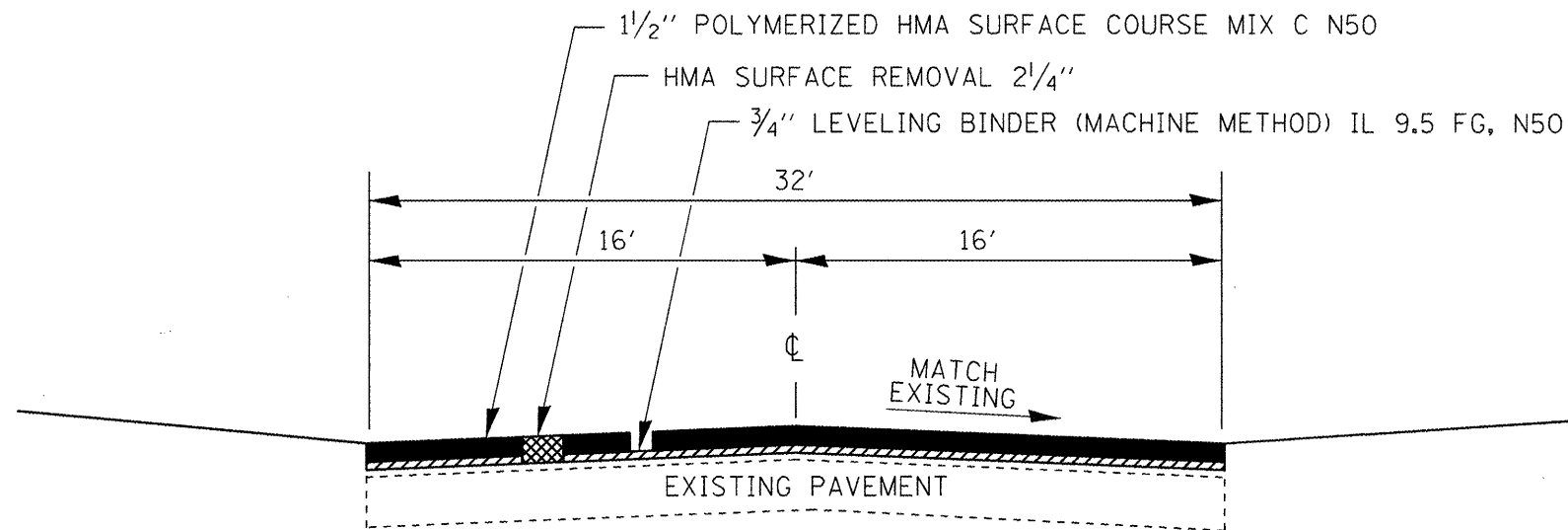

**BRIDGE ST. PROPOSED TYPICAL SECTION  
STA. 44 + 70 TO STA. 47 + 04**

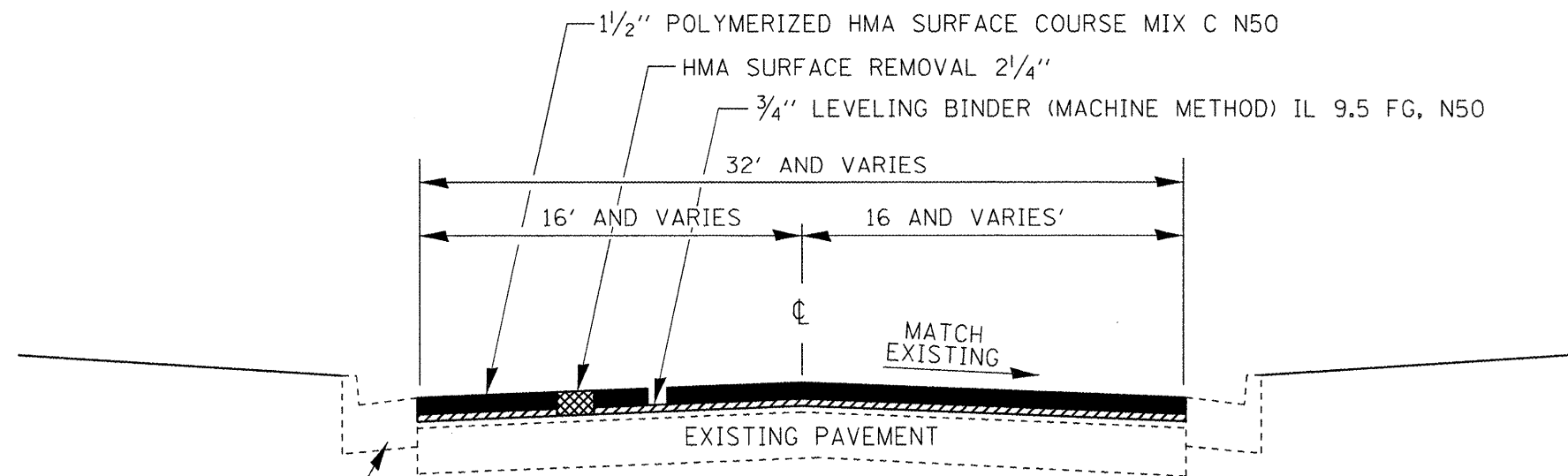

**BRIDGE ST. PROPOSED TYPICAL SECTION  
STA. 47 + 04 TO STA. 48 + 71**

STATION EQUATION  
STA. 48+09 BK = STA. 2402+89.62 AH

FILE NAME =	USER NAME = duncanbd	DESIGNED -	REVISED -	<b>STATE OF ILLINOIS DEPARTMENT OF TRANSPORTATION</b>	<b>TYPICAL SECTIONS</b>		F.A.P. RTE.	SECTION	COUNTY	TOTAL SHEETS	SHEET NO.		
c:\pwwork\pwwork\duncanbd\0285100\0366882-sh-typical.dgn		DRAWN -	REVISED -		SCALE:	SHEET 3 OF 4 SHEETS	STA.	TO STA.	653	7RS-3 & BRS-4	LASALLE	23	9
		CHECKED -	REVISED -		CONTRACT NO. 66B82								
		DATE -	REVISED -		ILLINOIS FED. AID PROJECT								

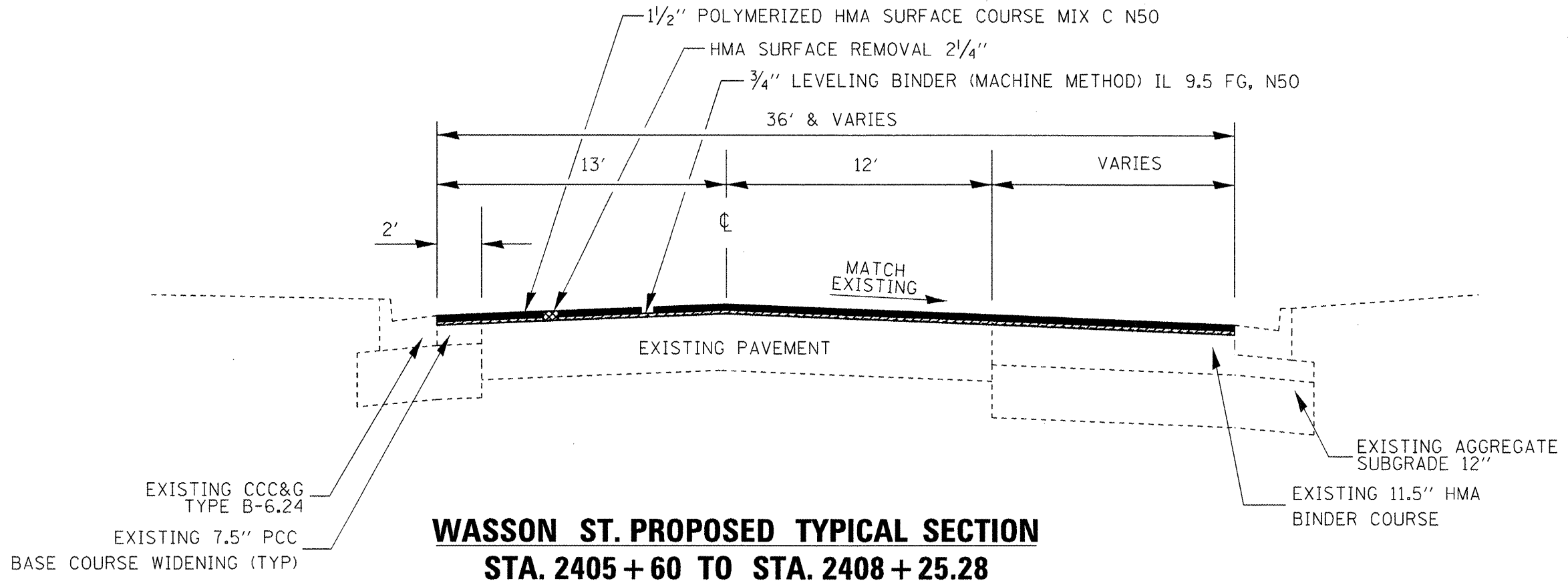
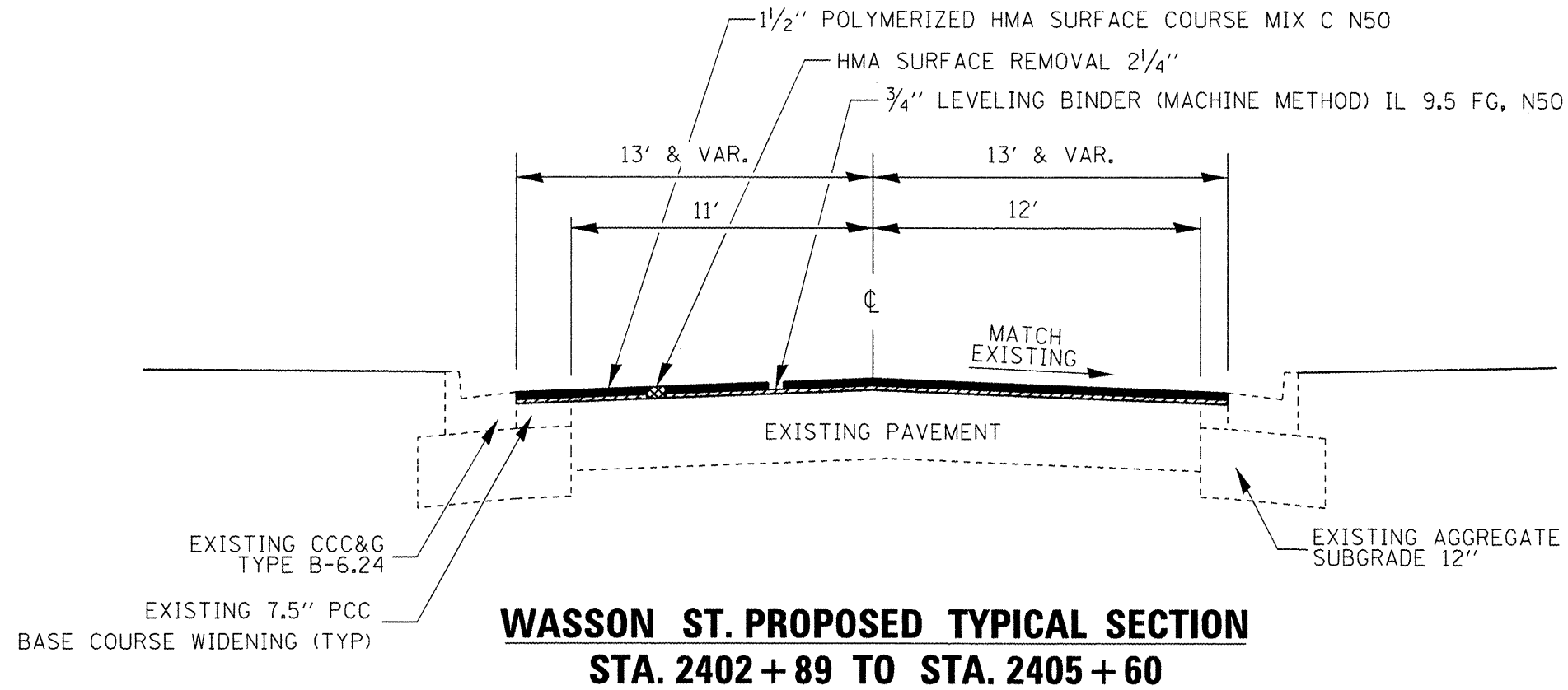

FILE NAME =	USER NAME = duncnbd	DESIGNED -	REVISED -
c:\pwwork\p1dot\duncnbd\0205100\0366882-shs-typical.dgn		DRAWN -	REVISED -
PLOT SCALE = 100.0000' / in.		CHECKED -	REVISED -
PLOT DATE = 3/23/2012		DATE -	REVISED -

STATE OF ILLINOIS  
 DEPARTMENT OF TRANSPORTATION

TYPICAL SECTIONS	
SCALE:	SHEET 4 OF 4 SHEETS STA. TO STA.

F.A.P. RTE.	SECTION	COUNTY	TOTAL SHEETS	SHEET NO.
653	7RS-3 & 8RS-4	LASALLE	23	10
CONTRACT NO. 66B82				
ILLINOIS FED. AID PROJECT				

MAINLINE PAVING SCHEDULE												
STA. TO STA.	AREA	HMA SURF REM 2 1/4"	HMA SURF REM 3 3/4"	POLY HMA SURF CSE MIX C N50	LEVEL BINDER (MM) N50	HMA BINDER CSE N50	BIT MATL PRIME COAT	AGG PRIME COAT	MIX FOR CRACKS JTS & FLGWYS	LEVEL BINDER (HM) N50	TEMP RAMP	
	SQ YD	SQ YD	SQ YD	TON	TONS	TONS	GAL	TON	TON	TON	SQ YD	
13+18 TO 20+20	1872		1872	158		236	243	7	1	1	75	
20+20 TO 22+55												
22+55 TO 29+34	1962		1962	165		247	255	8	1	1	73	
29+34 TO 29+79												
29+79 TO 33+10	1618		1618	136		204	210	6	1	1	123	
33+10 TO 33+53												
33+53 TO 44+70	5709	5709		480	240		742	23	2	3	39	
44+70 TO 47+04	832	832		70	35		108	3	1	1		
47+04 TO 48+69												
2402+90 TO 2404+05	944	944		80	40		123	4	1	1	27	
2404+05 TO 2405+60	448	448		38	19		58	2	1	1		
2405+60 TO 2408+25.28	1185	1185		100	50		154	5	1	1	115	
<b>TOTALS</b>	<b>14569</b>	<b>9118</b>	<b>5452</b>	<b>1227</b>	<b>384</b>	<b>687</b>	<b>1894</b>	<b>58</b>	<b>9</b>	<b>9</b>	<b>452</b>	

ADJUSTMENT SCHEDULE		
LOCATION	MANHOLE ADJUSTMENT	WATER VALVE ADJUSTMENT
	EACH	EACH
STA. 14+78 30' LT	1	
STA. 15+96 10' RT		1
STA. 19+51 3' LT	1	
STA. 27+11 18' RT	1	
STA. 27+17 36' RT	1	
STA. 26+98 37' LT	1	
STA. 28+12 4' LT	1	
STA. 29+28 10' RT		1
STA. 29+31 21' RT	1	
STA. 29+81 21' RT	1	
STA. 31+56 33' LT	1	
STA. 37+00 3' RT	1	
STA. 42+51 24' LT	1	
STA. 44+37 3' RT	1	
<b>WASSON ST</b>		
STA. 2406+57 2' RT	1	
<b>TOTAL</b>	<b>13</b>	<b>2</b>

SIDEROAD SCHEDULE											
STATION	SIDE	DESCRIPTION	EXISTING MATERIAL	WIDTH	AREA	HMA SURFACE REM 1 1/2"	INC. HMA SURFACE	BIT MAT'L (PR CT)	AGG (PR CT)	TEMP RAMP	
				FOOT	SQ YD	SQ YD	TON	GAL	TON	SQ YD	
14+78	LT	Armory St.	HMA	26	81.1	81.1	6.8	6.5	0.2	14.4	
24+42	RT	Pleasant St.	HMA	18.5	145.4	145.4	12.2	11.6	0.3	10.3	
27+02	LT	Oak St.	HMA	28.4	152.9	152.9	12.8	12.2	0.3	15.8	
27+16	RT	City Hall Alley	HMA	19	74.4	74.4	6.2	6.0	0.1	10.6	
28+19	LT	Alley	HMA	33.7	65.8	65.8	5.5	5.3	0.1	18.7	
31+49	LT	Alley	HMA	14	24.9	24.9	2.1	2.0	0.1	7.8	
35+16	LT	Alley	HMA	21	29.6	29.6	2.5	2.4	0.1	11.7	
36+98	RT	Monroe St.	HMA	30.5	116.9	116.9	9.8	9.4	0.2	16.9	
36+98	LT	Monroe St.	HMA	38.5	143.1	143.1	12.0	11.4	0.3	21.4	
38+82	LT	Alley	HMA	15	21.5	21.5	1.8	1.7	0.1	8.3	
40+68	RT	Vermillion St.	HMA	30	140.6	140.6	11.8	11.2	0.3	16.7	
40+68	LT	Vermillion St.	HMA	41	146.1	146.1	12.3	11.7	0.3	22.8	
42+51	LT	Alley	HMA	20	26.7	26.7	2.2	2.1	0.1	11.1	
44+70	RT	Sterling St.	HMA	30.5	112.2	112.2	9.4	9.0	0.2	16.9	
44+70	LT	Sterling St.	HMA	42	152.8	152.8	12.8	12.2	0.3	23.3	
48+09	RT	Wasson St.	HMA	20.5	145.6	145.6	12.2	11.6	0.3	11.4	
2406+49.62	RT	Half St.	HMA	17.5	113.4	113.4	9.5	9.1	0.2	9.7	
<b>TOTAL</b>					<b>1693</b>	<b>1693</b>	<b>143</b>	<b>136</b>	<b>4.0</b>	<b>248</b>	

**MEDIAN, CURB, & SIDEWALK SCHEDULE**

DESCRIPTION	SUGGESTED STANDARD #	COMB CURB & GUTTER REM	CC&G TYPE B-6.12	CC&G TYPE B-6.24	CONC CURB TY B	SIDEWALK REM	PCC SIDEWALK 4"	DETECTABLE WARNING	INLET ADJUSTMENT	SEEDING	NIT FERT NUT	POT FERT NUT	PHOS FERT NUT	EROSION CONTROL BLANKET
		FOOT	FOOT	FOOT	FOOT	SQ FT	SQ FT	SQ FT	EACH	ACRE	LB	LB	LB	SQ YD
<b>Vermillion Bridge Levy</b>														
Northside	424006	10	-	-	10	91	91	8	-	0.0035	0.32	0.32	0.32	17
Southside	424006	10	-	-	10	174	191	8	-	0.0045	0.41	0.41	0.41	22
<b>Pleasant Street</b>														
Westside	424011	20	20	-	-	68.5	83	8	-	0.0017	0.15	0.15	0.15	8
Eastside	424011	20	20	-	-	78.5	95	8	-	0.0019	0.17	0.17	0.17	9
<b>Oak Street</b>														
SW Quad	424001-06	13	13	-	-	63	76	8	-	0.0014	0.13	0.13	0.13	7
SE Quad	424001-06	15	15	-	-	36	42	8	-	0.0008	0.07	0.07	0.07	4
NW Quad (N OF ALLEY)	N/A	10	13	-	-	-	-	-	-	0.0000	0.00	0.00	0.00	-
NW Quad (S OF ALLEY)	N/A	7	20	-	-	22	26	-	-	-	-	-	-	-
NE Quad	N/A	15	15	-	-	-	-	-	-	0.0000	0.00	0.00	0.00	-
<b>Alley between Bloomington Street and Park Street</b>														
Westside	424026	12	12	-	-	94	94	8	-	-	-	-	-	-
Eastside	424026	12	12	-	-	136	136	8	-	-	-	-	-	-
<b>Alley at Streator Home Building and Loan</b>														
Westside	424026	8	8	-	-	27	33	8	-	0.0006	0.06	0.06	0.06	3
Eastside	424026	8	8	-	-	27	33	8	-	0.0006	0.06	0.06	0.06	3
<b>Monroe Street</b>														
NW Quad	424021	18	18	-	-	173	173	32	1	0.0012	0.11	0.11	0.11	6
NE Quad	424001-06	28	28	-	-	198	198	16	1	-	-	-	-	-
SW Quad	424021	22	22	-	-	110	110	32	1	0.0023	0.20	0.20	0.20	11
SE Quad	424001-06	28	28	-	-	128	128	16	1	0.0017	0.15	0.15	0.15	8
<b>Alley between Monroe Street and Vermillion Street</b>														
Westside	424026	15	15	-	-	68	71	8	-	0.0014	0.13	0.13	0.13	7
Eastside	424026	15	15	-	-	70	75	8	-	0.0014	0.13	0.13	0.13	7
<b>Vermillion Street</b>														
NW Quad	424001-06	23	23	-	-	161	161	16	1	0.0010	0.09	0.09	0.09	5
NE Quad	424001-06	23	23	-	-	163	163	16	1	-	-	-	-	-
SW Quad	424001-06	28	28	-	-	163	163	16	1	-	-	-	-	-
SE Quad	424001-06	15	15	-	-	170	170	16	-	0.0006	0.06	0.06	0.06	3
<b>Alley between Vermillion Street and Sterling Street</b>														
Westside	424026	8	8	-	-	33	39	8	-	0.0010	0.09	0.09	0.09	5
Eastside	424026	13	13	-	-	47	53	8	-	-	-	-	-	-
<b>Sterling Street</b>														
NW Quad	424021	15	15	-	-	202	202	32	1	0.0008	0.07	0.07	0.07	4
NE Quad	424021	26	26	-	-	222	232	32	1	0.0008	0.07	0.07	0.07	4
SW Quad	424021	18	18	-	-	169	178	32	-	0.0014	0.13	0.13	0.13	7
SE Quad	424001-06	29	29	-	-	272	272	16	1	0.0021	0.19	0.19	0.19	10
<b>Wasson Street</b>														
SW Quad	424001-06	16	-	16	-	153	183	16	-	0.0008	0.07	0.07	0.07	4
SE Quad	424001-06	16	-	16	-	145	165	16	-	0.0008	0.07	0.07	0.07	4
<b>Main St.</b>														
Median Island	424031	-	-	-	-	10	10	16	-	-	-	-	-	-
<b>TOTAL</b>		516	480	32	20	3474	3646	432	10	0.03	2.94	2.94	2.94	158

FILE NAME =	USER NAME = duncenbd	DESIGNED -	REVISED -
c:\pwwork\pwwork\duncenbd\0285100\0366882-sht-schedule.dgn		DRAWN -	REVISED -
		CHECKED -	REVISED -
		DATE -	REVISED -

**STATE OF ILLINOIS  
DEPARTMENT OF TRANSPORTATION**

**SCHEDULES**

SCALE: SHEET NO. 2 OF 3 SHEETS STA. TO STA.

F.A.P. RTE.	SECTION	COUNTY	TOTAL SHEETS	SHEET NO.
653	TR5-3 & 8R5-4	LASALLE	23	12
ILLINOIS FED. AID PROJECT			CONTRACT NO. 66B82	

PAVEMENT MARKING SCHEDULE											
STA. TO STA.	DESCRIPTION	THERMOPLASTIC PAVEMENT MARKING						LTR & SYM SQ FT	PREFORMED PLASTIC PAVEMENT MARKINGS - TYPE B INLAID	RAISED REFLECTIVE PAVEMENT MARKERS EACH	PRISMATIC CURB REFLECTORS EACH
		4"	6"	8"	12"	24"	6"				
		WHITE FOOT	WHITE FOOT	WHITE FOOT	WHITE FOOT	WHITE FOOT	WHITE FOOT				
13+18 - 20+20	Project Begin to SN 050-8000	1404	80.4	-	-	-	-	176	9	-	
20+20 - 22+55	SN 050-8000	-	-	-	-	-	-	60	-	-	
22+55 - 24+42	SN 050-8000 to Pleasant St.	-	-	-	-	-	-	47	3	-	
24+42 - 26+98	Pleasant St. to Oak St.	-	-	-	-	-	-	64	4	-	
26+98 - 29+34	Oak St. to Bloomington St.	-	81.1	-	136.1	28.5	75	59	3	-	
29+79 - 33+10	Bloomington St. to Park St.	18	215.4	154	301.7	44.1	106.2	103	10	-	
33+53 - 36+98	Park St. to Monroe St.	48	100.5	-	145.8	-	-	87	5	-	
36+98 - 40+68	Monroe St. to Vermillion St. (including all Vermillion St. Pvt. Mrk.)	51	269.2	-	360	59.6	84.2	93	5	-	
40+68 - 44+37	Vermillion St. to Sterling St.	42	70	-	132	-	-	93	5	-	
44+37 - 48+09	Sterling St. to Wasson St. (including all Wasson St. Pvt. Mrk.)	450.7	356.2	305	31.5	27	98.8	93	9	8	
2402+89.61 - 2406+49.61	Wasson St. to Half St.	-	49	-	-	9.3	-	90	5	-	
2406+49.61 - 2408+23.61	Half St. to Main St.	-	178.7	288	21.9	48	62.4	44	11	8	
TOTAL		2014	1401	747	1129	217	426.6	1009	69	16	

TEMPORARY PAVEMENT MARKING SCHEDULE											
STA. TO STA.	DESCRIPTION	TEMPORARY PAINT PAVEMENT MARKING (2 APPLICATIONS)						LETTER AND SYMBOLS SQ FT	SHORT TERM PAVEMENT MARKING (3 APPLICATIONS) FOOT	WORK ZONE PAVT MARK REM SQ FT	
		4"	6"	8"	12"	24"					
		WHITE FOOT	WHITE FOOT	WHITE FOOT	WHITE FOOT	WHITE FOOT					
13+18	20+20	Project Begin to SN 050-8000						2808	160.8	192	42
20+20	22+55	SN 050-8000						-	-	-	-
22+55	24+42	SN 050-8000 to Pleasant St.						-	-	51	11
24+42	26+98	Pleasant St. to Oak St.						-	-	70	15
26+98	29+43	Oak St. to Bloomington St.						-	162.2	1390	307
29+79	33+10	Bloomington St. to Park St.						36	430.8	1786	395
33+53	36+98	Park St. to Monroe St.						96	201	95	21
36+98	40+68	Monroe St. to Vermillion St. (including all Vermillion St. Pvt. Mrk.)						102	538.4	1984	439
40+68	44+37	Vermillion St. to Sterling St.						84	140	101	22
44+37	48+09	Sterling St. to Wasson St. (including all Wasson St. Pvt. Mrk.)						901.4	712.4	1542	341
2402+90	2406+50	Wasson St. to Half St.						-	98	99	22
2406+50	2408+24	Half St. to Main St.						-	357.4	1488	329
TOTAL		4028	2801	1494	2258	433	854	8798	1946		

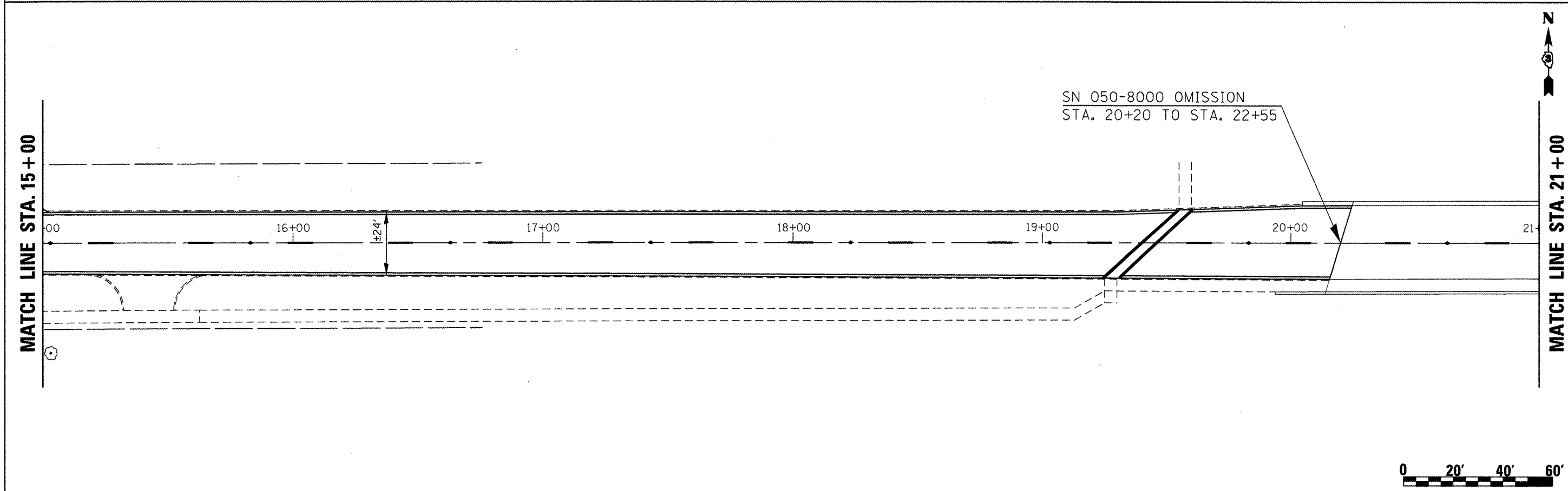
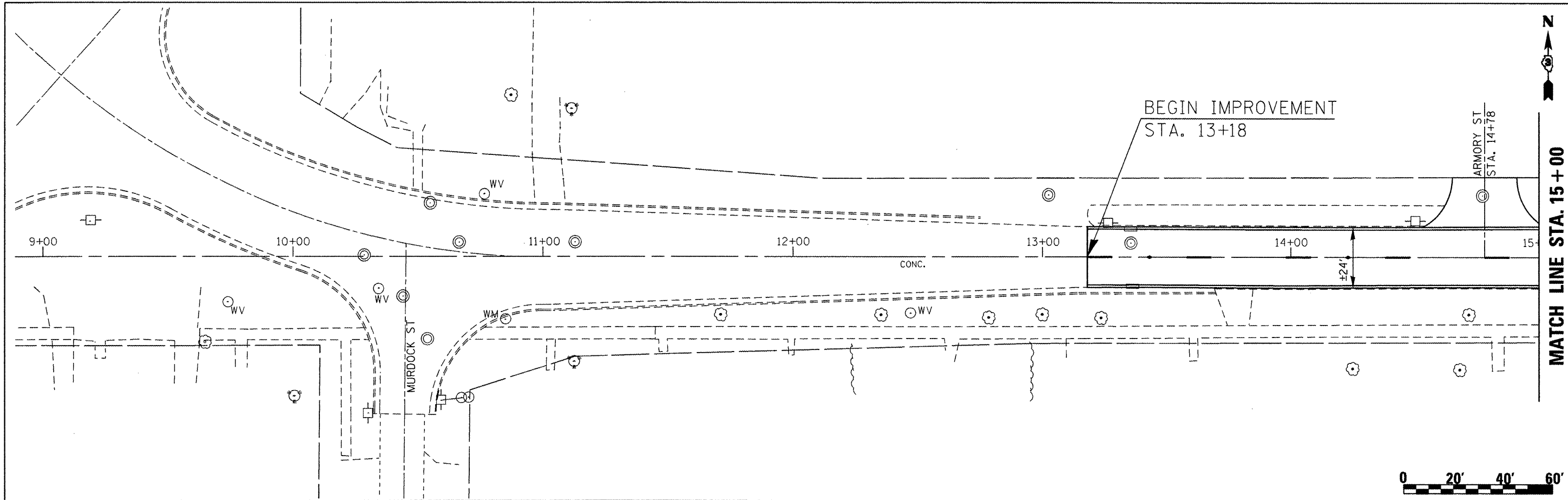

FILE NAME =	USER NAME = duncanbd	DESIGNED -	REVISED -
ct:\work\pilot\duncanbd\0285100\036882-shr-plan.dgn		DRAWN -	REVISED -
		CHECKED -	REVISED -
		DATE -	REVISED -

**STATE OF ILLINOIS**  
**DEPARTMENT OF TRANSPORTATION**

**PLAN VIEWS**

SCALE: 1" = 20' SHEET 1 OF 4 SHEETS STA. TO STA. 15+00

F.A.P. RTE.	SECTION	COUNTY	TOTAL SHEETS	SHEET NO.
653	7 RS-3 & 8 RS-4	LASALLE	23	14
CONTRACT NO. 66B82				
ILLINOIS FED. AID PROJECT				

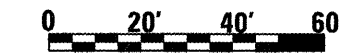
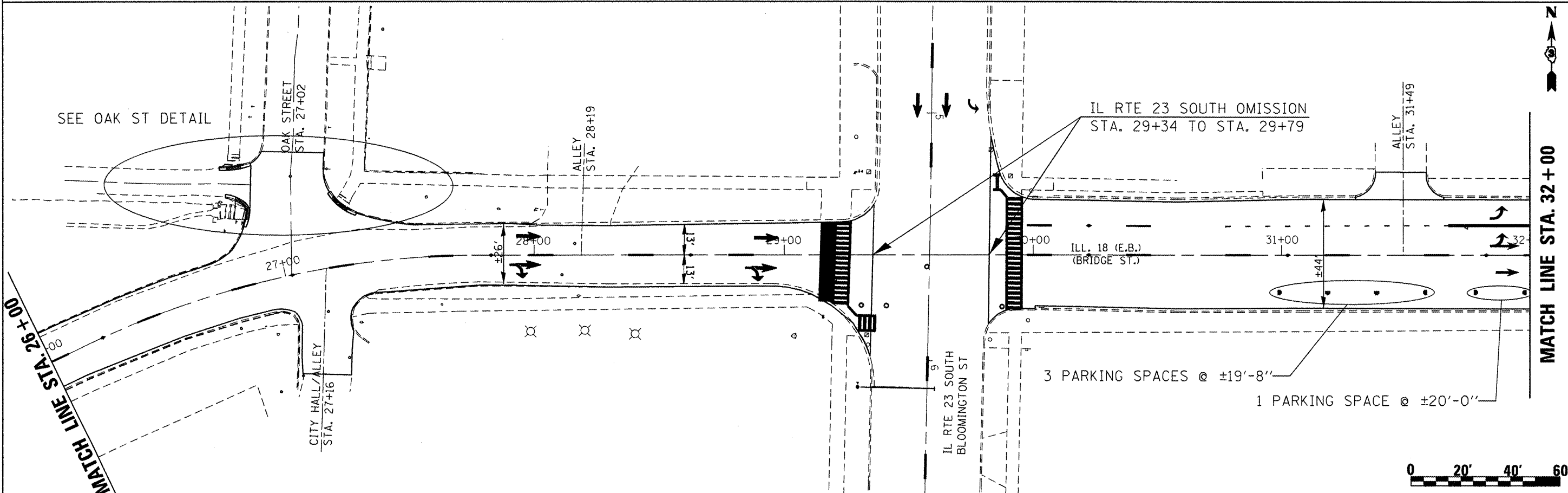
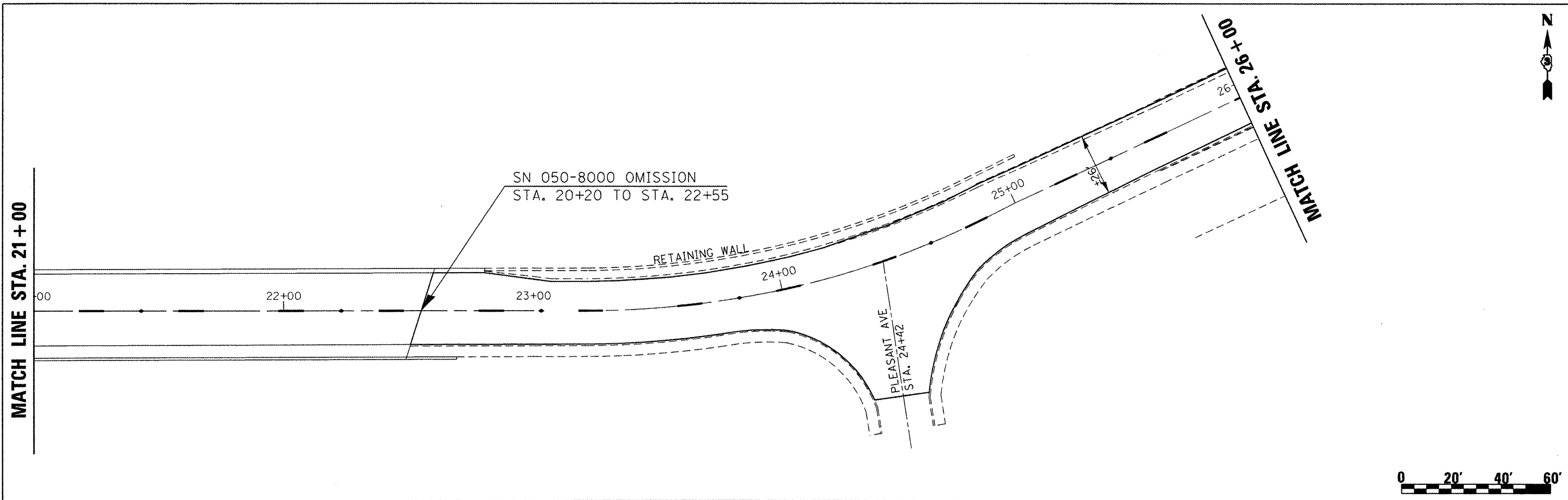

FILE NAME =	USER NAME = duncanbd	DESIGNED -	REVISED -
ca:\pwwork\pwwid\tduncanbd\0285180\036882\shh-plan.dgn		DRAWN -	REVISED -
PLOT SCALE = 40.0000' / in.		CHECKED -	REVISED -
PLOT DATE = 3/23/2012		DATE -	REVISED -

**STATE OF ILLINOIS  
DEPARTMENT OF TRANSPORTATION**

**PLAN VIEWS**

SCALE: 1" = 20' SHEET 2 OF 4 SHEETS STA. 15+00 TO STA. 32+00

F.A.P. RTE.	SECTION	COUNTY	TOTAL SHEETS	SHEET NO.
653	7 RS-3 & 8 RS-4	LASALLE	23	15
CONTRACT NO. 66882				
ILLINOIS FED. AID PROJECT				

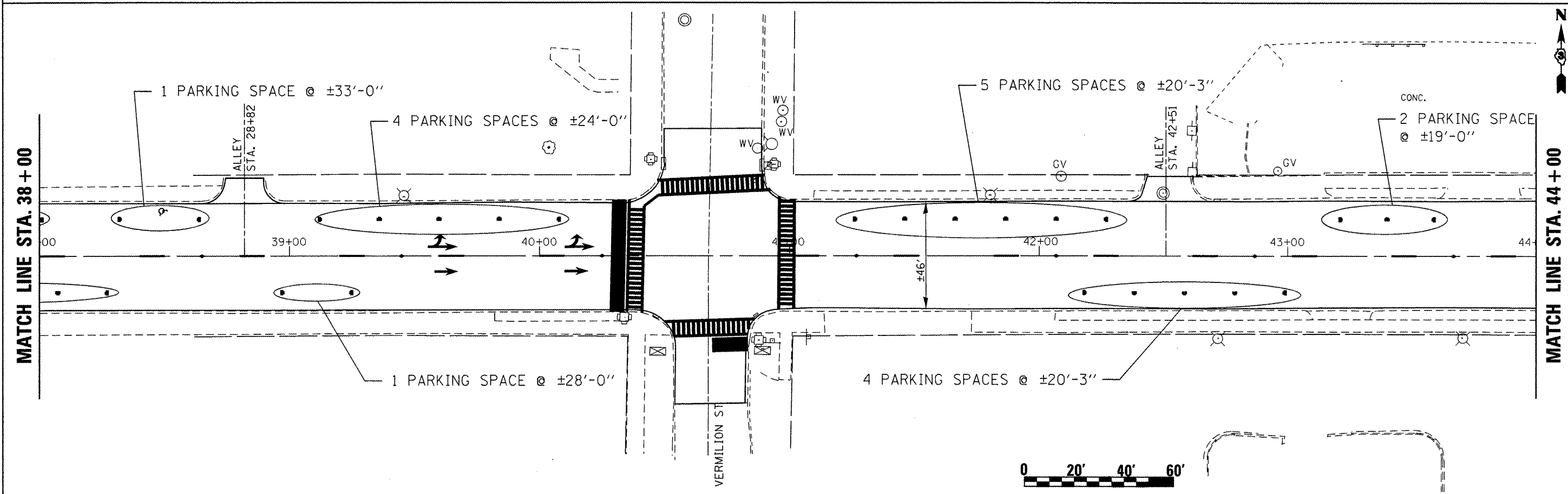
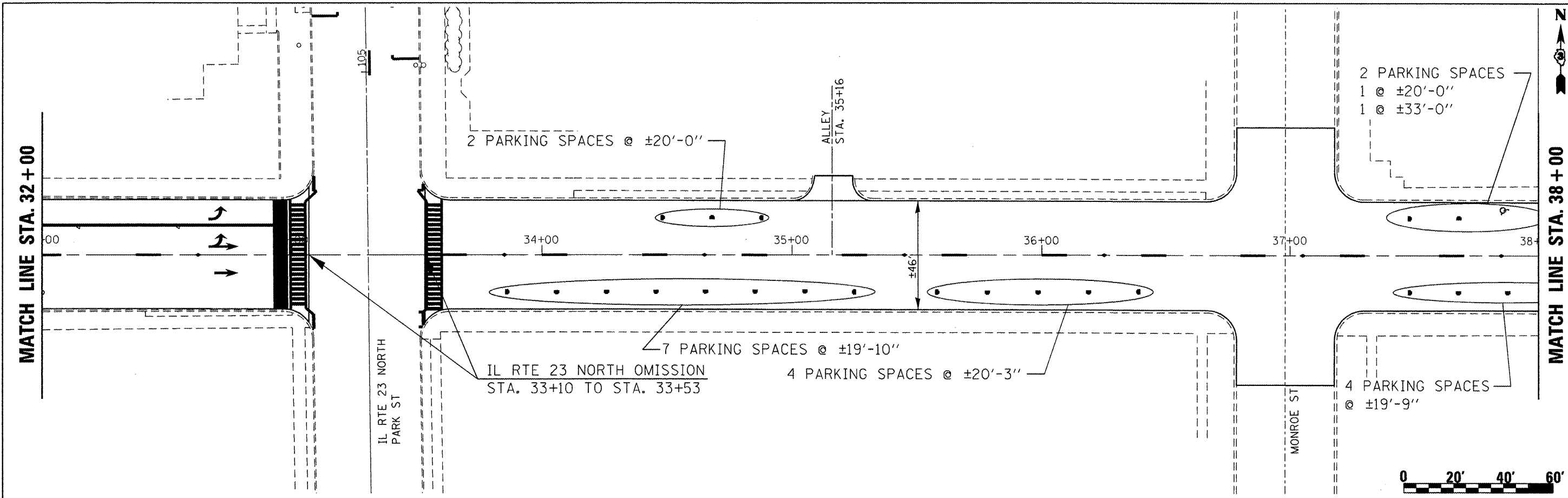

FILE NAME =	USER NAME = duncenbd	DESIGNED -	REVISED -	<b>STATE OF ILLINOIS DEPARTMENT OF TRANSPORTATION</b>	<b>PLAN VIEWS</b>		F.A.P. RTE.	SECTION	COUNTY	TOTAL SHEETS	SHEET NO.
ca:\pw\work\p\idot\duncenbd\0285100\0366882-sht-plan.dgn		DRAWN -	REVISED -		SCALE: 1" = 20'	SHEET 3 OF 4 SHEETS	653	7 RS-3 & 8 RS-4	LASALLE	23	16
PLOT SCALE = 40.0000' / 1"		CHECKED -	REVISED -		STA. 32+00	TO STA. 44+00	CONTRACT NO. 66B82				
PLOT DATE = 3/23/2012		DATE -	REVISED -		ILLINOIS FED. AID PROJECT						



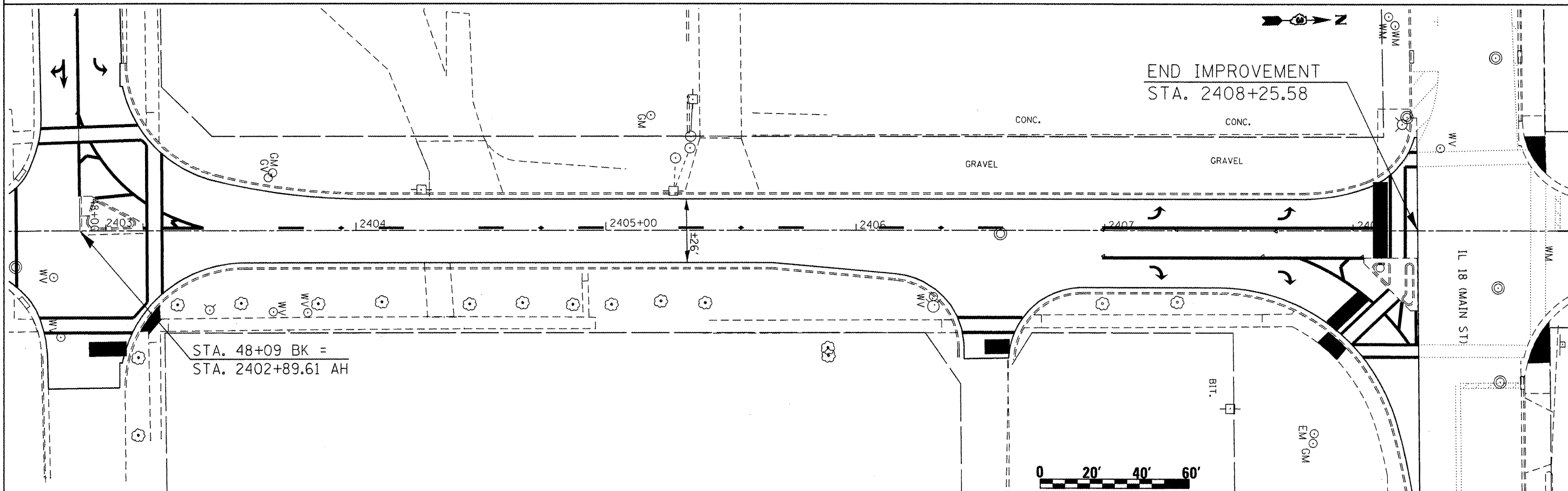
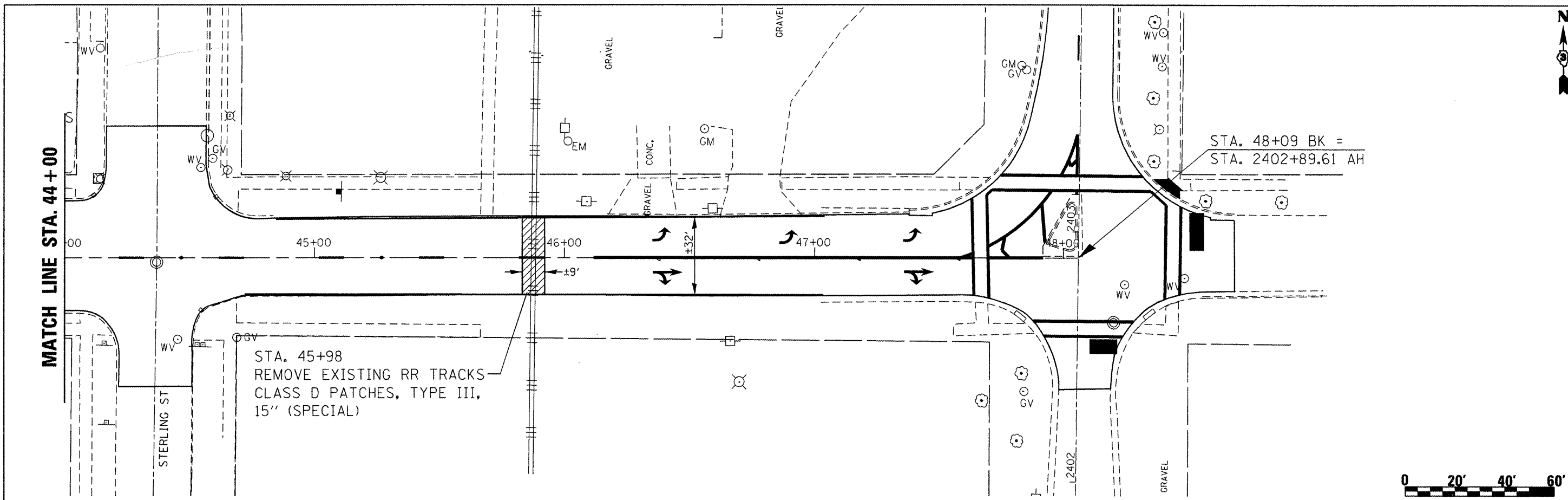

FILE NAME =	USER NAME = dunoanbd	DESIGNED -	REVISED -	<b>STATE OF ILLINOIS DEPARTMENT OF TRANSPORTATION</b>	<b>PLAN VIEWS</b>		F.A.P. RTE.	SECTION	COUNTY	TOTAL SHEETS	SHEET NO.	
es:\p\work\p\ridot\dunoanbd\0366882-sht-plan.dgn		DRAWN -	REVISED -		SCALE: 1" = 20'	SHEET 4 OF 4 SHEETS	STA. 44+00 TO STA.	653	7 RS-3 & 8 RS-4	LASALLE	23	17
PLOT SCALE = 48.0000' / in.		CHECKED -	REVISED -									
PLOT DATE = 3/23/2012		DATE -	REVISED -									
							CONTRACT NO. 66882					
							ILLINOIS FED. AID PROJECT					

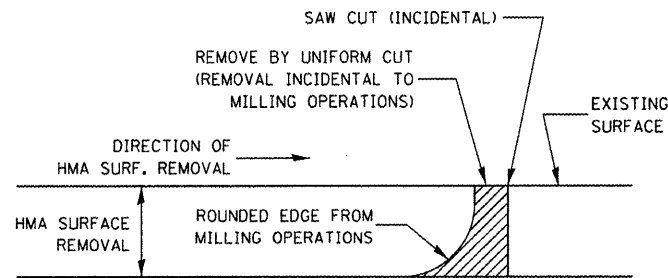

NOTE:  
 WHEN MILLING OPERATIONS PRODUCE A ROUNDED EDGE,  
 THEN A SAW CUT SHALL BE USED TO MANUFACTURE  
 A PERPENDICULAR EDGE AS SHOWN IN THE DETAIL.  
 THE ENGINEER SHALL BE THE SOLE JUDGE  
 CONCERNING THE USE OF THIS DETAIL

**HMA DETAIL AT BUTT JOINTS**

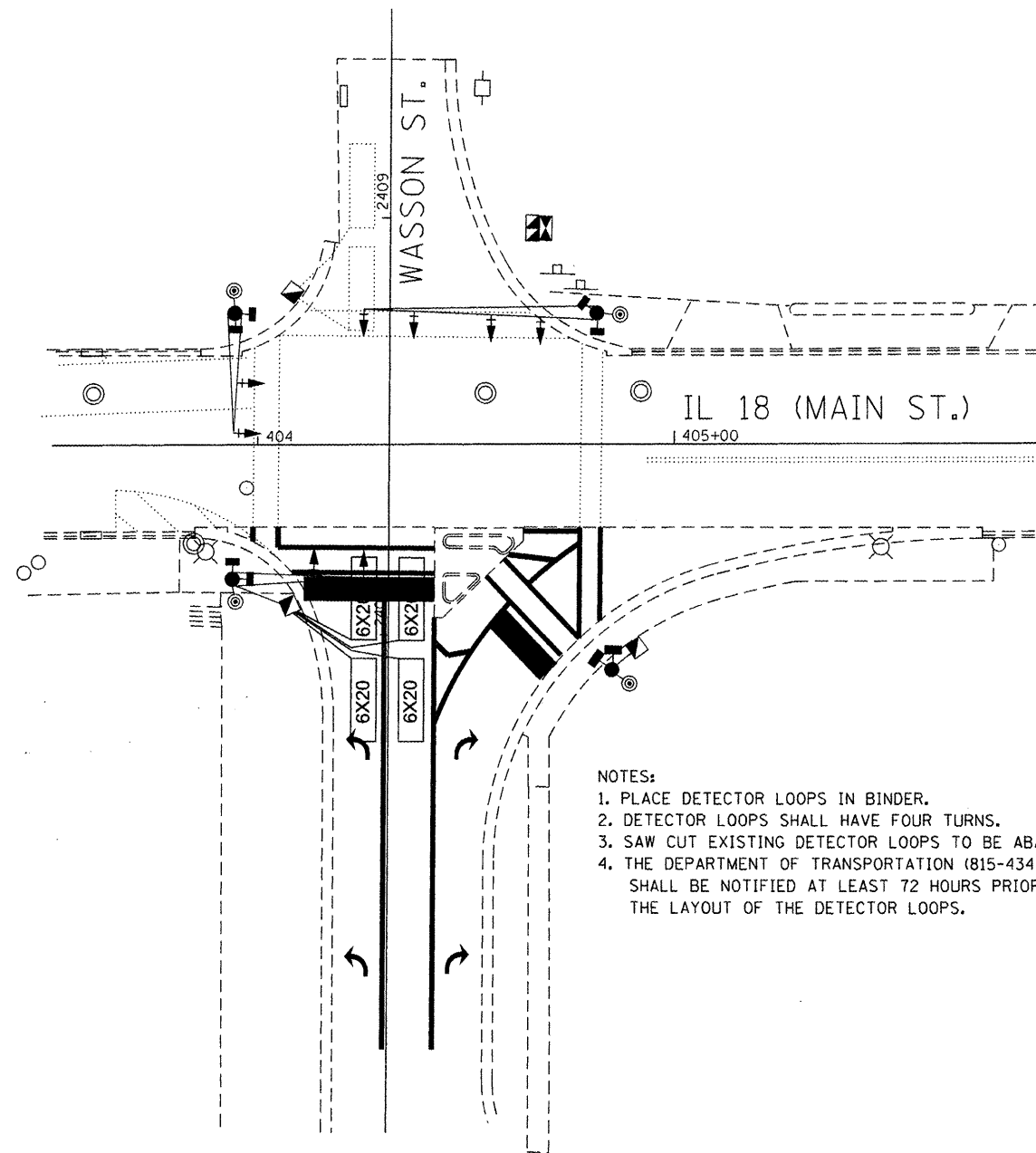

NOTES:  
 1. PLACE DETECTOR LOOPS IN BINDER.  
 2. DETECTOR LOOPS SHALL HAVE FOUR TURNS.  
 3. SAW CUT EXISTING DETECTOR LOOPS TO BE ABANDONED.  
 4. THE DEPARTMENT OF TRANSPORTATION (815-434-8506)  
 SHALL BE NOTIFIED AT LEAST 72 HOURS PRIOR TO  
 THE LAYOUT OF THE DETECTOR LOOPS.

**DETECTOR LOOP LAYOUT AT  
 WASSON & MAIN**

FILE NAME =	USER NAME = duncenbd	DESIGNED -	REVISED -
c:\pwork\pwork\duncenbd\0285100\0366882-shr-DETAILS.dgn		DRAWN -	REVISED -
PLOT SCALE = 100.0000' / in.		CHECKED -	REVISED -
PLOT DATE = 3/23/2012		DATE -	REVISED -

STATE OF ILLINOIS  
 DEPARTMENT OF TRANSPORTATION

DETAILS

SCALE:	SHEET NO. 1 OF 6 SHEETS	STA.	TO STA.
--------	-------------------------	------	---------

F.A.P. RTE.	SECTION	COUNTY	TOTAL SHEETS	SHEET NO.
653	7RS-3 & BR5-4	LASALLE	23	18
CONTRACT NO. 66B82				
ILLINOIS FED. AID PROJECT				

**CONTROLLER SEQUENCE**

NAME OF INTERSECTION: ILL. RTE. 18/MAIN ST. AND WASSON ST.  
 CONTROLLER SPECIFIED: REFERRING TO STANDARD 857001.  
 THE VEHICULAR AND PEDESTRIAN PHASES USED ARE DESIGNATED BELOW.

**LEGEND**

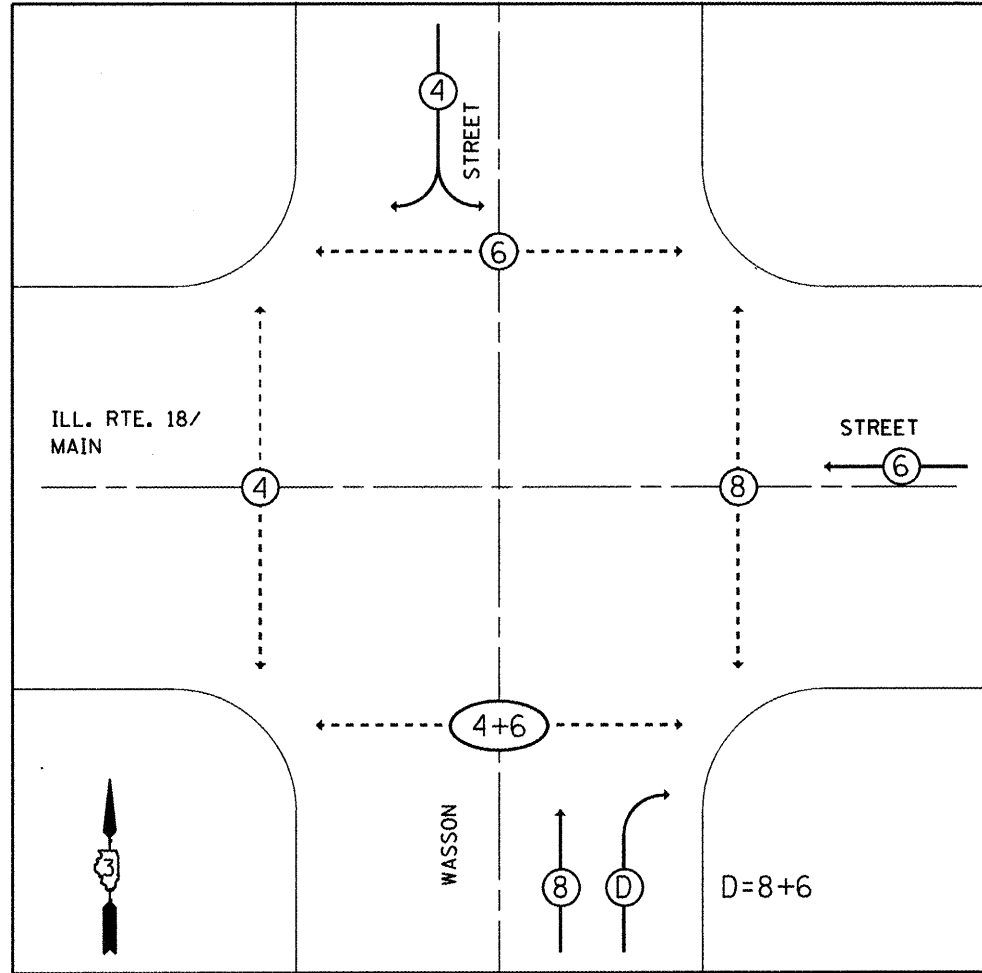
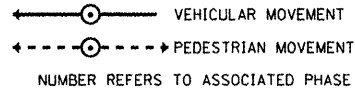

**PHASE DESIGNATION DIAGRAM**  
 NOT TO SCALE

**PROPOSED CABLE PLAN**

**WASSON ST. & ILL. RTE. 18/MAIN ST.**

NOT TO SCALE

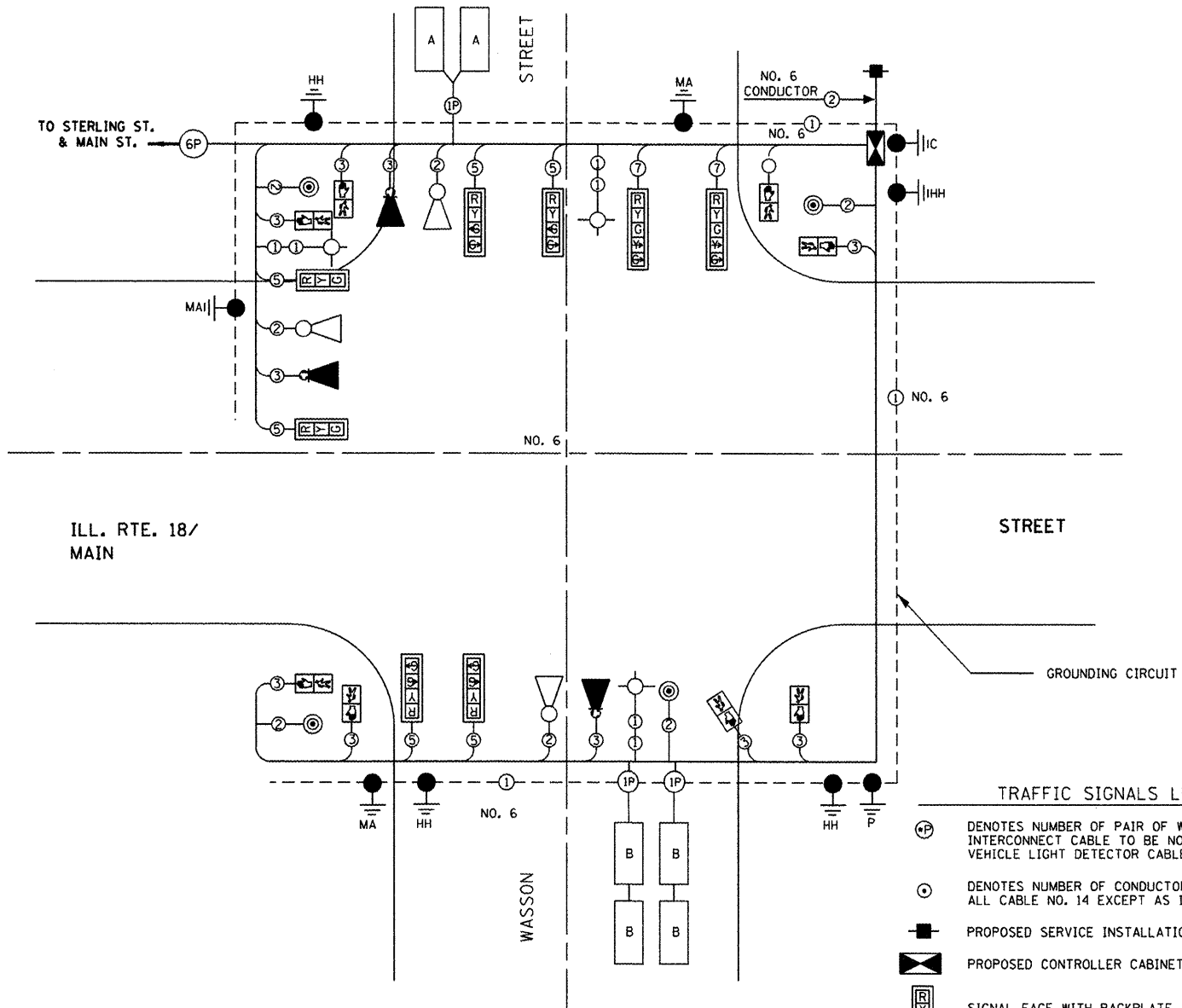

**TRAFFIC SIGNALS LEGEND**

- ⊕ DENOTES NUMBER OF PAIR OF WIRE (NEW) INTERCONNECT CABLE TO BE NO. 18. EMERGENCY VEHICLE LIGHT DETECTOR CABLE TO BE NO. 16.
- ⊙ DENOTES NUMBER OF CONDUCTORS (NEW) ALL CABLE NO. 14 EXCEPT AS INDICATED.
- PROPOSED SERVICE INSTALLATION
- ▣ PROPOSED CONTROLLER CABINET
- ▭ SIGNAL FACE WITH BACKPLATE
- ▭ 12" SIGNAL SECTION
- ▭ DON'T WALK WALK
- ▴ EMERGENCY VEHICLE LIGHT DETECTOR
- ◊ EMERGENCY VEHICLE CONFIRMATION BEACON
- ⊙ LUMINAIRE, SODIUM VAPOR, 250 WATT

**LOOP INDUCTANCE CHART**

DETECTOR LOOP SYSTEM	TURNS PER LOOP	INDUCTANCE (MICROHENRIES)	FREQUENCY (HERTZ)
A	4	535	26,387
B	4	551	26,001
C	4	551	26,001

CABLE PLAN

THIS SHEET FOR INFORMATION ONLY

FILE NAME =	USER NAME = duncanbd	DESIGNED -	REVISED -
c:\p\work\p\idot\duncanbd\0285100\036882-shr-DETAILS.dgn		DRAWN -	REVISED -
PLOT SCALE = 100.0000' / in.		CHECKED -	REVISED -
PLOT DATE = 3/23/2012		DATE -	REVISED -

**STATE OF ILLINOIS**  
**DEPARTMENT OF TRANSPORTATION**

**DETAILS**

SCALE: SHEET 2 OF 6 SHEETS STA. TO STA.

F.A.P. RTE.	SECTION	COUNTY	TOTAL SHEETS	SHEET NO.
653	7RS-3 & 8RS-4	LASALLE	23	19
CONTRACT NO. 66B82			ILLINOIS FED. AID PROJECT	

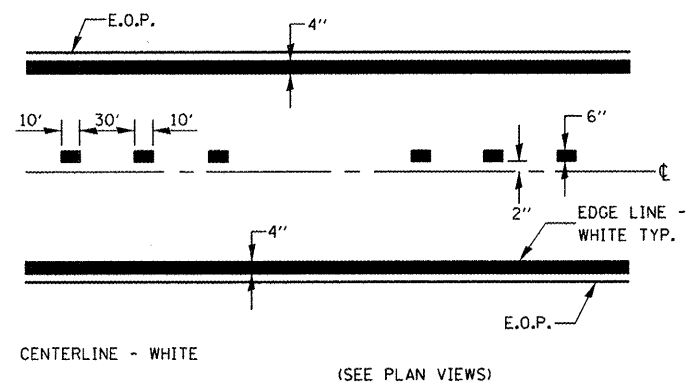

**PAVEMENT MARKING**

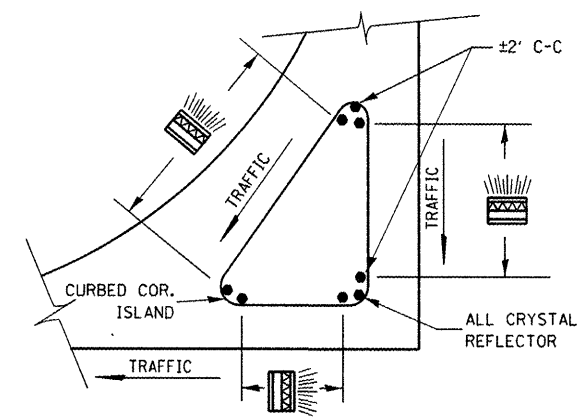

**PRISMATIC REFLECTORS**

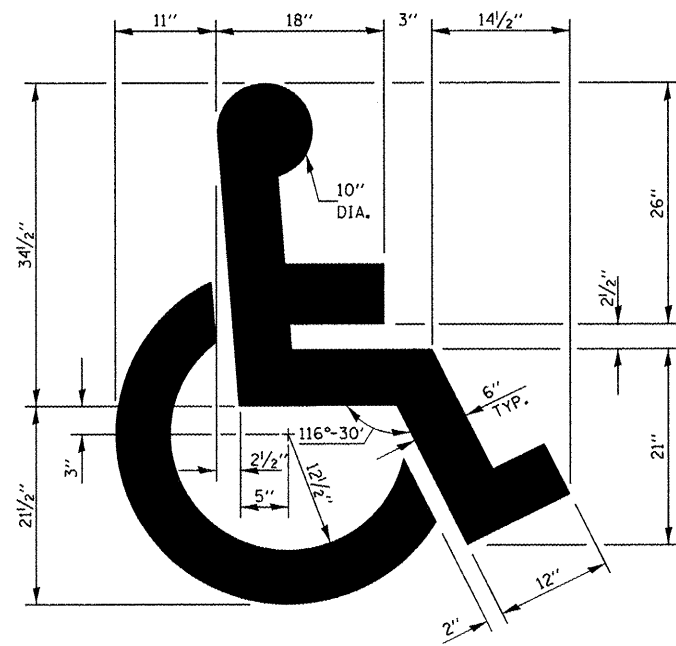

**TYPICAL DETAIL FOR PAINTING HANDICAP MARKINGS**

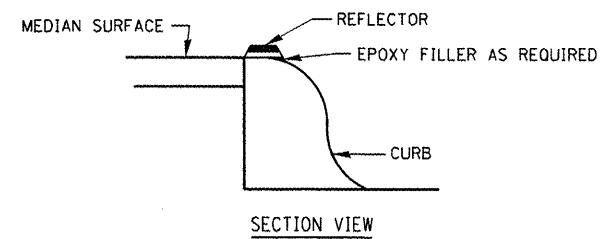

**NOTES**

1. PRISMATIC REFLECTORS SHALL BE MONO-DIRECTIONAL AND POSITIONED SO THAT THE REFLECTIVE FACE IS FACING THE APPROACHING TRAFFIC.
2. PRISMATIC REFLECTORS SHALL BE SECURED IN PLACE WITH AN EPOXY ADHESIVE.
3. PRISMATIC REFLECTORS SHALL BE EITHER AMBER OR CRYSTAL IN COLOR.

**OPTION 1**

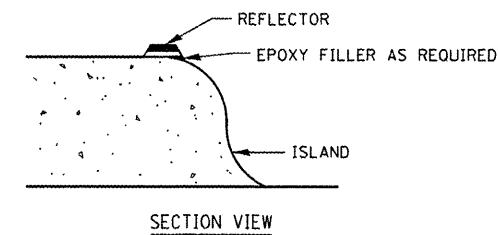

**NOTES**

1. PRISMATIC REFLECTORS SHALL BE MONO-DIRECTIONAL AND POSITIONED SO THAT THE REFLECTIVE FACE IS FACING THE APPROACHING TRAFFIC.
2. PRISMATIC REFLECTORS SHALL BE SECURED IN PLACE WITH AN EPOXY ADHESIVE.
3. PRISMATIC REFLECTORS SHALL BE EITHER AMBER OR CRYSTAL IN COLOR.

**OPTION 2**

FILE NAME =	USER NAME = duncanbd	DESIGNED -	REVISED -
c:\pwwork\p1sdat\duncanbd\0205100\036682-sh1-DETAILS.dgn		DRAWN -	REVISED -
		CHECKED -	REVISED -
		DATE -	REVISED -

**STATE OF ILLINOIS  
DEPARTMENT OF TRANSPORTATION**

**DETAILS**

SCALE: SHEET NO. 3 OF 6 SHEETS STA. TO STA.

F.A.P. RTE.	SECTION	COUNTY	TOTAL SHEETS	SHEET NO.
653	7RS-3 & BR5-4	LASALLE	23	20
CONTRACT NO. 66B82			ILLINOIS FED. AID PROJECT	

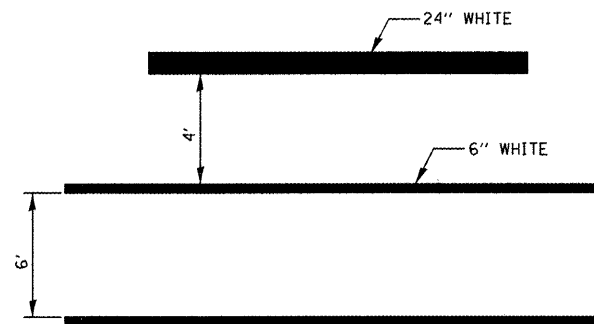

**TYPICAL SPACING DETAIL FOR  
CROSSWALKS AND STOP BARS**

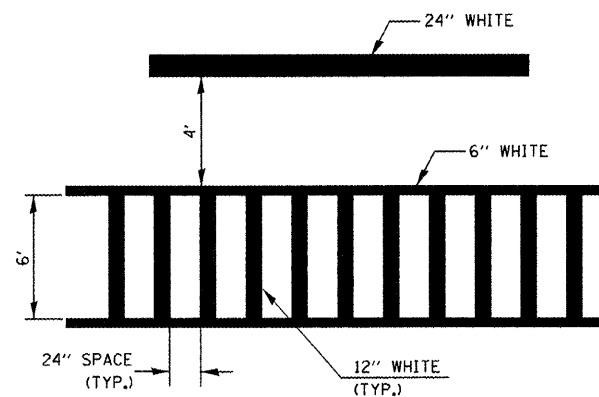

**TYPICAL SPACING DETAIL FOR  
CROSSWALKS AND STOP BARS**

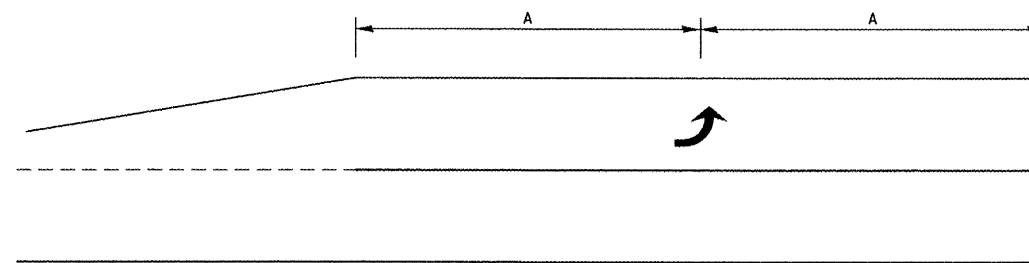

**99' AND UNDER**

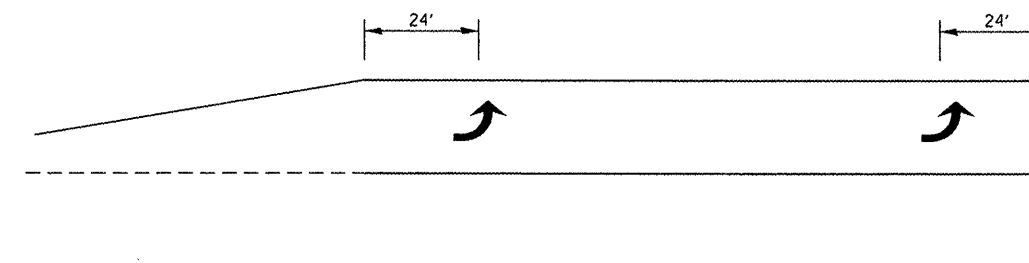

**100' TO 149'**

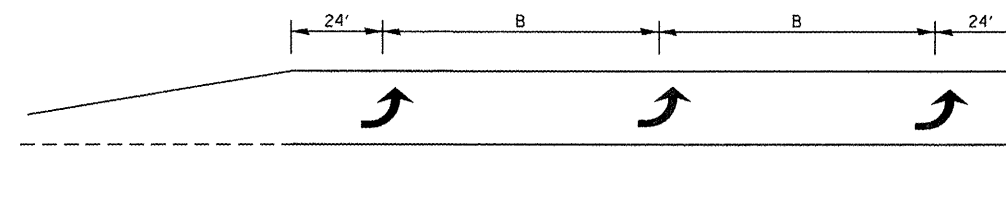

**150' AND LONGER**

**TYPICAL PLACEMENT OF ARROWS  
IN TURN LANES**

FILE NAME =	USER NAME = duncenbd	DESIGNED -	REVISED -
c:\pwwork\pwwork\duncenbd\0205100\0366882-shit-DETAILS.dgn		DRAWN -	REVISED -
	PLOT SCALE = 100.0000' / in.	CHECKED -	REVISED -
	PLOT DATE = 3/23/2012	DATE -	REVISED -

STATE OF ILLINOIS  
DEPARTMENT OF TRANSPORTATION

DETAILS

SCALE: SHEET NO. 4 OF 6 SHEETS STA. TO STA.

F.A.P. RTE.	SECTION	COUNTY	TOTAL SHEETS	SHEET NO.
653	7RS-3 & 8RS-4	LASALLE	23	21
CONTRACT NO. 66B82				
ILLINOIS FED. AID PROJECT				

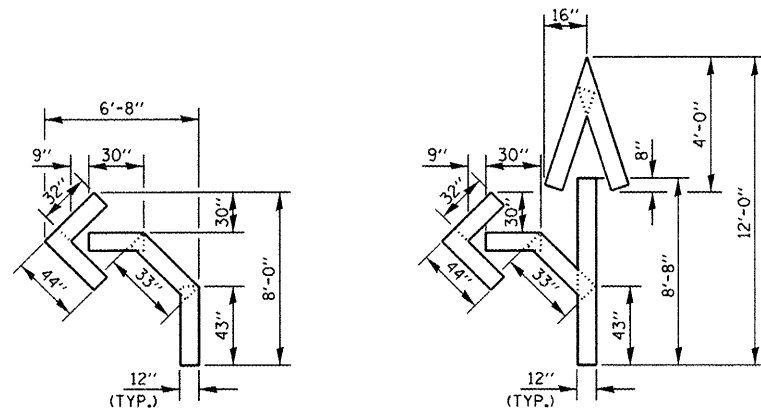

QUANTITY  
12" LINE = 16 LIN. FT.  
OR 4" LINE = 48 LIN. FT.

QUANTITY  
12" LINE = 29 LIN. FT.  
OR 4" LINE = 87 LIN. FT.

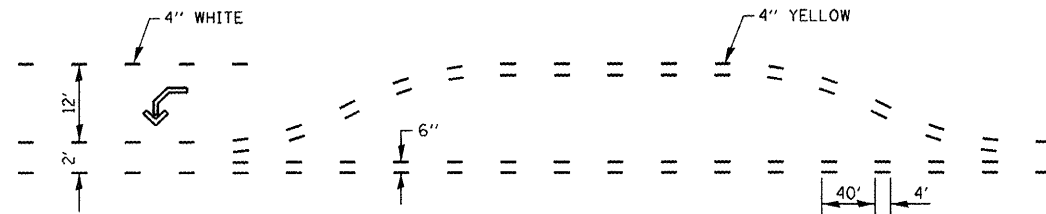

**SHORT-TERM PAVEMENT MARKING  
FOR MEDIANS AND ARROWS**

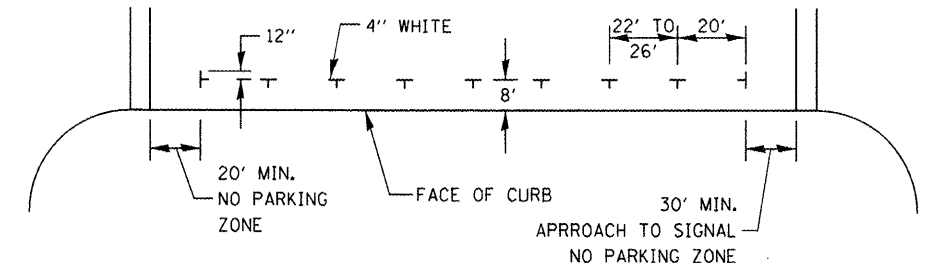

**PREFERRED METHOD**

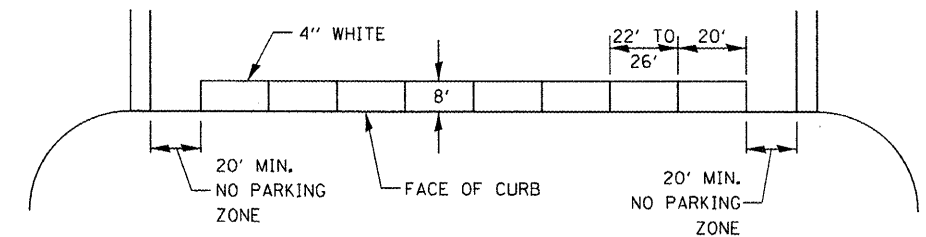

**OPTION 2**

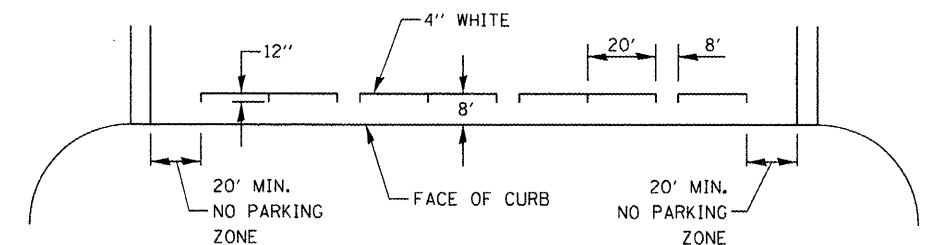

**OPTION 3**

**TYPICAL PARKING SPACING**

FILE NAME =	USER NAME = duncanbd	DESIGNED -	REVISED -	<b>STATE OF ILLINOIS DEPARTMENT OF TRANSPORTATION</b>	<b>DETAILS</b>		F.A.P. RTE. =	SECTION	COUNTY	TOTAL SHEETS	SHEET NO.	
ci:\pwork\pwidat\duncanbd\0285100\036	BB2-sh1-DETAILS.dgn	DRAWN -	REVISED -		SCALE:	SHEET NO. 5 OF 6 SHEETS	STA.	653	TRS-3 & BRS-4	LASALLE	23	22
	PLOT SCALE = 100.0000' / in.	CHECKED -	REVISED -				TO STA.					
	PLOT DATE = 3/23/2012	DATE -	REVISED -									
										<b>CONTRACT NO. 66B82</b>		
										<small>ILLINOIS FED. AID PROJECT</small>		



OAK STREET  
STA. 27+02

NOTE:  
THE CITY OF STREATOR PLANS TO CONSTRUCT  
NEW SIDEWALK (ADA RAMPS) AT THIS LOCATION.  
PRIOR TO CONSTRUCTING CURB AND GUTTER  
THE CITY SHALL BE CONTACTED TO COORDINATE  
RAMP WORK.

DEPRESSED CURB FOR  
FUTURE SIDEWALK BY  
OTHERS. FINAL LOCATION  
TO BE DETERMINED BY  
THE ENGINEER.

CURB & GUTTER TY B-6.12 (TYP.)

REMOVE LOWER STEP TO  
PROVIDE LANDING AS  
DIRECTED BY THE ENGINEER.

27+00

FILE NAME =	USER NAME = duncanbd	DESIGNED -	REVISED -
ct:\pwork\p\dot\duncanbd\0285100\036882-shr-DETAILS.dgn		DRAWN -	REVISED -
PLOT SCALE = 1/8" = 1' in.		CHECKED -	REVISED -
PLOT DATE = 3/23/2012		DATE -	REVISED -

STATE OF ILLINOIS  
DEPARTMENT OF TRANSPORTATION

DETAILS  
OAK ST

SCALE: 1" = 5' SHEET 6 OF 6 SHEETS STA. TO STA.

F.A.P. RTE.	SECTION	COUNTY	TOTAL SHEETS	SHEET NO.
653	7RS-3 & 8RS-4	LASALLE	23	23
CONTRACT NO. 66B82			ILLINOIS FED. AID PROJECT	