

| F.A.I. RTE. | SECTION | COUNTY | TOTAL SHEETS | SHEET NO. |
|-------------|---------------------------|----------|--------------------|-----------|
| 57 | D3 INTERMITTENT RS 2012-2 | IROQUOIS | 5 | 1 |
| | | ILLINOIS | CONTRACT NO. 66C09 | |

- INDEX OF SHEETS**
- COVER SHEET & STANDARDS
 - GENERAL NOTES & SUMMARY OF QUANTITIES
 - TYPICAL SECTION
 - SCHEDULE OF QUANTITIES
 - DETAILS

LIST OF ILLINOIS DOT HIGHWAY STANDARDS

- | | |
|-----------|---|
| 000001-06 | STANDARD SYMBOLS, ABBREVIATIONS AND PATTERNS |
| 701400-05 | APPROACH TO LANE CLOSURE, FREEWAY/EXPRESSWAY |
| 701401-06 | LANE CLOSURE, FREEWAY/EXPRESSWAY |
| 701411-08 | LANE CLOSURE, MULTILANE, AT ENTRANCE OR EXIT RAMP FOR SPEEDS **e** 45 MPH |
| 701901-02 | TRAFFIC CONTROL DEVICES |
| 780001-03 | TYPICAL PAVEMENT MARKINGS |
| 781001-03 | TYPICAL APPLICATIONS RAISED REFLECTIVE PAVEMENT MARKERS |

STATE OF ILLINOIS
DEPARTMENT OF TRANSPORTATION
DIVISION OF HIGHWAYS
PROPOSED
HIGHWAY PLANS

FAI ROUTE 57 (I-57)
SECTION D3 INTERMITTENT RS 2012-2
PROJECT: IM-TOLL-057-6(192)287
TYPE of IMPROVEMENT INTERMITTENT RESURF
IROQUOIS COUNTY

C-93-100-12



FUNCTIONAL CLASSIFICATION-INTERSTATE

2011 ADT = 18,200
P.V. = 67.0% S.U. = 4.6% M.U. = 28.4%

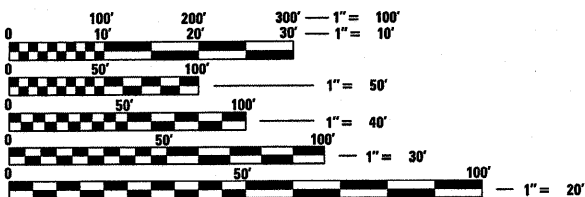

FULL SIZE PLANS HAVE BEEN PREPARED USING STANDARD ENGINEERING SCALES. REDUCED SIZED PLANS WILL NOT CONFORM TO STANDARD SCALES. IN MAKING MEASUREMENTS ON REDUCED PLANS, THE ABOVE SCALES MAY BE USED.

J.U.L.I.E.
JOINT UTILITY LOCATION INFORMATION FOR EXCAVATION
1-800-892-0123
OR 811

PROJECT ENGINEER: JOE KANNEL, P.E.
UNIT CHIEF: PAT BRABOY

CONTRACT NO. 66C09

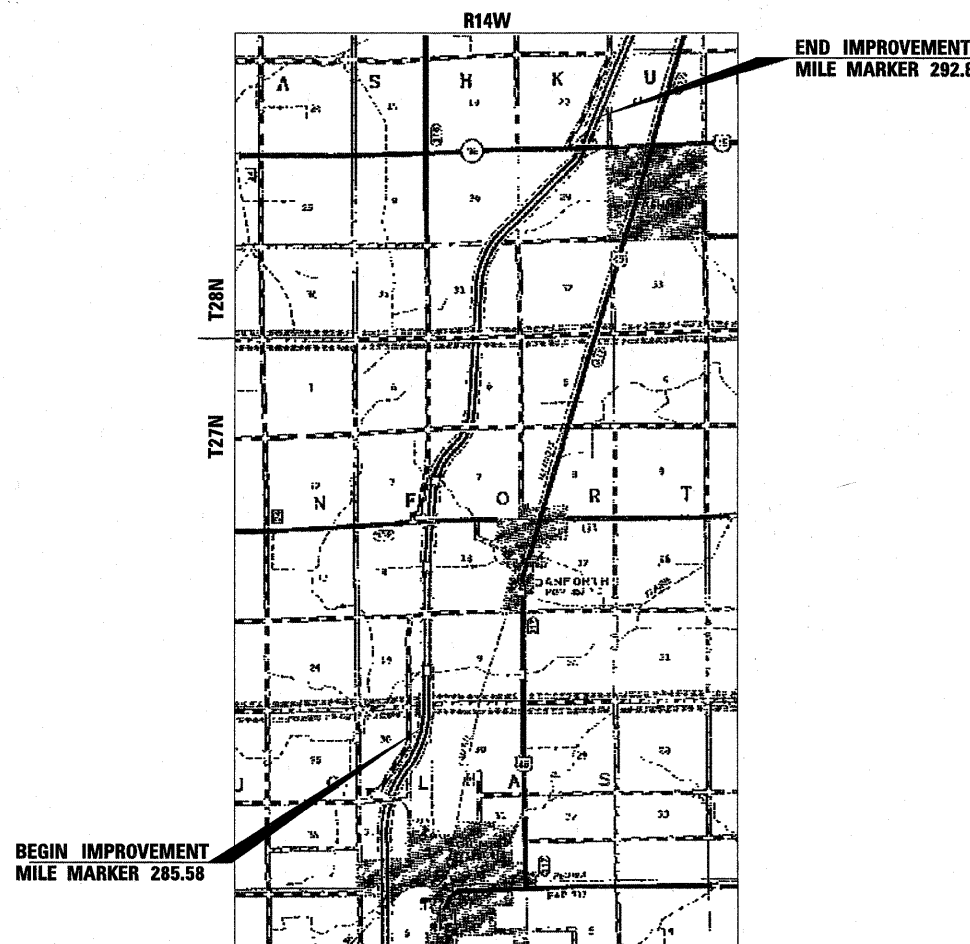

GROSS LENGTH = 38,121.6 FT. = 7.22 MILE
NET LENGTH = 24,828 FT. = 4.70 MILE

STATE OF ILLINOIS
DEPARTMENT OF TRANSPORTATION
DIVISION OF HIGHWAYS

SUBMITTED April 4 2012
Eric S. Therkildsen
DEPUTY DIRECTOR OF HIGHWAYS, REGION ENGINEER

May 11 2012
John D. Baranzelli, P.E.
acting ENGINEER OF DESIGN AND ENVIRONMENT

May 11 2012
William R. Flecker
acting DIRECTOR OF HIGHWAYS, CHIEF ENGINEER

PRINTED BY THE AUTHORITY
OF THE STATE OF ILLINOIS