

F.A.P. RTE.	SECTION	COUNTY	TOTAL SHEETS	SHEET NO.
316	(114)I	BUREAU	12	1
		ILLINOIS	CONTRACT NO. 66C11	

INDEX OF SHEETS

1. COVER SHEET
2. GENERAL NOTES
3. SUMMARY OF QUANTITIES
4. TYPICAL SECTION
5. TRAFFIC CONTROL AND PROTECTION, STANDARD 701321 (SPECIAL)
6. TYPICAL PAVEMENT MARKING DETAILS
- 7 - 8. ROADWAY DETAILS
- 9 - 12. STRUCTURE DETAILS FOR STRUCTURE NO. 006-2517

STANDARDS

- | | |
|-----------|--|
| 000001-06 | STANDARD SYMBOLS, ABBREVIATIONS AND PATTERNS |
| 001001-02 | AREAS OF REINFORCEMENT BARS |
| 001006 | DECIMAL OF AN INCH AND OF A FOOT |
| 420001-07 | PAVEMENT JOINTS |
| 420701-02 | PAVEMENT FABRIC |
| 442201-03 | CLASS C AND D PATCHES |
| 604081-04 | FRAMES AND GRATES, TYPE 22 |
| 606106-04 | OUTLET, TYPE 1 FOR TYPE A GUTTER |
| 635011-02 | REFLECTOR MARKER AND MOUNTING DETAILS |
| 701001-02 | OFF-ROAD OPERATIONS 2L, 2W, MORE THAN 15' (4.5 m) AWAY |
| 701006-03 | OFF-ROAD OPERATIONS 2L, 2W, 15' (4.5 m) TO 24" (600 mm) FROM PAVEMENT EDGE |
| 701201-04 | LANE CLOSURE, 2L, 2W, DAY ONLY, FOR SPEEDS \geq 45 MPH |
| 701301-04 | LANE CLOSURE, 2L, 2W, SHORT TIME OPERATIONS |
| 701901-02 | TRAFFIC CONTROL DEVICES |
| 704001-07 | TEMPORARY CONCRETE BARRIER |

STATE OF ILLINOIS
DEPARTMENT OF TRANSPORTATION
DIVISION OF HIGHWAYS
PROPOSED
HIGHWAY PLANS
FAP ROUTE 316 (IL 26)
SECTION (114)I

BOX CULVERT REPAIR
STRUCTURE NO. 006-2517
313 FEET SOUTH OF THE
LEE COUNTY LINE (BASE LINE RD)
BUREAU COUNTY
C-93-102-12

D-93-002-12



PROJECT LOCATION
STRUCTURE NO. 006-2517
STA. 1412 + 97

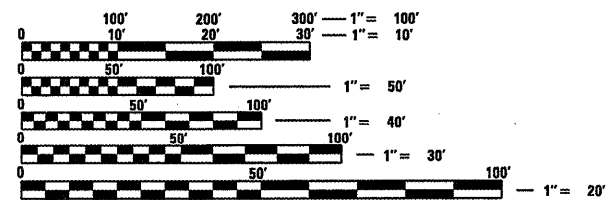

FULL SIZE PLANS HAVE BEEN PREPARED USING STANDARD ENGINEERING SCALES. REDUCED SIZED PLANS WILL NOT CONFORM TO STANDARD SCALES. IN MAKING MEASUREMENTS ON REDUCED PLANS, THE ABOVE SCALES MAY BE USED.

J.U.L.I.E.
 JOINT UTILITY LOCATION INFORMATION FOR EXCAVATION
 1-800-892-0123
 OR 811

DISTRICT NO. 3 (815) 434-6131

PROJECT ENGINEER: JOE KANNEL P.E.
UNIT CHIEF: RON WOODSHANK
TOWNSHIP: OHIO
CONTRACT NO. 66C11

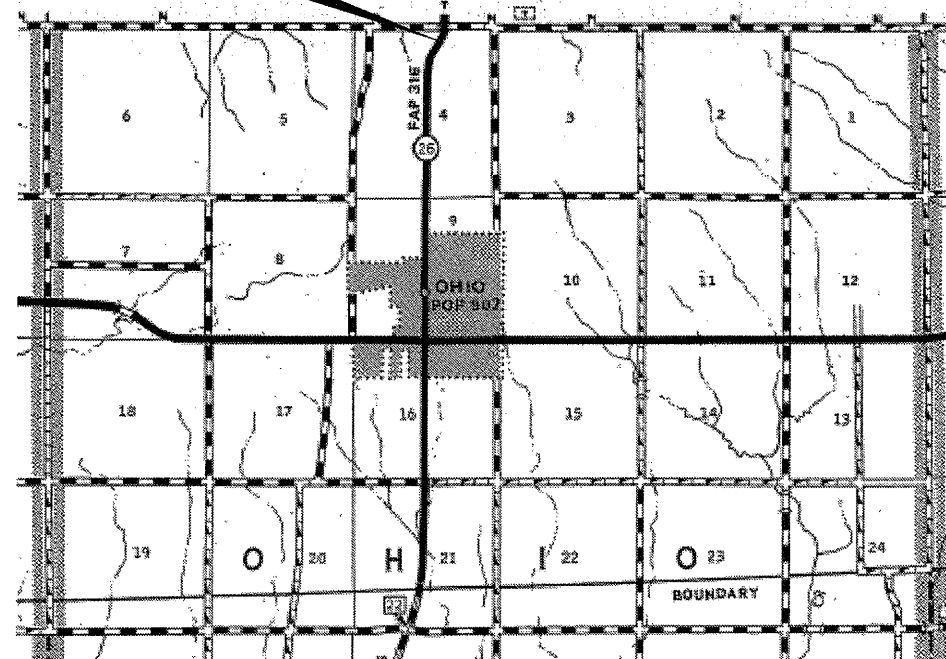

POINT LOCATION

OTHER PRINCIPAL ARTERIAL

FAP RTE. 316 (IL 26)

2011

ADT	1750
P.V.	77.43%
S.U.	6.86%
M.U.	15.71%

STATE OF ILLINOIS
 DEPARTMENT OF TRANSPORTATION
 DIVISION OF HIGHWAYS

SUBMITTED 4/6 2012
Eric S. Theobald
 DEPUTY DIRECTOR OF HIGHWAYS, REGION ENGINEER

May 11 2012
John D. Baranzelli P.E.
 acting ENGINEER OF DESIGN AND ENVIRONMENT

May 11 2012
William R. Freyer
 acting DIRECTOR OF HIGHWAYS, CHIEF ENGINEER

PRINTED BY THE AUTHORITY
OF THE STATE OF ILLINOIS