

**INDEX OF SHEETS**

1. COVER SHEET
2. GENERAL NOTES
3. SUMMARY OF QUANTITIES
4. TYPICAL SECTION
5. STRUCTURE PLANS

**STANDARDS**

- 000001-06 STANDARD SYMBOLS, ABBREVIATIONS AND PATTERNS
- 001006 DECIMAL OF AN INCH AND OF A FOOT
- 701001-02 OFF-ROAD OPERATIONS 2L, 2W, MORE THAN 15' (4.5 m) AWAY
- 701006-03 OFF-ROAD OPERATIONS 2L, 2W, 15' (4.5 m) TO 24" (600 mm) FROM PAVEMENT EDGE
- 701201-04 LANE CLOSURE, 2L, 2W, DAY ONLY, FOR SPEEDS  $\leq$  45 MPH
- 701301-04 LANE CLOSURE, 2L, 2W, SHORT TIME OPERATIONS
- 701901-02 TRAFFIC CONTROL DEVICES

**STATE OF ILLINOIS**  
**DEPARTMENT OF TRANSPORTATION**  
**DIVISION OF HIGHWAYS**  
**PROPOSED**  
**HIGHWAY PLANS**

**FAP 796 ROUTE (IL 115)**  
**SECTION (104BR)**

**BRIDGE REPAIR**  
**FURNISHING & ERECTING STRUCTURAL STEEL**  
**FOR SLAB SUPPORT ON SN 046-0067**  
**KANKAKEE COUNTY**

C-93-126-12

|             |         |          |                    |           |
|-------------|---------|----------|--------------------|-----------|
| F.A.P. RTE. | SECTION | COUNTY   | TOTAL SHEETS       | SHEET NO. |
| 796         | (104BR) | KANKAKEE | 5                  | 1         |
|             |         | ILLINOIS | CONTRACT NO. 66C30 |           |

D-93-065-12

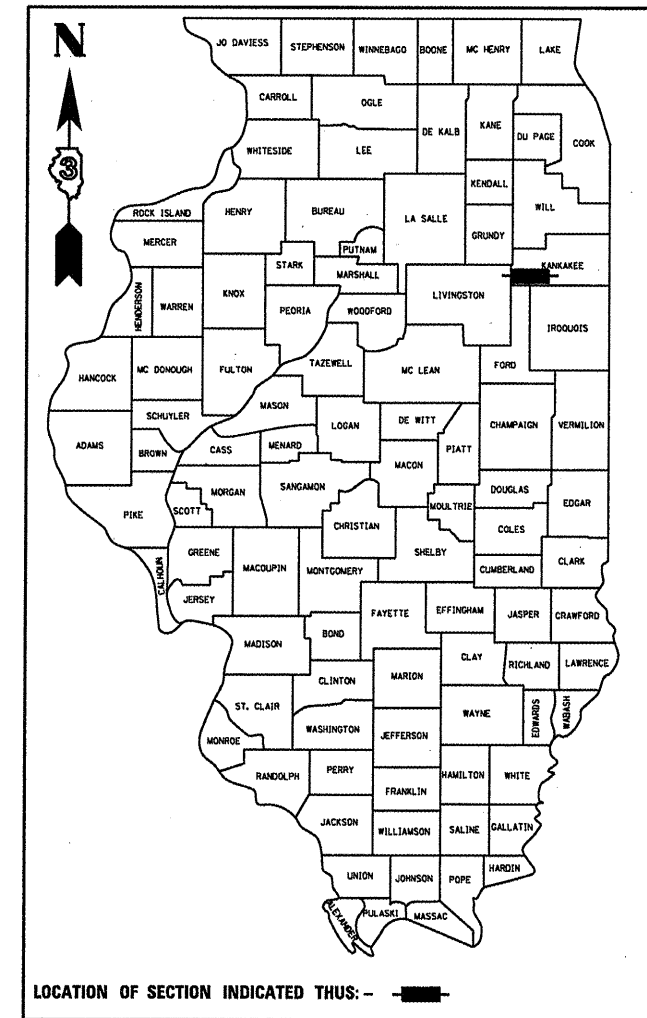

**RURAL**  
**MIN ARTERIAL NON-URB**  
**FAP 796 (IL 115)**  
**2011**

|      |       |
|------|-------|
| ADT  | 500   |
| P.V. | 91.6% |
| S.U. | 5.8%  |
| M.U. | 2.6%  |

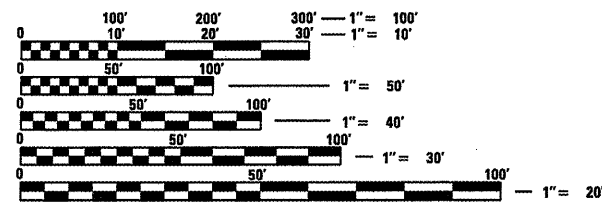

FULL SIZE PLANS HAVE BEEN PREPARED USING STANDARD ENGINEERING SCALES. REDUCED SIZED PLANS WILL NOT CONFORM TO STANDARD SCALES. IN MAKING MEASUREMENTS ON REDUCED PLANS, THE ABOVE SCALES MAY BE USED.

J.U.L.I.E.  
 JOINT UTILITY LOCATION INFORMATION FOR EXCAVATION  
 1-800-892-0123  
 OR 811

DISTRICT NO. (815)-434-6131

PROJECT ENGINEER: JOE KANNEL, P.E.  
 UNIT CHIEF: RON WOODSHANK  
 TOWNSHIP: NORTON

CONTRACT NO. 66C30

**PROJECT LOCATION**  
 SN 046-0067  
 STA. 953 + 12

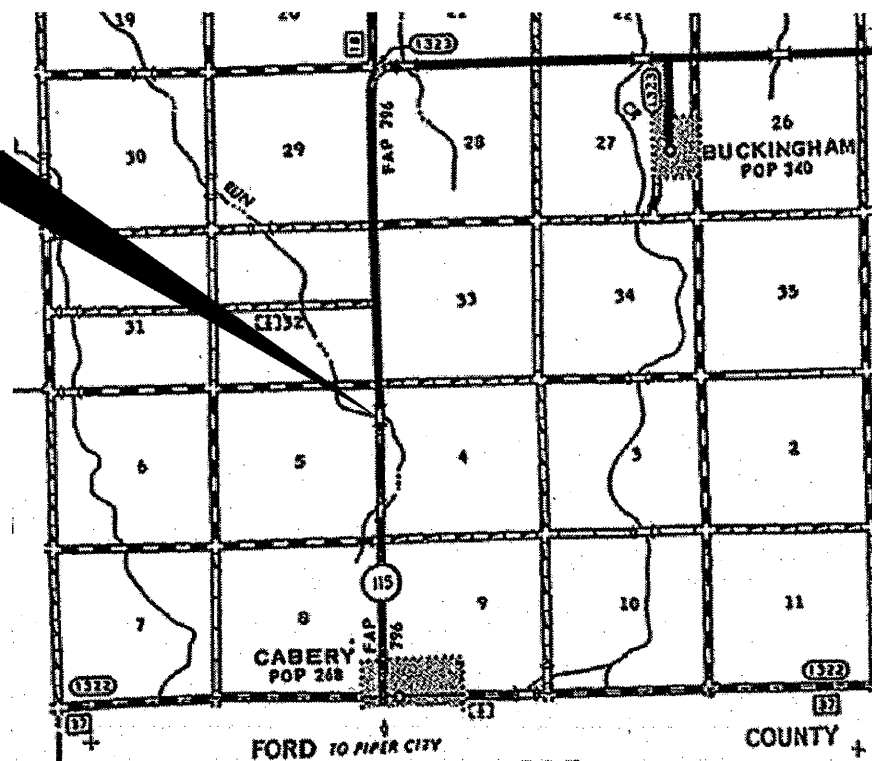

GROSS LENGTH = 26 FT. = .005 MILE  
 NET LENGTH = 26 FT. = 0.005 MILE

STATE OF ILLINOIS  
 DEPARTMENT OF TRANSPORTATION  
 DIVISION OF HIGHWAYS

SUBMITTED 4/6 20 12  
*Eric S. Theobaldson*  
 DEPUTY DIRECTOR OF HIGHWAYS, REGION ENGINEER

May 11 20 12  
*John D. Baumgall, P.E.*  
 ENGINEER OF DESIGN AND ENVIRONMENT

May 11 20 12  
*William R. Freyer*  
 DIRECTOR OF HIGHWAYS, CHIEF ENGINEER

**PRINTED BY THE AUTHORITY**  
**OF THE STATE OF ILLINOIS**