

### WB McClugage Traffic Control

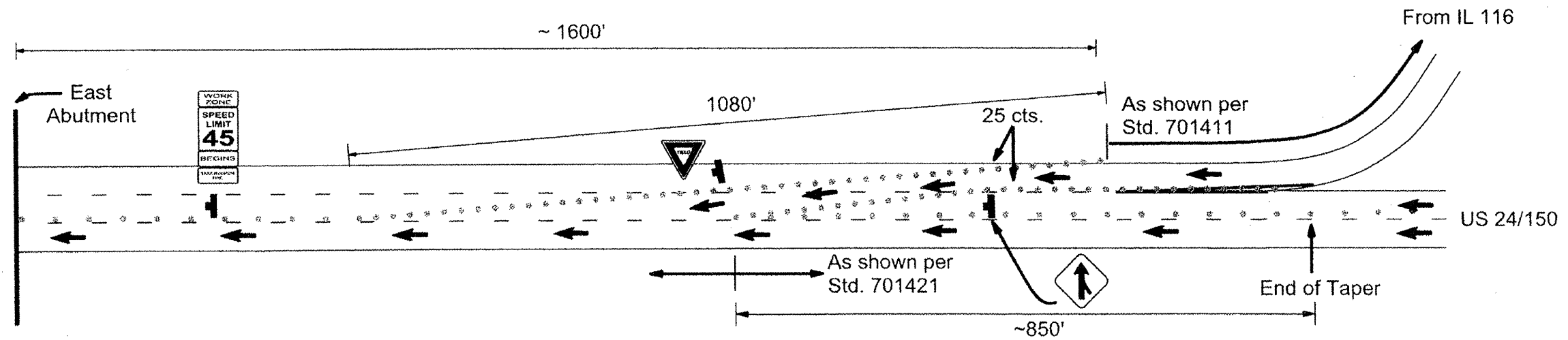

Std. 701421 & 701411 shall be used with the addition of the layout as shown above. Additional devices and layout as shown shall have any additional cost incidental to aforementioned standards.

Three (3) Changeable Message Boards shall be required for the duration of the traffic control while active. One on US 24, one on IL 116 EB, & one on IL 116 WB.

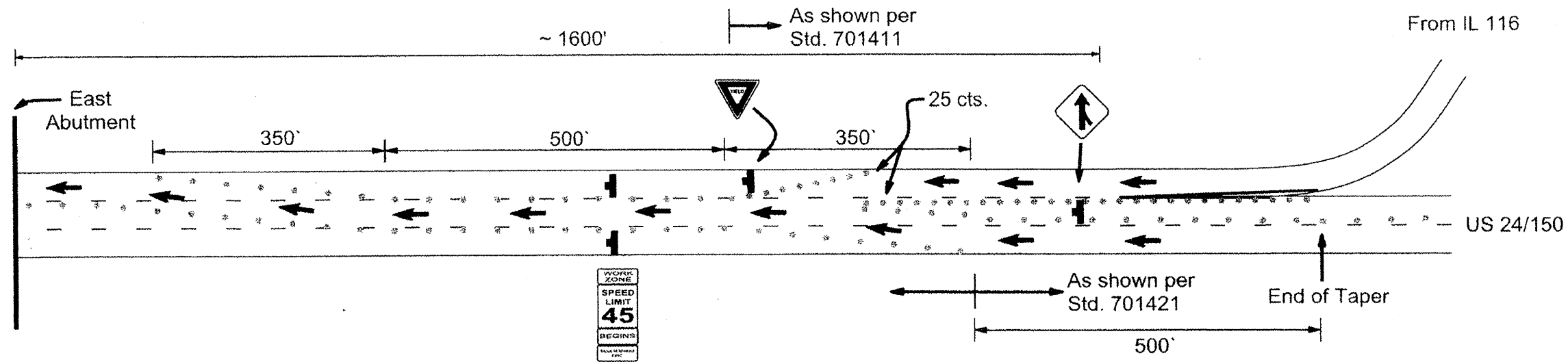

Std. 701421 & 701411 shall be used with the addition of the layout as shown above. Additional devices and layout as shown shall have any additional cost incidental to aforementioned standards.

EB McCluggage Traffic Control  
Traffic Control Standard 701602 & 701411 shall be Used.

FILE NAME = D4 washing 68A99 June 2012.dgn	USER NAME = AdadeSA	DESIGNED -	REVISED -	<b>STATE OF ILLINOIS DEPARTMENT OF TRANSPORTATION</b>	SCALE: _____ SHEET _____ OF _____ SHEETS STA. _____ TO STA. _____	F.A. RTE. var. D4 Bridge Washing 2012	SECTION Tazewell	COUNTY Tazewell	TOTAL SHEETS 8	SHEET NO. 8A
PLT SCALE = 2.0037" / 1in.	PLT DATE = 3/22/2012	DRAWN -	REVISED -			CONTRACT NO. 68A99		ILLINOIS FED. AID PROJECT		