

F.A.P. RTE.	SECTION	COUNTY	TOTAL SHEETS	SHEET NO.
643	(11B)-1	STARK	9	1
		ILLINOIS	CONTRACT NO. 68B06	

STATE OF ILLINOIS
DEPARTMENT OF TRANSPORTATION
DIVISION OF HIGHWAYS
**PROPOSED
HIGHWAY PLANS**

FAP ROUTE 643 (IL 17/IL 91)
SECTION (11B)-1

EMERGENCY BRIDGE BEAM BRACING
STARK COUNTY

C-94-093-12

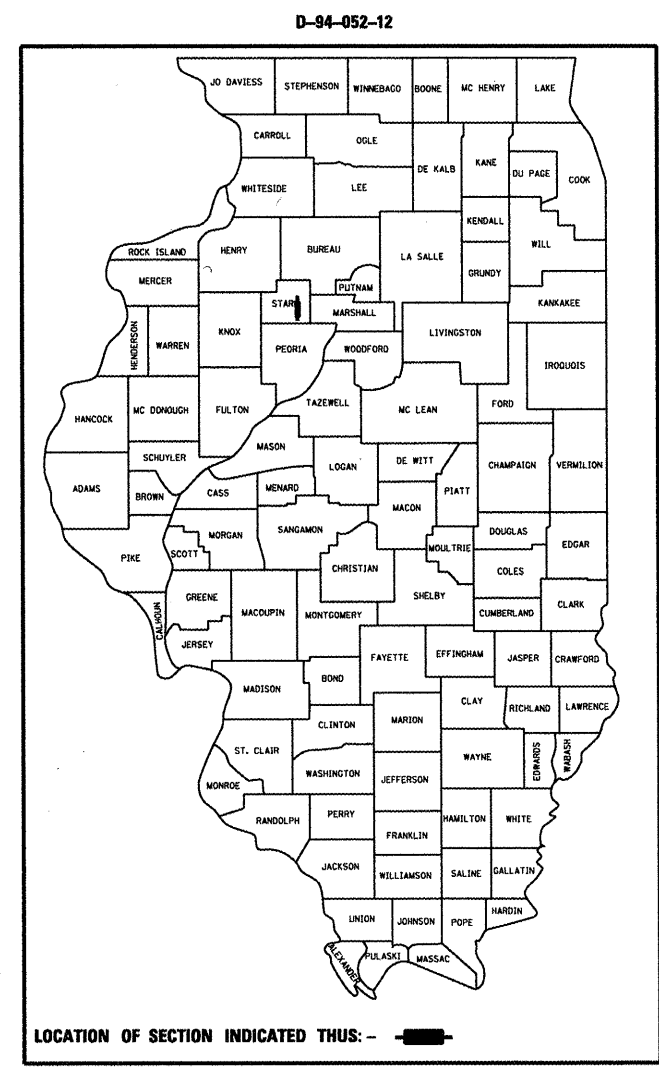

INDEX OF SHEETS

- 1 COVER SHEET
- 2 GENERAL NOTES/COMMITMENTS/JOB SPECIFIC NOTES
- 3 SUMMARY OF QUANTITIES
- 4 TYPICAL SECTIONS
- 5 SCHEDULE OF QUANTITIES
- 6 PLAN VIEW
- 7-9 STRUCTURAL DETAILS

HIGHWAY STANDARDS

- 701001-02
- 701006-03
- 701301-04
- 701311-03
- 701316-06
- 701901-02

DESIGN DESIGNATION

ADT = 1700 (2011)
MU = 2.35%
SU = 3.53%

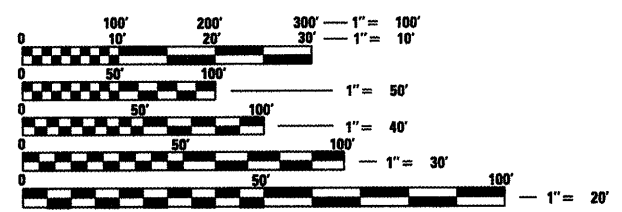

FULL SIZE PLANS HAVE BEEN PREPARED USING STANDARD ENGINEERING SCALES. REDUCED SIZED PLANS WILL NOT CONFORM TO STANDARD SCALES. IN MAKING MEASUREMENTS ON REDUCED PLANS, THE ABOVE SCALES MAY BE USED.

J.U.L.I.E.
JOINT UTILITY LOCATION INFORMATION FOR EXCAVATION
1-800-892-0123
OR 811

PROJECT ENGINEER RICH DOTSON
PROJECT MANAGER ANNA GHIDINA

CATALOG NO. 034817-00D
CONTRACT NO. 68B06

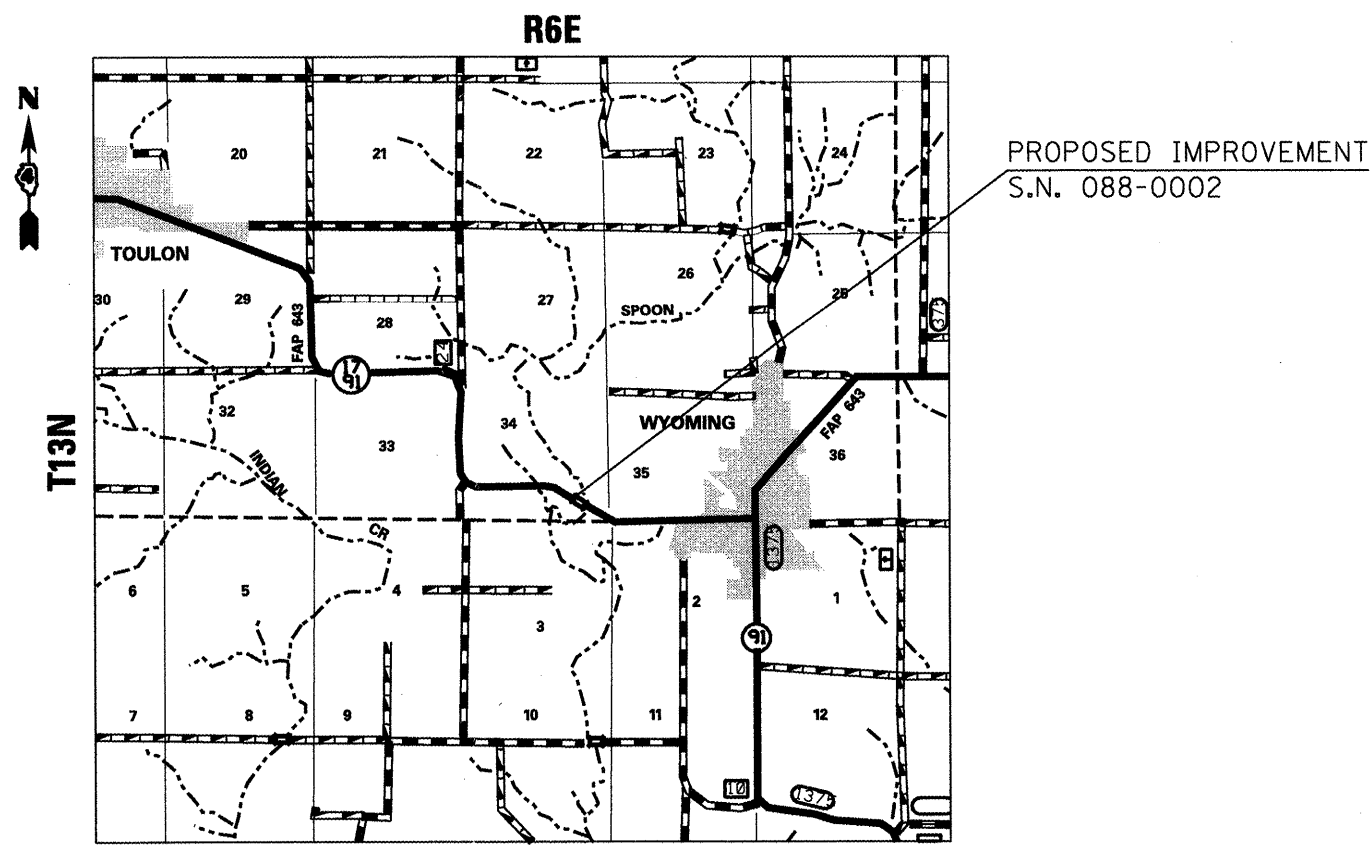

GROSS LENGTH = 260 FT. = 0.05 MILE
NET LENGTH = 260 FT. = 0.05 MILE

STATE OF ILLINOIS
DEPARTMENT OF TRANSPORTATION
DIVISION OF HIGHWAYS

SUBMITTED *April 20 2012*

[Signature]
DEPUTY DIRECTOR OF HIGHWAYS, REGION ENGINEER

May 11 2012
John D. Baranelli, P.E.
ENGINEER OF DESIGN AND ENVIRONMENT

May 11 2012
William R. Freyer
DIRECTOR OF HIGHWAYS, CHIEF ENGINEER

PRINTED BY THE AUTHORITY
OF THE STATE OF ILLINOIS