

DATE	
BY	
REVIEWED	
PLANNED	
NOTE BOOK NO.	
ADD. FILE NAME	

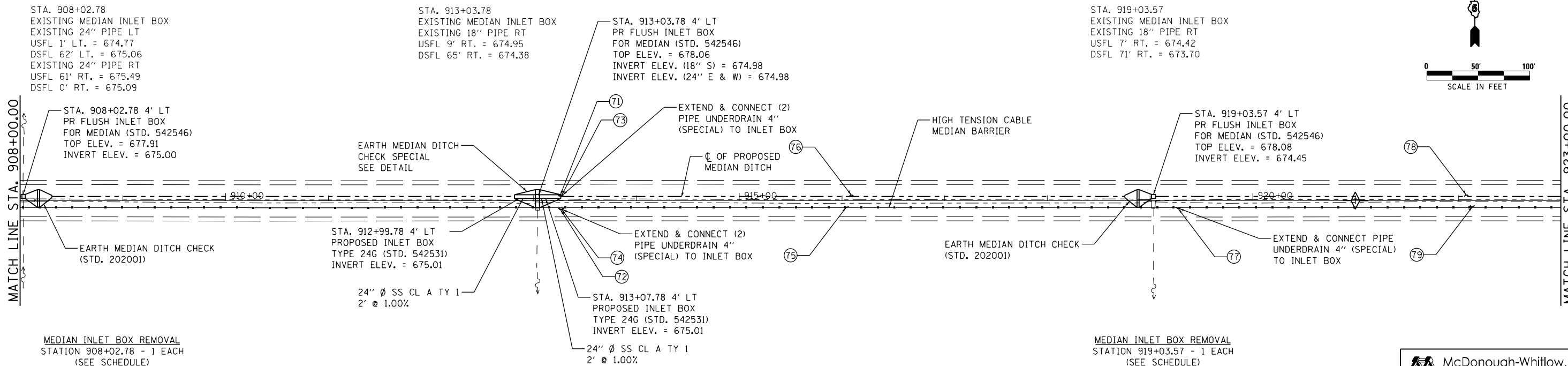

MEDIAN INLET BOX REMOVAL
STATION 908+02.78 - 1 EACH
(SEE SCHEDULE)

MEDIAN INLET BOX REMOVAL
STATION 913+03.78 - 1 EACH
(SEE SCHEDULE)

MEDIAN INLET BOX REMOVAL
STATION 919+03.57 - 1 EACH
(SEE SCHEDULE)

⊕ INDICATES PIPE UNDERDRAINS, 4" (SPECIAL)
SEE SCHEDULE

McDonough-Whitlow, P.C.
Consulting Engineers & Land Surveyors
138 East Wood Street
Hillsboro, IL 62049
Phone: 217.532.9233
Fax: 217.532.6300
PROFESSIONAL DESIGN NO. 184-002754

DATE	
BY	
REVIEWED	
PLANNED	
NOTE BOOK NO.	
ADD. FILE NAME	

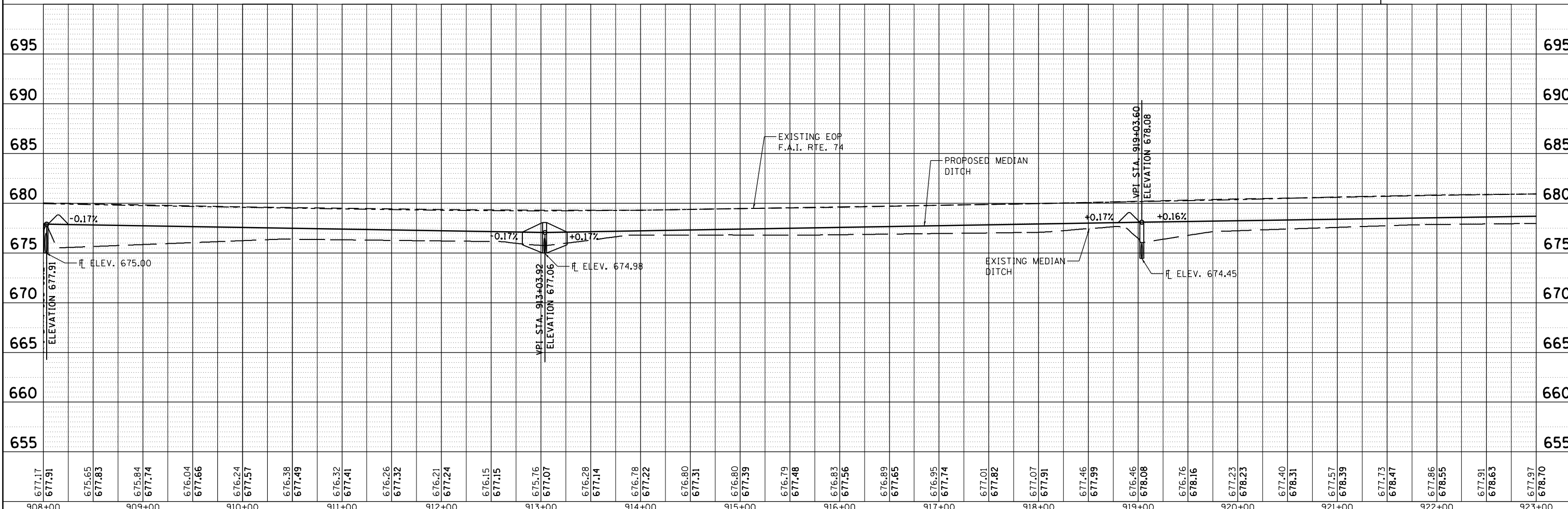

FILE NAME = D570966-XXX-PLNPRF11.dgn	USER NAME = RNH	DESIGNED - JAH	REVISED -	STATE OF ILLINOIS DEPARTMENT OF TRANSPORTATION	PLAN & PROFILE F.A.I. 74	F.A.I. RTE. 74	SECTION MEDIAN CABLE 2012-1	COUNTY	TOTAL SHEETS 130	SHEET NO. 23	
PLOT SCALE = 50	CHECKED - TMM	REVISED -	SCALE: 1"=50'			SHEET NO. 11 OF 27 SHEETS	STA. 908+00.00 TO STA. 923+00.00	CONTRACT NO. 70966		ILLINOIS FED. AID PROJECT	
PLOT DATE =	DATE -	REVISED -	*CHAMPAIGN & VERMILION								