

NOTES:
 ALL PROPOSED HMA SHOULDERS HAVE A WIDTH OF 3'-0" UNLESS OTHERWISE NOTED WITHIN THE PLAN SHEETS AND TYPICAL CROSS SECTION SHEETS.
 THE PROPOSED TREATMENT FOR RESURFACING EXISTING HMA SHOULDERS SHALL BE THE SAME AS THE PROPOSED TREATMENT FOR RESURFACING MAINLINE PAVEMENT.
 ALL PROPOSED AGGREGATE SHOULDERS HAVE A WIDTH OF 4'-0" UNLESS OTHERWISE NOTED WITHIN THE PLAN SHEETS AND TYPICAL CROSS SECTION SHEETS.

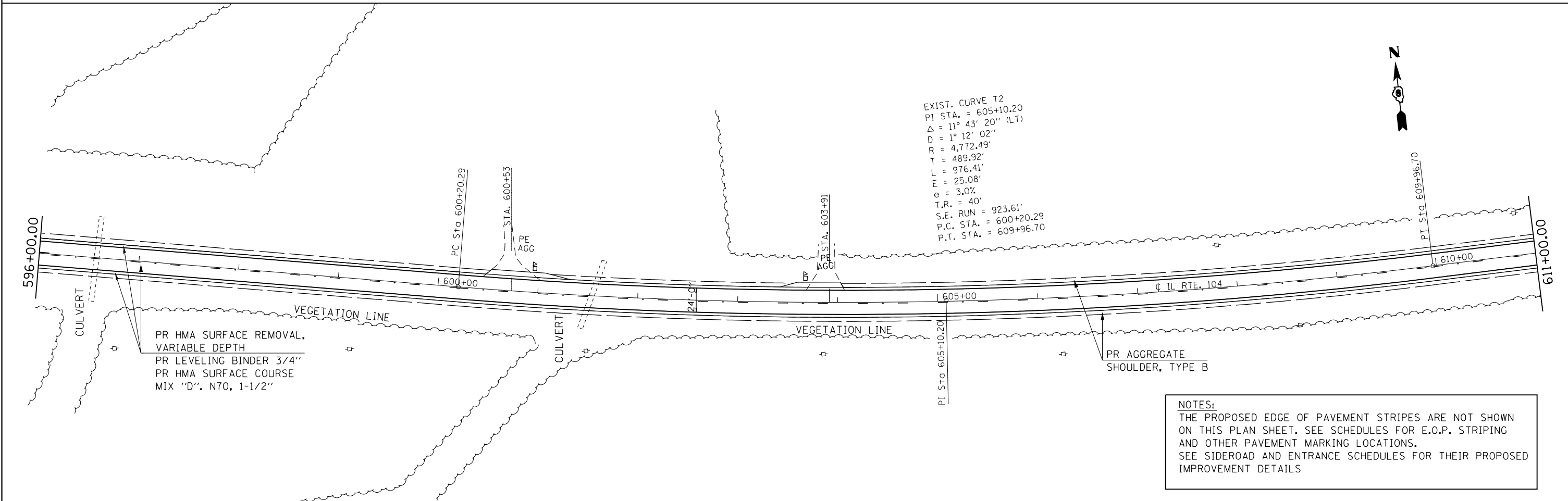

NOTES:
 THE PROPOSED EDGE OF PAVEMENT STRIPES ARE NOT SHOWN ON THIS PLAN SHEET. SEE SCHEDULES FOR E.O.P. STRIPING AND OTHER PAVEMENT MARKING LOCATIONS.
 SEE SIDEROAD AND ENTRANCE SCHEDULES FOR THEIR PROPOSED IMPROVEMENT DETAILS

FILE NAME =	USER NAME = sparksgw	DESIGNED - ETJ	REVISED -	STATE OF ILLINOIS DEPARTMENT OF TRANSPORTATION	PLAN SHEETS AUBURN TO I-55 INTERCHANGE			F.A.P. RTE. 753	SECTION (140RS-6, 141RS-7)I	COUNTY SANGAMON	TOTAL SHEETS 98	SHEET NO. 32
c:\pwork\pwork\sparksgw\10245433\11104WEST.dgn		DRAWN - ETJ	REVISED -		SCALE:	SHEET 3 OF 8 SHEETS	STA.	TO STA.	CONTRACT NO. 72E12			
		CHECKED -	REVISED -		ILLINOIS FED. AID PROJECT							
		DATE -	REVISED -									