

-  PR CORRUGATED MEDIAN REMOVAL
PR SUB-BASE GRANULAR MATERIAL, TYPE A, 4"
PR HMA BASE COURSE, 12"
PR LEVELING BINDER, N90, 1"
PR HMA SURFACE COURSE, MIX "D", N90, 1 1/2"
-  PR MEDIAN SURFACE REMOVAL
PR SUB-BASE GRANULAR MATERIAL, TYPE A, 4"
PR HMA BASE COURSE, 12"
PR LEVELING BINDER, N90, 1"
PR HMA SURFACE COURSE, MIX "D", N90, 1 1/2"

-  PR EARTH EXCAVATION
PR SUB-BASE GRANULAR MATERIAL, TYPE A, 4"
PR HMA BASE COURSE, 12"
PR LEVELING BINDER, N90, 1"
PR HMA SURFACE COURSE, MIX "D", N90, 1 1/2"

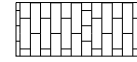
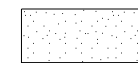
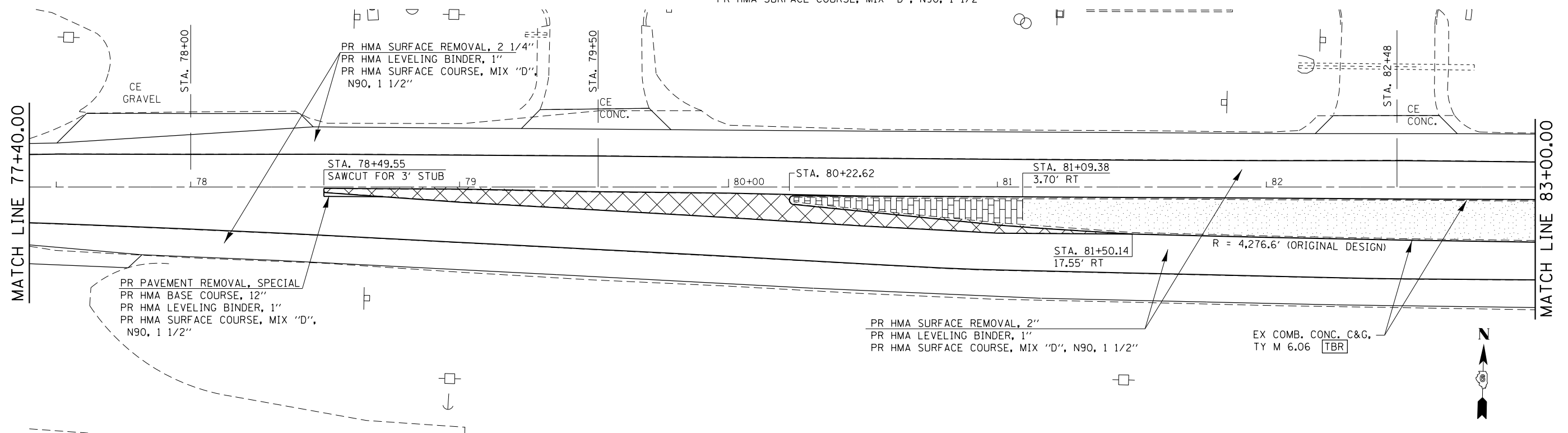

FILE NAME =	USER NAME = sparksgw	DESIGNED - RTS	REVISED -
c:\pwork\pwork\dot\sparksgw\10245433\0672E12-SHT-20PLAN.dgn		DRAWN - RTS	REVISED -
PLOT SCALE = 40.0000' / in.		CHECKED -	REVISED -
PLOT DATE = Apr-09-2012 03:33:35PM		DATE -	REVISED -

**STATE OF ILLINOIS
DEPARTMENT OF TRANSPORTATION**

PLAN SHEETS, I-55 INTERCHANGE

SCALE: SHEET 1 OF 7 SHEETS STA. TO STA.

F.A.P. RTE.	SECTION	COUNTY	TOTAL SHEETS	SHEET NO.
753	(140RS-6, 141RS-7)I	SANGAMON	38	98
CONTRACT NO. 72E12				
ILLINOIS FED. AID PROJECT				