

STAGE PRE-STAGE

- WORK AREA
- TRAFFIC FLOW DIRECTION ARROWS
- TYPE III BARRICADE
- TEMPORARY PAVEMENT
- TEMPORARY PAVEMENT MARKING - SYMBOLS

RAMP CLOSURES
NONE

ROAD CLOSURES
NONE

PROHIBITED MOVEMENTS
NONE

DETOURS
NONE

TEMPORARY TRAFFIC SIGNAL INSTALLATION
TO MAINTAIN EXISTING PHASING & INCLUDE WHISKEY ROAD
FOR CONSTRUCTION STAGES PRESTAGE THRU A3

WORKFLOW

- 1) INSTALL TEMPORARY TRAFFIC SIGNAL
- 2) REMOVE EXISTING CURBS, GUTTERS AND SHOULDERS
IN PREPARATION OF TEMPORARY WIDENING
- 3) CONSTRUCT PROPOSED PORTION OF WHISKEY ROAD
- 4) CONSTRUCT TEMPORARY PAVEMENT

APPROACH SIGNING - ALL APPROACHES TO PROJECT AREA

ROAD CONSTRUCTION AHEAD

W20-1103(O)-48

SPEED LIMIT 25

R2-1-2430

THESE SIGNS SHALL BE PLACED 400' PRIOR TO ANY SHIFT OR TAPER PRIOR TO THE CONSTRUCTION ZONE. IN THE EVENT OF A CONFLICT WITH AN IDOT STANDARD DETAIL, THE STANDARD DETAIL SHALL GOVERN, HOWEVER THE SPEED LIMIT SIGN SHALL BE ADDED TO THE "ROAD CONSTRUCTION AHEAD" SIGN.

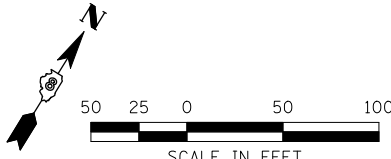
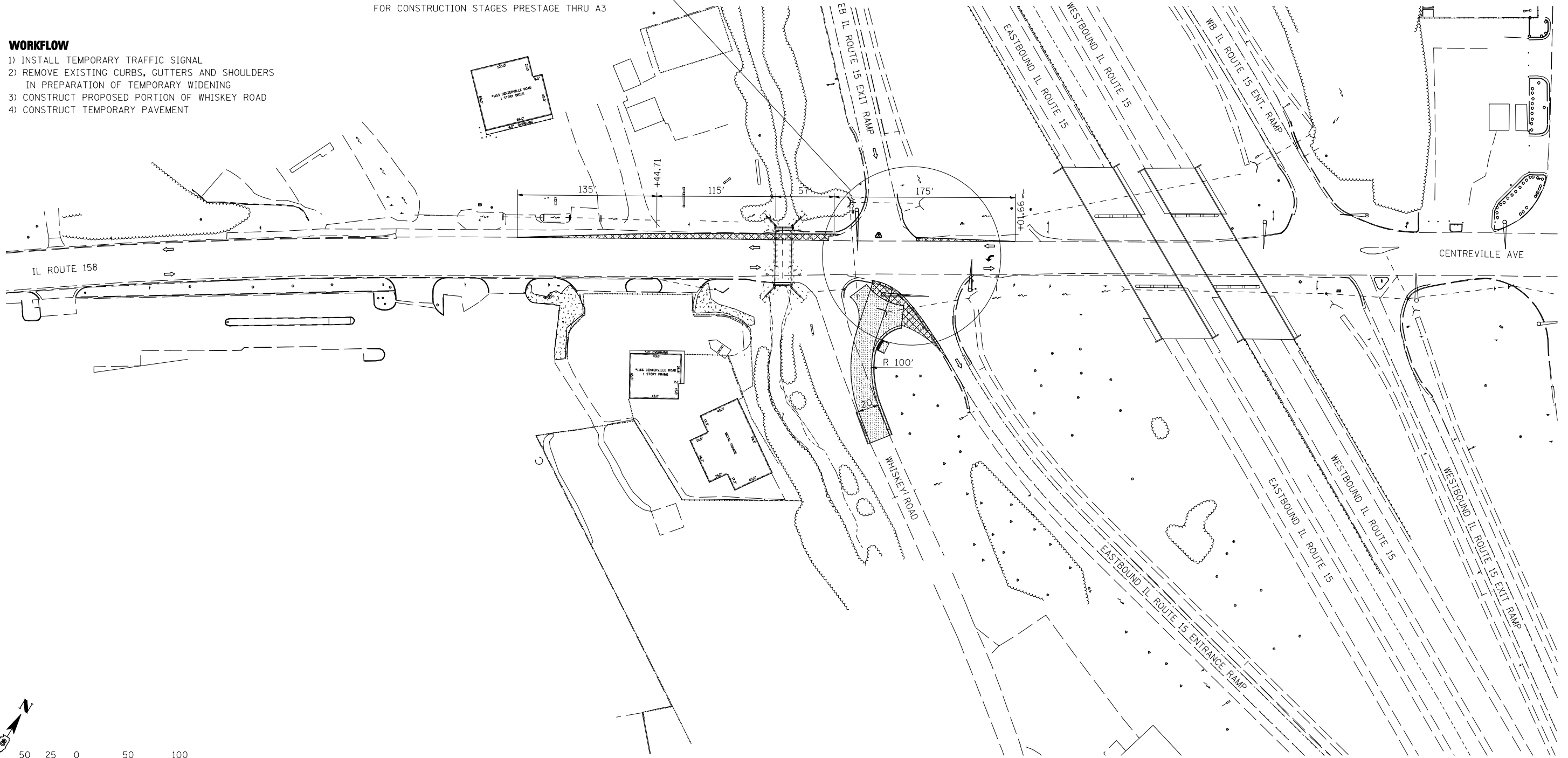

LAST SAVED = 3/20/2012
 PEN TABLE = V8-H4-14-14
 PLOT DRIVER = TR-18pdf-Block-Half.plt

FILE NAME =	USER NAME = bschmidt	DESIGNED -	REVISED -
1:\0906600\0906603\Cad\T\Plans\019-D876006-Sht-Staging-Prestage.dgn		DRAWN -	REVISED -
PLOT SCALE = 100.0000' / IN.		CHECKED -	REVISED -
PLOT DATE = 3/20/2012 8:51:17 PM		DATE -	REVISED -

**STATE OF ILLINOIS
DEPARTMENT OF TRANSPORTATION**

**HORNER &
SHIRIN, INC.
ENGINEERS**

**SUGGESTED STAGES OF CONSTRUCTION
AND TRAFFIC CONTROL**
STAGE PRE-STAGE

SCALE: NONE 1"=50' SHEET NO. 1 OF 23 SHEETS STA. TO STA.

① F.A.P. RTE 809 / F.A.U. RTE 9251 / F.A.U. RTE 9269			
F.A. RTE.	SECTION	COUNTY	TOTAL SHEETS
①	135-N	ST. CLAIR	206
			SHEET NO. 50
CONTRACT NO. 76D06			
ILLINOIS FED. AID PROJECT			