

\DBTR1-71-LANDSCAPING\PROJECTS\71-NDSCPL.DGN, \DBTR1-48-LANDSCAPING\PROJECTS\48-NDSCPL.DGN, \DBTR1-37-LANDSCAPING\PROJECTS\37-NDSCPL.DGN, \DBTR1-36-LANDSCAPING\PROJECTS\36-NDSCPL.DGN, \DBTR1-26-LANDSCAPING\PROJECTS\26-NDSCPL.DGN, \DBTR1-25-LANDSCAPING\PROJECTS\25-NDSCPL.DGN, \DBTR1-24-LANDSCAPING\PROJECTS\24-NDSCPL.DGN, \DBTR1-23-LANDSCAPING\PROJECTS\23-NDSCPL.DGN, \DBTR1-22-LANDSCAPING\PROJECTS\22-NDSCPL.DGN, \DBTR1-21-LANDSCAPING\PROJECTS\21-NDSCPL.DGN, \DBTR1-20-LANDSCAPING\PROJECTS\20-NDSCPL.DGN, \DBTR1-19-LANDSCAPING\PROJECTS\19-NDSCPL.DGN, \DBTR1-18-LANDSCAPING\PROJECTS\18-NDSCPL.DGN, \DBTR1-17-LANDSCAPING\PROJECTS\17-NDSCPL.DGN, \DBTR1-16-LANDSCAPING\PROJECTS\16-NDSCPL.DGN, \DBTR1-15-LANDSCAPING\PROJECTS\15-NDSCPL.DGN, \DBTR1-14-LANDSCAPING\PROJECTS\14-NDSCPL.DGN, \DBTR1-13-LANDSCAPING\PROJECTS\13-NDSCPL.DGN, \DBTR1-12-LANDSCAPING\PROJECTS\12-NDSCPL.DGN, \DBTR1-11-LANDSCAPING\PROJECTS\11-NDSCPL.DGN, \DBTR1-10-LANDSCAPING\PROJECTS\10-NDSCPL.DGN, \DBTR1-9-LANDSCAPING\PROJECTS\9-NDSCPL.DGN, \DBTR1-8-LANDSCAPING\PROJECTS\8-NDSCPL.DGN, \DBTR1-7-LANDSCAPING\PROJECTS\7-NDSCPL.DGN, \DBTR1-6-LANDSCAPING\PROJECTS\6-NDSCPL.DGN, \DBTR1-5-LANDSCAPING\PROJECTS\5-NDSCPL.DGN, \DBTR1-4-LANDSCAPING\PROJECTS\4-NDSCPL.DGN, \DBTR1-3-LANDSCAPING\PROJECTS\3-NDSCPL.DGN, \DBTR1-2-LANDSCAPING\PROJECTS\2-NDSCPL.DGN, \DBTR1-1-LANDSCAPING\PROJECTS\1-NDSCPL.DGN

MATCH LINE STA. 48+00
 RAMP EB I-64, SEE SHEET 19

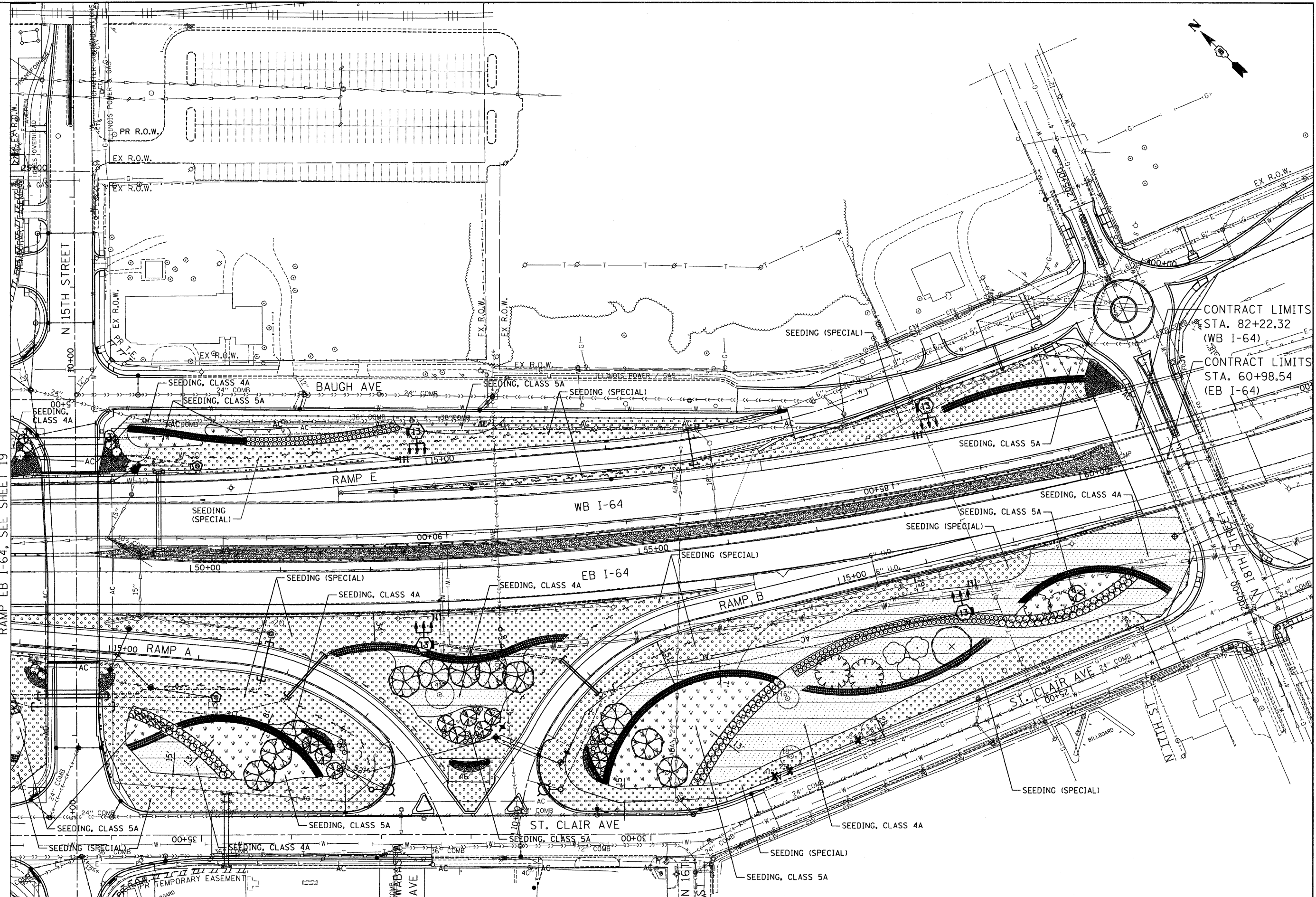

CONTRACT LIMITS
 STA. 82+22.32
 (WB I-64)
 CONTRACT LIMITS
 STA. 60+98.54
 (EB I-64)

FILE NAME =	USER NAME = #USER#	DESIGNED - JM	REVISED -
#FILEL#		DRAWN - MDN	REVISED -
	PLOT SCALE = #SCALE#	CHECKED - JB	REVISED -
	PLOT DATE = #DATE#	DATE - 03/23/12	REVISED -

DESIGNED - JM	REVISED -
DRAWN - MDN	REVISED -
CHECKED - JB	REVISED -
DATE - 03/23/12	REVISED -

STATE OF ILLINOIS
 DEPARTMENT OF TRANSPORTATION

PROPOSED LANDSCAPING PLANS
 STA. 48+00 TO STA. 62+00

SCALE: 1"=50'
 SHEET NO. 4 OF 5 SHEETS STA. TO STA.

F.A.I. RTE.	SECTION	COUNTY	TOTAL SHEETS	SHEET NO.
64	82-1-RIALS	ST. CLAIR	89	20
CONTRACT NO. 76F71				
FED. ROAD DIST. NO.		ILLINOIS FED. AID PROJECT		