

LOCATION 3 MAP & TYPICAL SECTION IL 127 (FAP 42) NORTH OF PINCKNEYVILLE STA 190+00 TO STA 498+65.8

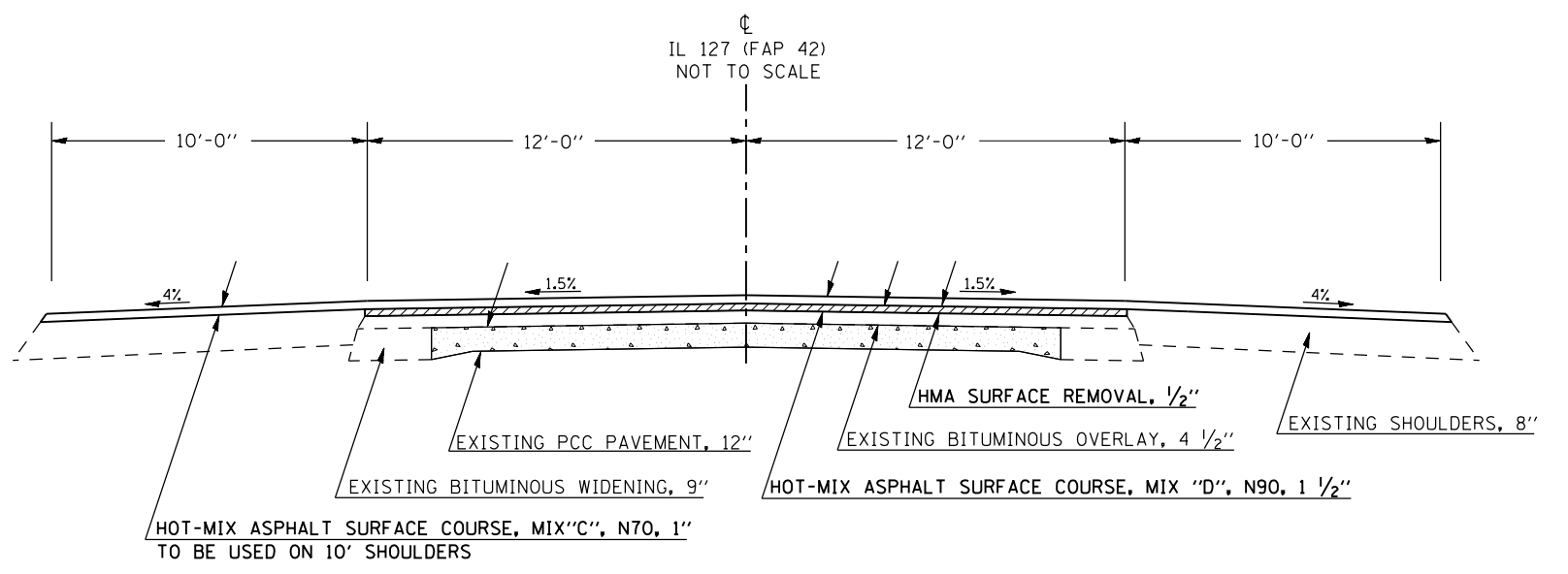
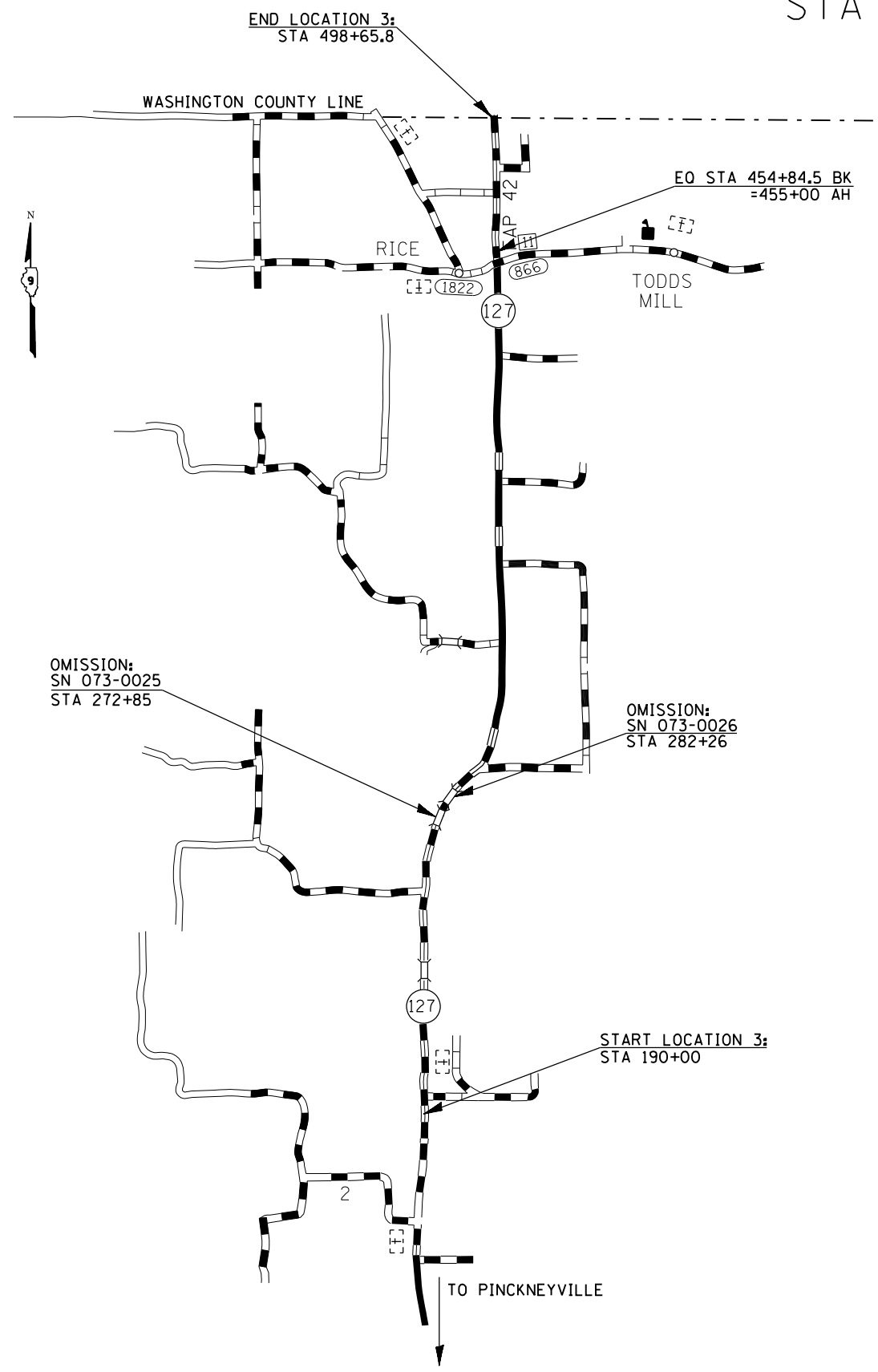

TO BE USED:
 STA 190+00 TO STA 272+11.372
 STA 273+58.62 TO STA 281+06.91
 STA 283+45.09 TO STA 498+65.8

FILE NAME =	USER NAME = \$USER\$	DESIGNED -	REVISED -
ct:\pw\work\p\dot\lavenderba\d0302467\78292-sht-plan.dgn		DRAWN -	REVISED -
	PLOT SCALE = 100.0000' / in.	CHECKED -	REVISED -
	PLOT DATE = 3/22/2012	DATE -	REVISED -

**STATE OF ILLINOIS
DEPARTMENT OF TRANSPORTATION**

LOCATION 3 MAP & TYPICAL SECTION			
SCALE:	SHEET	OF SHEETS	STA. TO STA.

*FAP 42/FAU 9668/9669		*PERRY & JACKSON	
F.A. RTE.	SECTION	COUNTY	TOTAL SHEETS
	(8,103) RS-2; (12-2) RS-1		19
			SHEET NO. 14
CONTRACT NO. 78292			
ILLINOIS FED. AID PROJECT			