

INDEX OF SHEETS	
SHEET NO.	DESCRIPTION
1	COVER SHEET
2	GENERAL NOTES & ROAD CLOSURE DETAIL
3	SUMMARY OF QUANTITIES
4	TYPICAL SECTIONS
5	REMOVAL PLAN
6	PLAN AND PROFILE
7	EROSION CONTROL, PAVEMENT MARKING & RESTORATION PLAN
8-12	STRUCTURE PLANS
13	SIDWALK RAMP DETAILS
14	SANITARY MANHOLE DETAILS
15-16	CROSS SECTIONS

STATE STANDARDS	
000001-06	STANDARD SYMBOLS, ABBREVIATIONS AND PATTERNS
280001-06	TEMPORARY EROSION CONTROL SYSTEM
424001-06	PERPENDICULAR CURB RAMPS FOR SIDEWALKS
424011	CORNER PARALLEL CURB RAMPS FOR SIDEWALKS
424016	MID-BLOCK CURB RAMPS FOR SIDEWALKS
515001-03	NAME PLATE FOR BRIDGES
602001-02	CATCH BASIN TYPE A
602301-03	INLET - TYPE A
602401-03	MANHOLE TYPE A
604001-03	FRAME AND LIDS TYPE 1
604006-04	FRAME AND GRATE TYPE 3
606001-04	CONCRETE CURB TYPE B AND COMBINATION CONCRETE CURB AND GUTTER
701006-03	OFF-RD OPERATIONS, 2L, 2W, 15' TO 24' FROM PAVEMENT EDGE
701011-02	OFF-RD MOVING OPERATIONS, 2L, 2W, DAY ONLY
701301-04	LANE CLOSURE, 2L, 2W, SHORT TERM OPERATIONS
701501-06	URBAN LANE CLOSURE, 2L 2W, UNDIVIDED
701801-05	LANE CLOSURE MULTILANE 1W OR 2W CROSSWALK OR SIDEWALK CLOSURE
701901-02	TRAFFIC CONTROL DEVICES
720011-01	METAL POST FOR SIGNS, MARKERS & DELINEATORS
728001-01	TELESCOPING STEEL SIGN SUPPORT
729001-01	APPLICATIONS OF TYPES A & B METAL POSTS (FOR SIGNS & MARKERS)
780001-03	TYPICAL PAVEMENT MARKINGS
BLR 21-9	TYPICAL APPLICATIONS OF TRAFFIC CONTROL DEVICES FOR CONSTRUCTION ON RURAL LOCAL HIGHWAYS
BLR 22-7	TYPICAL APPLICATION OF TRAFFIC CONTROL DEVICES FOR CONSTRUCTION ON RURAL LOCAL HIGHWAYS

CITY OF ROCKFORD

PLANS FOR PROPOSED FEDERAL AID HIGHWAY

**MUNICIPAL STREET 3634
 REED AVENUE
 OVER THE SOUTHEAST DRAINAGEWAY
 SECTION 09-00558-00-BR
 CULVERT REHABILITATION
 PROJECT NO. BHM-5099 (082)
 EXIST. S.N. 101-6083
 WINNEBAGO COUNTY
 C-92-098-09**



LOCATION OF SECTION INDICATED THUS:

STRUCTURE INFORMATION:

EXISTING SN: 101-6083;
 THE EXISTING STRUCTURE BUILT IN 1967 CONSISTS OF A THREE CELL 10'x6' REINFORCED CONCRETE BOX CULVERT WITH AN OUT-TO-OUT OF HEADWALL WIDTH OF 44'-8 3/4" AND A TOTAL LENGTH OF 33'-7 1/4" ALONG THE CENTERLINE OF THE ROADWAY. THE STRUCTURE HAS A 12° 57' AHEAD LEFT SKEW. TOP SLAB TO BE REMOVED AS SHOWN.

PROPOSED WORK INCLUDES PLACING A NEW REINFORCED CONCRETE TOP SLAB AS SHOWN.

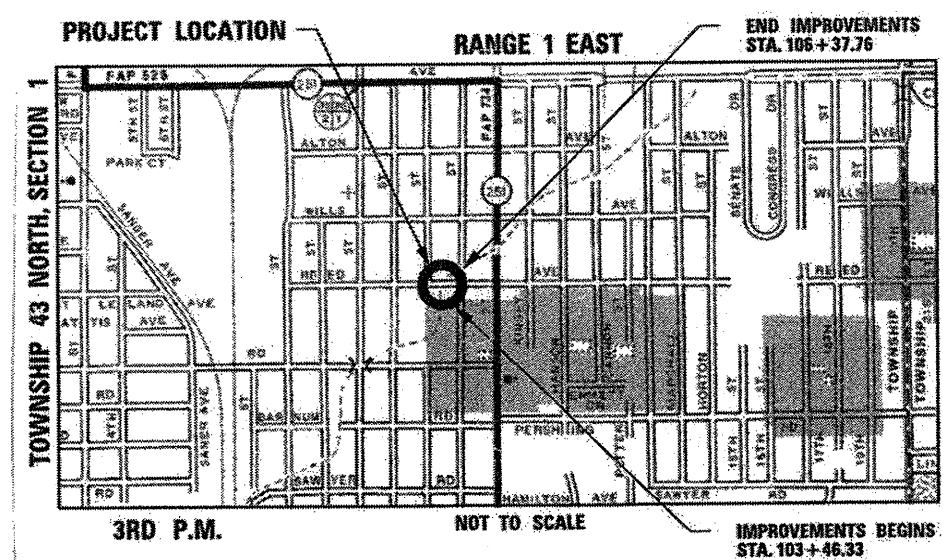

FUNCTIONAL CLASSIFICATION
 LOCAL ROAD (URBAN)

DESIGN SPEED
 REED AVENUE: 25 MPH

SPEED LIMIT
 REED AVENUE: 25 MPH

TRAFFIC DATA:
 REED AVENUE:
 ADT=622 (2012)
 ADT=731 (2032)
 1% TRUCKS

PRINTED BY THE AUTHORITY OF THE STATE OF ILLINOIS

CITY OF ROCKFORD

APPROVED: 3/26/2012 (DATE)
 CITY OF ROCKFORD, CITY ENGINEER

PASSED: APR 10 2012 (DATE)
 DISTRICT 2 ENGINEER OF LOCAL ROADS & STREETS

RELEASING FOR BID BASED ON LIMITED REVIEW: APR 19 2012 (DATE)
 DEPUTY DIRECTOR OF HIGHWAYS, REGION 2 ENGINEER

FEDERAL AID DESIGN ENGINEER: LAURA CONNOLLY (815) 284-2271

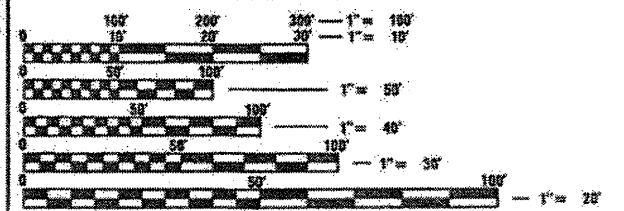

FULL SIZE PLANS HAVE BEEN PREPARED USING STANDARD ENGINEERING SCALES. REDUCED SIZED PLANS WILL NOT CONFORM TO STANDARD SCALES. IN MAKING MEASUREMENTS ON REDUCED PLANS, THE ABOVE SCALES MAY BE USED.

1330 E. STATE STREET, SUITE 4 | ROCKFORD, ILLINOIS 61104
 Phone: 815.998.7998 | Toll Free: 800.728.7805 | Fax: 815.998.9256 | HRGreen.com
 ILLINOIS PROFESSIONAL DESIGN FIRM #184-001322

PROJECT ENGINEER: KEVIN M. ARFT, P.E.
PROJECT MANAGER: ROBERT G. DAVIES, S.E., P.E.
CONTRACT NO. 85562

Call Before You Dig

Simply Call 811

ROCKFORD TOWNSHIP

GROSS LENGTH OF IMPROVEMENT = 291.43 FT. = 0.055 MILES
 NET LENGTH OF IMPROVEMENT = 291.43 FT. = 0.055 MILES

STRUCTURAL ENGINEER'S SIGN & SEAL

ROBERT G. DAVIES, S.E., P.E.

03/26/2012
 DATE

11/30/2012
 EXPIRES

PROFESSIONAL ENGINEER'S SIGN & SEAL

KEVIN M. ARFT, P.E.

03/26/2012
 DATE

11/30/2013
 EXPIRES