

**GENERAL NOTES:**

1. Reinforcement bars shall conform to the requirements of ASTM A 706 Gr 60. See Special Provisions.
2. Reinforcement bars designated (E) shall be epoxy coated.
3. Plan dimensions and details relative to existing structure are subject to nominal construction variations. The Contractor shall field verify existing dimensions and details affecting new construction and make necessary approved adjustments prior to construction or ordering of materials. Such variations shall not be cause for additional compensation for a change in scope of the work, however, the Contractor will be paid for the quantity actually furnished at the unit price bid for the work.
4. Plans for existing structure are not available.

**TOTAL BILL OF MATERIAL**

ITEM	UNIT	QUANTITY	TOTAL
Concrete Removal	Cu. Yd.	42.3	42.3
Structure Excavation	Cu. Yd.	29.8	29.8
Protective Coat	Sq. Yd.	45	45
Reinforcement Bars	Pound	12,780	12,780
Reinforcement Bars, Epoxy Coated	Pound	1,580	1,580
Parapet Railing	Foot	79	79
Name Plates	Each	1	1
Concrete Box Culverts	Cu. Yd.	56.9	56.9
Porous Granular Embankment, Special	Cu. Yd.	50.0	50.0
Structural Repair of Concrete (Depth Less than or Equal to 5")	Sq. Ft.	55	55

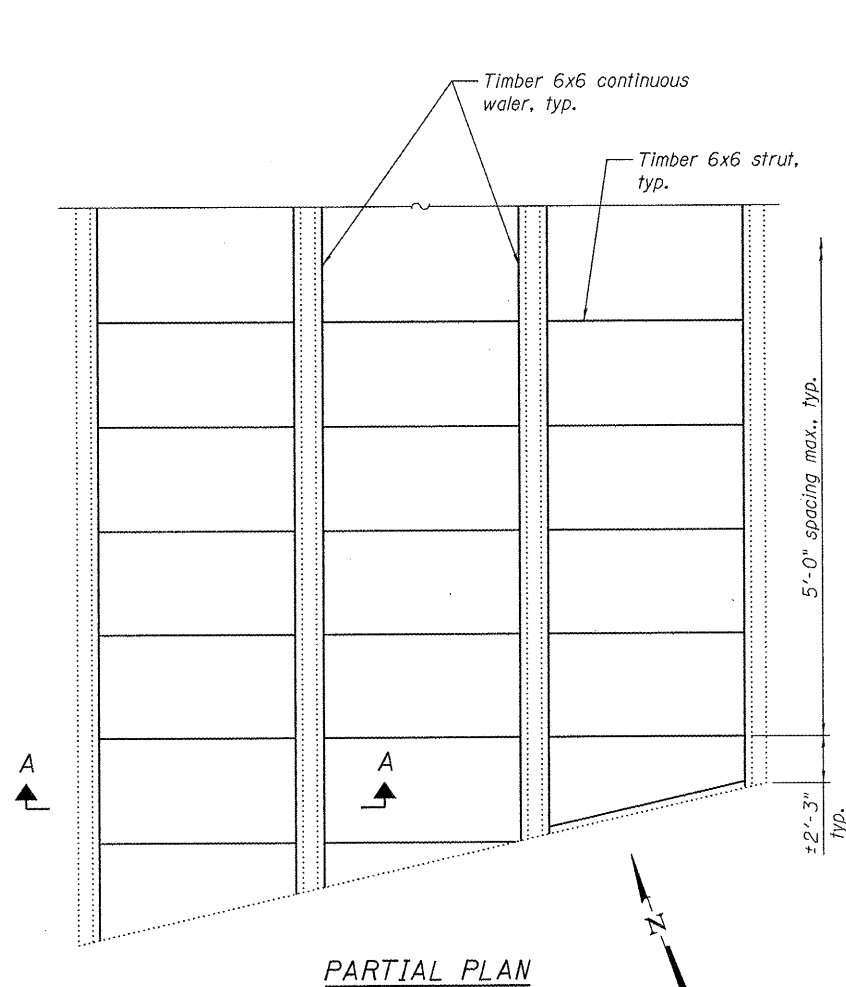

**PARTIAL PLAN**

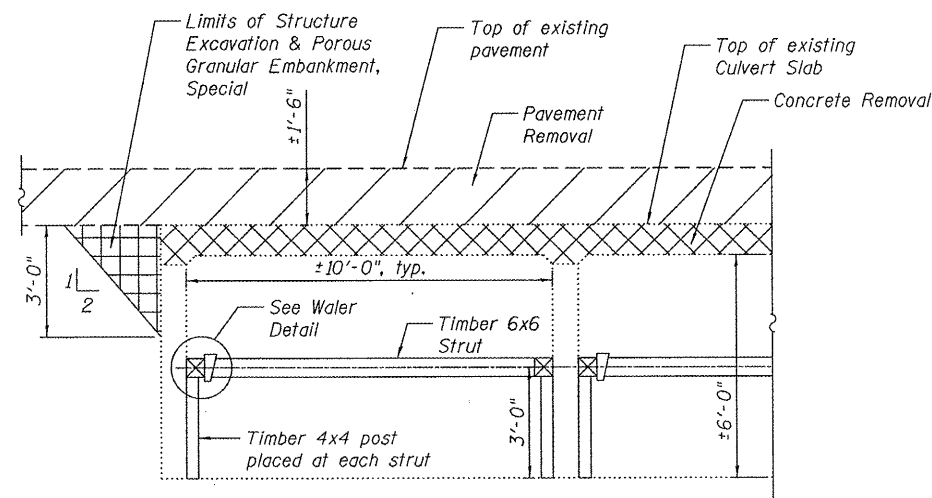

**SECTION A-A**

Horizontal dimensions at rt. L's to  $\varnothing$  culvert

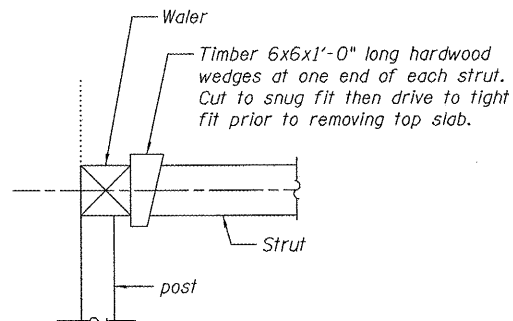

**WALER DETAIL**

**TEMPORARY CULVERT WALL BRACING DETAILS**

**TEMPORARY CULVERT BRACING SPECIFICATIONS**

Excavate behind culvert side wall as shown prior to removing top slab and prior to placing temporary bracing. Place bracing assembly after excavation and prior to removing culvert top slab.

The temporary bracing shown is a suggested minimum for bidding purposes. It does not accommodate for surcharge loading due to placement of construction equipment. The Contractor is responsible for maintaining and protecting the portions of the culvert to remain. Alternate bracing methods may be proposed to the Engineer provided the alternative bracing design submittal is sealed by an IL Licensed Structural Engineer.

The Contractor is made aware of existing utilities near the existing culvert.

The temporary bracing shall not be removed until the proposed culvert top slab has cured in accordance with the applicable portions of Section 503 of the Standard Specifications.

Timber members shall be southern pine or douglas fir.

Furnishing, installing and removing the temporary bracing will not be paid for separately, but will be included in the unit price bid for "Concrete Box Culverts."

COMPANY NAME: Kevin M. Arff  
 PROJECT CONTACT: City of Rockford  
 CLIENT: Rockford, IL  
 FILE NAME: 09-00558-00-01  
 PLOT DRIVER: plotport  
 PEN TABLE: standard-trans.tbl



USER NAME =	DESIGNED - KMA	REVISED -
	CHECKED - RGD	REVISED -
PLOT SCALE =	DRAWN - WJH	REVISED -
PLOT DATE = 4/3/2012	CHECKED - 4/3/12	REVISED -

**CITY OF ROCKFORD**

**GENERAL NOTES AND TOTAL BILL OF MATERIALS  
 REED AVENUE OVER THE SOUTHEAST DRAINAGEWAY**

M.S.	SECTION	COUNTY	TOTAL SHEETS	SHEET NO.
3634	09-00558-00-BR	WINNEBAGO	16	9
			CONTRACT NO. 85562	
ILLINOIS FED. AID PROJECT				

SHEET NO. S-2 OF S-5 SHEETS