

SEE SHEET 24
CAREER CENTER ROAD

ST. PAUL'S LUTHERAN SCHOOL

CAREER CENTER ROAD
SEE SHEET 24

BOURBONNAIS ELEMENTARY SCHOOL

MEADOWBROOK SUBDIVISION

ST. PAUL'S LUTHERAN SCHOOL

BOURBONNAIS ELEMENTARY SCHOOL SITE

EAGLE CREEK SUBDIVISION

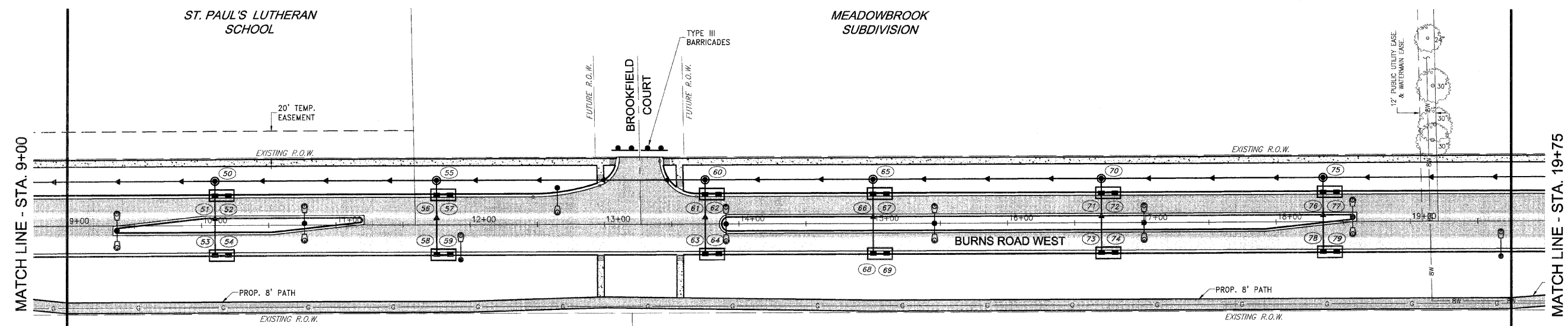
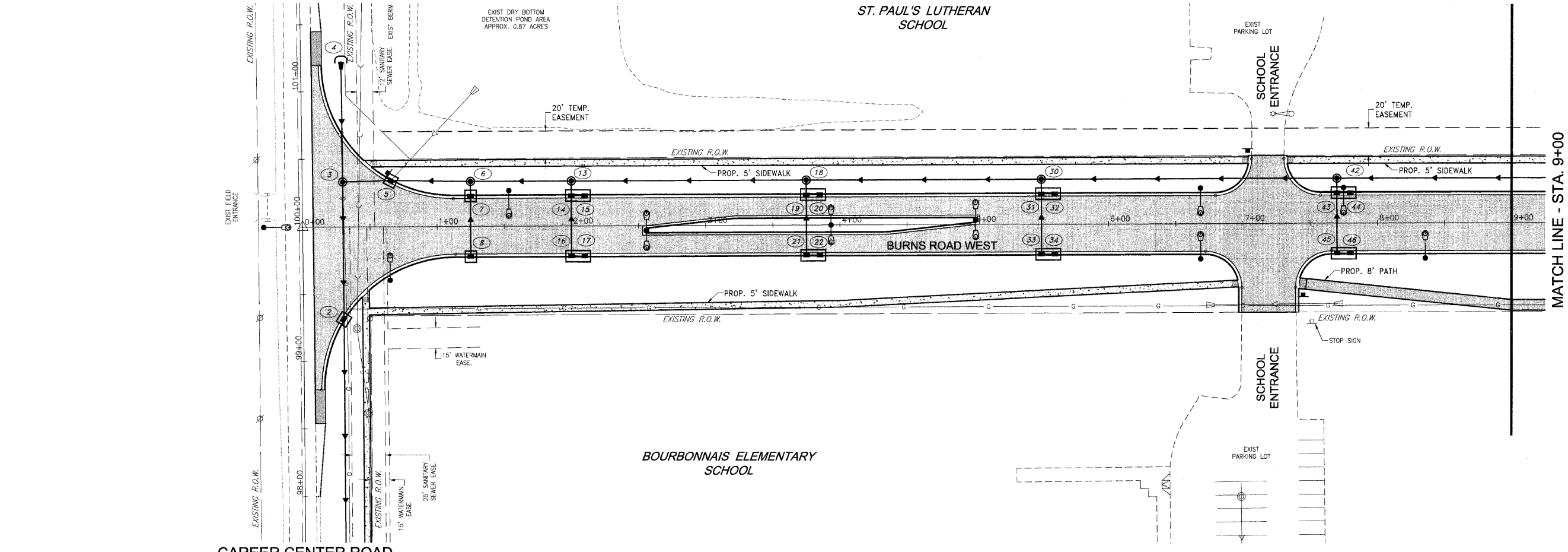

STORM WATER POLLUTION PREVENTION PLAN LEGEND

- NEW CURB INLET
- NEW MANHOLE
- ▼ NEW FLARED END SECTION
- INLET PROTECTION
- ⌋ PIPE PROTECTION
- S— SILT FENCE WITH WIRE SUPPORT

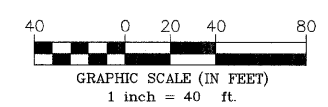

FAU. PTE.	SECTION	COUNTY	TOTAL SHEETS	SHEET NO.
*	**	KANKAKEE	36	25

CONTRACT NO. 87315
FED. ROAD DIST. NO. ILLINOIS
FED. AID PROJECT

* BURNS ROAD WEST - FAU 6212
** 03-00058-01-FP

TYSON ENGINEERING, INC.
CONSULTING CIVIL ENGINEERS
LAND SURVEYORS
DESIGN FIRM LICENSE #184-001136
367 SOUTH SCHUYLER AVENUE
KANKAKEE, ILLINOIS 60901
PHONE (815) 932-7406

This document and the ideas and designs incorporated herein, as an instrument of professional service, is the property of Tyson Engineering Inc. and is not to be used in whole or in part, for any other project without written authorization of Tyson Engineering Inc.
Do not scale drawings. Use dimensions only.
Contractor shall be responsible for verifying all dimensions.
Information hereon and herein is confidential.

REVISIONS			
NO.	DATE	BY	DESCRIPTION

PROJECT:
STORM WATER POLLUTION PREVENTION PLAN

PROPOSED IMPROVEMENTS FOR
BURNS ROAD WEST
FROM CAREER CENTER ROAD
TO BURNING BUSH DRIVE

SECTION
03-00058-01-FP

DATE: 3/23/12	JOB NO. E05055
SCALE: HORIZ.: 1"=40'	FILE NO.
VERT.: N/A	
DRAWN BY: MRG	SHEET
CHECKED BY: SRM	25
	36