

INDEX OF SHEETS:

1. TITLE SHEET
2. QUANTITY SHEET
3. PLAN AND PROFILE STA. 1+57 - 7+00
4. PLAN AND PROFILE STA. 7+00 - 13+00
5. PLAN AND PROFILE STA. 13+00 - 15+69

**STATE OF ILLINOIS
DEPARTMENT OF TRANSPORTATION
DIVISION OF HIGHWAYS
SURFACE TRANSPORTATION URBAN FUNDS
FAU 5503 - WASHINGTON STREET**

**CITY OF GENOA
PROJECT NO. M-5094(003)
SECTION NO. 10-00034-01-RS
JOB NO. C-93-034-12**

ROUTE NO.	SECTION	COUNTY	TOTAL SHEETS	SHEET NO.
FAU 5503	10-00034-01-RS	DeKalb	5	1

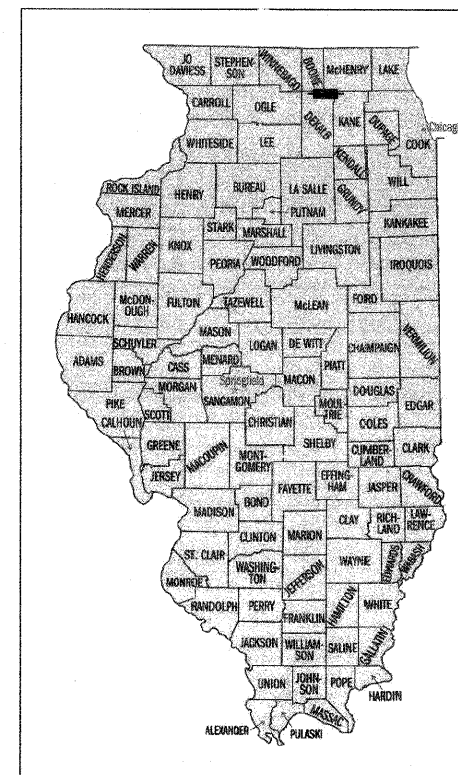

LOCATION OF SECTION, INDICATED THUS:

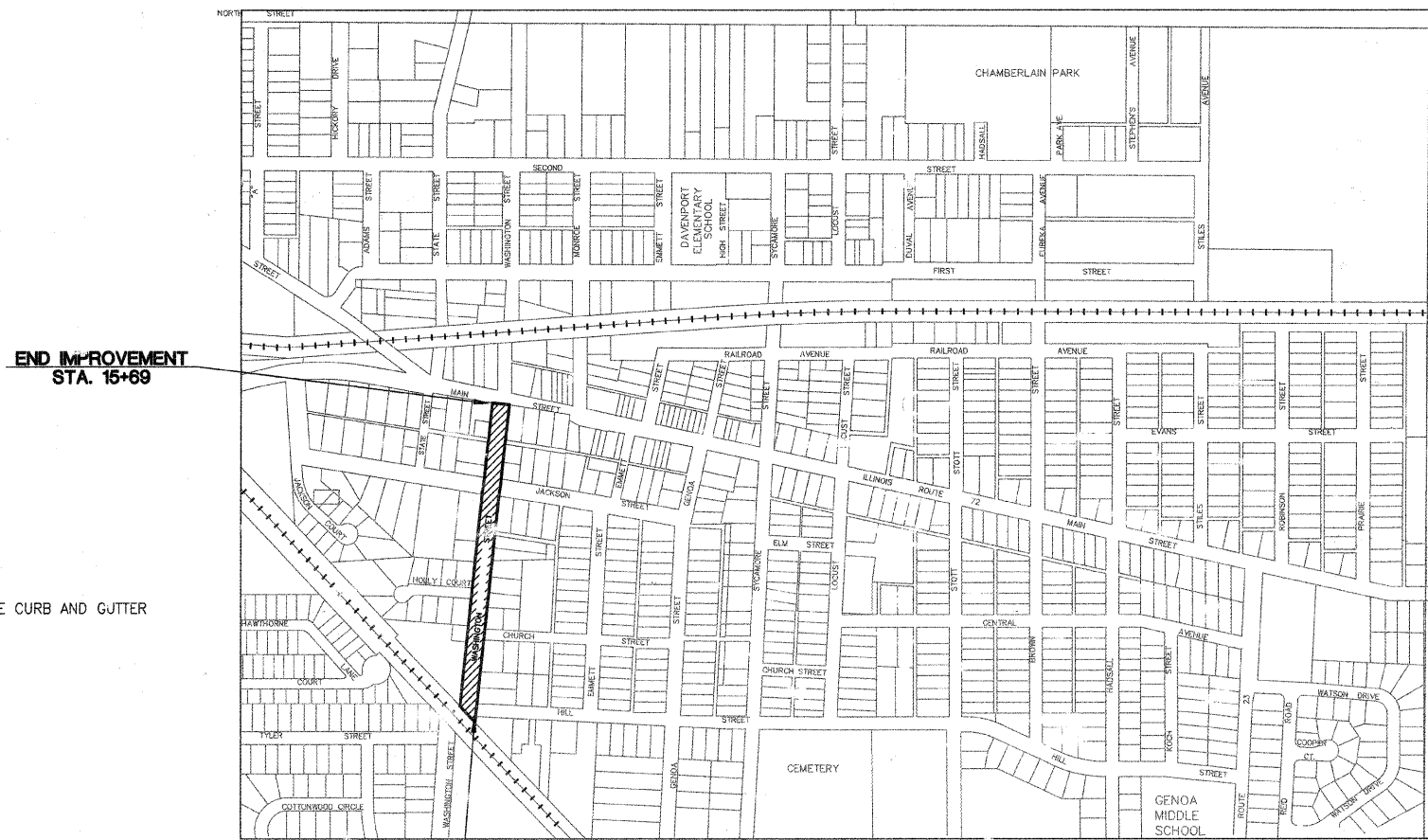

END IMPROVEMENT
STA. 15+69

BEGIN IMPROVEMENT
STA. 1+57

CITY OF GENOA
LOCATION MAP
NOT TO SCALE

LENGTH OF PROJECT = 1412 FEET = .267 MILE

TRAFFIC DATA:
CLASS III
AVERAGE DAILY TRAFFIC (ADT) DATA: 2012 (2032)
WASHINGTON STREET 850 TO 1200
POSTED SPEED LIMIT: 25 MPH



11/13 4/10/12
LIC. EXP. DATE DATE
SIGNATURE

- LIST OF HIGHWAY STANDARDS:**
- 000001-06 STANDARD SYMBOLS AND ABBREVIATIONS
 - 424001-06 PERPENDICULAR CURB RAMPS FOR SIDEWALKS
 - 606001-04 CONCRETE CURB TYPE B AND COMBINATION CONCRETE CURB AND GUTTER
 - 701501-06 URBAN LANE CLOSURE
 - 701801-06 SIDEWALK, CORNER OR CROSSWALK CLOSURE
 - 701901-02 TRAFFIC CONTROL DEVICES
 - 720001-01 SIGN PANEL MOUNTING DETAILS

DESIGN POLICY: THIS IMPROVEMENT WAS DESIGNED IN ACCORDANCE WITH THE RECONSTRUCTION POLICY IN THE BUREAU OF LOCAL ROADS AND STREETS MANUAL.

**STATE OF ILLINOIS
DEPARTMENT OF TRANSPORTATION
DIVISION OF HIGHWAYS**

SUBMITTED April 10 20 12
John A. ...
MAYOR OF GENOA

APPROVED April 11, 20 12
J. ...
DISTRICT THREE IMPLEMENTATION ENGINEER

RELEASED FOR BID April 11, 20 12
BASED ON LIMITED REVIEW
...
DEPUTY DIRECTOR OF HIGHWAYS, REGION 2 ENGINEER

CONTRACT NO. 87512

 1814 GRANDSTAND PLACE ELGIN, ILLINOIS 60123 phone 847.697.7095 fax 847.697.7099 scfloweng.com Firm License No. 184-00104	PRINTED BY THE AUTHORITY OF THE STATE OF ILLINOIS	GENOA FAU 5503 - WASHINGTON STREET CONTRACT NO. 87512 TITLE SHEET	SCALE NONE DATE 3/1/12 DRAWN BY P.C.S. JOB NO. 4721 CHECKED BY F.C.C. SHEET NO. 1 of 5
	#1 D/P/E REMARKS 11-23-12 PER DOT REVIEW 2-4-10-12 PER IDOT REVIEW	10-00034-01-RS ILLINOIS 11-23-12 PER DOT REVIEW 2-4-10-12 PER IDOT REVIEW	

PAVEMENT DESIGN WASHINGTON STREET

POSTED SPEED = 25 MPH
DESIGN SPEED = 25 MPH

TWO LANE FACILITY CLASS III

ITEM	AC TYPE	VOIDS
HOT MIX ASPHALT SURFACE COURSE, MIXTURE C N50	PG 58-28	4% @ 50 GYRATION
HOT MIX ASPHALT BINDER COURSE, IL 19.0 N50	PG 58-28	4% @ 50 GYRATION

DESIGN PERIOD 20 YEARS
DESIGN YEAR 2032
E_m = 3 ksi

**STATION 1+57 - 5+12
(HILL STREET TO CHURCH STREET)**

DESIGN ADT = 850
PV = 88% = 748
SU = 7% = 60
MU = 5% = 42

$$T.F. = DP \left[\frac{(0.073*(PV) + 54.570*(SU) + 192.175*(MU))}{1,000,000} \right]$$

T.F. = 0.22

CONVENTIONAL FLEXIBLE PAVEMENT DESIGN

PG BINDER GRADE SELECTION: PG 64-22

HMA MIXTURE TEMPERATURE: 72°

HMA DESIGN STRAIN: 225

E_{ac}: 650 ksi

HMA Thickness = 5.25 in

BITUMINOUS SURFACE COURSE = 1.5"
BITUMINOUS BINDER COURSE = 3.75"
AGGREGATE BASE COURSE, TY-A = 8.0"

**STATION 5+12 - 12+00
(CHURCH STREET TO JACKSON STREET)**

DESIGN ADT = 1050
PV = 88% = 924
SU = 7% = 74
MU = 5% = 52

$$T.F. = DP \left[\frac{(0.073*(PV) + 54.570*(SU) + 192.175*(MU))}{1,000,000} \right]$$

T.F. = 0.28

FULL-DEPTH HMA PAVEMENT DESIGN

SUBGRADE SUPPORT RATING: POOR

PG BINDER GRADE SELECTION: PG 64-22

HMA MIXTURE TEMPERATURE: 77°

HMA DESIGN STRAIN: 215

E_{ac}: 530 ksi

HMA Thickness = 6.50 in

BITUMINOUS SURFACE COURSE = 1.5"
BITUMINOUS BINDER COURSE = 5"
AGGREGATE BASE COURSE, TY-B = 12.0"

**STATION 12+00 - 16+59
(JACKSON STREET TO MAIN STREET)**

DESIGN ADT = 1200
PV = 88% = 1056
SU = 7% = 84
MU = 5% = 60

$$T.F. = DP \left[\frac{(0.073*(PV) + 54.570*(SU) + 192.175*(MU))}{1,000,000} \right]$$

T.F. = 0.32

FULL-DEPTH HMA PAVEMENT DESIGN

SUBGRADE SUPPORT RATING: FAIR

PG BINDER GRADE SELECTION: PG 64-22

HMA MIXTURE TEMPERATURE: 77°

HMA DESIGN STRAIN: 200

E_{ac}: 530 ksi

HMA Thickness = 6.50 in

BITUMINOUS SURFACE COURSE = 1.5"
BITUMINOUS BINDER COURSE = 5"
AGGREGATE BASE COURSE, TY-B = 12.0"

	HMA BINDER	HMA SURFACE
PG GRADE	PG 64-22	PG 64-22
DESIGN AIR VOIDS	4.0% @ N50	4.0% @ N50
MIXTURE COMPOSITION	IL 19.0	IL 9.5
FRICITION AGGREGATE		MIXTURE C
DENSITY TEST METHOD	CORES	CORES

LEGEND:

	EXISTING SANITARY MANHOLE		EXISTING DRIVEWAY
	EXISTING VALVE VAULT		PROPOSED ROADWAY PAVEMENT
	EXISTING HYDRANT		PROPOSED AGGREGATE SHOULDER
	EXISTING STORM MANHOLE AND STORM SEWER		PROPOSED EDGE OF PAVEMENT
	EXISTING CATCH BASIN		PROPOSED PARKING LOT AREA PAVEMENT
	EXISTING CURB AND GUTTER		
	EXISTING EDGE OF PAVEMENT		
	EXISTING SIDEWALK		
	EXISTING GRAVEL		

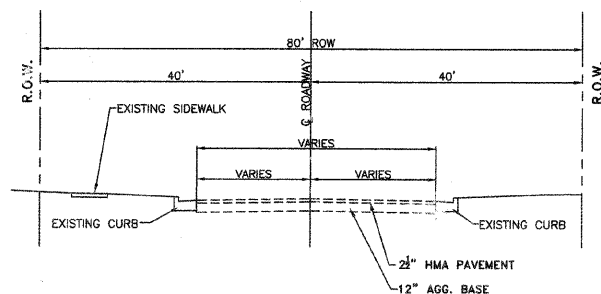

**EXISTING TYPICAL SECTION
STA. 1+57 TO 5+12**

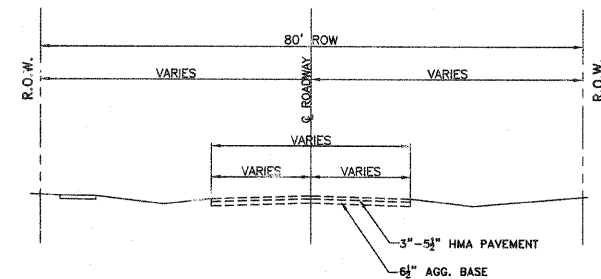

**EXISTING TYPICAL SECTION
STA. 5+12 TO 16+59**

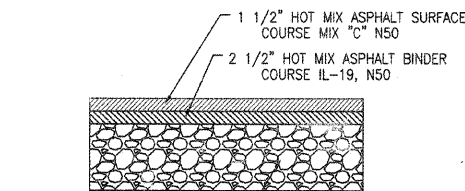

PARKING AREA SECTION

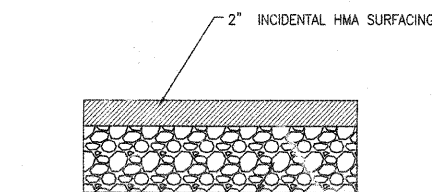

DRIVEWAY SECTION

General Notes:

These Special Conditions supplement the plans and specifications. Where they are in conflict with the plans and specifications they shall govern.

1. REFERENCED SPECIFICATIONS

- THE FOLLOWING SPECIFICATIONS ARE INCLUDED BY REFERENCE.
- ALL CONSTRUCTION SHALL BE IN ACCORDANCE WITH THE APPLICABLE SECTIONS EXCEPT AS MODIFIED HEREIN OR ON THE PLANS OR IN THE SPECIFICATIONS BOUND SEPARATELY:
- ILLINOIS DEPARTMENT OF TRANSPORTATION STANDARD SPECIFICATIONS FOR ROAD AND BRIDGE CONSTRUCTION, LATEST EDITION.
- CITY OF GENOA MUNICIPAL CODE.
- ILLINOIS DEPARTMENT OF TRANSPORTATION MANUAL OF UNIFORM TRAFFIC CONTROL DEVICES.
- ILLINOIS URBAN MANUAL STANDARDS FOR URBAN SOIL EROSION AND SEDIMENTATION CONTROL.

2. NOTIFICATION

- IT SHALL BE THE CONTRACTOR'S RESPONSIBILITY TO NOTIFY THE FOLLOWING:
- IDOT DISTRICT 3, 48 HOURS PRIOR TO COMMENCEMENT OF CONSTRUCTION.
- THE CITY OF GENOA 48 HOURS PRIOR TO COMMENCEMENT OF CONSTRUCTION.
- THE ELECTRIC, TELEPHONE AND GAS UTILITIES PRIOR TO COMMENCEMENT OF CONSTRUCTION.

3. PERMITS

- NO CITY OF GENOA PERMITS ARE REQUIRED.

4. QUANTITIES

- THE CONTRACTOR IS RESPONSIBLE FOR VERIFYING ALL QUANTITIES AS INDICATED ON THE PLANS. THE QUANTITIES WHICH ARE INDICATED ARE FOR BIDDING PURPOSES ONLY AND MUST BE VERIFIED. ANY DISCREPANCIES ARE TO BE REPORTED TO THE ENGINEER.

5. EXAMINATION OF THE SITE

- THE CONTRACTOR IS RESPONSIBLE FOR EXAMINING ALL SITE CONDITIONS PRIOR TO COMMENCEMENT OF CONSTRUCTION AND IS TO COMPARE THE SITE CONDITIONS AS INDICATED ON THE ENGINEERING PLANS.

6. ENGINEERING PLANS

- THE PROPOSED IMPROVEMENTS MUST BE CONSTRUCTED IN ACCORDANCE WITH THE ENGINEERING PLANS. THE CONSTRUCTION DETAILS, AS PRESENTED ON THE PLANS, MUST BE FOLLOWED BY THE CONTRACTOR. PROPER CONSTRUCTION TECHNIQUES MUST BE FOLLOWED ON THOSE IMPROVEMENTS INDICATED ON THE ENGINEERING PLANS.

7. LOCATION OF EXISTING UNDERGROUND UTILITIES

- THE LOCATION OF VARIOUS EXISTING UNDERGROUND UTILITIES WHICH ARE SHOWN ON THE PLANS ARE FOR INFORMATION ONLY AND REPRESENT THE BEST KNOWLEDGE OF THE ENGINEER. IT SHALL BE THE CONTRACTOR'S RESPONSIBILITY TO VERIFY THEIR LOCATIONS AND ELEVATIONS PRIOR TO THE CONSTRUCTION OPERATIONS.

8. DAMAGE TO PROPERTY

- ANY EXISTING PAVEMENT, SIDEWALK, DRIVEWAYS, ETC. DAMAGED BY THE CONTRACTOR'S OPERATIONS AND NOT CALLED FOR IN THE CONTRACT TO BE REMOVED SHALL BE REPLACED AT THE EXPENSE OF THE CONTRACTOR.

9. CONTRACTOR TO VERIFY ELEVATIONS

- THE CONTRACTOR SHALL VERIFY ALL ELEVATIONS PRIOR TO THE START OF WORK AND, IF THERE ARE ANY DISCREPANCIES, IS TO NOTIFY THE ENGINEER AT ONCE. NO WORK SHALL BE DONE UNTIL THE DISCREPANCY IS RESOLVED.

ROUTE NO.	SECTION	COUNTY	TOTAL SHEETS	SHEET NO.
FAU 5503	10-00034-01-RS	DeKalb	5	2

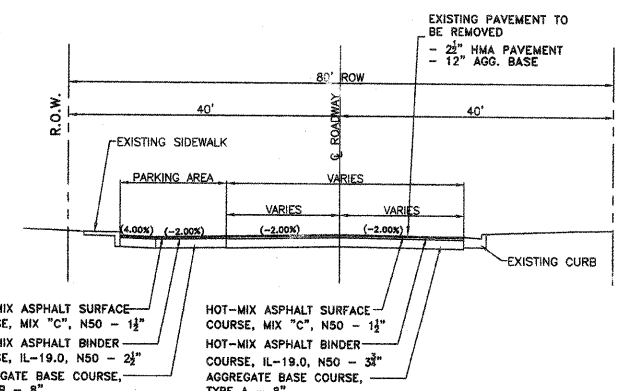

**PROPOSED TYPICAL SECTION #1
HILL STREET TO CHURCH STREET
STA. 1+57 TO 5+12**

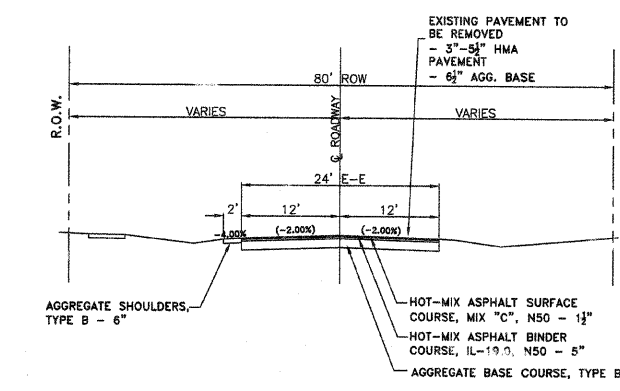

**PROPOSED TYPICAL SECTION #2
CHURCH STREET TO MAIN STREET
STA. 5+12 TO 16+59**

NOTE:
ALL SIDE ROAD WORK TO BE COMPLETED USING TYPICAL SECTIONS ABOVE

SUMMARY OF QUANTITIES CONSTRUCTION TYPE CODE: 0004

Item No.	Items	Unit	Quantity
40603310	Hot-Mix Asphalt Surface Course, Mix "C", N50	TON	432
40603080	Hot-Mix Asphalt Binder Course, IL-19, N50	TON	1340
40600100	Bituminous Materials (Prime Coat)	GALLON	1028
35100100	Aggregate Base Course, Type A	TON	623
35101400	Aggregate Base Course, Type B	TON	2510
48101200	Aggregate Shoulder, Type B	TON	127
44000100*	Pavement Removal	SQ YD	5073
20200100*	Earth Excavation	CU YD	1957
44000500	Combination Concrete Curb and Gutter Removal	FOOT	50
60603800	Combination Concrete Curb and Gutter, Type B6.12	FOOT	50
44000600	Sidewalk Removal	SQ FT	442
42400200	Portland Cement Concrete Sidewalk, 5 Inch	SQ FT	442
42400800	Detectable Warnings	SQ FT	112
44000200	Driveway Pavement Removal	SQ YD	113
40800050	Incidental Hot-Mix Asphalt Surfacing	TON	13
Δ 78000200	Thermoplastic Pavement Marking - Line 4"	FOOT	1064
Δ 78000400	Thermoplastic Pavement Marking - Line 6"	FOOT	365
Δ 78000600	Thermoplastic Pavement Marking - Line 12"	FOOT	51
Δ 78000650	Thermoplastic Pavement Marking - Line 24"	FOOT	65
Δ 78000100	Thermoplastic Pavement Marking - Letters and Symbols	SQ FT	5
67100100	Mobilization	L SUM	1
70102620	Traffic Control and Protection, Standard 701501	L SUM	1
70102640	Traffic Control and Protection, Standard 701801	L SUM	1
70103815	Traffic Control Surveillance	CAL DA	30

* SEE SPECIAL PROVISIONS
Δ SPECIALTY ITEMS

DATE	REVISIONS
11-23-12	PER IDOT REVIEW
2-4-10-12	PER IDOT REVIEW

SCHEFLOW engineers
1814 GRANDSTAND PLACE
ELGIN, ILLINOIS 60123
phone 847.697.7095
fax 847.697.7099
schefloweng.com
Firm License No. 184-001104

GENOA 10-00034-01-RS ILLINOIS
FAU 5503 - WASHINGTON STREET
CONTRACT NO. 87512
QUANTITY SHEET

SCALE	DATE
NONE	3/1/12
DRAWN BY	JOB NO.
P.C.S.	4721
CHECKED BY	SHEET NO.
F.C.C.	2 of 5

SOIL BORING LOG NUMBER	HMA - SURFACE	HMA - BINDER	CRUSHED GRAVEL	TOTAL DEPTH
B-5	0-3/4"	1-3/4"	9-1/2" WITH FINES	12-0"
B-6	1-0"	1-1/2"	13-1/2" WITH FINES	16-0"

ROUTE NO.	SECTION	COUNTY	TOTAL SHEETS	SHEET NO.
FAU 5503	10-00034-01-RS	DeKalb	5	3

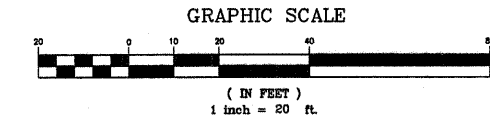
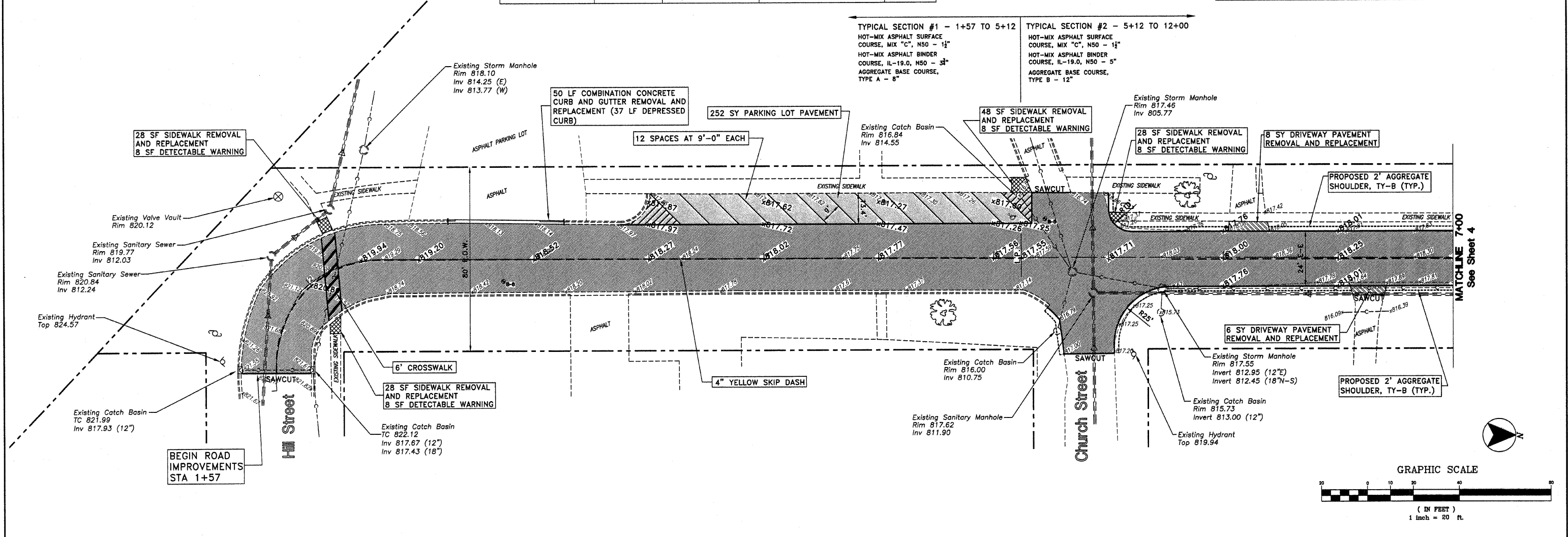

WASHINGTON STREET

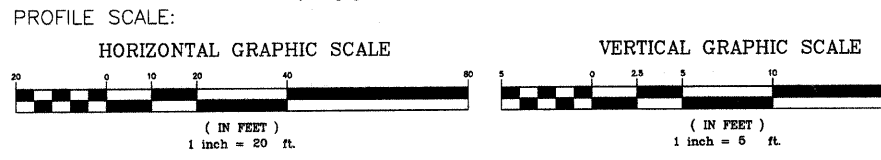
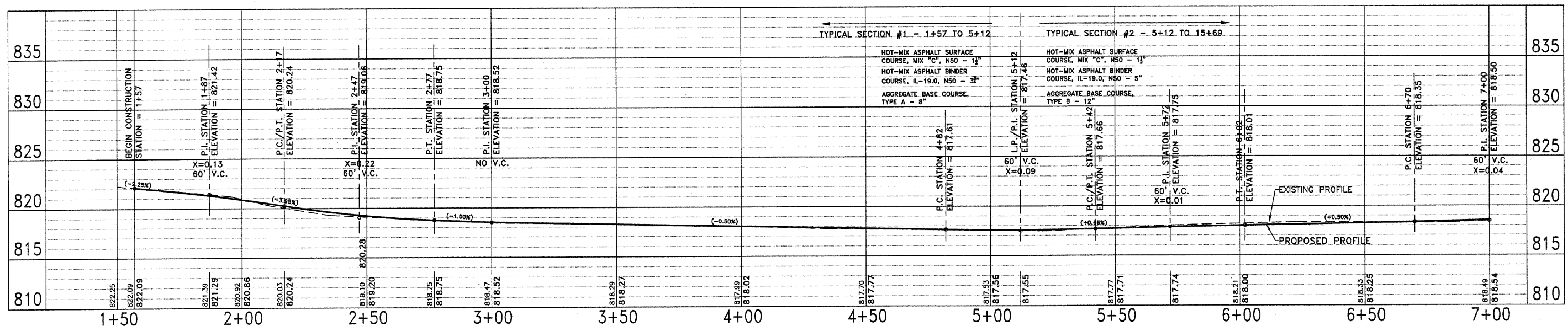

DATE	REMARKS	 1814 GRANDSTAND PLACE ELGIN, ILLINOIS 60123 phone 847.697.7095 fax 847.697.7099 schefloweng.com Firm License No. 184-001104	GENOA FAU 5503 - WASHINGTON STREET CONTRACT NO. 87512 STA. 1+57 - 7+00	SCALE	DATE
11-23-12	PER DOT REVIEW			1"=20'	3/1/12
2-4-10-12	PER DOT REVIEW				
				DRAWN BY	JOB NO.
				P.C.S.	4721
				CHECKED BY	SHEET NO.
				F.C.C.	3 of 5

ROUTE NO.	SECTION	COUNTY	TOTAL SHEETS	SHEET NO.
FAU 5503	10-00034-01-RS	DeKalb	5	4

SOIL BORING LOG NUMBER	HMA - SURFACE	HMA - SURFACE	CRUSHED AND UNCRUSHED GRAVEL	TOTAL DEPTH
B-3	2-0"	2-1/2"	6-0" WITH FINES	10-1/2"
B-4	2-0"	1-0"	6-1/2" WITH FINES	9-1/2"

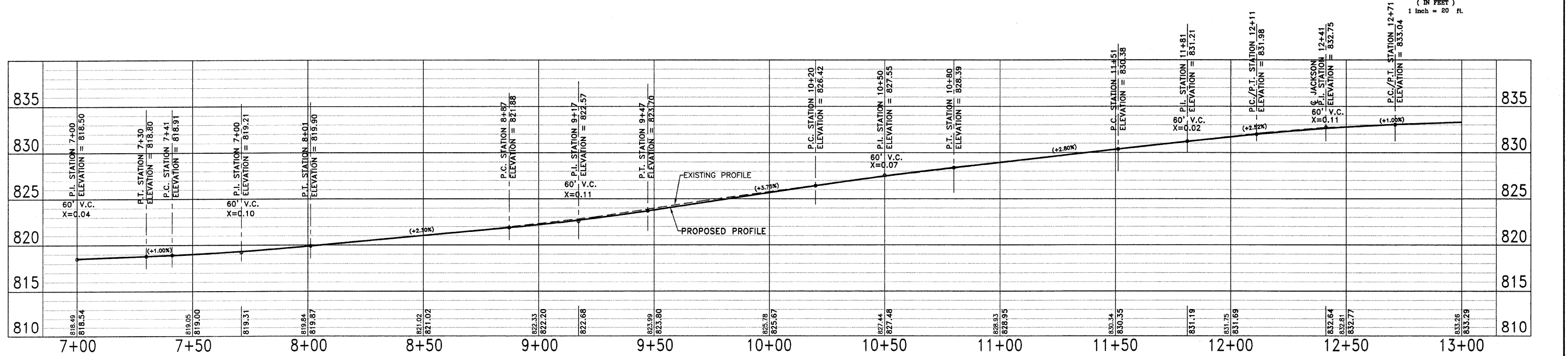
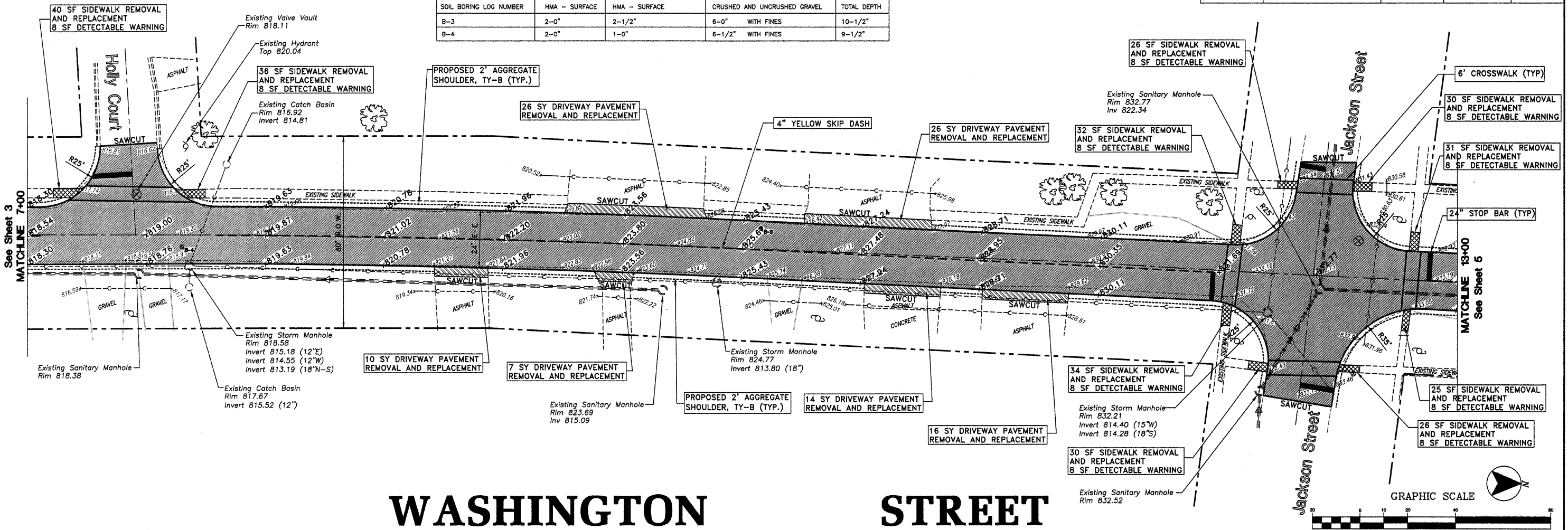

SCHEFLOW engineers 1814 GRANDSTAND PLACE ELGIN, ILLINOIS 60123 phone 847.697.7095 fax 847.697.7099 scheffloweng.com Firm License No. 184-001104	GENOA 10-00034-01-RS FAU 5503 - WASHINGTON STREET CONTRACT NO. 87512 STA. 7+00 -13+00	ILLINOIS SCALE 1"=20' DATE 3/1/12 DRAWN BY P.C.S. JOB NO. 4721 CHECKED BY F.C.C. SHEET NO. 4 of 5
	# DATE REMARKS 1 3-23-12 PER IDOT REVIEW 2 4-10-12 PER IDOT REVIEW	

