

CHAMLIN & ASSOCIATES, INC. © 2010  
 Drawing Name: G:\Users\G.A.Usery\OneDrive\Projects\113-Diamond-Will-Road-IL-113-Envr-Survey\CAD\C3D\PLANS-EXTENDED\028-TRAFFIC-CONTROL-DETAILS.dwg, Last Modified: Mar 27, 2012 - 3:12pm Plotted on: Mar 28, 2012 - 8:36am by nancq

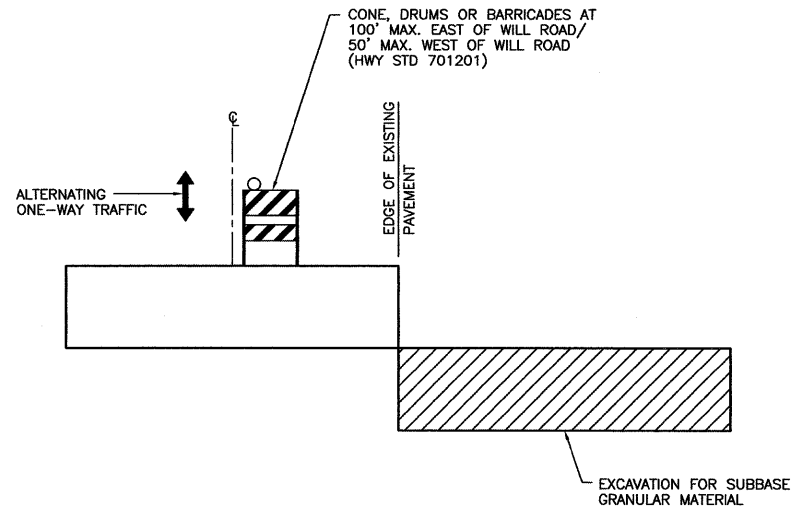

**STAGE CONSTRUCTION WIDENING DETAIL - IL 113**

TRAFFIC CONTROL SHALL BE IN ACCORDANCE WITH HIGHWAY STANDARD 701201 DURING WORK TO EXCAVATE FOR SUB-BASE GRANULAR MATERIAL. THE FIRST 4" OF SUB-BASE GRANULAR MATERIAL SHALL BE PLACED PRIOR TO OPENING THE ADJACENT LANE. THEN TRAFFIC CONTROL SHALL BE IN ACCORDANCE WITH HIGHWAY STANDARD 701326, EXCEPT THAT MAXIMUM DRUM OR BARRICADE SPACING SHALL BE 50' WEST OF WILL ROAD.

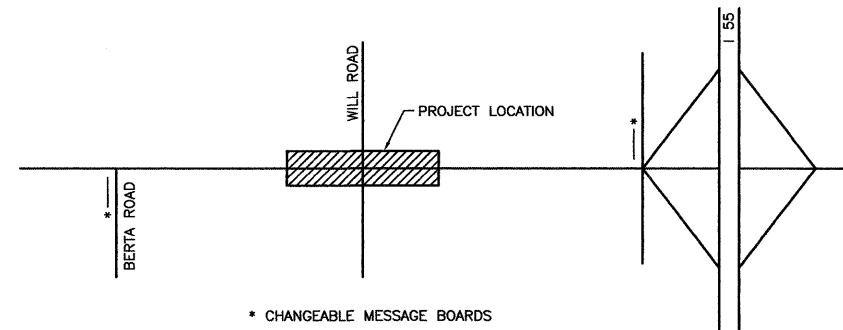

**PUBLIC INFORMATION PLAN**

- 1) CHANGEABLE MESSAGE BOARDS SHALL BE IN PLACE FOR TWO WEEKS PRIOR TO START OF CONSTRUCTION.
- 2) THE CONTRACTOR SHALL NOTIFY EMERGENCY SERVICES (POLICE, FIRE & AMBULANCE) IN WRITING 2 WEEKS PRIOR TO BEGINNING WORK AND SHALL GIVE 24 HOUR NOTICE OF SIDE STREET CLOSURES/CHANGES.

DRAWN BY: NV	REVISIONS			
	LEVEL	BY	DATE	DESCRIPTION
CHECKED BY: JKC				
DATE: 02/12				

**CHAMLIN & ASSOCIATES**  
 PERU MORRIS ILLINOIS

FAS 301 / FAU 383  
 SECTION 11-00007-00-WR  
 VILLAGE OF DIAMOND  
 GRUNDY AND WILL COUNTIES

STAGE CONSTRUCTION AND TRAFFIC CONTROL PLANS

**CONSTRUCTION PLANS**

CONTRACT NO. 87520	
CURRENT AS OF: 02/12	
SCALE: AS NOTED	SHEET 29
FILE NO.: 66022.01 Y-	OF 96