

LAND SECTION MARKERS

NOTES

THE REFERENCE MARKERS SHALL BE CONSTRUCTED BY POURING CLASS SI CONCRETE INTO HOLES PREPARED BY A POST HOLE DIGGER OR OTHER APPROVED METHODS. FORMS WILL NOT BE REQUIRED. PRECAST MARKERS OF THE SAME SIZE AND CONSTRUCTION MAY BE USED.

IN CULTIVATED FIELDS REFERENCE MARKERS SHALL BE PLACED TWO FEET BELOW THE GROUND SURFACE. IN FENCE LINES OR PROTECTED AREAS THE TOP SHALL BE PLACED AT GROUND LEVEL.

THE FOLLOWING WORK SHALL BE DONE UNDER THE DIRECTION OF A REGISTERED LAND SURVEYOR OF THE STATE OF ILLINOIS:

VERIFY AND TIE OFF ALL U.S. PUBLIC LAND SURVEY MONUMENTS, SHOWN IN THE PLANS, PRIOR TO CONSTRUCTION OPERATIONS. TIE POINTS SHALL BE SUFFICIENT IN NUMBER AND IN LOCATIONS AS NOT TO BE DISTURBED DURING CONSTRUCTION OPERATIONS.

AFTER CONSTRUCTION OPERATIONS ARE COMPLETE, INSTALL A PERMANENT SURVEY MARKER OF THE TYPE SPECIFIED TO REPLACE THE U.S. PUBLIC LAND SURVEY MONUMENT THAT WAS DISPLACED OR COVERED DURING CONSTRUCTION. THE LETTERING REFERRING TO THE STATE OF ILLINOIS AND DIVISION OF HIGHWAYS SHALL BE OMITTED FROM THE PERMANENT SURVEY MARKER AND THE MARKER SHALL BE MARKED AS DIRECTED BY THE ENGINEER.

SET FOUR CONCRETE REFERENCE MARKERS FOR EACH U.S. PUBLIC LAND SURVEY MONUMENT.

PREPARE MONUMENT RECORDS, FILE THE RECORDS AT THE COUNTY RECORDER'S OFFICE, AND PROVIDE A COPY TO THE DISTRICT OFFICE.

PERMANENT SURVEY MARKERS, OF THE TYPE SPECIFIED

SHALL BE PAID FOR AT THE CONTRACT UNIT PRICE, EACH, WHICH WILL BE PAYMENT IN FULL FOR FURNISHING, INSTALLING AND MARKING SAID MARKERS.

LAND SECTION MARKERS

SHALL BE PAID FOR AT THE CONTRACT UNIT PRICE, EACH, WHICH WILL BE PAYMENT IN FULL FOR SETTING TIE POINTS, SETTING FOUR CONCRETE REFERENCE MARKERS, PREPARING MONUMENT RECORDS, RECORDING AT COUNTY RECORDER'S OFFICE AND PROVIDING A COPY TO THE DISTRICT OFFICE.

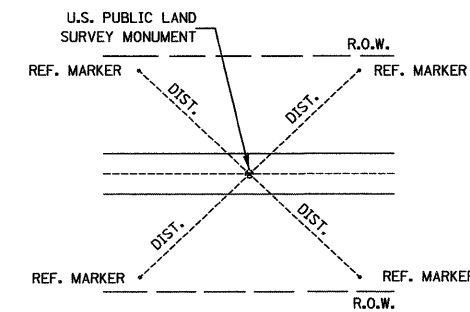

PLAN

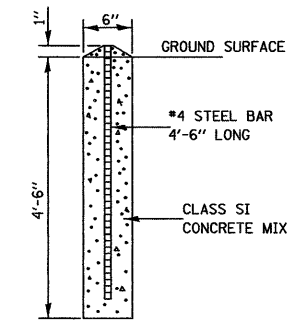

SECTION

CONCRETE REFERENCE MARKER

667-1

CHAMLIN & ASSOCIATES, INC. © 2011 Drawing Name: G:\Users\G\Documents\Will-Road-&-L-113-Env-Survey\CAD\PLANS-EXTENDED\066-DTS.dwg Last Modified: Feb 06, 2012 - 10:16am Plotted on: Mar 26, 2012 - 1:19pm by nancqb

DRAWN BY: NV	REVISIONS			
CHECKED BY: JKC	LEVEL	BY	DATE	DESCRIPTION
DATE: 02/12				

CHAMLIN & ASSOCIATES
 PERU MORRIS ILLINOIS

FAS 301 / FAU 383
SECTION 11-00007-00-WR
VILLAGE OF DIAMOND
GRUNDY AND WILL COUNTIES

DETAILS

CONSTRUCTION PLANS	CONTRACT NO. 87520	
	CURRENT AS OF: 02/12	
	SCALE: AS NOTED	SHEET 63
	FILE NO.: 66022.01 Y-	OF 96